

F.A.U. RTE.	SECTION	COUNTY	TOTAL SHEETS	SHEET NO.
6371	93-00295-03-PV	MCLEAN	109	43
STA.		TO STA.		
		ILLINOIS F.A. PROJ. NO. M-5227(046)		
CONTRACT NO. 91351				

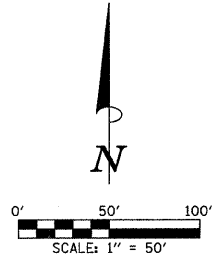

- LEGEND**
- CONSTRUCTION WORK ZONE
 - LIMITS OF PROPOSED CONSTRUCTION
 - AGGREGATE FOR TEMPORARY ACCESS
 - DRUM OR BARRICADE WITH STEADY BURN LIGHTS
 - TYPE III BARRICADE WITH FLASHING LIGHTS
 - DIRECTION OF TRAFFIC
 - SIGN

NOTE:
 THE ADDITIONAL TRAFFIC CONTROL DEVICES SHOWN FOR THIS STAGE SHALL BE INCLUDED IN THE CONTRACT LUMP SUM PRICE FOR TRAFFIC CONTROL AND PROTECTION, STANDARD BLR 21, SPECIAL UNLESS OTHERWISE NOTED.

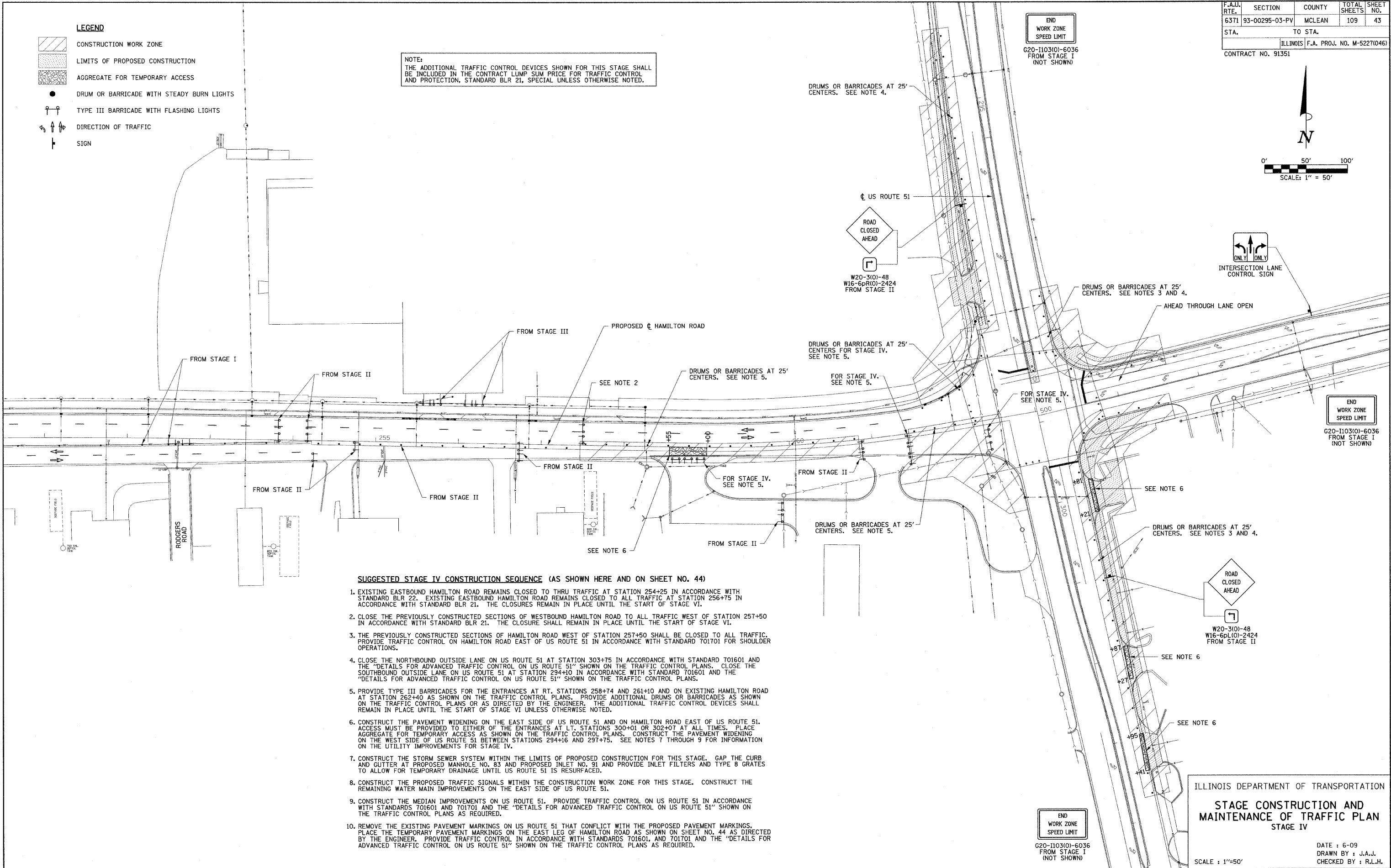

SUGGESTED STAGE IV CONSTRUCTION SEQUENCE (AS SHOWN HERE AND ON SHEET NO. 44)

1. EXISTING EASTBOUND HAMILTON ROAD REMAINS CLOSED TO THRU TRAFFIC AT STATION 254+25 IN ACCORDANCE WITH STANDARD BLR 22. EXISTING EASTBOUND HAMILTON ROAD REMAINS CLOSED TO ALL TRAFFIC AT STATION 256+75 IN ACCORDANCE WITH STANDARD BLR 21. THE CLOSURES REMAIN IN PLACE UNTIL THE START OF STAGE VI.
2. CLOSE THE PREVIOUSLY CONSTRUCTED SECTIONS OF WESTBOUND HAMILTON ROAD TO ALL TRAFFIC WEST OF STATION 257+50 IN ACCORDANCE WITH STANDARD BLR 21. THE CLOSURE SHALL REMAIN IN PLACE UNTIL THE START OF STAGE VI.
3. THE PREVIOUSLY CONSTRUCTED SECTIONS OF HAMILTON ROAD WEST OF STATION 257+50 SHALL BE CLOSED TO ALL TRAFFIC. PROVIDE TRAFFIC CONTROL ON HAMILTON ROAD EAST OF US ROUTE 51 IN ACCORDANCE WITH STANDARD 701701 FOR SHOULDER OPERATIONS.
4. CLOSE THE NORTHBOUND OUTSIDE LANE ON US ROUTE 51 AT STATION 303+75 IN ACCORDANCE WITH STANDARD 701601 AND THE "DETAILS FOR ADVANCED TRAFFIC CONTROL ON US ROUTE 51" SHOWN ON THE TRAFFIC CONTROL PLANS. CLOSE THE SOUTHBOUND OUTSIDE LANE ON US ROUTE 51 AT STATION 294+10 IN ACCORDANCE WITH STANDARD 701601 AND THE "DETAILS FOR ADVANCED TRAFFIC CONTROL ON US ROUTE 51" SHOWN ON THE TRAFFIC CONTROL PLANS.
5. PROVIDE TYPE III BARRICADES FOR THE ENTRANCES AT RT. STATIONS 258+74 AND 261+10 AND ON EXISTING HAMILTON ROAD AT STATION 262+40 AS SHOWN ON THE TRAFFIC CONTROL PLANS. PROVIDE ADDITIONAL DRUMS OR BARRICADES AS SHOWN ON THE TRAFFIC CONTROL PLANS OR AS DIRECTED BY THE ENGINEER. THE ADDITIONAL TRAFFIC CONTROL DEVICES SHALL REMAIN IN PLACE UNTIL THE START OF STAGE VI UNLESS OTHERWISE NOTED.
6. CONSTRUCT THE PAVEMENT WIDENING ON THE EAST SIDE OF US ROUTE 51 AND ON HAMILTON ROAD EAST OF US ROUTE 51. ACCESS MUST BE PROVIDED TO EITHER OF THE ENTRANCES AT LT. STATIONS 300+01 OR 302+07 AT ALL TIMES. PLACE AGGREGATE FOR TEMPORARY ACCESS AS SHOWN ON THE TRAFFIC CONTROL PLANS. CONSTRUCT THE PAVEMENT WIDENING ON THE WEST SIDE OF US ROUTE 51 BETWEEN STATIONS 294+16 AND 297+75. SEE NOTES 7 THROUGH 9 FOR INFORMATION ON THE UTILITY IMPROVEMENTS FOR STAGE IV.
7. CONSTRUCT THE STORM SEWER SYSTEM WITHIN THE LIMITS OF PROPOSED CONSTRUCTION FOR THIS STAGE. GAP THE CURB AND GUTTER AT PROPOSED MANHOLE NO. 83 AND PROPOSED INLET NO. 91 AND PROVIDE INLET FILTERS AND TYPE B GRATES TO ALLOW FOR TEMPORARY DRAINAGE UNTIL US ROUTE 51 IS RESURFACED.
8. CONSTRUCT THE PROPOSED TRAFFIC SIGNALS WITHIN THE CONSTRUCTION WORK ZONE FOR THIS STAGE. CONSTRUCT THE REMAINING WATER MAIN IMPROVEMENTS ON THE EAST SIDE OF US ROUTE 51.
9. CONSTRUCT THE MEDIAN IMPROVEMENTS ON US ROUTE 51. PROVIDE TRAFFIC CONTROL ON US ROUTE 51 IN ACCORDANCE WITH STANDARDS 701601 AND 701701 AND THE "DETAILS FOR ADVANCED TRAFFIC CONTROL ON US ROUTE 51" SHOWN ON THE TRAFFIC CONTROL PLANS AS REQUIRED.
10. REMOVE THE EXISTING PAVEMENT MARKINGS ON US ROUTE 51 THAT CONFLICT WITH THE PROPOSED PAVEMENT MARKINGS. PLACE THE TEMPORARY PAVEMENT MARKINGS ON THE EAST LEG OF HAMILTON ROAD AS SHOWN ON SHEET NO. 44 AS DIRECTED BY THE ENGINEER. PROVIDE TRAFFIC CONTROL IN ACCORDANCE WITH STANDARDS 701601, AND 701701 AND THE "DETAILS FOR ADVANCED TRAFFIC CONTROL ON US ROUTE 51" SHOWN ON THE TRAFFIC CONTROL PLANS AS REQUIRED.

ILLINOIS DEPARTMENT OF TRANSPORTATION
**STAGE CONSTRUCTION AND
 MAINTENANCE OF TRAFFIC PLAN
 STAGE IV**

DATE : 6-09
 DRAWN BY : J.A.J.
 CHECKED BY : R.L.H.