

F.A.U. RTE.	SECTION	COUNTY	TOTAL SHEETS	SHEET NO.
6371	93-00295-03-PV	MCLEAN	109	42
STA.		TO STA.		
		ILLINOIS F.A. PROJ. NO. M-5227(046)		
CONTRACT NO. 91351				

- LEGEND**
- CONSTRUCTION WORK ZONE
 - LIMITS OF PROPOSED CONSTRUCTION
 - AGGREGATE FOR TEMPORARY ACCESS
 - DRUM OR BARRICADE WITH STEADY BURN LIGHTS
 - TYPE III BARRICADE WITH FLASHING LIGHTS
 - DIRECTION OF TRAFFIC
 - SIGN

- WORK ZONE PAVEMENT MARKING LEGEND**
- (A) PAVEMENT MARKING TAPE, TYPE III 4" - YELLOW (10' DASH, 30' SKIP)

NOTE:
THE ADDITIONAL TRAFFIC CONTROL DEVICES SHOWN FOR THIS STAGE SHALL BE INCLUDED IN THE CONTRACT LUMP SUM PRICE FOR TRAFFIC CONTROL AND PROTECTION, STANDARD BLR 21, SPECIAL UNLESS OTHERWISE NOTED.

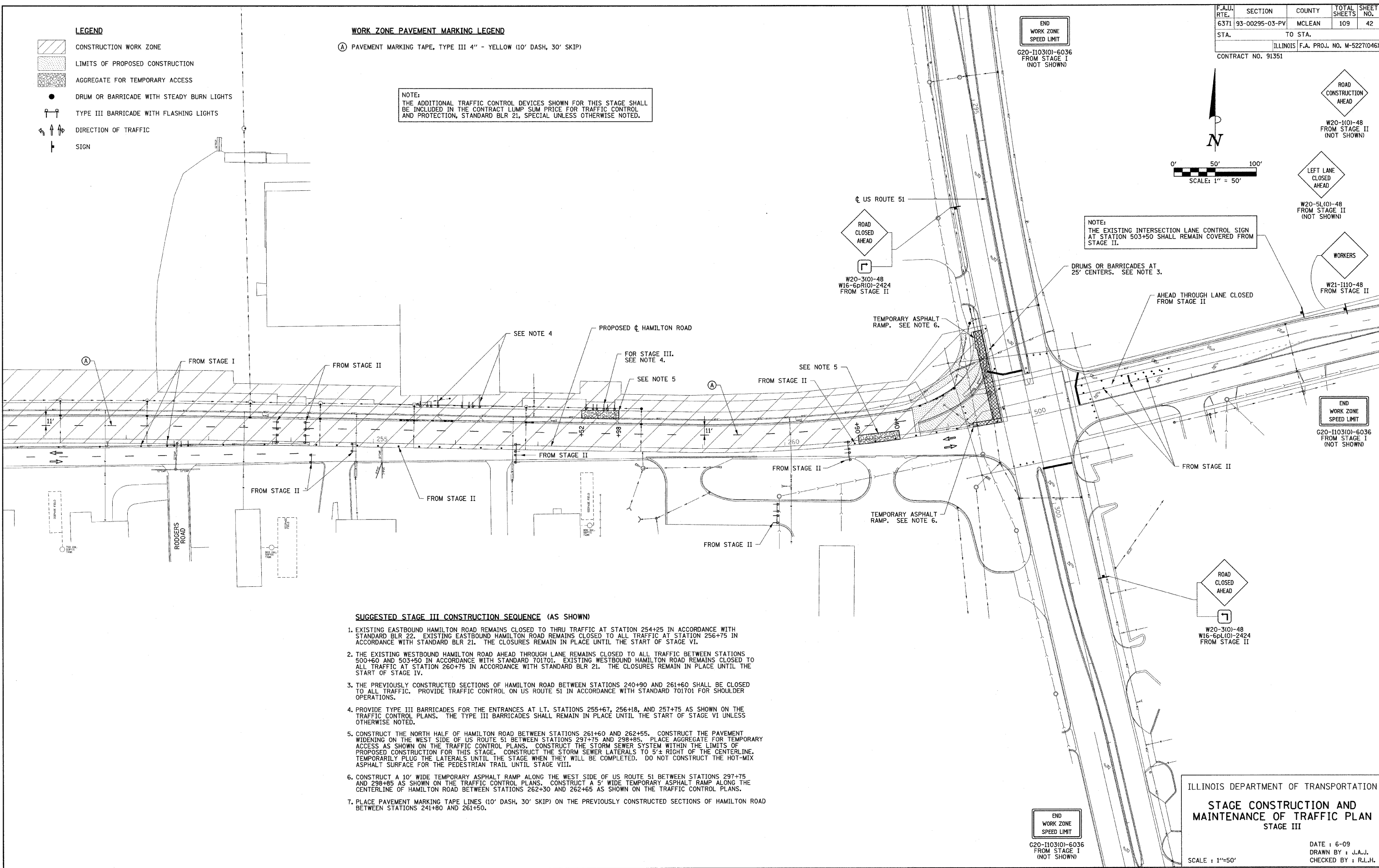
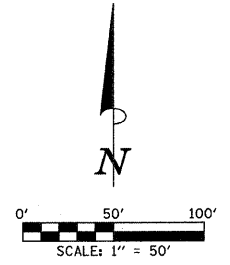

SUGGESTED STAGE III CONSTRUCTION SEQUENCE (AS SHOWN)

1. EXISTING EASTBOUND HAMILTON ROAD REMAINS CLOSED TO THRU TRAFFIC AT STATION 254+25 IN ACCORDANCE WITH STANDARD BLR 22. EXISTING EASTBOUND HAMILTON ROAD REMAINS CLOSED TO ALL TRAFFIC AT STATION 256+75 IN ACCORDANCE WITH STANDARD BLR 21. THE CLOSURES REMAIN IN PLACE UNTIL THE START OF STAGE VI.
2. THE EXISTING WESTBOUND HAMILTON ROAD AHEAD THROUGH LANE REMAINS CLOSED TO ALL TRAFFIC BETWEEN STATIONS 500+60 AND 503+50 IN ACCORDANCE WITH STANDARD 701701. EXISTING WESTBOUND HAMILTON ROAD REMAINS CLOSED TO ALL TRAFFIC AT STATION 260+75 IN ACCORDANCE WITH STANDARD BLR 21. THE CLOSURES REMAIN IN PLACE UNTIL THE START OF STAGE IV.
3. THE PREVIOUSLY CONSTRUCTED SECTIONS OF HAMILTON ROAD BETWEEN STATIONS 240+90 AND 261+60 SHALL BE CLOSED TO ALL TRAFFIC. PROVIDE TRAFFIC CONTROL ON US ROUTE 51 IN ACCORDANCE WITH STANDARD 701701 FOR SHOULDER OPERATIONS.
4. PROVIDE TYPE III BARRICADES FOR THE ENTRANCES AT LT. STATIONS 255+67, 256+18, AND 257+75 AS SHOWN ON THE TRAFFIC CONTROL PLANS. THE TYPE III BARRICADES SHALL REMAIN IN PLACE UNTIL THE START OF STAGE VI UNLESS OTHERWISE NOTED.
5. CONSTRUCT THE NORTH HALF OF HAMILTON ROAD BETWEEN STATIONS 261+60 AND 262+55. CONSTRUCT THE PAVEMENT WIDENING ON THE WEST SIDE OF US ROUTE 51 BETWEEN STATIONS 297+75 AND 298+85. PLACE AGGREGATE FOR TEMPORARY ACCESS AS SHOWN ON THE TRAFFIC CONTROL PLANS. CONSTRUCT THE STORM SEWER SYSTEM WITHIN THE LIMITS OF PROPOSED CONSTRUCTION FOR THIS STAGE. CONSTRUCT THE STORM SEWER LATERALS TO 5'± RIGHT OF THE CENTERLINE. TEMPORARILY PLUG THE LATERALS UNTIL THE STAGE WHEN THEY WILL BE COMPLETED. DO NOT CONSTRUCT THE HOT-MIX ASPHALT SURFACE FOR THE PEDESTRIAN TRAIL UNTIL STAGE VIII.
6. CONSTRUCT A 10' WIDE TEMPORARY ASPHALT RAMP ALONG THE WEST SIDE OF US ROUTE 51 BETWEEN STATIONS 297+75 AND 298+85 AS SHOWN ON THE TRAFFIC CONTROL PLANS. CONSTRUCT A 5' WIDE TEMPORARY ASPHALT RAMP ALONG THE CENTERLINE OF HAMILTON ROAD BETWEEN STATIONS 262+30 AND 262+65 AS SHOWN ON THE TRAFFIC CONTROL PLANS.
7. PLACE PAVEMENT MARKING TAPE LINES (10' DASH, 30' SKIP) ON THE PREVIOUSLY CONSTRUCTED SECTIONS OF HAMILTON ROAD BETWEEN STATIONS 241+80 AND 261+50.

ILLINOIS DEPARTMENT OF TRANSPORTATION
STAGE CONSTRUCTION AND MAINTENANCE OF TRAFFIC PLAN
STAGE III

DATE : 6-09
DRAWN BY : J.A.J.
CHECKED BY : R.L.H.

SCALE : 1"=50'
SHEET 42 OF 109 SHEETS B0110094