

F.A.U. RTE.	SECTION	COUNTY	TOTAL SHEETS	SHEET NO.
6371	93-00295-03-PV	MCLEAN	109	41
STA. _____ TO STA. _____		ILLINOIS F.A. PROJ. NO. M-5227(046)		
CONTRACT NO. 91351				

- LEGEND**
- CONSTRUCTION WORK ZONE
 - LIMITS OF PROPOSED CONSTRUCTION
 - AGGREGATE FOR TEMPORARY ACCESS
 - DRUM OR BARRICADE WITH STEADY BURN LIGHTS
 - TYPE III BARRICADE WITH FLASHING LIGHTS
 - DIRECTION OF TRAFFIC
 - SIGN

NOTE:
 THE ADDITIONAL TRAFFIC CONTROL DEVICES SHOWN FOR THIS STAGE SHALL BE INCLUDED IN THE CONTRACT LUMP SUM PRICE FOR TRAFFIC CONTROL AND PROTECTION, STANDARD BLR 21, SPECIAL UNLESS OTHERWISE NOTED.

END WORK ZONE SPEED LIMIT
 G20-1103(0)-6036 FROM STAGE I (NOT SHOWN)

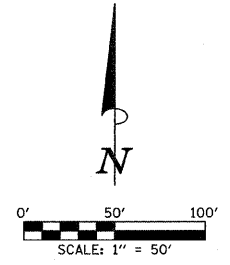

ROAD CONSTRUCTION AHEAD
 W20-110-48 STATION 507+75 (NOT SHOWN)

LEFT LANE CLOSED AHEAD
 W20-5L(0)-48 STATION 505+75 (NOT SHOWN)

WORKERS
 W21-1110-48 STATION 503+75

NOTE:
 THE EXISTING INTERSECTION LANE CONTROL SIGN AT STATION 503+50 SHALL BE COVERED DURING THIS STAGE.

END WORK ZONE SPEED LIMIT
 G20-1103(0)-6036 FROM STAGE I (NOT SHOWN)

ROAD CLOSED AHEAD
 W20-3(0)-48 W16-6pL(0)-2424 STATION 301+00

END WORK ZONE SPEED LIMIT
 G20-1103(0)-6036 FROM STAGE I (NOT SHOWN)

ILLINOIS DEPARTMENT OF TRANSPORTATION
STAGE CONSTRUCTION AND MAINTENANCE OF TRAFFIC PLAN
 STAGE II

DATE : 6-09
 DRAWN BY : J.A.J.
 CHECKED BY : R.L.H.

SCALE : 1"=50'
 SHEET 41 OF 109 SHEETS B0110094

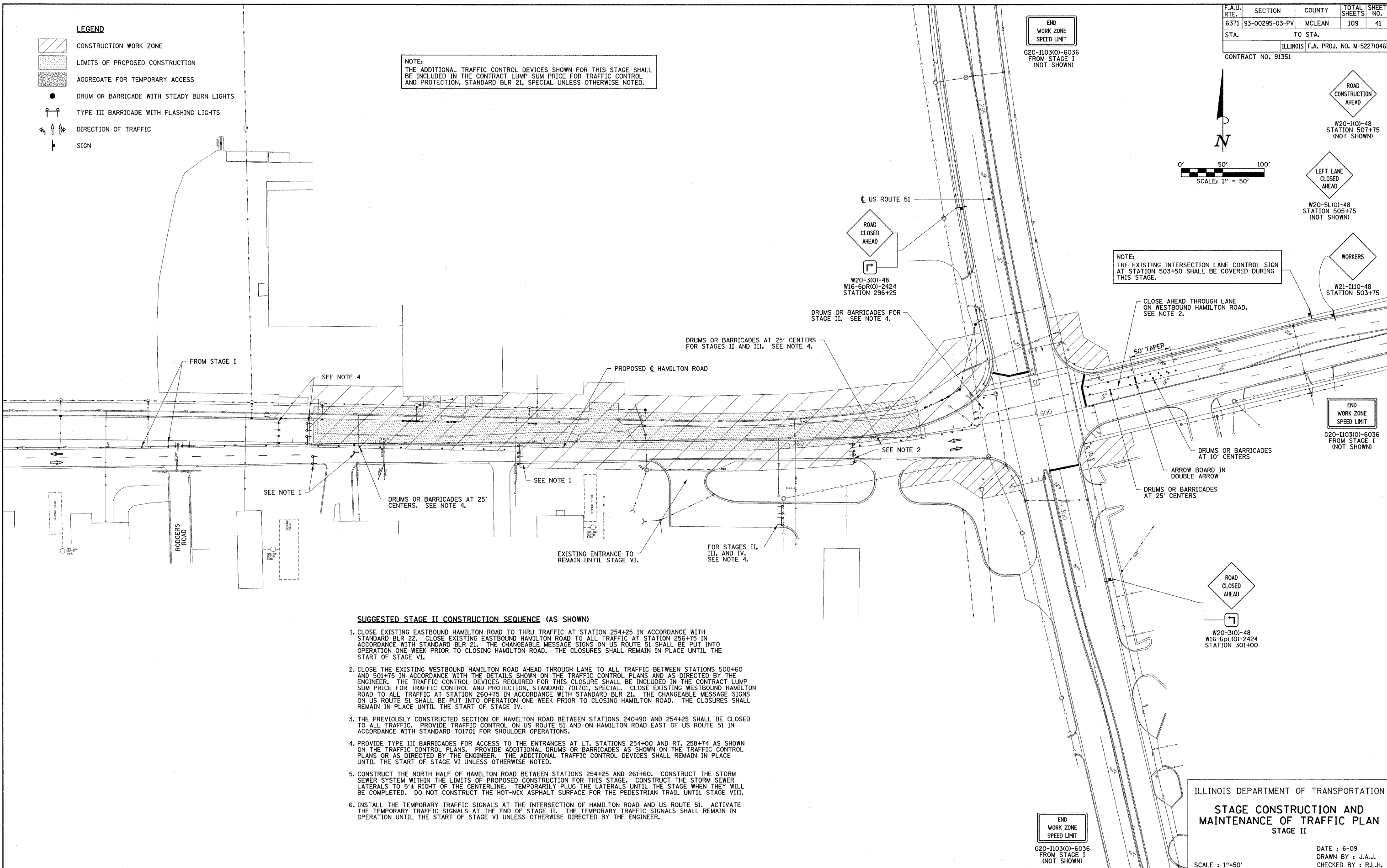

SUGGESTED STAGE II CONSTRUCTION SEQUENCE (AS SHOWN)

1. CLOSE EXISTING EASTBOUND HAMILTON ROAD TO THRU TRAFFIC AT STATION 254+25 IN ACCORDANCE WITH STANDARD BLR 22. CLOSE EXISTING EASTBOUND HAMILTON ROAD TO ALL TRAFFIC AT STATION 256+75 IN ACCORDANCE WITH STANDARD BLR 21. THE CHANGEABLE MESSAGE SIGNS ON US ROUTE 51 SHALL BE PUT INTO OPERATION ONE WEEK PRIOR TO CLOSING HAMILTON ROAD. THE CLOSURES SHALL REMAIN IN PLACE UNTIL THE START OF STAGE VI.
2. CLOSE THE EXISTING WESTBOUND HAMILTON ROAD AHEAD THROUGH LANE TO ALL TRAFFIC BETWEEN STATIONS 500+60 AND 501+75 IN ACCORDANCE WITH THE DETAILS SHOWN ON THE TRAFFIC CONTROL PLANS AND AS DIRECTED BY THE ENGINEER. THE TRAFFIC CONTROL DEVICES REQUIRED FOR THIS CLOSURE SHALL BE INCLUDED IN THE CONTRACT LUMP SUM PRICE FOR TRAFFIC CONTROL AND PROTECTION, STANDARD 70170L, SPECIAL. CLOSE EXISTING WESTBOUND HAMILTON ROAD TO ALL TRAFFIC AT STATION 260+75 IN ACCORDANCE WITH STANDARD BLR 21. THE CHANGEABLE MESSAGE SIGNS ON US ROUTE 51 SHALL BE PUT INTO OPERATION ONE WEEK PRIOR TO CLOSING HAMILTON ROAD. THE CLOSURES SHALL REMAIN IN PLACE UNTIL THE START OF STAGE IV.
3. THE PREVIOUSLY CONSTRUCTED SECTION OF HAMILTON ROAD BETWEEN STATIONS 240+90 AND 254+25 SHALL BE CLOSED TO ALL TRAFFIC. PROVIDE TRAFFIC CONTROL ON US ROUTE 51 AND ON HAMILTON ROAD EAST OF US ROUTE 51 IN ACCORDANCE WITH STANDARD 70170I FOR SHOULDER OPERATIONS.
4. PROVIDE TYPE III BARRICADES FOR ACCESS TO THE ENTRANCES AT LT. STATIONS 254+00 AND RT. 258+74 AS SHOWN ON THE TRAFFIC CONTROL PLANS. PROVIDE ADDITIONAL DRUMS OR BARRICADES AS SHOWN ON THE TRAFFIC CONTROL PLANS OR AS DIRECTED BY THE ENGINEER. THE ADDITIONAL TRAFFIC CONTROL DEVICES SHALL REMAIN IN PLACE UNTIL THE START OF STAGE VI UNLESS OTHERWISE NOTED.
5. CONSTRUCT THE NORTH HALF OF HAMILTON ROAD BETWEEN STATIONS 254+25 AND 261+60. CONSTRUCT THE STORM SEWER SYSTEM WITHIN THE LIMITS OF PROPOSED CONSTRUCTION FOR THIS STAGE. CONSTRUCT THE STORM SEWER LATERALS TO 5'± RIGHT OF THE CENTERLINE. TEMPORARILY PLUG THE LATERALS UNTIL THE STAGE WHEN THEY WILL BE COMPLETED. DO NOT CONSTRUCT THE HOT-MIX ASPHALT SURFACE FOR THE PEDESTRIAN TRAIL UNTIL STAGE VIII.
6. INSTALL THE TEMPORARY TRAFFIC SIGNALS AT THE INTERSECTION OF HAMILTON ROAD AND US ROUTE 51. ACTIVATE THE TEMPORARY TRAFFIC SIGNALS AT THE END OF STAGE II. THE TEMPORARY TRAFFIC SIGNALS SHALL REMAIN IN OPERATION UNTIL THE START OF STAGE VI UNLESS OTHERWISE DIRECTED BY THE ENGINEER.