

F.A.U. RTE.	SECTION	COUNTY	TOTAL SHEETS	SHEET NO.
6371	93-00295-03-PV	MCLEAN	109	40
STA.		TO STA.		
		ILLINOIS F.A. PROJ. NO. M-5227(046)		
CONTRACT NO. 91351				

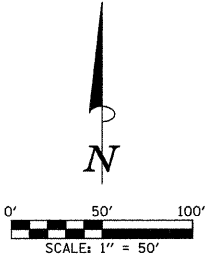

- LEGEND**
- CONSTRUCTION WORK ZONE
  - LIMITS OF PROPOSED CONSTRUCTION
  - AGGREGATE FOR TEMPORARY ACCESS
  - DRUM OR BARRICADE WITH STEADY BURN LIGHTS
  - TYPE III BARRICADE WITH FLASHING LIGHTS
  - DIRECTION OF TRAFFIC
  - SIGN

- WORK ZONE PAVEMENT MARKING LEGEND**
- (A) PAVEMENT MARKING TAPE, TYPE III 4" - YELLOW
  - (B) PAVEMENT MARKING TAPE, TYPE III 4" - WHITE
  - (C) PAVEMENT MARKING TAPE, TYPE III 4" - DOUBLE YELLOW
  - (D) TEMPORARY PAVEMENT MARKING - LINE 4" - YELLOW (10' DASH, 30' SKIP)

**NOTE:**  
 THE ADDITIONAL TRAFFIC CONTROL DEVICES SHOWN FOR THIS STAGE SHALL BE INCLUDED IN THE CONTRACT LUMP SUM PRICE FOR TRAFFIC CONTROL AND PROTECTION, STANDARD 701606, SPECIAL UNLESS OTHERWISE NOTED.  
 THE TRAFFIC CONTROL DEVICES AND PAVEMENT MARKINGS SHOWN FOR THIS STAGE THAT ARE WEST OF US ROUTE 51 SHALL REMAIN IN PLACE UNTIL THE START OF STAGE VI UNLESS OTHERWISE NOTED.  
 THE "END WORK ZONE SPEED LIMIT" SIGNS SHOWN ON THIS SHEET SHALL REMAIN IN PLACE FOR THE DURATION OF THE PROJECT.

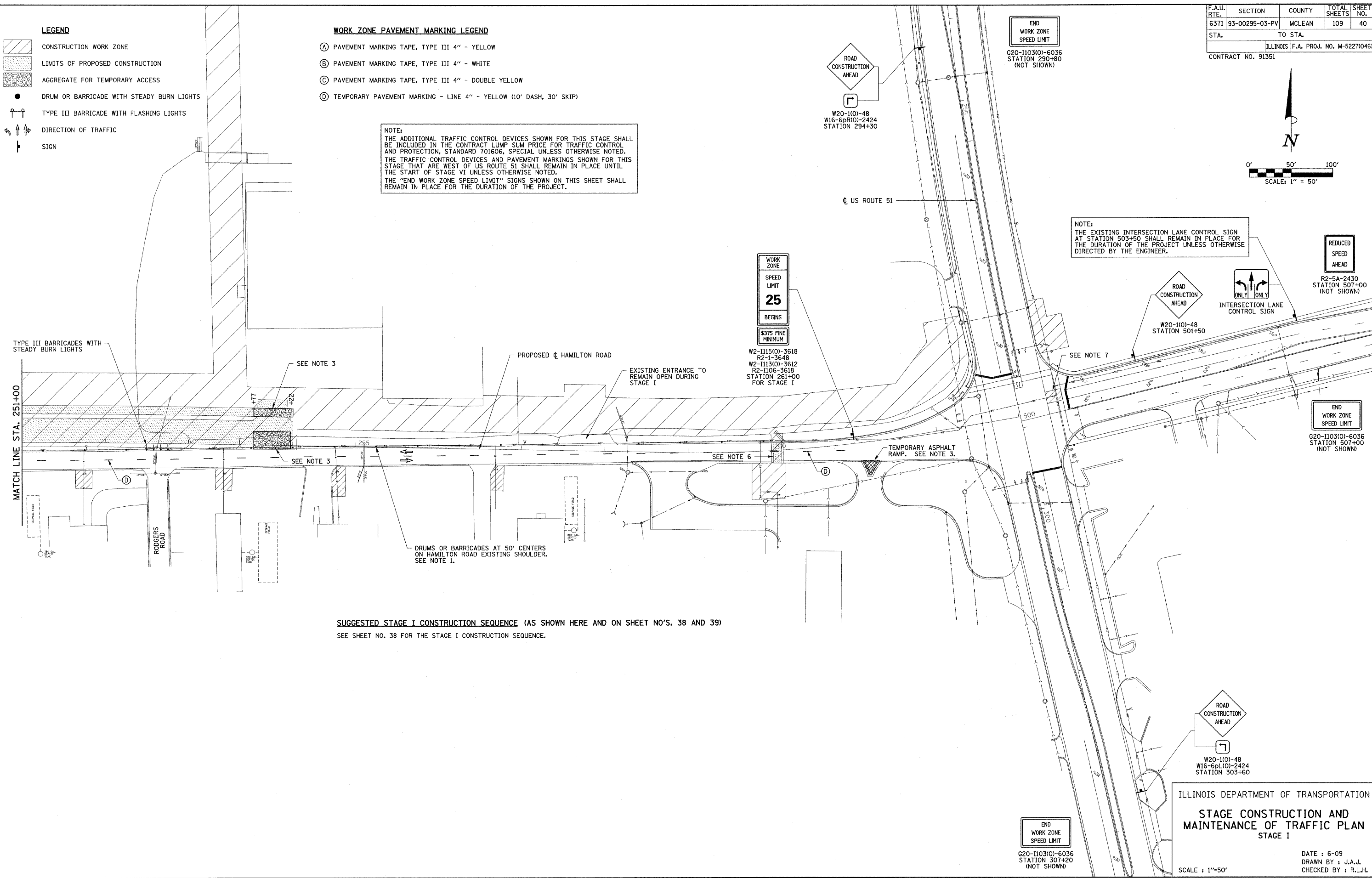

**SUGGESTED STAGE I CONSTRUCTION SEQUENCE (AS SHOWN HERE AND ON SHEET NO'S. 38 AND 39)**  
 SEE SHEET NO. 38 FOR THE STAGE I CONSTRUCTION SEQUENCE.

ILLINOIS DEPARTMENT OF TRANSPORTATION  
**STAGE CONSTRUCTION AND MAINTENANCE OF TRAFFIC PLAN STAGE I**

DATE : 6-09  
 DRAWN BY : J.A.J.  
 CHECKED BY : R.L.H.

SCALE : 1"=50'  
 SHEET 40 OF 109 SHEETS B0110094