

SEC. 16, T.23 N., R.2 E., 3rd P.M.
MCLEAN COUNTY, ILLINOIS

F.A.U. RTE.	SECTION	COUNTY	TOTAL SHEETS	SHEET NO.
6371	93-00295-03-PV	MCLEAN	109	30
STA. 501+00.00		TO STA. 505+00.00		
ILLINOIS F.A. PROJ. NO. M-5227(046)				
CONTRACT NO. 91351				

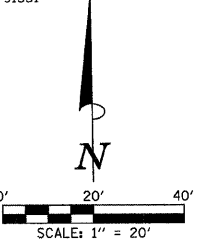

PLAN	DATE	BY
SURVEYED		
ALIGNED		
CHECKED		
RT. OF WAY CHECKED		
NO.		
NO.		
NO.		

PROF. FILE	DATE	BY
SURVEYED		
PLOTTED		
CHECKED		
B.M. NOTED		
STRUCTURE NOTATING		
NO.		

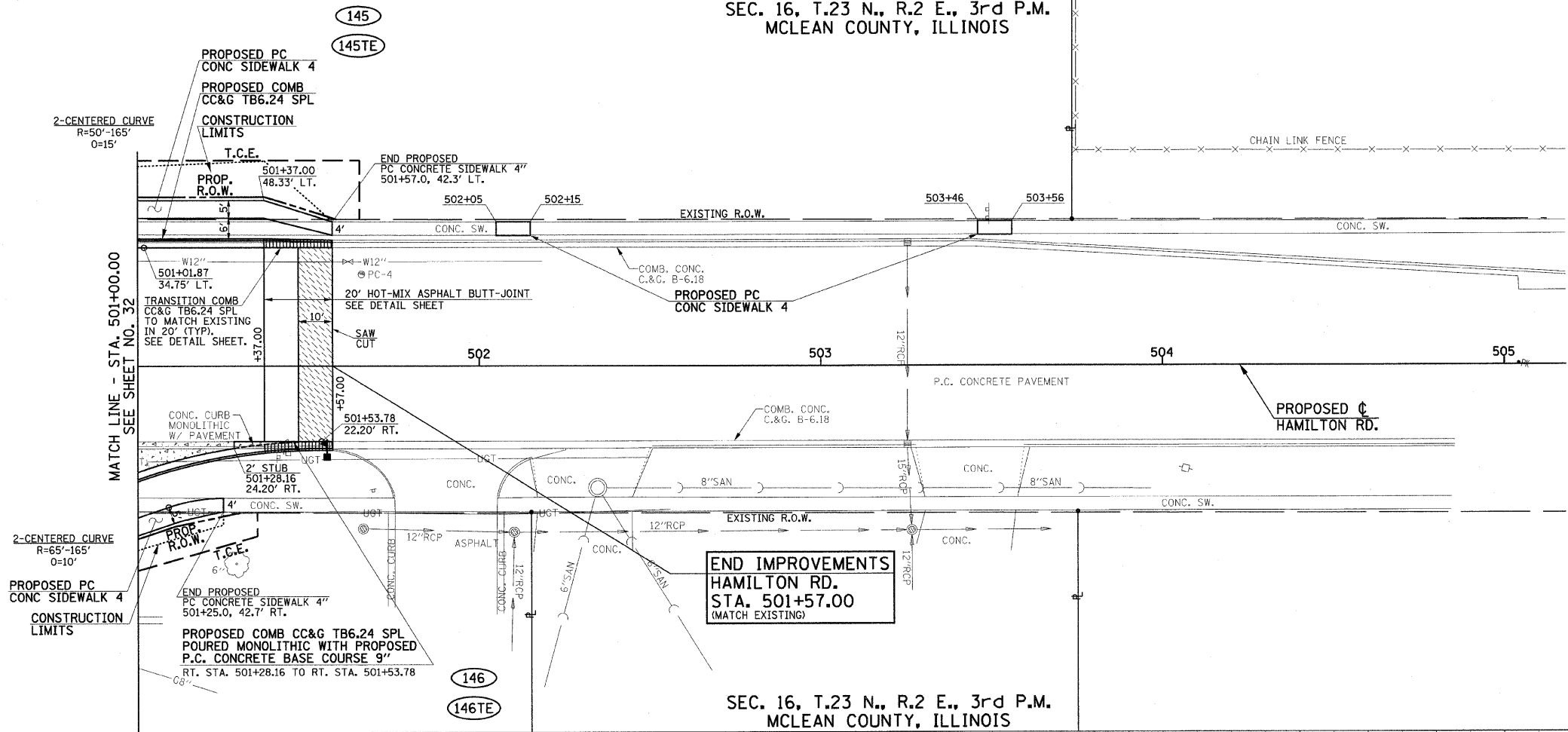

- LEGEND**
- PROPOSED PORTLAND CEMENT CONCRETE BASE COURSE 9"
 - PROPOSED PORTLAND CEMENT CONCRETE SURFACE REMOVAL - BUTT JOINT
- FOR REMOVAL/RELOCATION PLAN IN THIS AREA SEE SHEET NO. 22.
- SEE HORIZONTAL ALIGNMENT LAYOUT AND CONTROL SHEETS FOR ADDITIONAL INFORMATION.
- SEE SCHEDULE OF QUANTITIES FOR TYPICAL SECTION PAVEMENT PAY ITEMS AND THEIR LOCATIONS.
- SEE INTERSECTION DETAILS FOR ADDITIONAL INFORMATION.
- SEE THE STAGE CONSTRUCTION AND MAINTENANCE OF TRAFFIC PLANS FOR THE VARIOUS STAGES AND CONSTRUCTION SEQUENCES ON HAMILTON RD.

