

LOCATION	PAVEMENT REMOVAL SCHEDULE					
	HMA SURF REM 2 1/2" (44000159) (SQ YD)	PAVEMENT REM (44000100) (SQ YD)	MEDIAN REM (44003100) (SQ FT)	DRIVE PAVEMENT REM (44000200) (SQ YD)	COMB CURB GUTTER REM (44000500) (FOOT)	SIDEWALK REM (44000600) (SQ FT)
CITY - HAMILTON ROAD						
262+00.0 TO 262+67.0 LT. & RT.		594.9			166.6	
CITY - HAMILTON ROAD SUBTOTAL		594.9			166.6	
CITY - MAIN STREET						
294+16.0 RT. TO 297+00.0 RT.	31.6				286.7	1143.9
297+00.0 RT. TO 300+22.5 RT.	35.8					
297+00.0 RT. TO 298+10.7 RT.					142.9	
299+55.4 RT. TO 300+22.5 RT.				68.9	67.2	
297+24.0 RT. - C.E.						
297+00.0 RT. TO 262+24.1 LT.						515.3
262+47.7 RT. TO 300+09.8 RT.						391.0
297+45.8 LT. TO 301+60.0 LT.	484.7					
297+45.8 LT. TO 501+00.0 LT.					147.9	
501+00.0 RT. TO 301+60.0 LT.					289.2	71.2
298+01.0 LT. TO 298+51.9 LT.			375.1		68.5	
298+32.0 LT. TO 501+00.0 LT.						211.1
501+00.0 RT. TO 299+33.9 LT.						249.4
300+00.7 LT. - C.E.				214.0		
CITY - MAIN STREET SUBTOTAL	552.1		375.1	282.9	1002.4	71.2
PAGE TOTAL	552.1	594.9	375.1	282.9	1169.0	71.2

CLASS B PATCHES, 9 INCH	
LOCATION	TYPE III (44200962) (SQ YD)
CITY - MAIN STREET	
298+71 LT.	24.8
PAGE TOTAL	24.8

TREE REMOVAL (6 TO 15 UNITS DIAMETER) (20100110)		
STATION	OFFSET	UNIT
CITY - MAIN STREET		
300+57.3	47.3' LT.	6
301+03.1	47.5' LT.	6
301+50.9	46.7' LT.	6
PAGE TOTAL		18

BEGIN IMPROVEMENTS
U.S. RTE. 51 (MAIN ST.)
STA. 294+16.00

EXISTING U.S. RTE. 51 (MAIN ST.) CURVE DATA
 P.T. STA. 293+53.59 L = 911.34'
 Δ = 13°40'12" E = 27.34'
 D = 130'00" P.C. STA. 288+95.75 (NOT SHOWN)
 T = 457.84' P.T. STA. 298+07.09
 R = 3819.72'

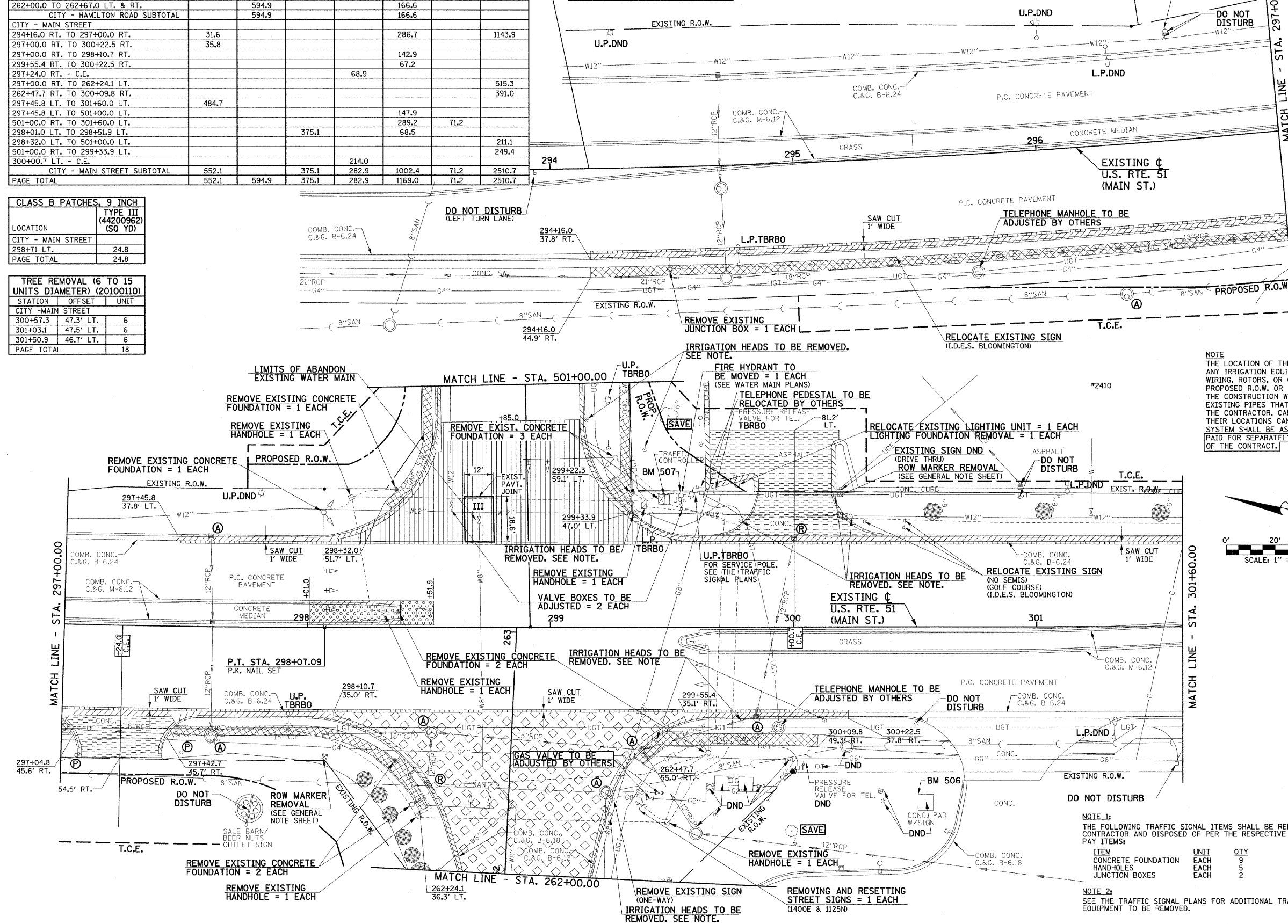

- LEGEND**
- U.P. DND - UTILITY POLE DO NOT DISTURB
 - L.P. DND - LIGHT POLE DO NOT DISTURB
 - U.P. TBRBO - UTILITY POLE TO BE RELOCATED BY OTHERS
 - L.P. TBRBO - LIGHT POLE TO BE RELOCATED BY OTHERS
 - M - MAILBOX TO BE RELOCATED
 - A - STRUCTURE TO BE ADJUSTED
 - P - STRUCTURE TO BE REMOVED
 - ⊙ - POST TO BE REMOVED
 - OR OR - TREE REMOVAL
 - TP1 - EXISTING TREE TO BE TRANSPLANTED
 - ▨ - HOT-MIX ASPHALT SURFACE REMOVAL 2 1/2"
 - ▨ - PAVEMENT REMOVAL
 - ▨ - DRIVEWAY PAVEMENT REMOVAL
 - ▨ - COMBINATION CURB AND GUTTER REMOVAL OR CURB REMOVAL
 - ▨ - SIDEWALK REMOVAL
 - ▨ - MEDIAN REMOVAL
 - III - CLASS B PATCH 9" (III INDICATES TYPE)
 - X---X---X--- - EXISTING FENCE
 - X---X---X--- - FENCE REMOVAL

NOTE
 THE LOCATION OF THE UNDERGROUND IRRIGATION SYSTEM IS UNKNOWN. ANY IRRIGATION EQUIPMENT SUCH AS PIPING, SPRAY HEADS, CONTROLLERS, WIRING, ROTORS, OR CONTROL VALVES THAT ARE WITHIN THE EXISTING OR PROPOSED R.O.W. OR PERMANENT EASEMENT LIMITS AND CONFLICT WITH THE CONSTRUCTION WORK SHALL BE REMOVED BY THE CONTRACTOR. EXISTING PIPES THAT ARE CUT SHALL BE CAPPED TO PREVENT LEAKAGE BY THE CONTRACTOR. CAPPED PIPES SHALL BE MARKED AND DOCUMENTED SO THEIR LOCATIONS CAN BE RE-ESTABLISHED. THE REMOVAL OF THE IRRIGATION SYSTEM SHALL BE AS DIRECTED BY THE ENGINEER. THIS WORK WILL NOT BE PAID FOR SEPARATELY AND SHALL BE INCLUDED IN THE VARIOUS PAY ITEMS OF THE CONTRACT.

FOR PROPOSED CONSTRUCTION IN THIS AREA SEE PLAN AND PROFILE SHEET NO'S 31 AND 32.

MAILBOXES SHALL BE RELOCATED AS DIRECTED BY THE ENGINEER IN ACCORDANCE WITH ARTICLE 107.20 OF THE STANDARD SPECIFICATIONS.

SEE PLAN AND PROFILE SHEETS FOR STORM SEWER REMOVAL AND STRUCTURE REMOVAL AND ADJUSTMENT SCHEDULES.

EXISTING PAVEMENTS, CURBS AND GUTTERS, AND SIDEWALKS IN WHICH THE TOP SURFACE IS TO BE JOINED TO THE PROPOSED WORK SHALL BE SO JOINED THROUGH SAW CUT JUNCTURES.

THE REMOVAL OF POSTS SHALL BE INCLUDED IN THE CONTRACT UNIT PRICE FOR VARIOUS REMOVAL ITEMS. NO ADDITIONAL COMPENSATION WILL BE ALLOWED DUE TO VARIATIONS OF POST TYPES OR TO THE EXTENT WHICH THEY BE REINFORCED.

THE REMOVAL AND RELOCATION OF VARIOUS TRAFFIC SIGNS NOTED HEREON SHALL BE AS DIRECTED BY THE ENGINEER AND AS SPECIFIED IN GENERAL NOTES. THIS WORK SHALL NOT BE PAID FOR SEPARATELY AND IS CONSIDERED AS INCLUDED IN THE VARIOUS REMOVAL ITEMS.

NOTE 1:
 THE FOLLOWING TRAFFIC SIGNAL ITEMS SHALL BE REMOVED BY THE CONTRACTOR AND DISPOSED OF PER THE RESPECTIVE CONTRACT PAY ITEMS:

ITEM	UNIT	QTY
CONCRETE FOUNDATION	EACH	9
HANDHOLES	EACH	5
JUNCTION BOXES	EACH	2

NOTE 2:
 SEE THE TRAFFIC SIGNAL PLANS FOR ADDITIONAL TRAFFIC SIGNAL EQUIPMENT TO BE REMOVED.

ILLINOIS DEPARTMENT OF TRANSPORTATION

REMOVALS/RELOCATIONS PLAN

DATE : 6-09
 DRAWN BY : J.L.B.
 CHECKED BY : R.L.H.

SCALE : 1"=20'