

PAVEMENT REMOVAL SCHEDULE			
LOCATION	PAVEMENT REM (44000100) (SQ YD)	DRIVE PAVEMENT REM (44000200) (SQ YD)	COMB CURB GUTTER REM (44000500) (FOOT)
248+00.0 TO 253+00.0 RT.	1172.4		
253+00.0 TO 258+00.0 LT. & RT.	1172.5		
DICKERSON DRIVE RT.	56.1		2.3
RODGERS ROAD RT.	61.0		10.5
253+52.0 LT. - C.E.		86.2	
SAIL BARN CONC. PAD LT.		106.5	
256+54.0 RT. - P.E.		141.8	
257+75.0 LT. - C.E.		92.9	
PAGE TOTAL	2462.0	427.4	12.8

SALVAGING AND TRANSPLANTING TREES, SPECIAL (25300910)			
ABBREV.	EXISTING STATION	EXISTING OFFSET	EACH
TP2	249+62.3	27.0' LT.	1
TP3	252+22.4	49.8' LT.	1
PAGE TOTAL			2

F.A.U. RTE.	SECTION	COUNTY	TOTAL SHEETS NO.
6371	93-00295-03-PV	MCLEAN	109
STA. 248+00.00 TO STA. 258+00.00			21

ILLINOIS F.A. PROJ. NO. M-5227(046)  
CONTRACT NO. 91351

PROPOSED  $\phi$  HAMILTON RD.  
CURVE DATA  
P.I. STA. 251+59.84  
 $\Delta = 1^{\circ}30'00''$   
 $D = 0^{\circ}34'23''$   
 $T = 130.91'$   
 $R = 10000.00'$   
 $L = 261.80'$   
 $E = 0.86'$   
P.C. STA. 250+28.93  
P.T. STA. 252+90.73

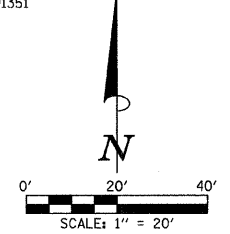

- LEGEND**
- U.P. DND - UTILITY POLE DO NOT DISTURB
  - L.P. DND - LIGHT POLE DO NOT DISTURB
  - U.P. TBRBO - UTILITY POLE TO BE RELOCATED BY OTHERS
  - L.P. TBRBO - LIGHT POLE TO BE RELOCATED BY OTHERS
  - (M) - MAILBOX TO BE RELOCATED
  - (A) - STRUCTURE TO BE ADJUSTED
  - (R) - STRUCTURE TO BE REMOVED
  - (P) - POST TO BE REMOVED
  - (OR) (OR) - TREE REMOVAL
  - TP1 - EXISTING TREE TO BE TRANSPLANTED
  - (Hatched) - PAVEMENT REMOVAL
  - (Diagonal Lines) - DRIVEWAY PAVEMENT REMOVAL
  - (Cross-hatched) - COMBINATION CURB AND GUTTER REMOVAL
  - (Dotted) - SIDEWALK REMOVAL
  - (X-X-X) - EXISTING FENCE
  - (X-X-X) - FENCE REMOVAL

**NOTE 1**  
THE EXISTING SIGNS SHALL BE REMOVED AND DELIVERED TO A LOCATION WITHIN THE CITY LIMITS AS DIRECTED BY THE ENGINEER. THIS WORK WILL NOT BE PAID FOR SEPARATELY AND SHALL BE INCLUDED IN THE COST OF THE VARIOUS REMOVAL ITEMS.

FOR LOCATIONS OF TREES TO BE TRANSPLANTED, SEE THE TREE PLANTING PLAN SHEETS.

FOR PROPOSED CONSTRUCTION IN THIS AREA SEE PLAN AND PROFILE SHEET NO'S 27 AND 28.

MAILBOXES SHALL BE RELOCATED AS DIRECTED BY THE ENGINEER IN ACCORDANCE WITH ARTICLE 107.20 OF THE STANDARD SPECIFICATIONS.

SEE PLAN AND PROFILE SHEETS FOR STORM SEWER REMOVAL AND STRUCTURE REMOVAL AND ADJUSTMENT SCHEDULES.

EXISTING PAVEMENTS, CURBS AND GUTTERS, AND SIDEWALKS IN WHICH THE TOP SURFACE IS TO BE JOINED TO THE PROPOSED WORK SHALL BE SO JOINED THROUGH SAW CUT JUNCTURES.

THE REMOVAL OF POSTS SHALL BE INCLUDED IN THE CONTRACT UNIT PRICE FOR VARIOUS REMOVAL ITEMS. NO ADDITIONAL COMPENSATION WILL BE ALLOWED DUE TO VARIATIONS OF POST TYPES OR TO THE EXTENT WHICH THEY BE REINFORCED.

THE REMOVAL AND RELOCATION OF VARIOUS TRAFFIC SIGNS NOTED HEREON SHALL BE AS DIRECTED BY THE ENGINEER AND AS SPECIFIED IN GENERAL NOTES. THIS WORK SHALL NOT BE PAID FOR SEPARATELY AND IS CONSIDERED AS INCLUDED IN THE VARIOUS REMOVAL ITEMS.

ILLINOIS DEPARTMENT OF TRANSPORTATION

**REMOVALS/RELOCATIONS PLAN**

SCALE: 1"=20'  
DATE: 6-09  
DRAWN BY: J.L.B.  
CHECKED BY: R.L.H.

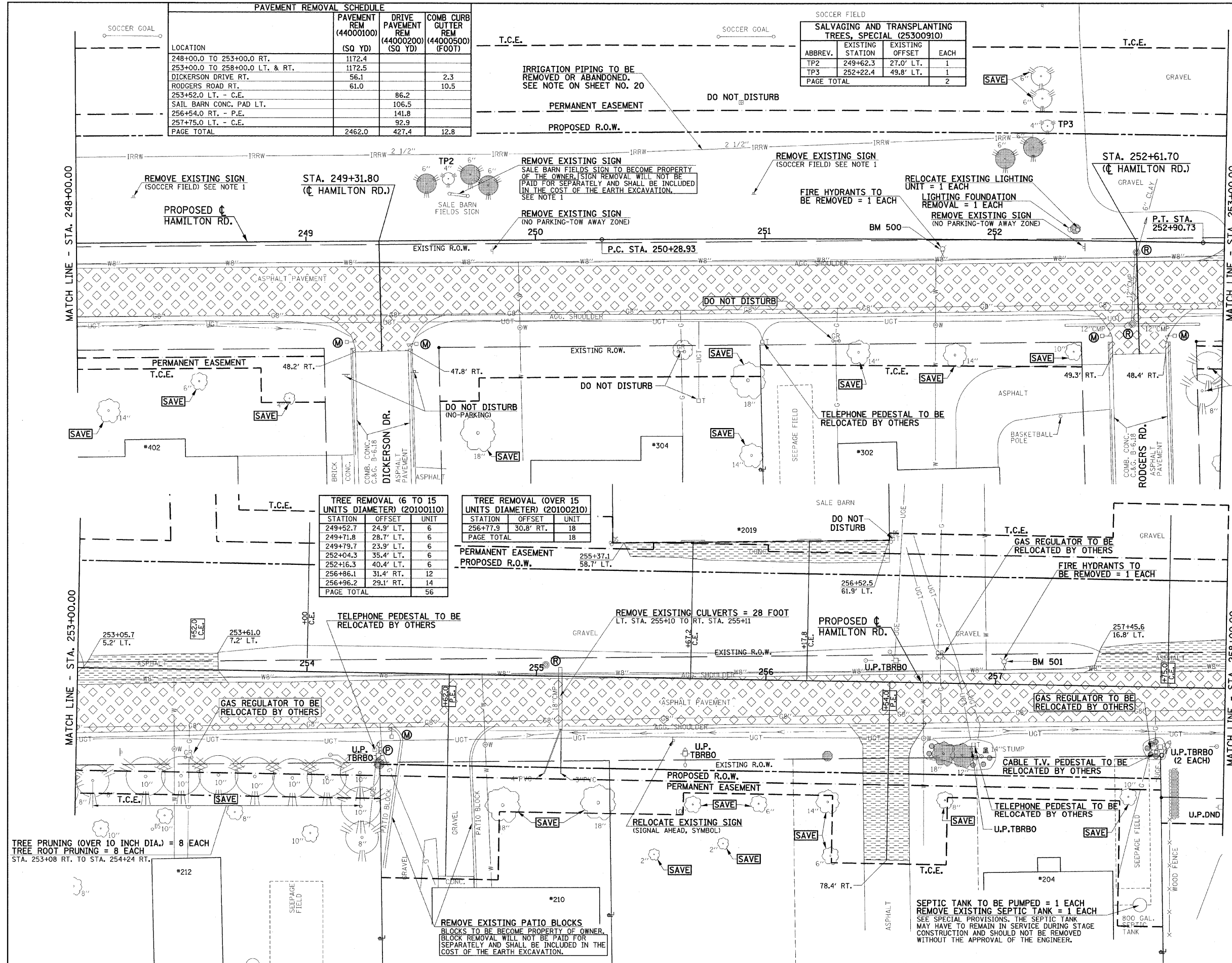

TREE REMOVAL (6 TO 15 UNITS DIAMETER) (20100110)		
STATION	OFFSET	UNIT
249+52.7	24.9' LT.	6
249+71.8	28.7' LT.	6
249+79.7	23.9' LT.	6
252+04.3	35.4' LT.	6
252+16.3	40.4' LT.	6
256+86.1	31.4' RT.	12
256+96.2	29.1' RT.	14
PAGE TOTAL		56

TREE REMOVAL (OVER 15 UNITS DIAMETER) (20100210)		
STATION	OFFSET	UNIT
256+77.9	30.8' RT.	18
PAGE TOTAL		18

TREE PRUNING (OVER 10 INCH DIA) = 8 EACH  
TREE ROOT PRUNING = 8 EACH  
STA. 253+08 RT. TO STA. 254+24 RT.

REMOVE EXISTING PATIO BLOCKS  
BLOCKS TO BE BECOME PROPERTY OF OWNER.  
BLOCK REMOVAL WILL NOT BE PAID FOR SEPARATELY AND SHALL BE INCLUDED IN THE COST OF THE EARTH EXCAVATION.

SEPTIC TANK TO BE PUMPED = 1 EACH  
REMOVE EXISTING SEPTIC TANK = 1 EACH  
SEE SPECIAL PROVISIONS. THE SEPTIC TANK MAY HAVE TO REMAIN IN SERVICE DURING STAGE CONSTRUCTION AND SHOULD NOT BE REMOVED WITHOUT THE APPROVAL OF THE ENGINEER.