

STATION	LEFT E.O.P. OFFSET	LEFT E.O.P. ELEVATION	CENTERLINE P.G.L. ELEVATION	RIGHT E.O.P. ELEVATION	RIGHT E.O.P. OFFSET
252+20.00	27.50	887.22	887.77	887.22	27.50
252+30.00	27.50	887.16	887.71	887.23	27.50
252+40.00	27.50	887.10	887.65	887.24	27.50
252+50.00	27.50	887.04	887.59	887.25	27.50
252+60.00	27.50	886.98	887.53	887.25	27.50
252+70.00	27.50	886.92	887.47	887.26	27.50
252+80.00	27.50	886.86	887.41	887.27	27.50
252+90.00	27.50	886.80	887.35	887.28	27.50
253+00.00	27.50	886.74	887.29	887.29	27.50
253+10.00	27.50	886.68	887.23	887.30	27.50
253+20.00	27.50	886.62	887.17	887.31	27.50
253+30.00	27.50	886.56	887.11	887.32	27.50
253+40.00	27.50	886.50	887.05	887.32	27.50
253+50.00	27.50	886.44	886.99	887.26	27.50
253+75.00	27.50	886.29	886.84	887.12	27.50
254+00.00	27.50	886.14	886.69	886.97	27.50
254+25.00	27.50	885.99	886.54	886.82	27.50
254+50.00	27.50	885.84	886.39	886.67	27.50
254+75.00	27.50	885.69	886.24	886.51	27.50
255+00.00	27.50	885.54	886.09	886.36	27.50
255+25.00	27.50	885.41	885.96	886.24	27.50
255+50.00	27.50	885.36	885.91	886.18	27.50
255+75.00	27.50	885.37	885.92	886.20	27.50
256+00.00	27.50	885.46	886.01	886.28	27.50
256+25.00	27.50	885.62	886.17	886.44	27.50
256+50.00	27.50	885.85	886.40	886.67	27.50
256+75.00	27.50	886.12	886.67	886.95	27.50
257+00.00	27.50	886.40	886.95	887.23	27.50
257+25.00	27.50	886.68	887.23	887.51	27.50
257+50.00	27.50	886.96	887.51	887.79	27.50
257+75.00	27.50	887.24	887.79	888.07	27.50
258+00.00	27.50	887.52	888.07	888.34	27.50
258+25.00	27.50	887.80	888.35	888.62	27.50
258+50.00	27.50	888.09	888.63	888.90	27.50
258+75.00	27.50	888.36	888.91	889.18	27.50
259+00.00	27.50	888.64	889.19	889.46	27.50
259+25.00	27.50	888.92	889.47	889.74	27.50
259+50.00	27.50	889.20	889.75	890.02	27.50
259+75.00	27.50	889.39	889.94	890.22	27.50
260+00.00	27.50	889.50	890.05	890.32	27.50
260+25.00	27.50	889.51	890.06	890.33	27.50
260+50.00	27.50	889.42	889.97	890.24	27.50
260+75.00	27.50	889.25	889.80	890.08	27.50
261+00.00	27.50	888.98	889.53	889.81	27.50
261+25.00	27.50	888.67	889.22	889.49	27.50
261+50.00	27.50	888.40	888.95	889.22	27.50
261+75.00	27.50	888.25	888.80	889.07	27.50
262+00.00	27.50	888.21	888.76	889.04	27.50
262+10.00	27.50	888.24	888.76	889.04	27.50
262+20.00	27.50	888.33	888.78	889.06	27.50
262+30.00	27.50	888.43	888.81	889.08	27.50
262+40.00	27.50	888.55	888.86	889.14	27.50
262+50.00	27.50	888.69	888.93	889.20	27.50
262+55.04	27.50	888.84	889.01	889.28	27.50
262+55.04	27.50	888.92	889.06	889.34	27.50

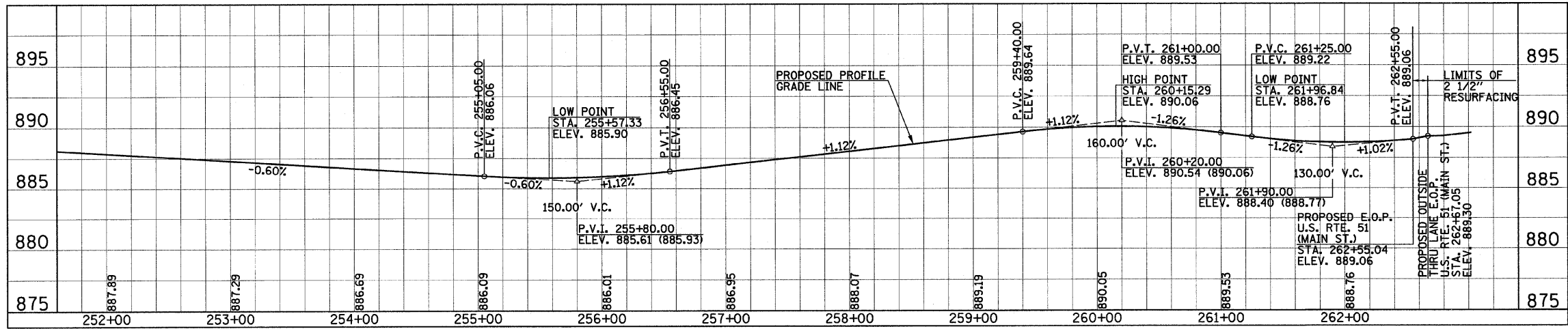

HAMILTON ROAD CENTERLINE PROFILE
SCALE: 1"=50' HOR.
1"=5' VERT.

SEE PROPOSED TYPICAL SECTION SHEETS, PLAN AND PROFILE SHEETS, AND INTERSECTION DETAIL SHEETS FOR ADDITIONAL INFORMATION.

ILLINOIS DEPARTMENT OF TRANSPORTATION
SUPERELEVATION TRANSITION TABLES

SCALE: NONE
DATE: 6-09
DRAWN BY: J.L.B.
CHECKED BY: R.L.H.