

ROUTE NO.	SECTION	COUNTY	TOTAL SHEETS	SHEET NO.
C.H. 3	07-00188-00-BR	WHITESIDE	32	15
		ILLINOIS		

Sheet 10 of 22 Contract No. 85465

Notes:

See sheet 11 of 22 for Sections B-B & C-C.
 See sheet 12 of 22 for Railing & Railing Connection Details.
 a(E), a₄(E), and w(E) bar spacings measured perpendicular to \varnothing Rdwy.

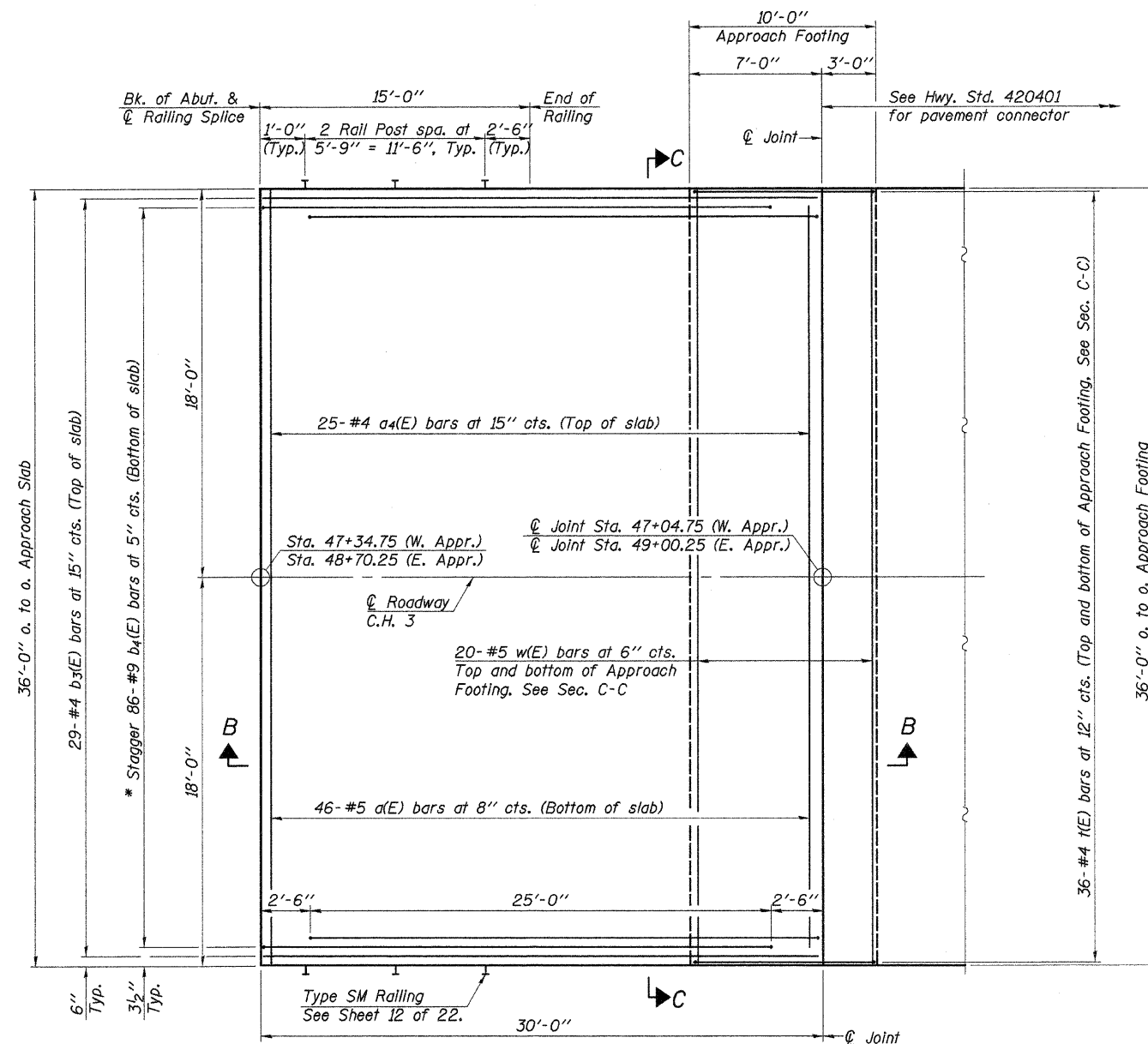

PLAN

* Tilt #9 b₄(E) bars as required to maintain clearance.

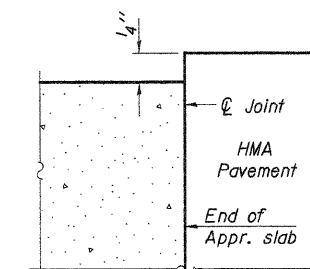

DETAIL A

DESIGNED -	A.R.K.
CHECKED -	A.L.S.
DRAWN -	S.A.P.
CHECKED -	A.R.K. & A.L.S.

BA-0

10-31-08

4440 ASH GROVE
 SPRINGFIELD, IL 62711
 (217) 793-8600
 www.fehr-graham.com

FEHR-GRAHAM & ASSOCIATES, LLC
 ENGINEERING AND SCIENCE CONSULTANTS
 FREDERICK, MICHIGAN, & ROSELLE, ILLINOIS, SPRINGFIELD, ILLINOIS

JOB NO.: 47515
 FILE: APRCH-DTL.DGN
 DATE: 08/17/09

BRIDGE APPROACH SLAB DETAILS
 SECTION 07-00188-00-BR
 COUNTY HIGHWAY 3
 WHITESIDE COUNTY
 STA. 48+02.50