

STATE OF ILLINOIS  
DEPARTMENT OF TRANSPORTATION

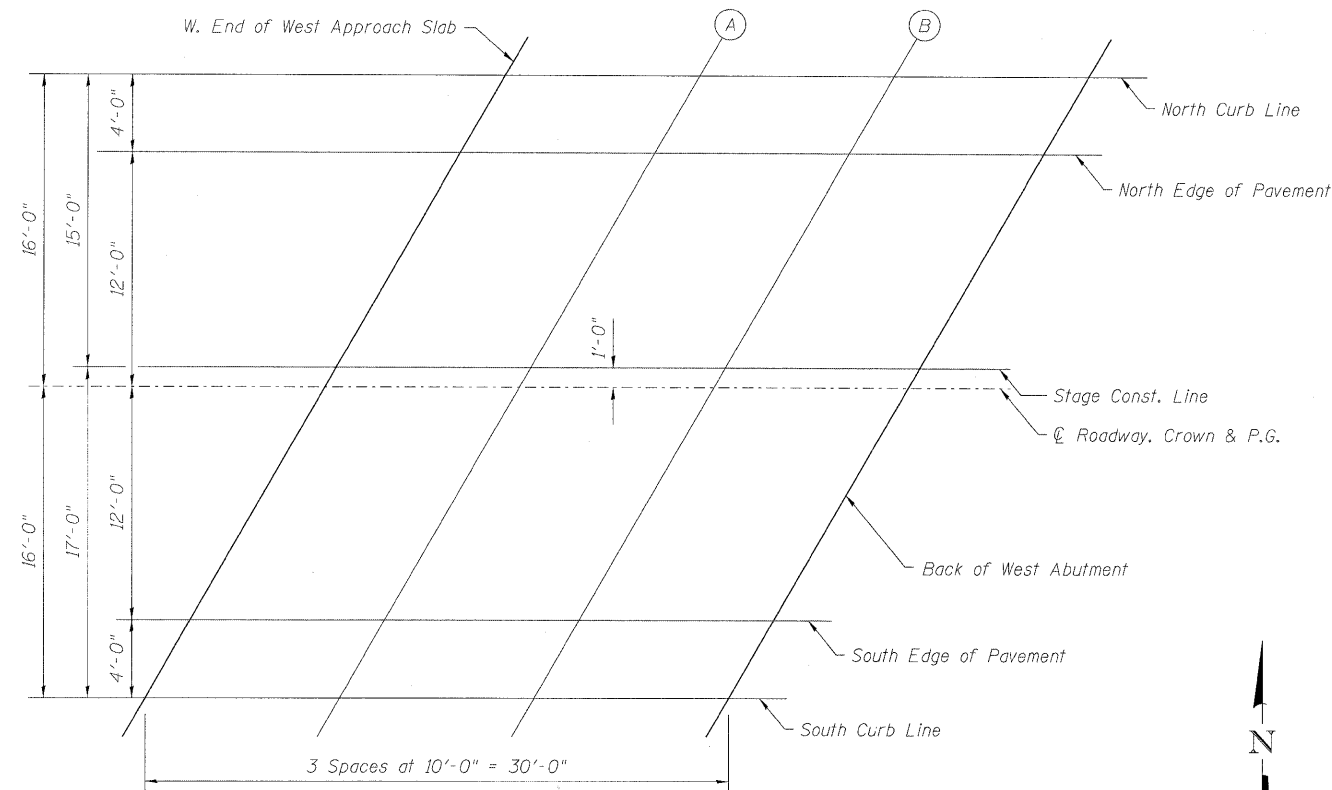

PLAN - WEST APPROACH

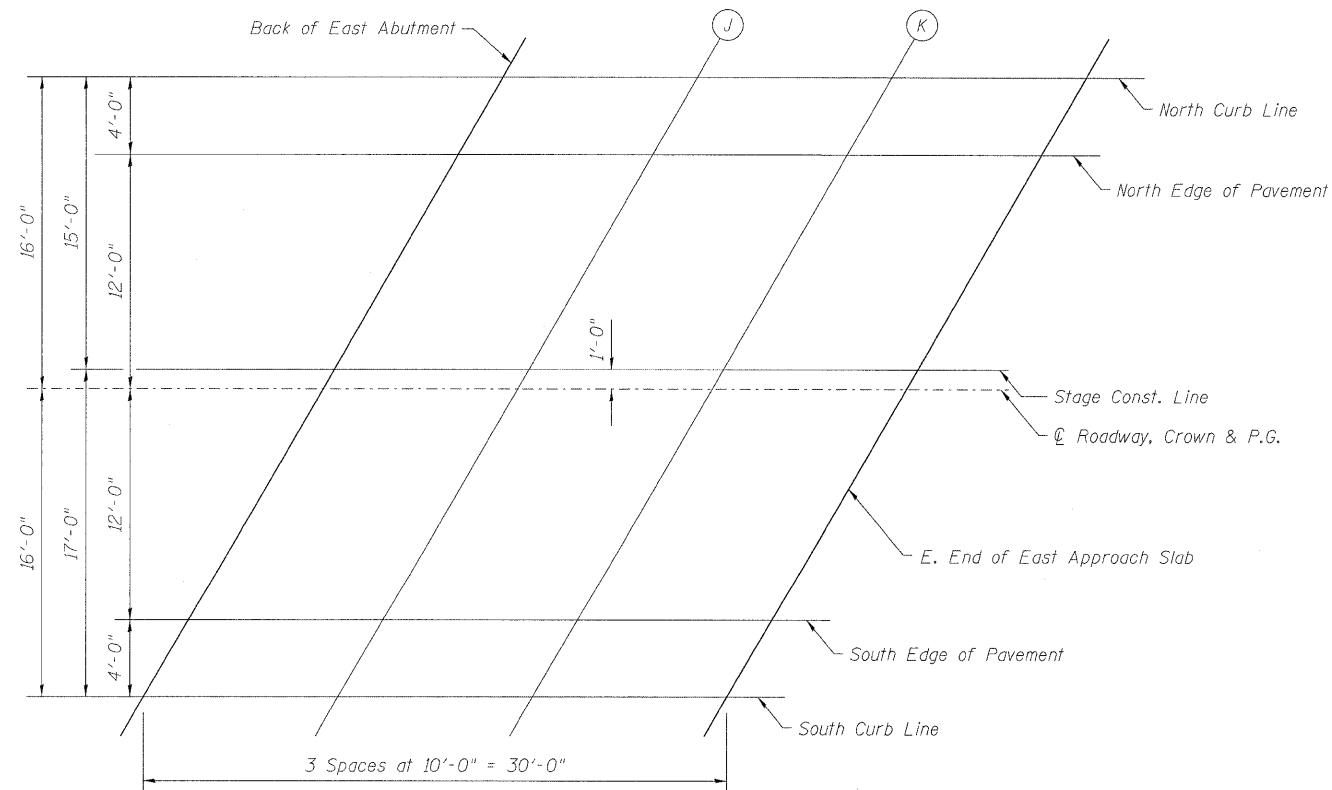

PLAN - EAST APPROACH

NORTH CURB LINE

Location	Station	Offset (ft)	Theoretical Grade Elevations
End W. Appr. Slab	239+21.74	-16.00	392.55
A	239+31.74	-16.00	392.60
B	239+41.74	-16.00	392.63
Bk. W. Abut.	239+51.74	-16.00	392.66
Bk. E. Abut.	240+36.74	-16.00	392.63
J	240+46.74	-16.00	392.59
K	240+56.74	-16.00	392.55
End E. Appr. Slab	240+66.74	-16.00	392.51

ROADWAY, CROWN & P.G.

Location	Station	Offset (ft)	Theoretical Grade Elevations
End W. Appr. Slab	239+12.50	0.00	392.78
A	239+22.50	0.00	392.83
B	239+32.50	0.00	392.87
Bk. W. Abut.	239+42.50	0.00	392.90
Bk. E. Abut.	240+27.50	0.00	392.92
J	240+37.50	0.00	392.90
K	240+47.50	0.00	392.86
End E. Appr. Slab	240+57.50	0.00	392.82

NORTH EDGE OF PAVEMENT

Location	Station	Offset (ft)	Theoretical Grade Elevations
End W. Appr. Slab	239+19.43	-12.00	392.63
A	239+29.43	-12.00	392.67
B	239+39.43	-12.00	392.71
Bk. W. Abut.	239+49.43	-12.00	392.74
Bk. E. Abut.	240+34.43	-12.00	392.72
J	240+44.43	-12.00	392.68
K	240+54.43	-12.00	392.64
End E. Appr. Slab	240+64.43	-12.00	392.60

SOUTH EDGE OF PAVEMENT

Location	Station	Offset (ft)	Theoretical Grade Elevations
End W. Appr. Slab	239+05.57	12.00	392.56
A	239+15.57	12.00	392.61
B	239+25.57	12.00	392.65
Bk. W. Abut.	239+35.57	12.00	392.69
Bk. E. Abut.	240+20.57	12.00	392.75
J	240+30.57	12.00	392.73
K	240+40.57	12.00	392.70
End E. Appr. Slab	240+50.57	12.00	392.66

STAGE CONSTRUCTION LINE

Location	Station	Offset (ft)	Theoretical Grade Elevations
End W. Appr. Slab	239+13.08	-1.00	392.77
A	239+23.08	-1.00	392.82
B	239+33.08	-1.00	392.86
Bk. W. Abut.	239+43.08	-1.00	392.89
Bk. E. Abut.	240+28.08	-1.00	392.91
J	240+38.08	-1.00	392.88
K	240+48.08	-1.00	392.84
End E. Appr. Slab	240+58.08	-1.00	392.80

SOUTH CURB LINE

Location	Station	Offset (ft)	Theoretical Grade Elevations
End W. Appr. Slab	239+03.26	16.00	392.47
A	239+13.26	16.00	392.51
B	239+23.26	16.00	392.56
Bk. W. Abut.	239+33.26	16.00	392.60
Bk. E. Abut.	240+18.26	16.00	392.67
J	240+28.26	16.00	392.65
K	240+38.26	16.00	392.62
End E. Appr. Slab	240+48.26	16.00	392.59

APPROACH SLAB ELEVATIONS  
STRUCTURE NO. 097-0073

<p>LIN ENGINEERING, LTD. Consulting Engineers Chatham, Illinois</p>	SHEET NO. 6  17 SHEETS	F.A.P. RTE.	SECTION	COUNTY	TOTAL SHEETS	SHEET NO.
		877	101B-1	WHITE	42	21
		CONTRACT NO. 78084				
		FED. ROAD DIST. NO. ILLINOIS FED. AID PROJECT				