

STATE OF ILLINOIS
DEPARTMENT OF PUBLIC WORKS & BUILDINGS
DIVISION OF HIGHWAYS

| NO. | DATE | BY | REVISION |
|-----|----------|----------|----------|
| 55 | 04-24-02 | Sangamon | 24 |
| 55 | 04-24-02 | Sangamon | 24 |
| 55 | 04-24-02 | Sangamon | 24 |

SHEET 5 OF 13

2004
Risks

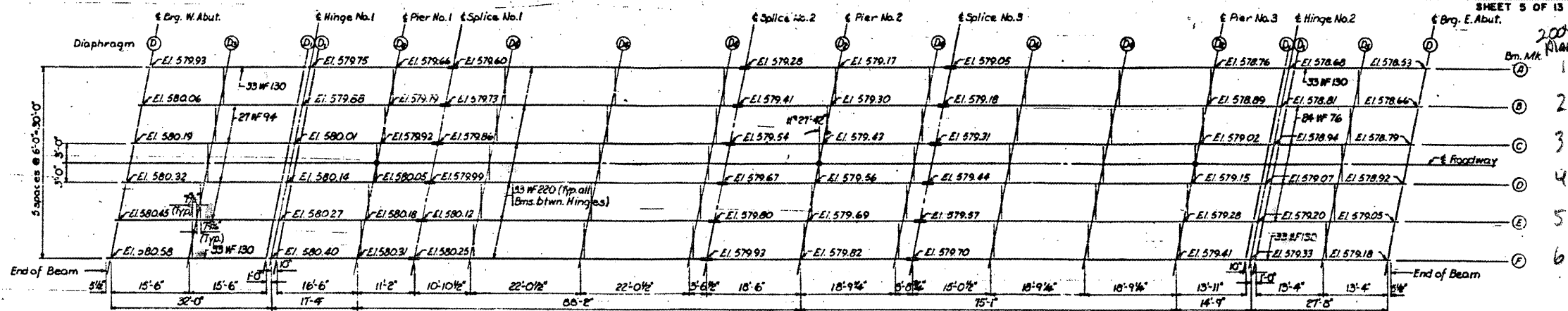

FRAMING PLAN-NORTH BRIDGE

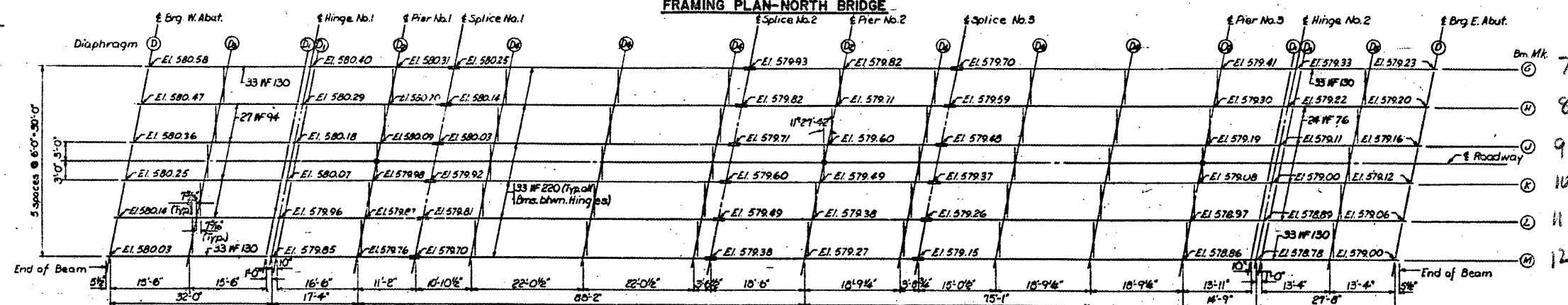

FRAMING PLAN-SOUTH BRIDGE

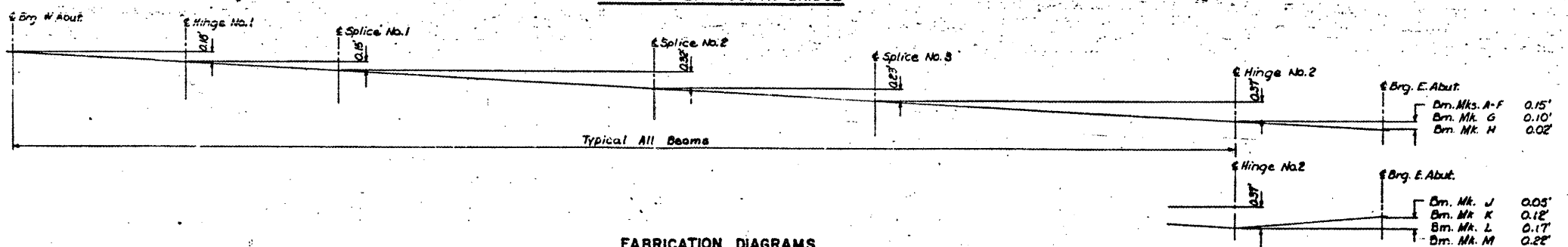

FABRICATION DIAGRAMS

STRUCTURAL STEEL
E. LAKE SHORE DRIVE OVER F.A.I. RT. 55

F.A.I. ROUTE 55 SECTION 84-3HB-2-F
SANGAMON COUNTY
STATION 172+01.81

| | | | |
|----------|--------|----------|--|
| DESIGNED | JFC | EXAMINED | |
| CHECKED | JLR | PASSED | |
| DRAWN | JFC | APPROVED | |
| CHECKED | V.F.S. | | |

Note: All elevations shown are given at the top of the top flange of the beams & Brg. or Splice and are to be used for fabrication of structural steel. Deflection is not included. Work this sheet with Sheet 6 of 13.

FOR INFORMATION ONLY

EXISTING PLANS SN084-0082,0083
FAI 55 (I-55)
D-6 REHAB BDGE PAINTING 2010
SANGAMON COUNTY