

ROUTE NO.	SECTION	COUNTY	TOTAL SHEETS	SHEET NO.
7998	(**)	SANGAMON	264	214
ILLINOIS PROJECT				
FED. ROAD DIST. NO. 7				SHEET 3 OF 30
(**) D-6 RESURF 2004, (84-3HB-2)BR				

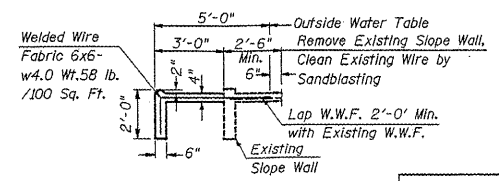
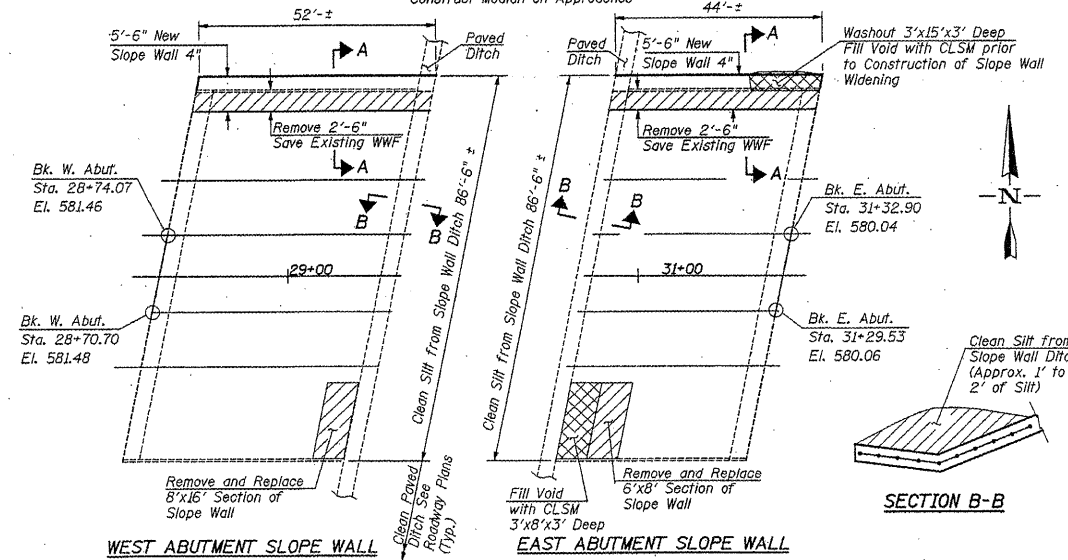
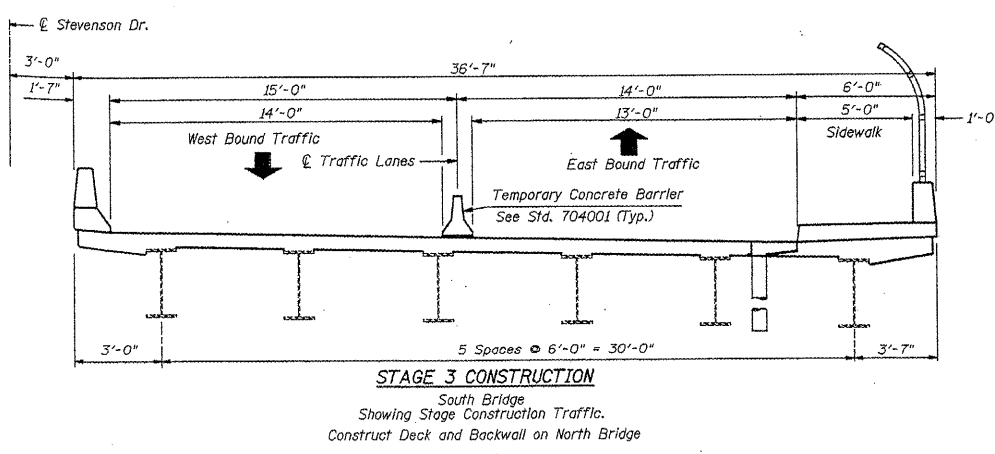
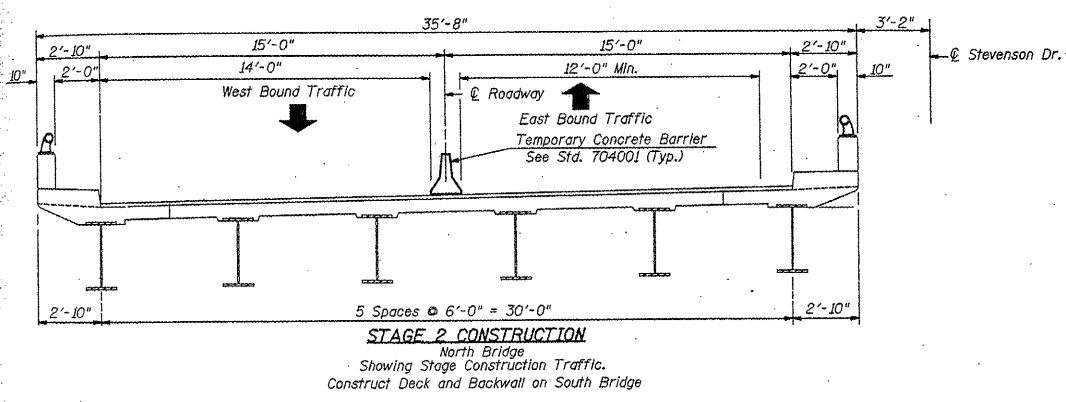
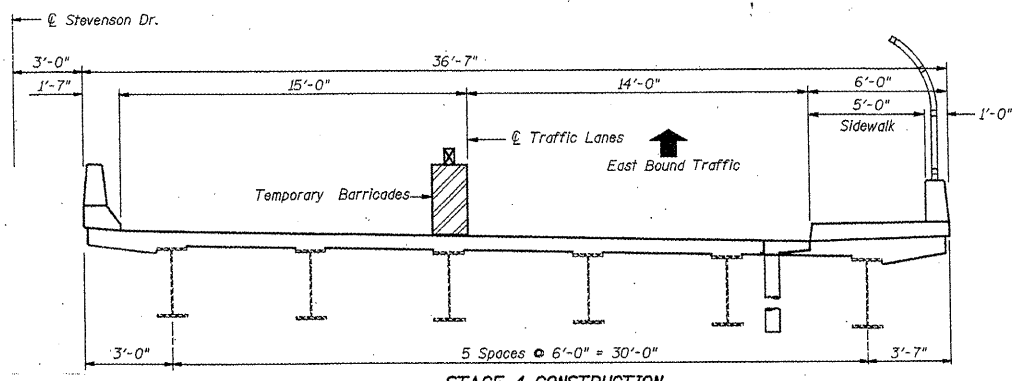
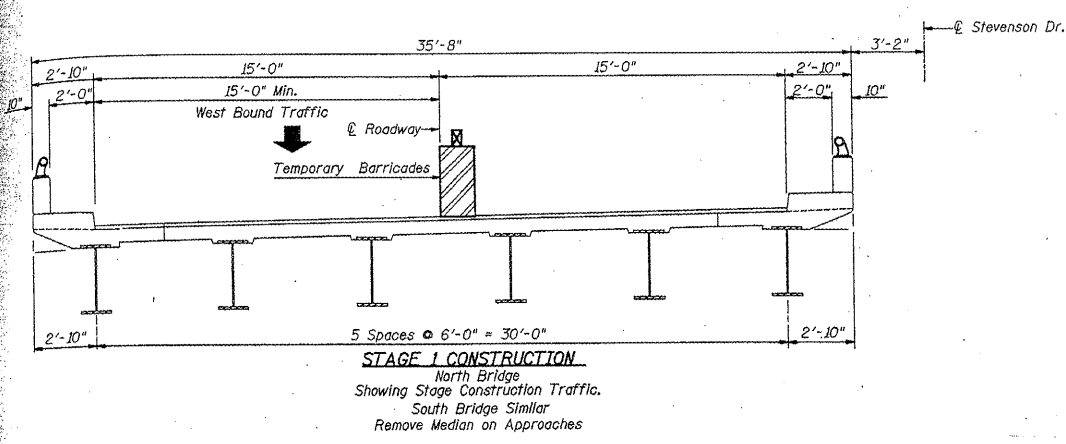

NOTE:  
Slope wall repair quantities are based on visual inspections performed in Nov. 2003 and are for estimating purposes only. Final location and quantities will be determined by the Engineer in the field.

ITEM	UNIT	QUANTITY
Slope Wall Repair	Sq. Yd.	20
Slope Wall 4 Inch	Sq. Yd.	59
Clean Slope Wall Ditch	Foot	173
Controlled Low-Strength Material	Cu. Yd.	8

**STAGE CONSTRUCTION DETAILS**  
F.A.U. RTE. 7998 STEVENSON DR.  
OVER F.A.I. RTE. 55  
SECTION 84-3HB-2  
SANGAMON COUNTY  
S.N. 084-0082 & S.N. 084-0083  
STA. 30+11.66

<b>ie</b> INTERNATIONAL ENGINEERING CONSULTANTS, INC.			
8420 SOUTH SIXTH STREET, SPRINGFIELD, ILLINOIS 62707			
TEL. (217) 528-8027 FAX. (217) 528-4643			
WWW.IE-CONSULTANTS.COM			
DRAWN BY: TRF	CHECKED BY: DRB	DATE: 3-29-04	PROJECT: S03046

FOR INFORMATION ONLY

EXISTING PLANS SN084-0082,0083  
FAI 55 (I-55)  
D-6 REHAB BDGE PAINTING 2010  
SANGAMON COUNTY