

**NOTES:**

1. MAINLINE RESURFACING, 1 3/4" INCLUDES: 1 3/4" POLYMERIZED HOT-MIX ASPHALT SURFACE COURSE, MIX "D", N105
2. POLYMERIZED LEVELING BINDER (MACHINE METHOD), N90 (3/4" MIN. VARIABLE DEPTH) (AS NECESSARY)
3. SHOULDER RESURFACING, 1 3/4" INCLUDES: 1 3/4" HOT-MIX ASPHALT SURFACE COURSE, MIX "C", N50
- 3A. SHOULDER RESURFACING, 1 3/4" INCLUDES: 1 3/4" POLYMERIZED HOT-MIX ASPHALT SURFACE COURSE, MIX "D", N105
4. FULL-DEPTH HOT-MIX ASPHALT SHOULDERS, 12" INCLUDES: 1 3/4" HOT-MIX ASPHALT SURFACE COURSE, MIX "C", N50 10 1/4" HOT-MIX ASPHALT BINDER COURSE, IL-19.0, N50 6" AGGREGATE BASE COURSE, TYPE A
- 4A. FULL-DEPTH HOT-MIX ASPHALT SHOULDERS, 12" INCLUDES: 1 3/4" POLYMERIZED HOT-MIX ASPHALT SURFACE COURSE, MIX "D", N105 10 1/4" HOT-MIX ASPHALT BINDER COURSE, IL-19.0, N90 6" AGGREGATE BASE COURSE, TYPE A
5. SEE ROADWAY DETAILS SHEET FOR TABLE OF STATIONS/OFFSETS

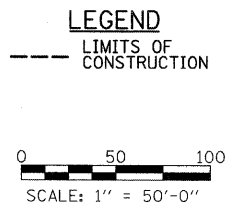
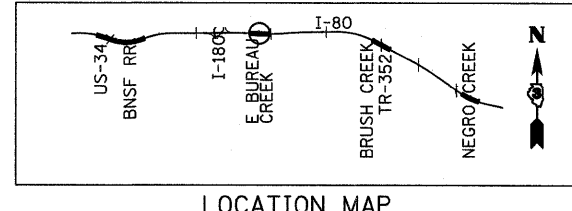
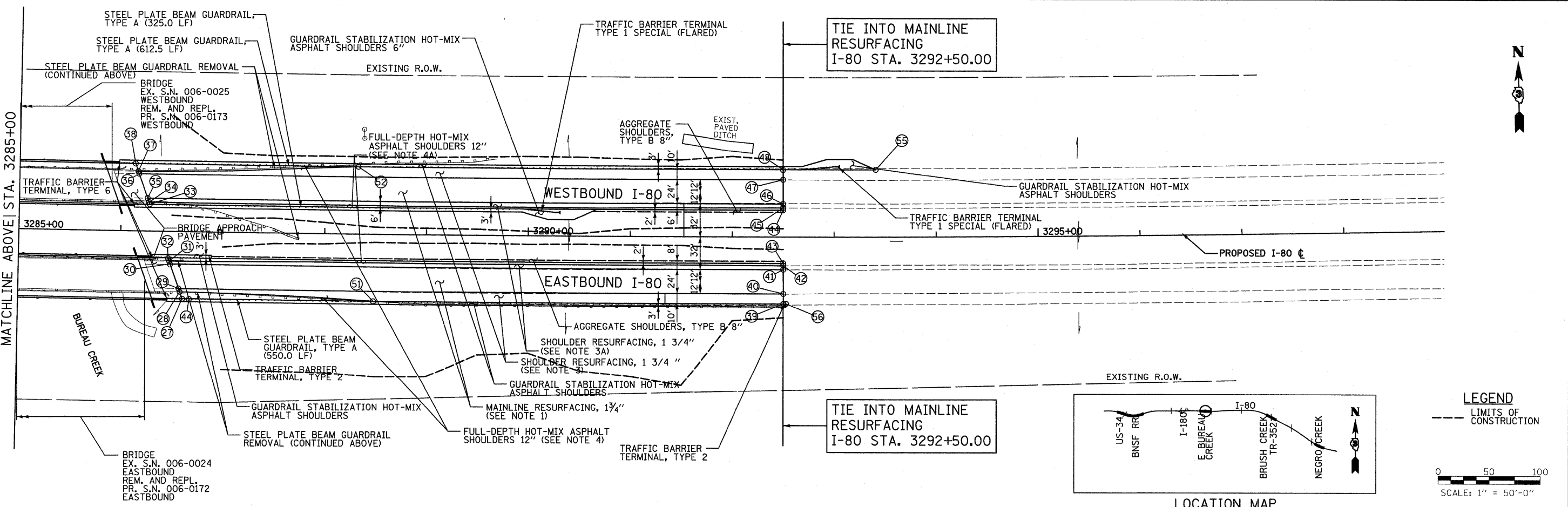
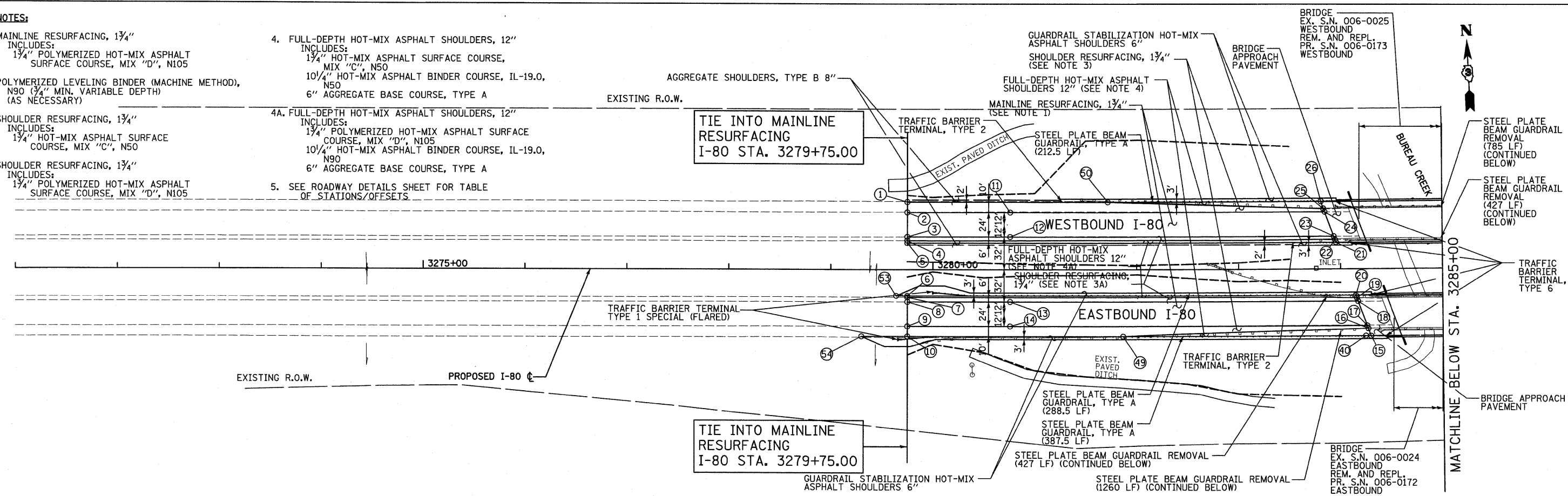

<b>TYLIN INTERNATIONAL</b>	USER NAME = #USER#	DESIGNED - CAC	REVISED -
	PLOT SCALE = #SCALE#	DRAWN - CAC	REVISED -
	PLOT DATE = 8/14/2009	CHECKED - JDF	REVISED -
		DATE - 08/14/2009	REVISED -

**STATE OF ILLINOIS  
DEPARTMENT OF TRANSPORTATION**

<b>F.A.I. ROUTE 80 (I-80) PROPOSED PLANS</b>	
SCALE: 1" = 50'	SHEET NO. 1 OF 1 SHEET
STA. 3279+75 TO STA. 3292+50	

F.A.I. RTE. 80	SECTION	COUNTY	TOTAL SHEETS NO.	SHEET NO.
		BUREAU	344	45
CONTRACT NO. 66908				
FED. ROAD DIST. NO. [ILLINOIS] FED. AID PROJECT				
• 06-17BR & BR-1,7VB-M, 6BR & 6, 7 RS-1 & I				