

STATE OF ILLINOIS  
DEPARTMENT OF TRANSPORTATION

ROUTE NO.	SECTION	COUNTY	TOTAL SHEETS	SHEET NO.
IL 84	(1,2)B-2M	HENRY and ROCK ISLAND	23	22
FED. ROAD DIST. NO. 7	ILLINOIS	FED. AID PROJECT-	CONTRACT 64E18	

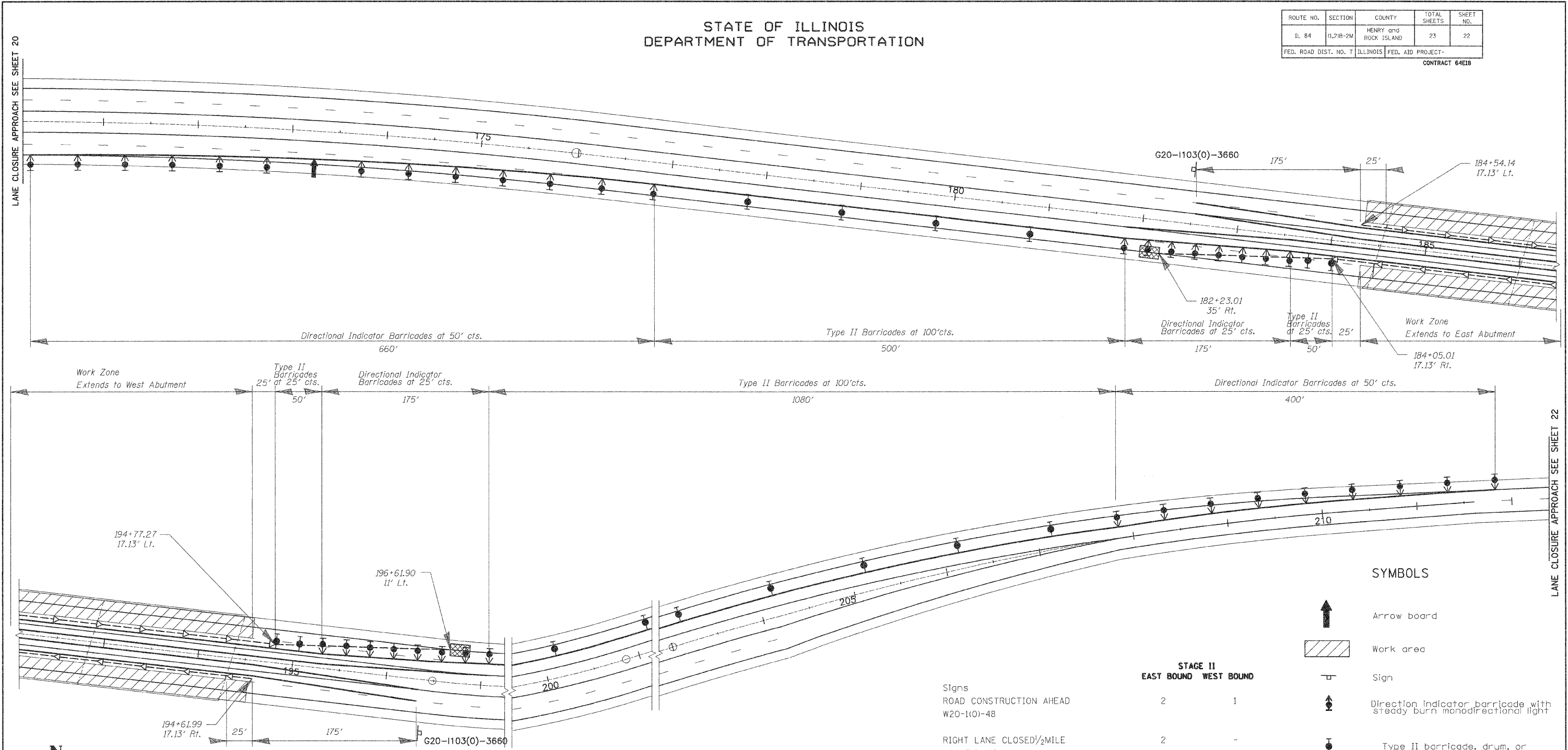

SUMMARY OF QUANTITIES TRAFFIC CONTROL AND PROTECTION

	STAGE I I	
	EAST BOUND	WEST BOUND
Arrow board	2	-
Direction indicator barricade with steady burn monodirectional light	21	17
Type II barricade with steady burn monodirectional light	6	11
Relocate Impact attenuator	1	1
Relocate Temporary concrete barrier	1300'	1300'

DESIGNED	M.H.
CHECKED	P.B.
DRAWN	C.L.
CHECKED	M.H./P.B.

Signs	STAGE II	
	EAST BOUND	WEST BOUND
ROAD CONSTRUCTION AHEAD W20-1(O)-48	2	1
RIGHT LANE CLOSED 1/2 MILE W20-5(O)-48	2	-
W4-2R(O)-48 (lane ends)	1	-
W1-4R(O)-48 or STAY IN YOUR LANE	-	1
WORK ZONE W2-1115(O)-3618	1	1
SPEED LIMIT 55 R2-1-3648	1	1
BEGINS W2-1113(O)-3612	1	1
\$XXX FINE MINIMUM W21-1106(O)-3618	1	1
END WORK ZONE SPEED LIMIT G20-1103(O)-3660	1	1

**SYMBOLS**

- Arrow board
- Work area
- Sign
- Direction indicator barricade with steady burn monodirectional light
- Type II barricade, drum, or vertical barricade with steady burn monodirectional light
- Temporary concrete barrier
- Type C Monodirectional reflector
- Impact attenuator

**TRAFFIC CONTROL AND PROTECTION**  
STAGE II  
IL ROUTE 84 OVER ROCK RIVER  
FAP ROUTE 595 (IL 84), SECTION (1,2)B-2-M  
HENRY HENRY COUNTIES  
STATION 189+44  
STRUCTURE NO. 037-0128

SCALE: 1" = 50' DATE: Sept. 30, 2009  
Soodan & Associates, Inc.  
100 North LaSalle Street, Suite 1800  
Chicago, Illinois 60602