

GENERAL NOTES

1. TRAFFIC CONTROL SHALL BE ERRECTED AS SHOWN AND ACCORDING TO "TRAFFIC CONTROL AND PROTECTION, STANDARD 701321."
2. SEE SPECIAL PROVISIONS FOR ADDITIONAL TRAFFIC CONTROL REQUIREMENTS.
3. COORDINATE LOCATION OF SIGNALS WITH FINAL WORK AS DIRECTED BY THE ENGINEER.
4. ADDITIONAL SIGNAGE AND BARRICADES SHOWN FOR SIDE-ROADS AND ENTRANCES SHALL BE INCLUDED IN THE COST OF STANDARD 701321.
5. THE DIMENSION SHOWN ON THE WIDTH RESTRICTION SIGN SHOWN ON STANDARD 701321 SHALL BE 10'-6". THE SIGN SHALL FOLLOW DISTRICT STANDARD 39.2.

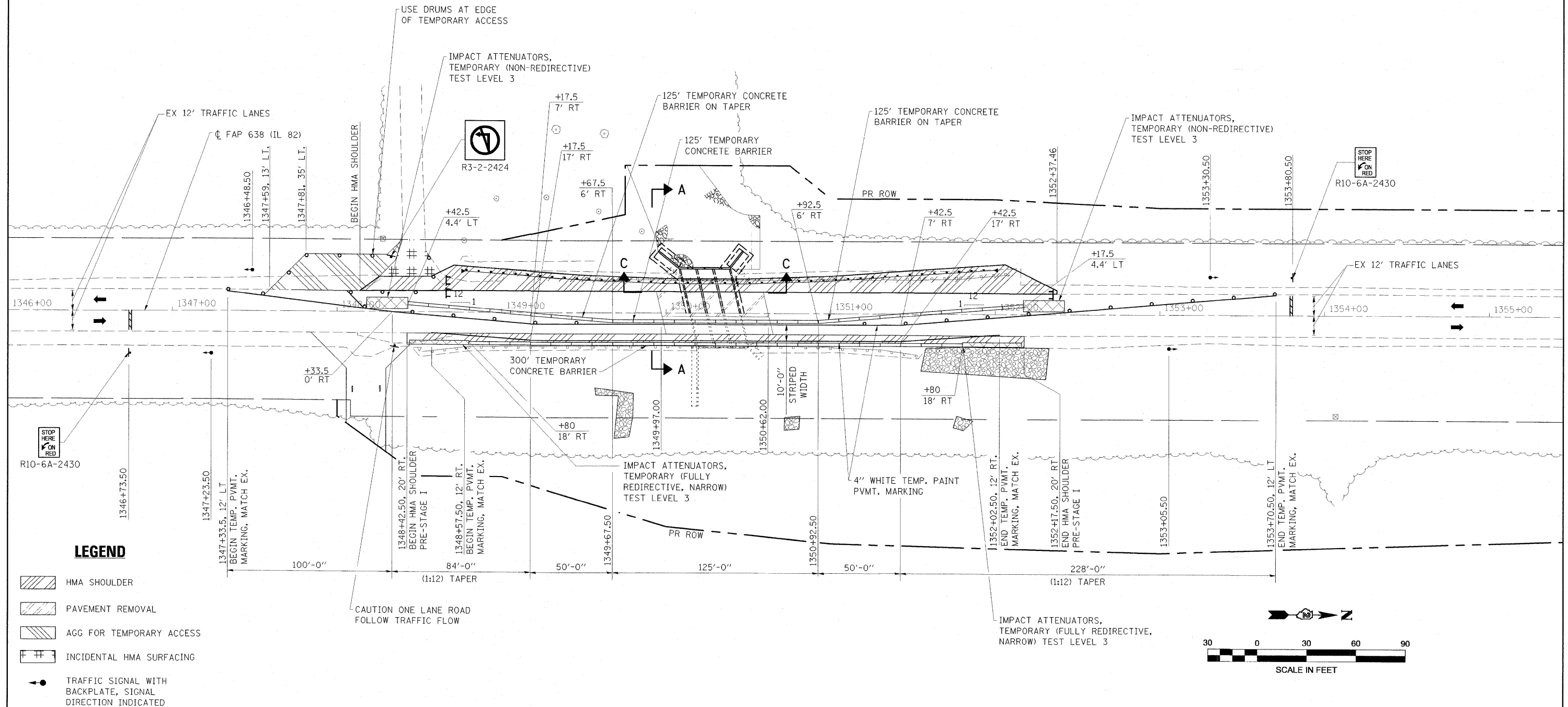

FILE NAME =
D:\254681-shc-staging\01.dgn

USER NAME = HAS
PLOT SCALE = 0.0833" / IN.
PLOT DATE = 9/9/2009 9:47:43 AM

DESIGNED - JMS
DRAWN - KAH
CHECKED - ELH
DATE - 09/08/09

REVISED -
REVISED -
REVISED -
REVISED -

**STATE OF ILLINOIS
DEPARTMENT OF TRANSPORTATION**

STAGE I CONSTRUCTION

SCALE: 1"=30'-0" SHEET NO. 1 OF 1 SHEETS STA. 1346+00 TO STA. 1355+50

F.A.P. RTE. 638	SECTION 129BR	COUNTY HENRY	TOTAL SHEETS 42	SHEET NO. 13
CONTRACT NO. 64A04				
FED. ROAD DIST. NO. ILLINOIS FED. AID PROJECT				