

FINAL SURVEY SURVEYED BY DATE
 SUPPLY PLOTTED BY DATE
 NOTE BOOK NO. DATE
 AREAS CHECKED

ORIGINAL SURVEY SURVEYED BY DATE
 PLOTTED BY DATE
 NOTE BOOK NO. DATE
 AREAS CHECKED

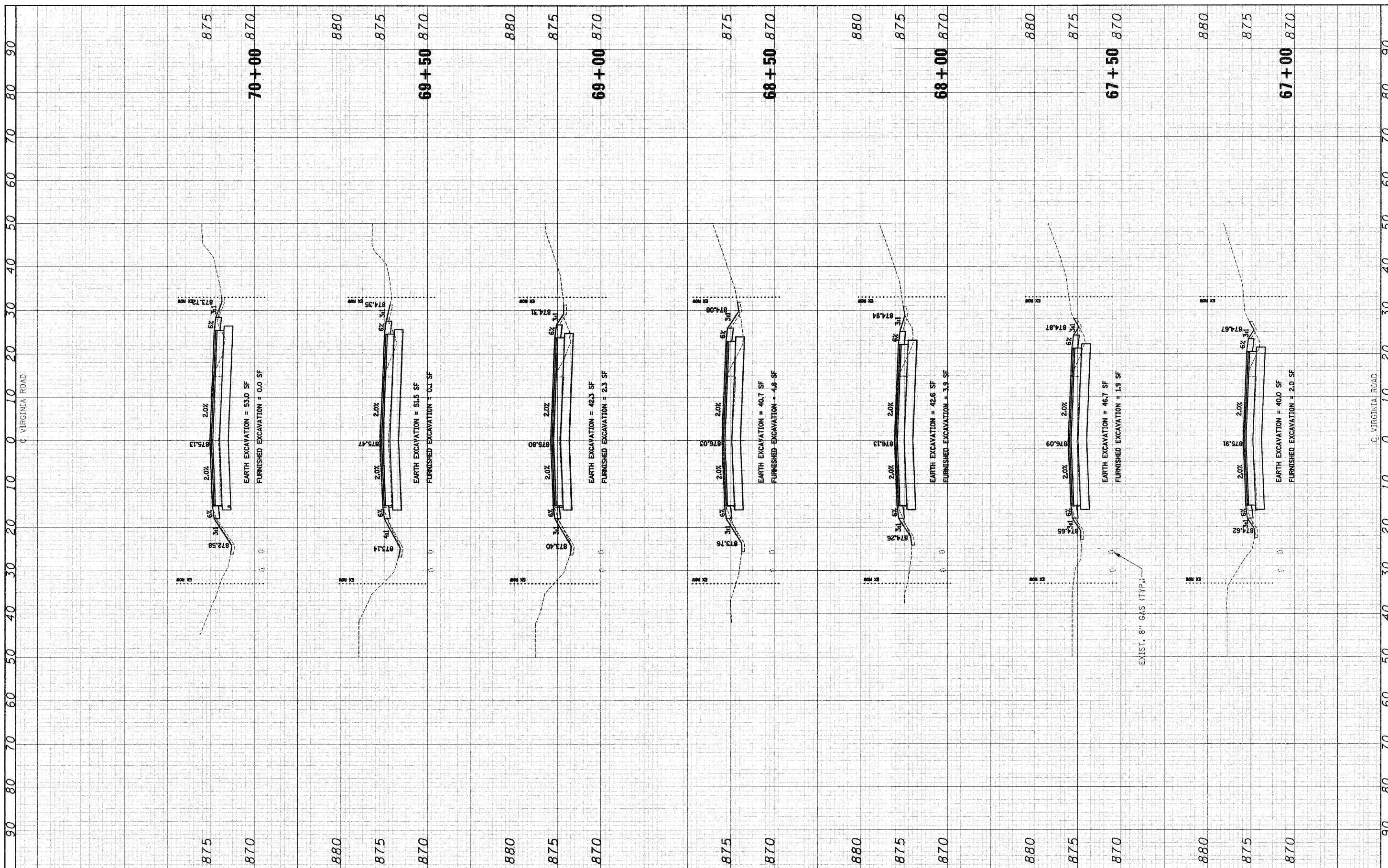

FILE NAME = J:\2211\road\ahoot\2211-sht-x.dgn	USER NAME = ara	DESIGNED - RJD	REVISED -	STATE OF ILLINOIS DEPARTMENT OF TRANSPORTATION	CROSS SECTIONS VIRGINIA ROAD	F.A. RTE. 0121	SECTION 03-00362-00-PV	COUNTY MCHENRY	TOTAL SHEETS 54	SHEET NO. 49		
PLOT SCALE = 1/2"=5'	CHECKED - GAB	DATE - 5-28-09	REVISED -			SCALE: 1"=10'H 1"=5'V	SHEET NO. 11 OF 16 SHEETS	STA. 67+00	TO STA. 70+00	CONTRACT NO. 63195		
PLOT DATE = 9/23/2009	DATE - 5-28-09	REVISED -	REVISED -			FED. ROAD DIST. NO.			ILLINOIS FED. AID PROJECT: M-900312551			