

STATE OF ILLINOIS
DEPARTMENT OF TRANSPORTATION

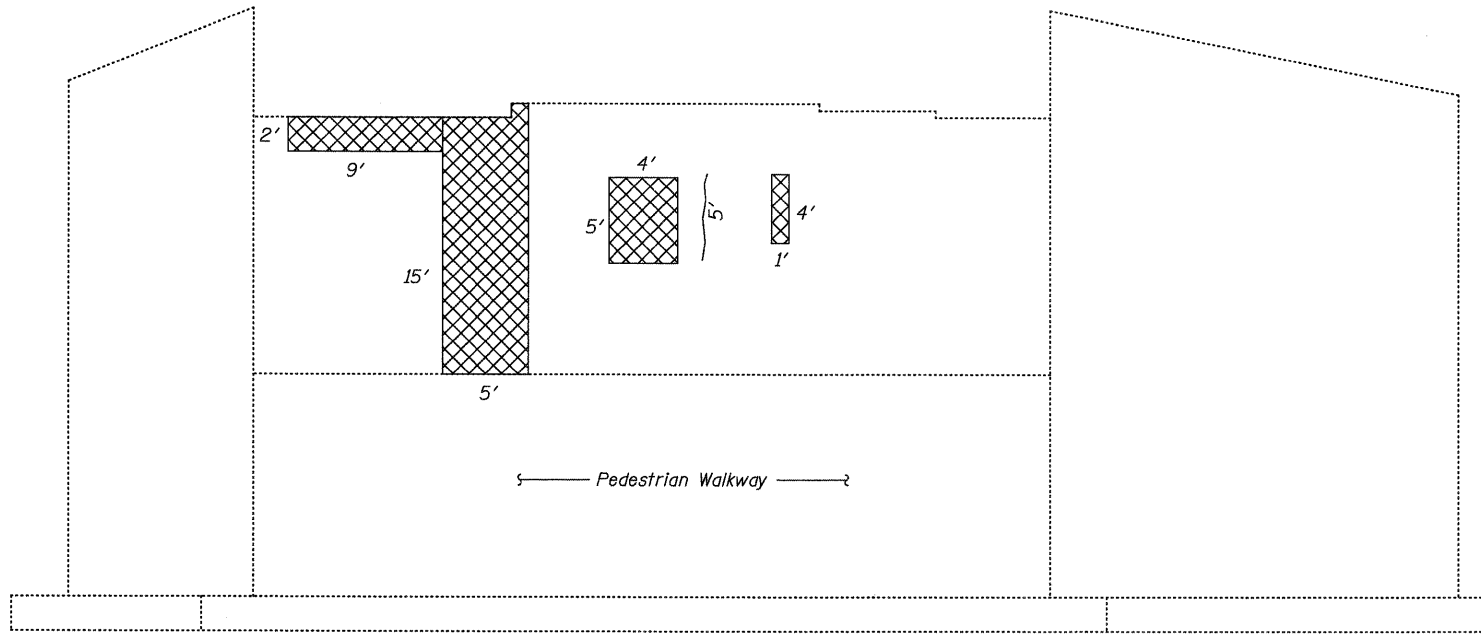

SOUTH ABUTMENT

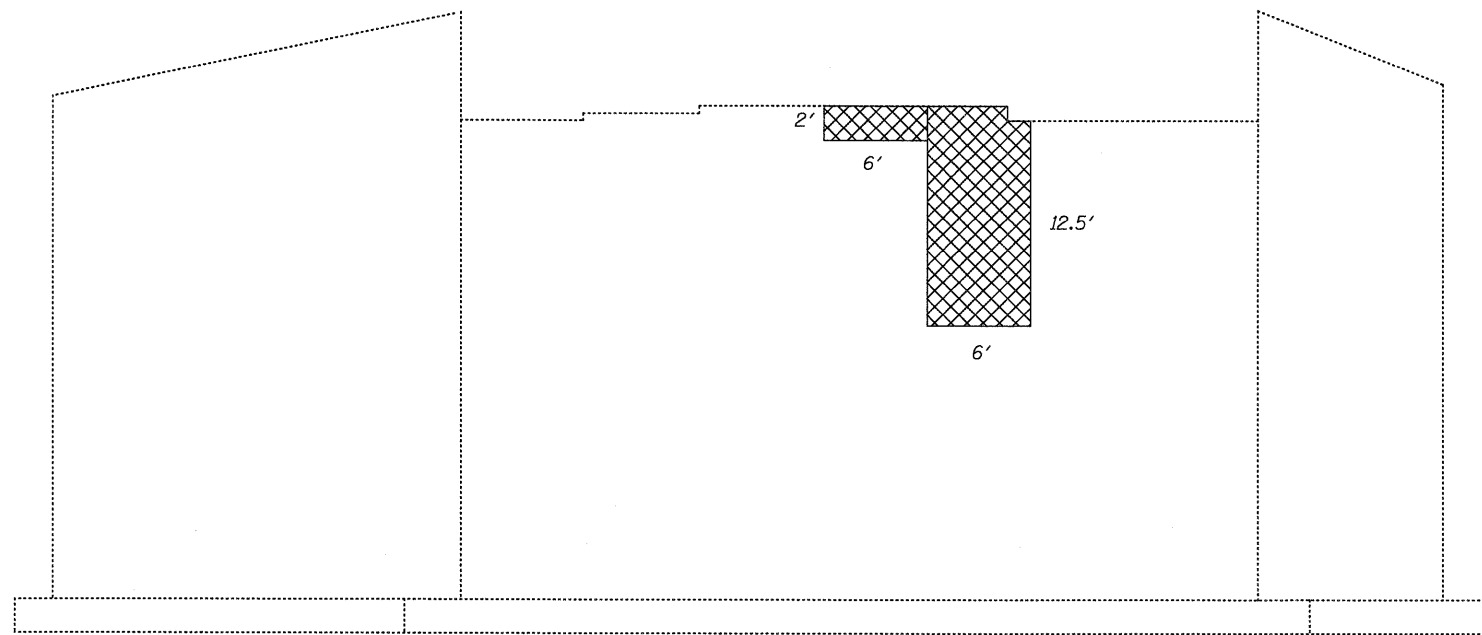

NORTH ABUTMENT

LEGEND

- Structural Repair of Concrete
(Depth equal to or less than 5")
- Epoxy Crack Sealing

ABUTMENT REPAIR DETAILS
INTERSTATE 55 W. FRONTAGE ROAD
OVER I & M CANAL & STATE TRAIL
F.A.I. ROUTE 55 - SECTION 86B-3-R
WILL COUNTY
STRUCTURE NO. 099-0036
PUBLIC WATERS

DESIGNED - SDS
CHECKED - CWC
DRAWN - DLH
CHECKED - SDS/CEH

WHKS & CO.
ENGINEERING

7018 KINGSMILL CT.,
SPRINGFIELD, IL
(217) 483-9457
DESIGN FIRM #184001036

SHEET NO. 16	F.A.I. RTE.	SECTION	COUNTY	TOTAL SHEETS	SHEET NO.
	55	86B-3-R	WILL	38	29
17 SHEETS	S.N. 099-0036		CONTRACT NO. 60F53		
FED. ROAD DIST. NO.		ILLINOIS	FED. AID PROJECT		