

NOTE:
FOR DETAILS OF RAIL ELEMENTS, RAIL SPLICING, NUT, BOLT AND SIDE VIEW
OF RAIL, SEE STANDARD 630001

ALL WELDS SHALL BE GROUND SMOOTH

POSTS SHALL BE CUT AND WELDED TO THE BASE PLATE SO THAT THE POST WILL BE
PLUMB WHEN ERECTED.

TWO PERCENT (2%) OF ALL ANCHOR BOLTS SHALL BE TEST LOADED IN PLACE,
MINIMUM TEST LOAD=8 KIPS. IF ONE ANCHOR BOLT FAILS DURING THE TEST,
TWO OTHER ANCHOR BOLTS SHALL BE TESTED. TESTING EQUIPMENT SHALL BE
BOLT COMPANIES.

PROVIDE 1/8" AND 2/16" GALVANIZED SHIMS FOR 25% OF THE POSTS.

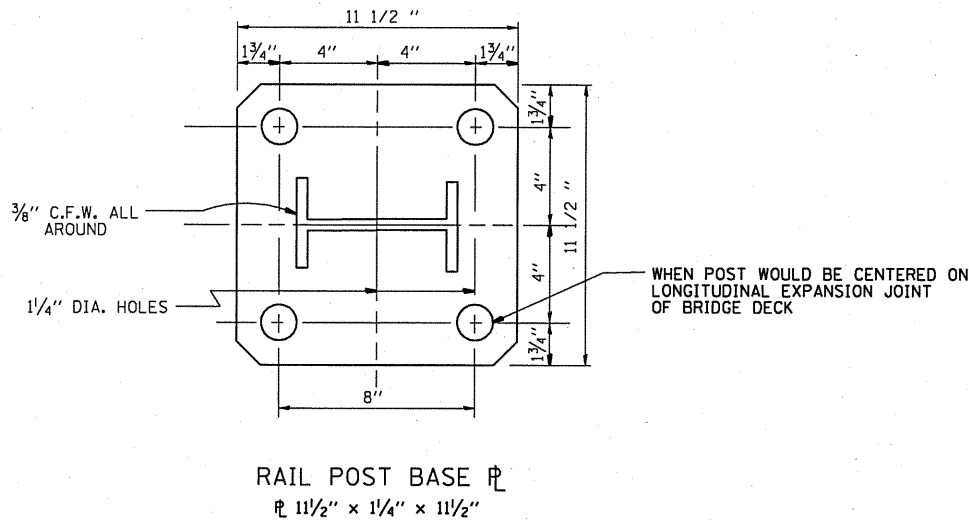

NOTE:
ALL WELDS SHALL BE GROUND SMOOTH. POSTS
SHALL BE CUT AND WELDED TO THE TO THE
BASE PLATE SO THAT THE POSTS WILL BE PLUMB
WHEN ERECTED.

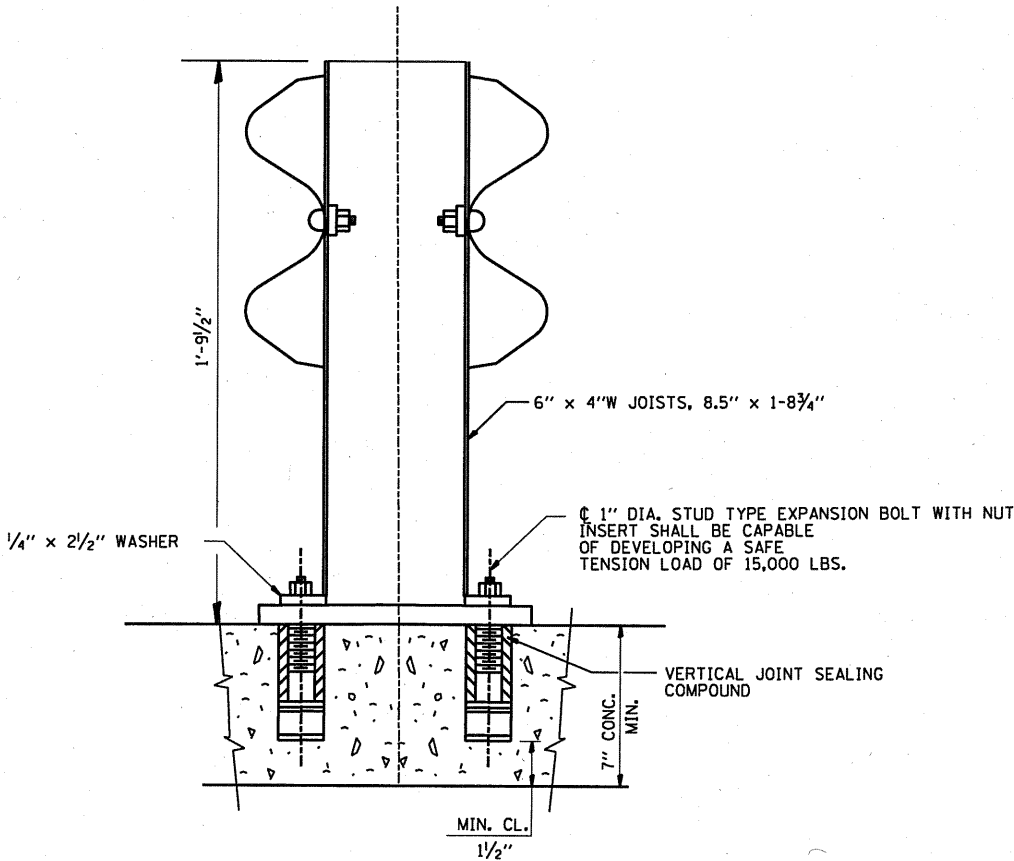

FILE NAME =	USER NAME = midyja	DESIGNED -	REVISED -	STATE OF ILLINOIS DEPARTMENT OF TRANSPORTATION	ANCHOR DETAIL FOR STEEL PLATE BEAM RAIL ON CONCRETE					F.A. RTE.	SECTION	COUNTY	TOTAL SHEETS	SHEET NO.
c:\pv_work\pwsdot\midyja\0213106\Design\		DRAWN -	REVISED -							VAR	2010-058 GRR	VARIOUS	21	10
		CHECKED -	REVISED -		CONTRACT NO. 60L36									
		PLOT SCALE = 103.1216 ' / IN.	REVISED -											
		PLOT DATE = 8/27/2010	REVISED -											
				SCALE:	SHEET NO.	OF	SHEETS	STA.	TO STA.	FED. ROAD DIST. NO. ILLINOIS FED. AID PROJECT				