

INDEX TO SHEETS

SECTION 104-A

Sheet No.	Title Page
1	Standard Cross Section 1250.
2	Special Rock Section for Future Gutter, Type B.
3	Schedule of Culverts for Future Gutter.
4	Special Cross Sections and Location of Borrow Pits.
5	Plan and Profile Sta. 2+72 to Sta. 15+00.
6	15+00 - 45+00.
7	45+00 - 75+00.
8	75+00 - 105+00.
9	105+00 - 135+00.
10	135+00 - 165+00.
11	165+00 - (165+00)A.
12	(165+00)A - 195+00.
13	195+00 - 225+00.
14	225+00 - 255+00.
15	255+00 - 285+00.
16	285+00 - 300+56.
17-60	Inclusive - Cross Sections.
61	Standard Culvert Design No. 828-1; 828-5; 1204-3
62	Special Culvert Design Sta. 14+90
63	16+34; 20+75; 24+58; 38+00.
64	82+02; 94+23; 117+51; 125+09
65	138+36; 146+82; 150+30; 154+07
66	172+30;
67	173+95; 184+52; (174+00)A; 170+10
68	195+73; 202+24; 233+28; 237+75
69	253+10; 279+20; 266+50; 266+50
70	293+69; 299+20.
71	Standard No. 935.
72	862.

SECTIONS 104-B&C

Title Page
Plan and Profile Sta. 135+00 to Sta. 165+00
225+00 - 255+00
255+00 - 285+00
Special Bridge Design Sta. 268+05 Sheets 1 of 2.
268+05 - 2-2
221+88 - 1-1
161+85 - 1-3
161+85 - 2-3
161+85 - 3-3
Standard No. 1177.
Special Bridge Design Sta. 149+50 - 1-1

146 B-104-A Union 7. 1.

ROUTE 146, SEC'S. 104-A-B&C, UNION CO. FEDERAL AID PROJECT 161

FROM A POINT NEAR THE CENTER OF THE S.E. 1/4 OF SECTION 19, T.12S., R.1W. OF 3RD P.M.
TO A POINT NEAR THE S.W. CORNER OF THE S.E. 1/4 OF SECTION 20, T.12S., R.2W. OF THE 3RD P.M.

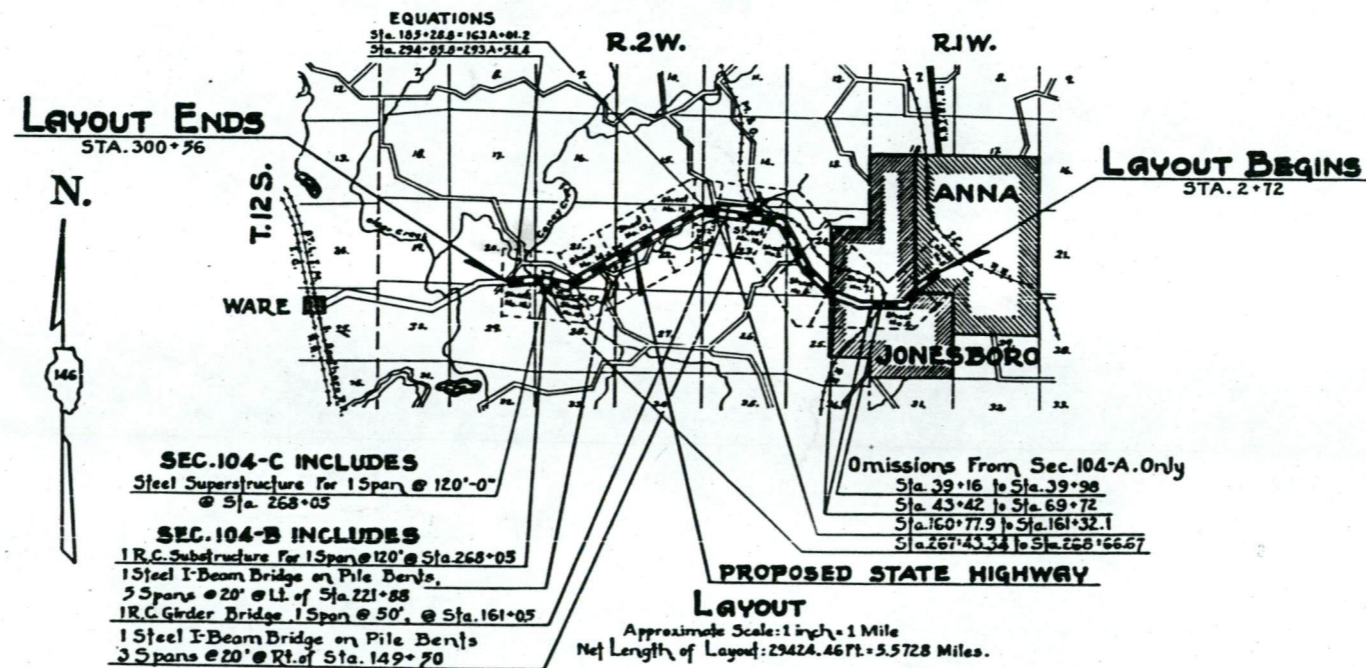

091-2012

STATE OF ILLINOIS
DEPARTMENT OF PUBLIC WORKS AND HIGHWAYS
DIVISION OF HIGHWAYS

May 22, 1961
G.A. Semarville

May 22, 1961
[Signature]

May 22, 1961
[Signature]

May 22, 1961
[Signature]

REEL 9-17

-SCHEDULE OF CULVERTS-

STA.	TYPE	SIZE	SKEW	CONC. CU. YDS.	STEEL LBS.
14+98	A.R.	18" Tile x 80'-11 1/4"	40°RH.	10.5	220
16+34	A.R.	18" " x 56'-0"		7.9	220
20+75	A.R.	3' x 2' x 49'-0"		14.2	1500
22+47	P.E.R.	12" Tile x 16'-0"		1.5	
24+58	A.R.	2' x 2' x 46'-0"		11.6	1100
35+00	S.R.L.	18" Tile x 24'-0"		4.2	220
38+00	S.R.R.	24" " x 50'-0"		7.5	120" Vitr. Sewer Pipe
81+70	Rt.	#935 - 8"		0.8	
82+02	A.R.	8'x6' x 70'-2"	21°RH.	93.5	10340
84+23	A.R.	2'x2' x 30'-6"		9.4	1030
117+51	A.R.	Double 10'x7' x 34'-0"		84.9	10910
124+58	S.R.L.	18" Tile - 24'-0"		4.9	230
125+00	P.E.L.	18" " - 16'-0"		2.2	
125+09	A.R.	8'x4' x 39'-5"	30°RH.	36.6	4800
126+00	P.E.L.	24" Tile - 16'-0"		2.8	
136+08	P.E.L.	18" " - 16'-0"		2.2	
138+36	A.R.	5'x3' x 64'-4 1/2"	45°L.H.	38.7	4590
146+82	P.E.L.	18" Tile - 16'-0"		2.2	
146+82	P.E.R.	6' x 3' x 16'-0"		10.0	1150
150+30	Rt.	Special Weir Design		3.6	
154+07	A.R.	3' x 3' x 104'-7 1/2"	55°L.H.	34.9	4750
161+05	A.R.	Special Bridge (Sec. 104-B)			
172+30	A.R.	Special Culvert (Designed in Sp'd.)			
173+85	A.R.	10' x 8' x 51'-0"		69.1	8060
177+50	S.R.R.	18" Tile - 24'-0"		4.9	230
184+52	A.R.	10' x 5' x 34'-0"		53.1	5400
174+08	A.R.	10' x 6' x 35'-2 1/2"	15°RH.	48.6	6180
189+44	P.E.R.	18" Tile - 16'-0"		2.2	
190+08	P.E.R.	15" Tile - 16'-0"		1.9	
190+10	A.R.	3' x 2' x 48'-1"	45°RH.	15.4	1660
195+13	A.R.	8' x 3 1/2' x 34'-0"		24.1	3360
202+24	A.R.	3' x 2' x 39'-5 1/4"	30°RH.	14.6	1330
221+88	P.E.L.	Special Bridge (Sec. 104-B)			
227+00	P.E.R.	18" Tile - 30'-0"		3.6	
233+28	A.R.	6' x 6' x 75'-6 1/4"	47°RH.	65.4	6730
236+50	P.E.L.	15" Tile - 16'-0"		1.9	
236+50	P.E.R.	15" Tile - 16'-0"		1.9	
237+75	A.R.	4' x 3' x 65'-9"	45°RH.	26.3	3030
247+50	S.R.L.	24" Tile - 24'-0"		6.6	280
253+10	A.R.	8' x 7' x 34'-0"		50.7	5170
259+20	A.R.	8' x 7' x 34'-0"		51.6	4520
266+50	P.E.L.	3' x 3' x 32'-0"		13.4	1200
266+50	P.E.R.	4' x 4' x 24'-6"		15.6	1340
268+05	A.R.	Special Bridge (Sec. 104-B+C)			
293+50	P.E.L.	24" Tile - 16'-0"		2.8	
293+50	P.E.R.	24" " - 16'-0"		2.8	
293+69	A.R.	7' x 5' x 42'-6"		23.0	2310
299+20	A.R.	6' x 5' x 57'-5 1/4"	45°RH.	30.1	3700
Section Totals.				813.7	95560

120" Vitr. Sewer Pipe.

-SCHEDULE OF FUTURE GUTTER-

TYPE	LOCATION	STA. to	STA.	LINE FT.	OUTLETS.
B	Right	2+72	23+00		
"	"	25+00	39+16		
"	"	39+98	43+42		
"	"	69+72	71+75		
"	"	75+75	81+75		
"	"	89+50	100+25		
"	"	138+25	138+36		
"	"	140+30	146+00		

SCHEDULE OF FUTURE GUTTER (ROCK SECTION)

TYPE	LOCATION	STA. to	STA.	LINE FT.	OUTLETS.
B	Left	129+75	135+75		
"	"	138+36	140+30		
"	"	154+80	157+50		

