

STATE OF ILLINOIS
DEPARTMENT OF TRANSPORTATION

FA RTE	SECTION	COUNTY	TOTAL SHEETS	SHEET NO.
2706	FAU 2706 22 RS	LAKE	72	1
ILLINOIS CONTRACT NO. 62T71			* 72 + 9 = 81 TOTAL SHEETS	

THIS PROJECT IS LOCATED IN THE VILLAGES OF DEERFIELD AND BANNOCKBURN

FOR INDEX OF SHEETS, SEE SHEET NO. 2

TRAFFIC DATA

POSTED SPEED LIMIT:

- LAKE COOK RD TO FIRE STATION: 40 MPH
- FIRE STATION TO GREENWOOD AVE: 30 MPH
- GREENWOOD AVE TO DEERFIELD HS ENTRANCE: 35 MPH
- DEERFIELD HS ENTRANCE TO IL 22 : 45 MPH

EXISTING ADT:

- LAKE COOK RD TO DEERFIELD RD: 30,500
- DEERFIELD RD TO IL 22: 18,000

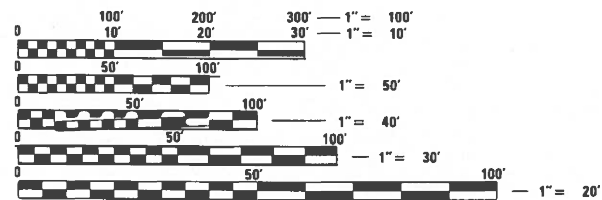

FULL SIZE PLANS HAVE BEEN PREPARED USING STANDARD ENGINEERING SCALES. REDUCED SIZED PLANS WILL NOT CONFORM TO STANDARD SCALES. IN MAKING MEASUREMENTS ON REDUCED PLANS, THE ABOVE SCALES MAY BE USED.

J.U.L.I.E.
JOINT UTILITY LOCATION INFORMATION FOR EXCAVATORS
1-800-892-0123
OR 811

PROJECT ENGINEER: LUKASZ POCIECHA (847) 705-4255
PROJECT MANAGER: FAWAD AQUEEL

CONTRACT NO. 62T71

**PROPOSED
HIGHWAY PLANS**

FAU ROUTE 2706: IL 43 (WAUKEGAN RD)
SE OF HALF DAY RD TO LAKE COOK RD
SECTION FAU 2706 22 RS
PROJECT NHPP-W9P8(974)
SMART OVERLAY AND ADA IMPROVEMENTS
LAKE COUNTY

C-91-369-22

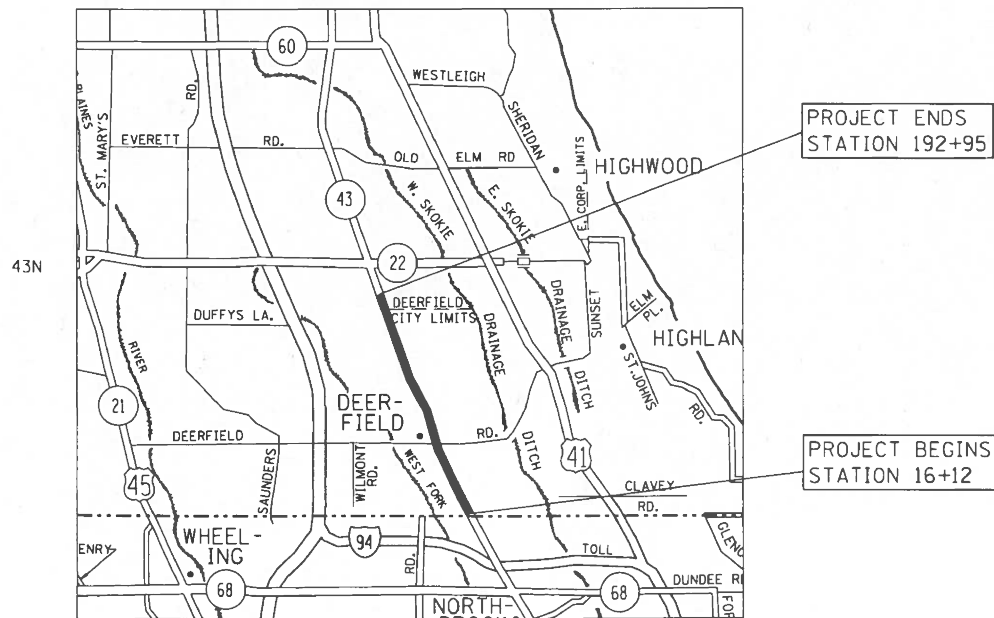

STATE OF ILLINOIS
DEPARTMENT OF TRANSPORTATION

SUBMITTED JUNE 26 20 23
Jose B. Lopez
REGIONAL ENGINEER

August 18, 2023
Scott A. Etkin
ENGINEER OF DESIGN AND ENVIRONMENT

August 18, 2023
Stephen M. ...
DIRECTOR OF HIGHWAYS PROJECT IMPLEMENTATION

PRINTED BY THE AUTHORITY
OF THE STATE OF ILLINOIS

GROSS LENGTH = 17,683 FT. = 3.35 MILE
NET LENGTH = 17,683 FT. = 3.35 MILE

INDEX OF SHEETS

STATE STANDARDS

GENERAL NOTES CONT.

SHEET NO.	DESCRIPTION
1	COVER SHEET
2	INDEX OF SHEETS, STATE STANDARDS AND GENERAL NOTES
3-7	SUMMARY OF QUANTITIES
8-11	EXISTING CROSS SECTIONS
12-18	PROPOSED PLANS AND PAVEMENT MARKING PLANS
19-41	ADA RAMP DETAILS
42-59	APS AND DETECTOR LOOP INSTALLATION PLAN
60	DETAILS FOR FRAMES AND LIDS ADJUSTMENT WITH MILLING (BD-08)
61	PAVEMENT PATCHING FOR HMA SURFACED PAVEMENT (BD-22)
62	CURB OR CURB AND GUTTER REMOVAL AND REPLACEMENT (BD-24)
63	BUTT JOINT AND HMA TAPER DETAILS (BD-32)
64	TRAFFIC CONTROL AND PROTECTION FOR SIDE ROADS, INTERSECTIONS, AND DRIVEWAYS (TC-10)
65	TYPICAL APPLICATIONS RAISED REFLECTIVE PAVEMENT MARKERS (SNOW-PLOW RESISTANT) (TC-11)
66	DISTRICT ONE TYPICAL PAVEMENT MARKINGS (TC-13)
67	SHORT TERM PAVEMENT MARKING LETTERS AND SYMBOLS (TC-16)
68	ARTERIAL ROAD INFORMATION SIGNING (TC-22)
69	DRIVEWAY ENTRANCE SIGNING (TC-26)
70	DISTRICT 1- DETECTOR LOOP INSTALLATION DETAILS FOR ROADWAY RESURFACING (TS-07)
71	PROJECT DETAIL FOR SINGLE PERPENDICULAR CURB RAMPS (PD-01)
72	PROJECT DETAIL FOR DOUBLE PERPENDICULAR CURB RAMPS (PD-03)

STANDARD NO.	DESCRIPTION
000001-08	STANDARD SYMBOLS, ABBREVIATIONS AND PATTERNS
280001-07	TEMPORARY EROSION CONTROL SYSTEMS
424001-11	PERPENDICULAR CURB RAMPS FOR SIDEWALKS
442201-03	CLASS C AND D PATCHES
602001-02	CATCH BASIN TYPE A
602601-06	PRECAST REINFORCED CONCRETE FLAT SLAB TOP
604001-05	FRAME AND LIDS, TYPE 1
604006-05	FRAME AND GRATE, TYPE 3
604091-05	FRAME AND GRATE, TYPE 24
606001-08	CONCRETE CURB TYPE B AND COMBINATION CONCRETE CURB AND GUTTER
701101-05	OFF-RD OPERATIONS, MULTILANE, 15' TO 24" FROM PAVEMENT EDGE
701426-09	LANE CLOSURE, MULTILANE, INTERMITTENT OR MOVING OPERATIONS, FOR SPEEDS GREATER OR EQUAL TO 45 MPH
701427-05	LANE CLOSURE, MULTILANE, INTERMITTENT OR MOVING OPERATIONS, FOR SPEEDS LESS THAN OR EQUAL TO 40 MPH
701601-09	URBAN LANE CLOSURE, MULTILANE, 1W OR 2W WITH NONTRAVERSABLE MEDIAN
701602-10	URBAN LANE CLOSURE, MULTILANE, 2W WITH BIDIRECTIONAL LEFT TURN
701606-10	URBAN LANE CLOSURE, MULTILANE, 2W WITH MOUNTABLE MEDIAN
701611-01	URBAN HALF ROAD CLOSURE, MULTILANE, 2W WITH MOUNTABLE MEDIAN
701701-10	URBAN LANE CLOSURE, MULTILANE INTERSECTION
701801-06	SIDEWALK, CORNER, OR CROSSWALK CLOSURE
701901-08	TRAFFIC CONTROL DEVICES
886001-01	DETECTOR LOOP INSTALLATIONS
886006-01	TYPICAL LAYOUTS FOR DETECTION LOOPS

- ANY PAVEMENT MARKINGS AND RAISED REFLECTIVE PAVEMENT MARKERS OBLITERATED BY MILLING AND RESURFACING OPERATIONS ON SIDE STREETS AND ENTRANCES SHALL BE REPLACED AND PAID FOR IN KIND.
- ALL DAMAGE TO EXISTING PAVEMENT MARKINGS OR RAISED REFLECTIVE PAVEMENT MARKERS OUTSIDE THE REMOVAL LINE SHOWN ON THE PLANS SHALL BE REPLACED AT NO ADDITIONAL COST TO THE DEPARTMENT.
- BEFORE BEGINNING ANY WORK, THE CONTRACTOR SHALL RETAIN AND RECORD FOR FUTURE REFERENCE, ALL EXISTING PAVEMENT MARKING LINES (AND RAISED REFLECTIVE PAVEMENT MARKERS) IN ORDER THAT THESE LOCATIONS CAN BE RE-ESTABLISHED FOR STRIPING. EXACT LOCATIONS OF ALL PAVEMENT MARKINGS SHALL BE AS SHOWN ON THE PLANS OR AS DIRECTED BY THE ENGINEER.
- ALL PAVEMENT PATCHING LOCATIONS WILL BE DETERMINED IN THE FIELD BY THE ENGINEER.
- LOCATION OF COMBINATION CONCRETE CURB AND GUTTER REMOVAL AND REPLACEMENT (OR COMBINATION CURB AND GUTTER (THE TYPE SPECIFIED ON THE PLANS)), WILL BE DETERMINED IN THE FIELD BY THE ENGINEER.
- DRAINAGE ADJUSTMENT OR RECONSTRUCTION LOCATIONS WILL BE DETERMINED IN THE FIELD BY THE ENGINEER.
- IT SHALL BE THE CONTRACTOR'S RESPONSIBILITY TO VERIFY ALL DIMENSIONS AND CONDITIONS EXISTING IN THE FIELD PRIOR TO CONSTRUCTION AND ORDERING OF MATERIALS.
- FRAMES AND GRATES ADJUSTMENT OF PRIVATE UTILITIES WITHIN THE LIMITS OF THE IMPROVEMENTS SHALL BE DONE BY THEIR RESPECTIVE OWNERS AND ARE NOT PART OF THIS CONTRACT.
- SIDEWALK REMOVAL AND P.C.C. SIDEWALK 5" LOCATIONS SHALL BE DETERMINED BY THE ENGINEER.
- THE CONTRACTOR SHALL CONTACT KALPANA KANNAN-HOSADURGA, THE DISTRICT ONE TRAFFIC CONTROL SUPERVISOR AT KALPANA.KANNAN-HOSADURGA@ILLINOIS.GOV A MINIMUM OF 72 HOURS IN ADVANCE OF BEGINNING WORK.
- THE ENGINEER SHALL CONTACT FADI SULTAN, AREA TRAFFIC FIELD ENGINEER, AT FADI.SULTAN@ILLINOIS.GOV A MINIMUM OF TWO (2) WEEKS PRIOR TO THE PLACEMENT OF PERMANENT PAVEMENT MARKINGS.
- THE CONTRACTOR SHALL BE REQUIRED TO PROVIDE ACCESS TO ABUTTING PROPERTY AT ALL TIMES DURING THE CONSTRUCTION OF THIS PROJECT.
- THE CONTRACTOR WILL BE REQUIRED TO KEEP A RECORD OF THE LOCATIONS OF PLATED STRUCTURES BY STATION AND OFFSET LEFT OR RIGHT OF THE CENTERLINE OF PAVEMENT.
- THE CONTRACTOR WILL BE REQUIRED TO KEEP A RECORD OF THE LOCATIONS OF THE BURIED STRUCTURES ACCORDING TO THE STATION AND DISTANCE LEFT OR RIGHT OF THE CENTERLINE OF PAVEMENT. UPON COMPLETION OF THE WORK, THE CONTRACTOR WILL DELIVER THE RECORD TO THE ENGINEER.
- EXISTING BROKEN FRAMES AND LIDS SHALL BE REMOVED AND DISPOSED OF BY THE CONTRACTOR AND SHALL BE REPLACED AS DIRECTED BY THE ENGINEER. REPLACEMENT FRAMES AND LIDS WILL BE PAID FOR ACCORDING TO ARTICLE 109.04 OF THE STANDARD SPECIFICATIONS UNLESS A SEPARATE PAY ITEM HAS BEEN PROVIDED.
- DO NOT SCALE PLANS FOR CONSTRUCTION DIMENSIONS.
- DOUBLE LANE MARKERS ARE TO BE USED AS SHOWN ON THE DISTRICT ONE DETAIL "TYPICAL APPLICATIONS RAISED REFLECTIVE PAVEMENT MARKERS (SNOW-PLOW RESISTANT)" SHOWN IN THE PLANS.
- EROSION CONTROL/ NO INTRUSION FENCING SHALL BE PLACED AT THE EXISTING ROW LINE AND BETWEEN THE ROADWAY AND THE DRAINAGE CHANNEL FROM STA 134+43 TO STA 139+76 TO PROTECT THE DRAINAGE CHANNEL AT THE NW CORNER OF IL 43 AND NORTH AVE.
- ADA WORK DELINEATED FROM THE MAINLINE BY A DEPRRESSED CURB IS TO BE COMPLETED IN THIS PROJECT. ANY RESTORATION THAT IS REQUIRED ADJACENT TO THE CURB AND GUTTER WILL BE PAID FOR UNDER CLASS D PATCH.
- THE CONTRACTOR SHALL BE RESPONSIBLE FOR ALL DAMAGES TO VISIBLE SPRINKLER HEADS DURING ADA WORK.
- USE PROPOSED PAVEMENT MARKINGS ON ROADWAY PLAN AND NOT ON ADA SHEETS.
- THE "ROAD CONSTRUCTION AHEAD" SIGNS SHALL REMAIN INSTALLED UNTIL THE COMPLETION OF THE PROJECT OR WHEN NO ROADWAY HAZARDS REMAIN IN THE WORK ZONE.

GENERAL NOTES

- BEFORE STARTING ANY EXCAVATION, THE CONTRACTOR SHALL CALL "J.U.L.I.E." AT (800) 892-0123 OR 811 FOR FIELD LOCATIONS OF BURIED ELECTRIC, TELEPHONE AND GAS UTILITIES. 48 HOUR NOTIFICATION IS REQUIRED.
- PAVEMENT MARKING TAPE, TYPE III SHALL BE USED FOR SHORT TERM PAVEMENT MARKINGS ON ALL FINAL SURFACES.
- THE CONTRACTOR SHALL COORDINATE CONSTRUCTION ACTIVITIES WITH UTILITY COMPANIES, AND THE CITIES OF DEERFIELD AND BANNOCKBURN.
- OVERNIGHT LANE CLOSURES SHALL NOT BE ALLOWED FOR REHABILITATION PROJECTS INVOLVING DAYTIME MILLING AND RESURFACING OPERATIONS AND CLASS D PATCHING UNLESS OTHER CONDITIONS WARRANT EXTENDED LANE CLOSURES AS DETERMINED AND APPROVED IN WRITING BY THE ENGINEER OR AS PROVIDED FOR IN THE CONTRACT SPECIFICATIONS.
- SIDEWALK RAMPS MODIFICATIONS WITHIN THE LIMITS OF THE PROJECT SHALL CONFORM TO THE APPLICABLE HIGHWAY STANDARDS INCLUDED IN THE PLANS

REVISED SHEET 9/13/2023

MODEL: Default
FILE: \\nas01c-pw-bentley.com\FWIDOT\Documents\DOT_Offices\Bartlett_IL\Projects\131522\CADD\DATA\Drawings\131522-sign_notes

USER NAME = connor.mullane	DESIGNED -	REVISED - ADD 2 - LP - 9-12-23	STATE OF ILLINOIS DEPARTMENT OF TRANSPORTATION	INDEX OF SHEETS, STATE STANDARDS, AND GENERAL NOTES				F.A. RTE.	SECTION	COUNTY	TOTAL SHEETS	SHEET NO.
PLOT SCALE = 100.0000 ' / in.	CHECKED -	REVISED -						2706	FAU 2706 22 RS	LAKE	71	2
PLOT DATE = 6/30/2023	DATE -	REVISED -		SCALE:	SHEET	OF	SHEETS	STA.	TO	STA.	ILLINOIS FED. AID PROJECT	

SUMMARY OF QUANTITIES			TOTAL QUANTITIES URBAN	CONSTRUCTION TYPE CODE			CODE NO	SUMMARY OF QUANTITIES			TOTAL QUANTITIES URBAN	CONSTRUCTION TYPE CODE		
CODE NO	ITEM	UNIT		80% FED 20% STATE 0005	100% STATE 0005	80% FED 20% STATE 0021		CODE NO	ITEM	UNIT		80% FED 20% STATE 0005	100% STATE 0005	80% FED 20% STATE 0021
70102635	TRAFFIC CONTROL AND PROTECTION, STANDARD 701701	L SUM	1	1			* 78000200	THERMOPLASTIC PAVEMENT MARKING - LINE 4"	FOOT	49370	49370			
70102640	TRAFFIC CONTROL AND PROTECTION, STANDARD 701801	L SUM	1	1			* 78000400	THERMOPLASTIC PAVEMENT MARKING - LINE 6"	FOOT	7915	7915			
70300100	SHORT TERM PAVEMENT MARKING	FOOT	39466	39466			* 78000600	THERMOPLASTIC PAVEMENT MARKING - LINE 12"	FOOT	2410	2410			
70300150	SHORT TERM PAVEMENT MARKING REMOVAL	SO FT	13156	13156			* 78000650	THERMOPLASTIC PAVEMENT MARKING - LINE 24"	FOOT	1205	1205			
70300211	TEMPORARY PAVEMENT MARKING LETTERS AND SYMBOLS - PAINT	SO FT	1625	1625			* 78100100	RAISED REFLECTIVE PAVEMENT MARKER	EACH	1909	1909			
70300221	TEMPORARY PAVEMENT MARKING - LINE 4"- PAINT	FOOT	49369	49369			78300200	RAISED REFLECTIVE PAVEMENT MARKER REMOVAL	EACH	1715 1528	1715 1528			
70300241	TEMPORARY PAVEMENT MARKING - LINE 6"- PAINT	FOOT	6304	6304			78300202	PAVEMENT MARKING REMOVAL - WATER BLASTING	SO FT	33436	33436			
70300261	TEMPORARY PAVEMENT MARKING - LINE 12"- PAINT	FOOT	4012	4012			* 81028200	UNDERGROUND CONDUIT, GALVANIZED STEEL, 2" DIA.	FOOT	186 123		186 123		
70300281	TEMPORARY PAVEMENT MARKING - LINE 24"- PAINT	FOOT	1205	1205			* 85000200	MAINTENANCE OF EXISTING TRAFFIC SIGNAL INSTALLATION	EACH	11 8		11 8		
70306120	TEMPORARY PAVEMENT MARKING - LINE 4" - TYPE III TAPE	FOOT	19733	19733			* 87301215	ELECTRIC CABLE IN CONDUIT, SIGNAL NO. 14 2C	FOOT	2671 2092		2671 2092		
* 78000100	THERMOPLASTIC PAVEMENT MARKING - LETTERS AND SYMBOLS	SO FT	1625	1625										
							* SPECIALTY ITEM							

2 REVISIED SHEET 9/13/2023
1 REVISIED SHEET 9/8/2023

SUMMARY OF QUANTITIES			CONSTRUCTION TYPE CODE			
CODE NO	ITEM	UNIT	TOTAL QUANTITIES URBAN	80% FED 20% STATE 0005	100% STATE 0005	80% FED 20% STATE 0021
* 87301225	ELECTRIC CABLE IN CONDUIT, SIGNAL NO. 14 3C	FOOT	1396 885			1396 885
* 87301900	ELECTRIC CABLE IN CONDUIT, EQUIPMENT GROUNDING CONDUCTOR, NO. 6 1C	FOOT	285 178			285 178
* 87900200	DRILL EXISTING HANDHOLE	EACH	10 6			10 6
* 88102717	PEDESTRIAN SIGNAL HEAD, LED, 1-FACE, BRACKET MOUNTED WITH COUNTDOWN TIMER	EACH	12 4			12 4
* 88102747	PEDESTRIAN SIGNAL HEAD, LED, 2-FACE, BRACKET MOUNTED WITH COUNTDOWN TIMER	EACH	1			1
* 88600100	DETECTOR LOOP, TYPE I	FOOT	3892 3487 1437			3892 3487 1437
* 89502350	REMOVE AND REINSTALL ELECTRIC CABLE FROM CONDUIT	FOOT	141 17			141 17
* 89502375	REMOVE EXISTING TRAFFIC SIGNAL EQUIPMENT	EACH	10 7			10 7
* 89502376	REBUILD EXISTING HANDHOLE	EACH	6			6
X0320050	CONSTRUCTION LAYOUT (SPECIAL)	L SUM	1			1
X0327611	REMOVE AND REINSTALL EXISTING BRICK PAVERS	SO FT	2000	2000		
X0327989	REMOVE EXISTING BRICK PAVERS	SO FT	585	585		
* X1400378	PEDESTRIAN SIGNAL POST, 5 FT.	EACH	6			6

SUMMARY OF QUANTITIES			CONSTRUCTION TYPE CODE			
CODE NO	ITEM	UNIT	TOTAL QUANTITIES URBAN	80% FED 20% STATE 0005	100% STATE 0005	80% FED 20% STATE 0021
* X1400450	REBUILD EXISTING HEAVY DUTY HANDHOLE	EACH	1			1
X2020110	GRADING AND SHAPING SHOULDERS	UNIT	2.8	2.8		
X4400501	COMBINATION CURB AND GUTTER REMOVAL AND REPLACEMENT LESS THAN OR EQUAL TO 10 FEET	FOOT	1776	1776		
X4400503	COMBINATION CURB AND GUTTER REMOVAL AND REPLACEMENT GREATER THAN 10 FEET	FOOT	5709	5709		
X5537800	STORM SEWERS TO BE CLEANED 12"	FOOT	1000		1000	
X5538000	STORM SEWERS TO BE CLEANED 18"	FOOT	500		500	
X5538200	STORM SEWERS TO BE CLEANED 24"	FOOT	300		300	
X6030310	FRAMES AND LIDS TO BE ADJUSTED (SPECIAL)	EACH	172	172		
X6700407	ENGINEER'S FIELD OFFICE, TYPE A (D1)	CAL MO	12	12		
* X8140234	REPLACE HANDHOLE COVER	EACH	5			5
* X8760200	ACCESSIBLE PEDESTRIAN SIGNALS	EACH	56 38			56 38
* X8780012	CONCRETE FOUNDATION, TYPE A 12-INCH DIAMETER	FOOT	40 24			40 24
	* SPECIALTY ITEM					

FILE NAME =	USER NAME = conner.mullane	DESIGNED -	REVISED -
pw\N\dot-pw\benfrey.com\PI\DOT\Documents\1007 - Office\1\1\1\Projects\131522\CAD\dot\Design\131522-sh-500		DRAWN -	REVISED -
	PLOT SCALE = 100.0000' / 1in	CHECKED -	REVISED -
	PLOT DATE = 6/30/2023	DATE -	REVISED -

**STATE OF ILLINOIS
DEPARTMENT OF TRANSPORTATION**

**IL 43 (WAUKEGAN RD) SOUTH OF IL 22 TO LAKE COOK RD
SUMMARY OF QUANTITIES**

F.A. RTE. 2706	SECTION FAU 2706 22 RS	COUNTY LAKE	TOTAL SHEETS 72	SHEET NO. 6
CONTRACT NO. 62771				
FED. ROAD DIST. NO. 1 ILLINOIS FED. AID PROJECT				

△ REVISIED SHEET 9/13/2023
△ REVISIED SHEET 9/8/2023

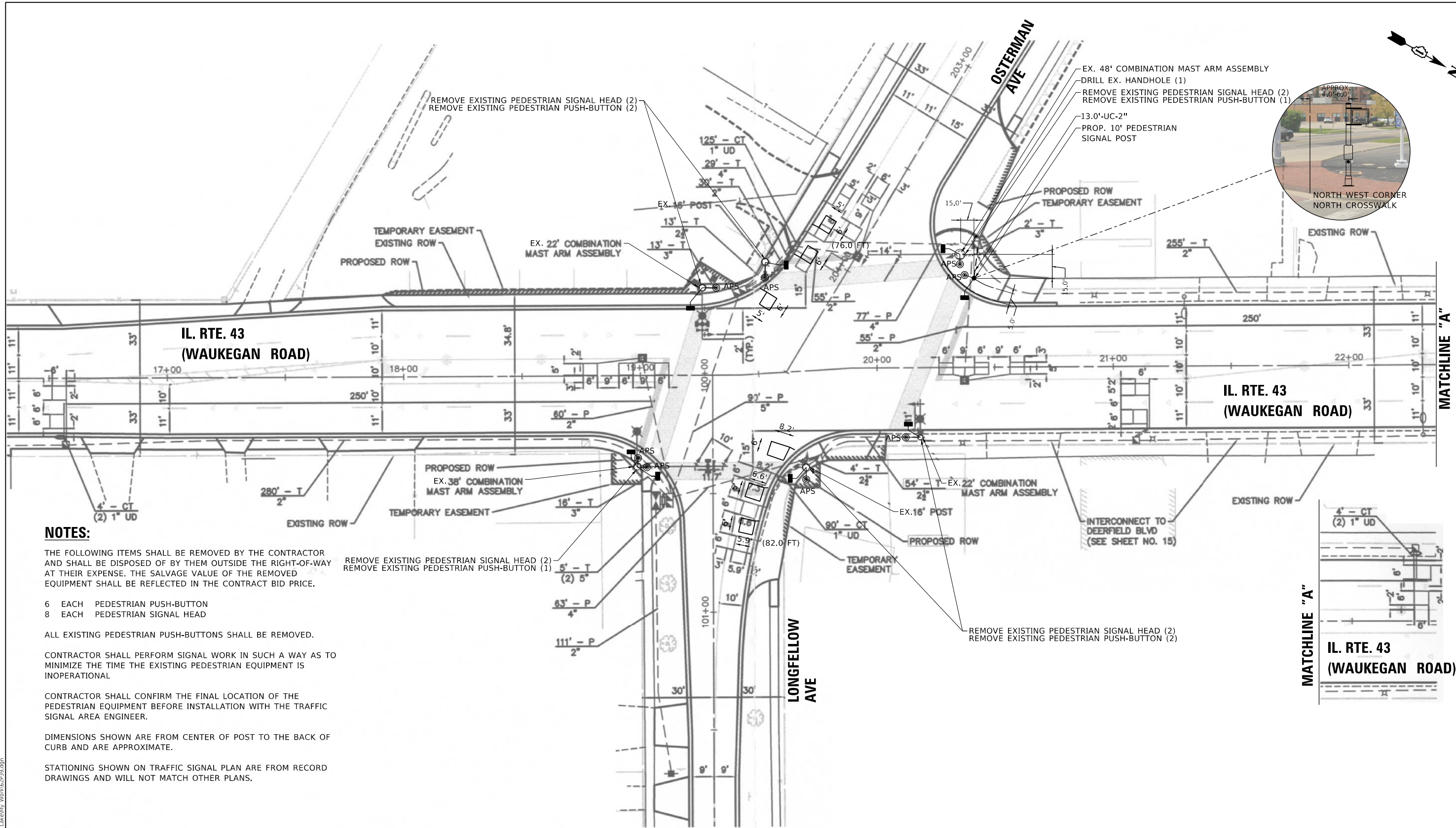

NOTES:

THE FOLLOWING ITEMS SHALL BE REMOVED BY THE CONTRACTOR AND SHALL BE DISPOSED OF BY THEM OUTSIDE THE RIGHT-OF-WAY AT THEIR EXPENSE. THE SALVAGE VALUE OF THE REMOVED EQUIPMENT SHALL BE REFLECTED IN THE CONTRACT BID PRICE.

- 6 EACH PEDESTRIAN PUSH-BUTTON
- 8 EACH PEDESTRIAN SIGNAL HEAD

ALL EXISTING PEDESTRIAN PUSH-BUTTONS SHALL BE REMOVED.

CONTRACTOR SHALL PERFORM SIGNAL WORK IN SUCH A WAY AS TO MINIMIZE THE TIME THE EXISTING PEDESTRIAN EQUIPMENT IS INOPERATIONAL

CONTRACTOR SHALL CONFIRM THE FINAL LOCATION OF THE PEDESTRIAN EQUIPMENT BEFORE INSTALLATION WITH THE TRAFFIC SIGNAL AREA ENGINEER.

DIMENSIONS SHOWN ARE FROM CENTER OF POST TO THE BACK OF CURB AND ARE APPROXIMATE.

STATIONING SHOWN ON TRAFFIC SIGNAL PLAN ARE FROM RECORD DRAWINGS AND WILL NOT MATCH OTHER PLANS.

REMOVE EXISTING PEDESTRIAN SIGNAL HEAD (2)
REMOVE EXISTING PEDESTRIAN PUSH-BUTTON (1)

- EX. 48' COMBINATION MAST ARM ASSEMBLY
- DRILL EX. HANDHOLE (1)
- REMOVE EXISTING PEDESTRIAN SIGNAL HEAD (2)
- REMOVE EXISTING PEDESTRIAN PUSH-BUTTON (1)
- 13.0'-UC-2"
- PROP. 10' PEDESTRIAN SIGNAL POST

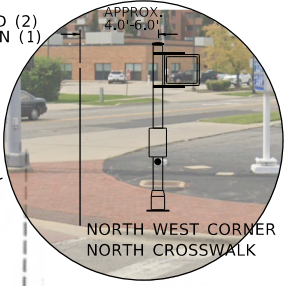

**STATE OF ILLINOIS
DEPARTMENT OF TRANSPORTATION**

**TRAFFIC SIGNAL APS INSTALLATION PLAN
IL RTE. 43 (WAUKEGAN RD) AT OSTERMAN AVE / LONGFELLOW AVE**

SCALE: SHEET OF SHEETS STA. TO STA.

USER NAME = mereimh	DESIGNED - MM	REVISED - ADD 2 - LP - 9-12-23
PLOT SCALE = 40.0000' / in.	DRAWN - MM	REVISED -
PLOT DATE = 7/15/2022	CHECKED - KK	REVISED -
	DATE - 7/15/2022	REVISED -

F.A. RTE.	SECTION	COUNTY	TOTAL SHEETS	SHEET NO.
	FAU 2706 22 RS	LAKE	72	59A
CONTRACT NO. 62T71				
ILLINOIS FED. AID PROJECT				

REVISED ENTIRE SHEET 9/13/2023

TS 12925

ECON 155

REMOVE EXISTING PEDESTRIAN SIGNAL HEAD (2)
REMOVE EXISTING PEDESTRIAN PUSH-BUTTON (2)

ADD SIDEWALK HERE

IL. RTE. 43
(WAUKEGAN ROAD)

11119+00

SOUTHWEST CORNER

OSTERMAN
AVE

OSTERMAN
AVE

EX. 48" COMBINATION MAST ARM ASSEMBLY
DRILL EX. HANDHOLE (1)
REMOVE EXISTING PEDESTRIAN SIGNAL HEAD (2)
REMOVE EXISTING PEDESTRIAN PUSH-BUTTON (1)
13.0'-UC-2"
PROP. 10' PEDESTRIAN
SIGNAL POST

IL. RTE. 43
(WAUKEGAN ROAD)

11120+00

11121+00

NORTHWEST CORNER

NOTES:

THE PLAN SHEET SHALL BE USED FOR DETERMINING THE EXACT
LOCATION OF THE NEW APS PUSH BUTTONS.

IL. RTE. 43
(WAUKEGAN ROAD)

11119+00

REMOVE EXISTING PEDESTRIAN SIGNAL HEAD (2)
REMOVE EXISTING PEDESTRIAN PUSH-BUTTON (1)

SOUTHEAST CORNER

LONGFELLOW
AVE

11120+00

IL. RTE. 43
(WAUKEGAN ROAD)

LONGFELLOW
AVE

NORTHEAST CORNER

REMOVE EXISTING PEDESTRIAN SIGNAL HEAD (2)
REMOVE EXISTING PEDESTRIAN PUSH-BUTTON (2)

TS 12925

ECON 155

REVISD ENTIRE SHEET 9/13/2023

USER NAME = mereimh	DESIGNED - MM	REVISED - ADD 2 - LP - 9-12-23
PLOT SCALE = 40,0000 '"/> in.	CHECKED - KK	REVISED -
PLOT DATE = 7/15/2022	DATE - 7/15/2022	REVISED -

STATE OF ILLINOIS
DEPARTMENT OF TRANSPORTATION

PORPOSED APS PUSH BUTTONS WITH NEW ADA SIDEWALK PLAN
IL RTE. 43 (WAUKEGAN RD) AT OSTERMAN AVE /LONGFELLOW AVE

SCALE: SHEET OF SHEETS STA. TO STA.

F.A. RTE.	SECTION	COUNTY	TOTAL SHEETS	SHEET NO.
	FAU 2706 22 RS	LAKE	72	59B
			CONTRACT NO. 62T71	
		ILLINOIS FED. AID PROJECT		

TS SHT NO. 2

MODEL Path: S:\Work\Design\MonteCarlo\62T71_Southeast_Lake\My_Work\62T71.dgn
FILE NAME: S:\Work\Design\MonteCarlo\62T71_Southeast_Lake\My_Work\62T71.dgn

EXISTING CONTROLLER SEQUENCE

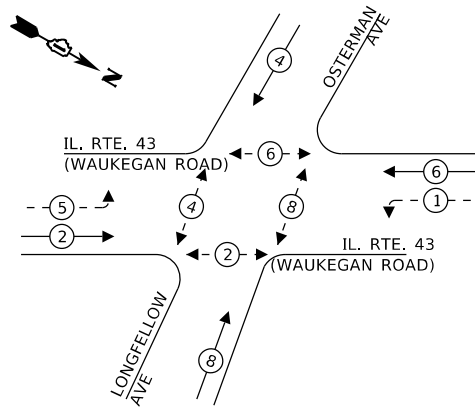

LEGEND:

- ← * → PROTECTED PHASE
- ← * - - → PROTECTED/PERMITTED PHASE
- ← * → PEDESTRIAN PHASE
- ← OL → OVERLAP

EXISTING EMERGENCY VEHICLE PREEMPTION SEQUENCE

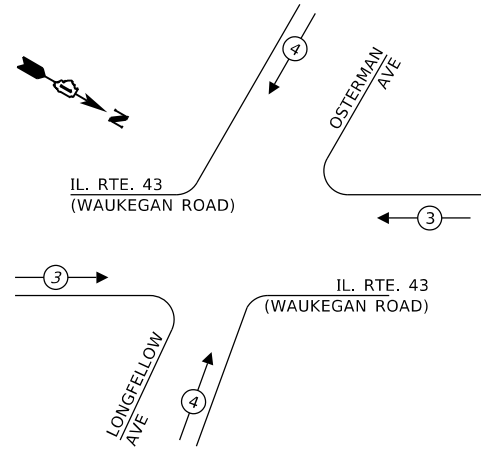

TRAFFIC SIGNAL ELECTRICAL SERVICE REQUIREMENTS

TYPE	NO. OF LAMPS	LED WATTAGE	% OPERATION	TOTAL WATTAGE
SIGNAL (RED)	13	11	50	71.5
(YELLOW)	13	20	5	13
(GREEN)	13	12	45	70.2
PERMISSIVE ARROW	8	10	10	8.0
PED. SIGNAL	8	20	100	160.0
CONTROLLER	1	100	100	100.0
UPS	1	25	100	25.0
VIDEO SYSTEM	-	150	100	-
BLANK-OUT SIGN	-	25	5	-
FLASHER	-	-	50	-
STREET NAME SIGN	-	120	50	-
LUMINAIRE	-	-	-	-
TOTAL =				447.7

ENERGY COSTS TO:

VILLAGE OF DEERFIELD
850 WAUKEGAN ROAD
DEERFIELD, IL 60015

ENERGY SUPPLY: CONTACT: TERRI BLECK
PHONE: 847-816-5239
COMPANY: ComEd
ACCOUNT NUMBER: 00171-45050

SCHEDULE OF QUANTITIES

ITEM DESCRIPTION	UNITS	TOTAL QTY
UNDERGROUND CONDUIT, GALVANIZED STEEL, 2" DIA.	FOOT	13
MAINTENANCE OF EXISTING TRAFFIC SIGNAL INSTALLATION.	EACH	1
ELECTRIC CABLE IN CONDUIT, SIGNAL NO. 14 2C.	FOOT	312
ELECTRIC CABLE IN CONDUIT, SIGNAL NO. 14 3C.	FOOT	269
ELECTRIC CABLE IN CONDUIT, EQUIPMENT GROUNDING CONDUCTOR, NO. 6 1C.	FOOT	24
DRILL EXISTING HANDHOLE.	EACH	1
PEDESTRIAN SIGNAL HEAD, LED, 1-FACE, BRACKET MOUNTED WITH COUNTDOWN TIMER.	EACH	8
* DETECTOR LOOP, TYPE I.	FOOT	158
REMOVE ELECTRIC CABLE FROM CONDUIT.	FOOT	258
REMOVE EXISTING TRAFFIC SIGNAL EQUIPMENT.	EACH	1
PEDESTRIAN SIGNAL POST, 10 FT.	EACH	1
ACCESSIBLE PEDESTRIAN SIGNALS.	EACH	8
CONCRETE FOUNDATION, TYPE A 12-INCH DIAMETER.	FOOT	4

* NOMINAL QUANTITY TO BE USED AS NEEDED AND AS APPROVED BY THE ENGINEER

IL. RTE. 43 (WAUKEGAN ROAD)

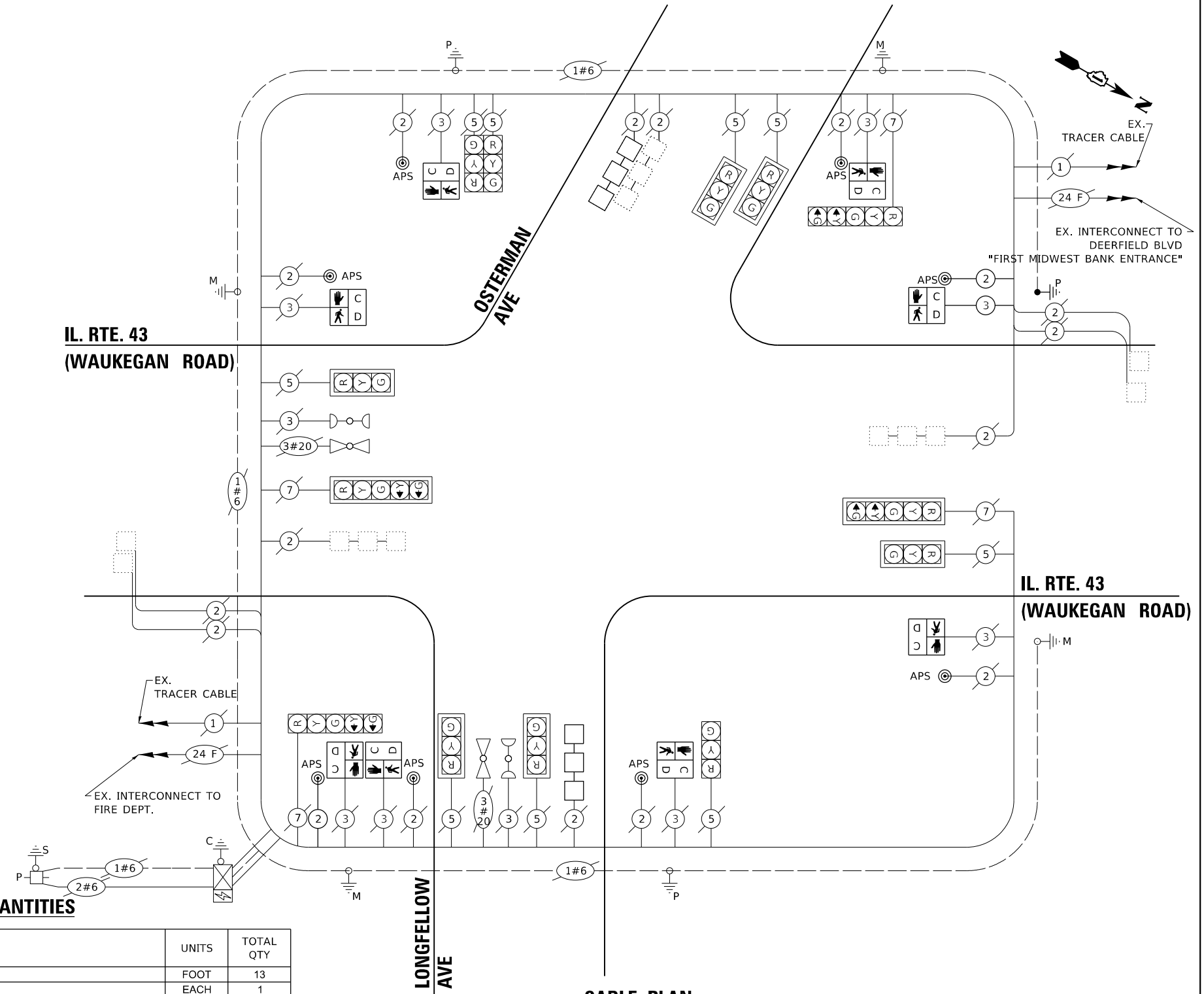

CABLE PLAN
(NOT TO SCALE)

TS SHT NO. 3

MODEL: Deerfield; FILE NAME: SAV\Design\Main\ts-sht-no-3-2023-05-04.dwg; WORKSPACE: WorkSpace2023.dwg

USER NAME = merelmh	DESIGNED - MM	REVISED - ADD 2 - LP - 9-12-23
PLOT SCALE = 40.0000' / in.	DRAWN - MM	REVISED -
PLOT DATE = 7/15/2022	CHECKED - KK	REVISED -
	DATE - 7/15/2022	REVISED -

**STATE OF ILLINOIS
DEPARTMENT OF TRANSPORTATION**

**CABLE PLAN, CONTROLLER SEQUENCE AND SCHEDULE OF QUANTITIES
IL. RTE. 43 (WAUKEGAN RD) AT OSTERMAN AVE / LONGFELLOW AVE**

SCALE: SHEET OF SHEETS STA. TO STA.

F.A. RTE.	SECTION	COUNTY	TOTAL SHEETS	SHEET NO.
	FAU 2706 22 RS	LAKE	72	59C
ILLINOIS FED. AID PROJECT			CONTRACT NO. 62T71	

TS 12925

ECON 155

REVISED ENTIRE SHEET 9/13/2023

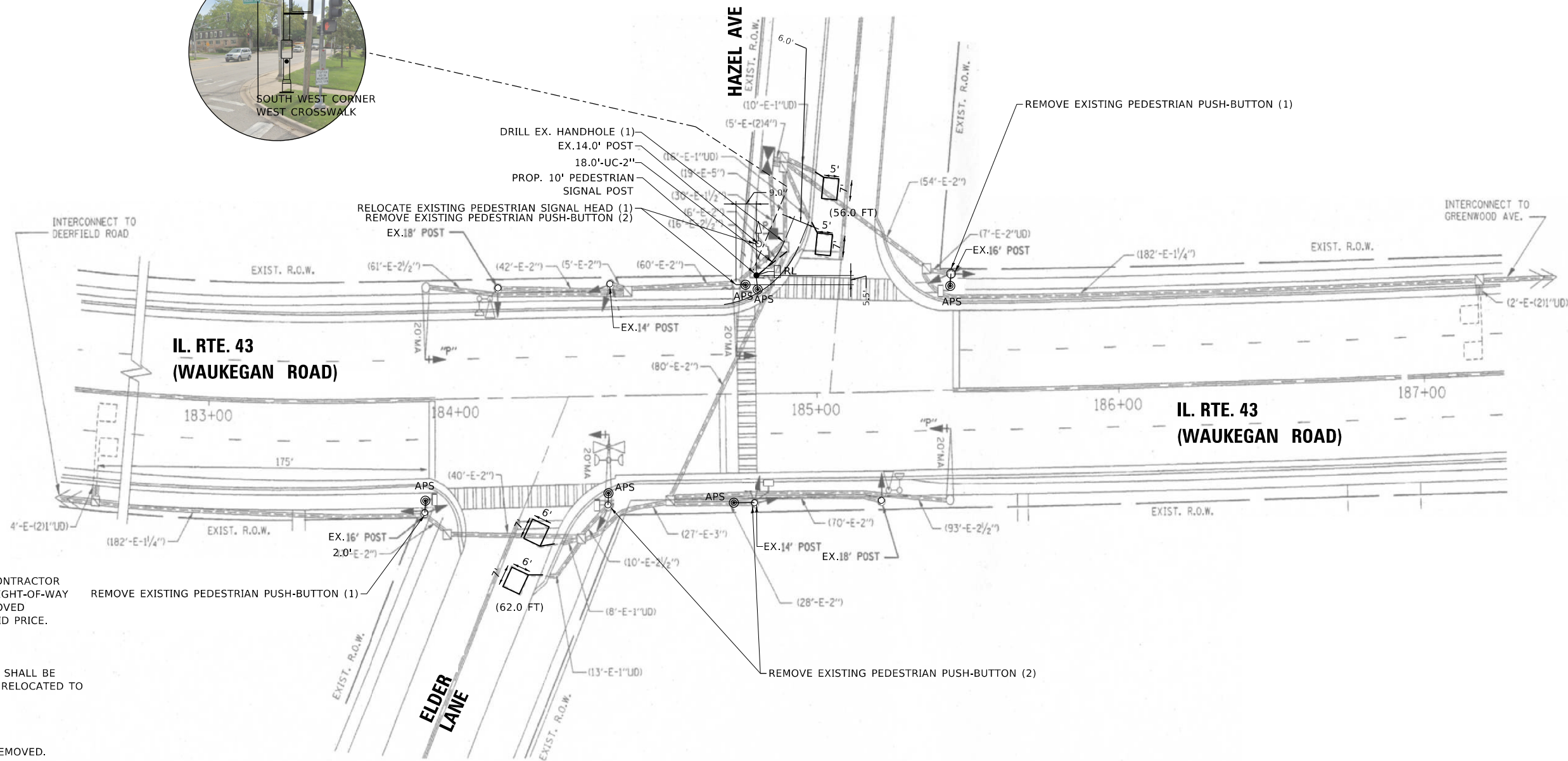
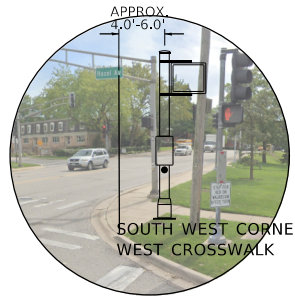

NOTES:

THE FOLLOWING ITEMS SHALL BE REMOVED BY THE CONTRACTOR AND SHALL BE DISPOSED OF BY THEM OUTSIDE THE RIGHT-OF-WAY AT THEIR EXPENSE. THE SALVAGE VALUE OF THE REMOVED EQUIPMENT SHALL BE REFLECTED IN THE CONTRACT BID PRICE.

6 EACH PEDESTRIAN PUSH-BUTTON

THE FOLLOWING EXISTING TRAFFIC SIGNAL EQUIPMENT SHALL BE REMOVED BY THE CONTRACTOR, SAFELY STORED AND RELOCATED TO THE PROPOSED POST:

1 EACH PEDESTRIAN SIGNAL HEAD

ALL EXISTING PEDESTRIAN PUSH-BUTTONS SHALL BE REMOVED.

CONTRACTOR SHALL PERFORM SIGNAL WORK IN SUCH A WAY AS TO MINIMIZE THE TIME THE EXISTING PEDESTRIAN EQUIPMENT IS INOPERATIONAL

CONTRACTOR SHALL CONFIRM THE FINAL LOCATION OF THE PEDESTRIAN EQUIPMENT BEFORE INSTALLATION WITH THE TRAFFIC SIGNAL AREA ENGINEER.

DIMENSIONS SHOWN ARE FROM CENTER OF POST TO THE BACK OF CURB AND ARE APPROXIMATE.

STATIONING SHOWN ON TRAFFIC SIGNAL PLAN ARE FROM RECORD DRAWINGS AND WILL NOT MATCH OTHER PLANS.

TS SHT NO. 4

MODEL: D:\proj\TS SHT NO. 4.dwg
FILE: I:\Users\SKW\OneDrive\My Documents\Projects\TS SHT NO. 4.dwg

USER NAME = mereimh	DESIGNED - MM	REVISED - ADD 2 - LP - 9-12-23
	DRAWN - MM	REVISED -
PLOT SCALE = 40,0000' / in.	CHECKED - KK	REVISED -
PLOT DATE = 7/15/2022	DATE - 7/15/2022	REVISED -

STATE OF ILLINOIS
DEPARTMENT OF TRANSPORTATION

TRAFFIC SIGNAL APS INSTALLATION PLAN
IL RTE. 43 (WAUKEGAN RD) AT HAZEL AVE / ELDER LN

SCALE: SHEET OF SHEETS STA. TO STA.

REVISED ENTIRE SHEET 9/13/2023

TS 12940

ECON 155

F.A. RTE.	SECTION	COUNTY	TOTAL SHEETS	SHEET NO.
	FAU 2706 22 RS	LAKE	72	59D
			CONTRACT NO. 62T71	
		ILLINOIS FED. AID PROJECT		

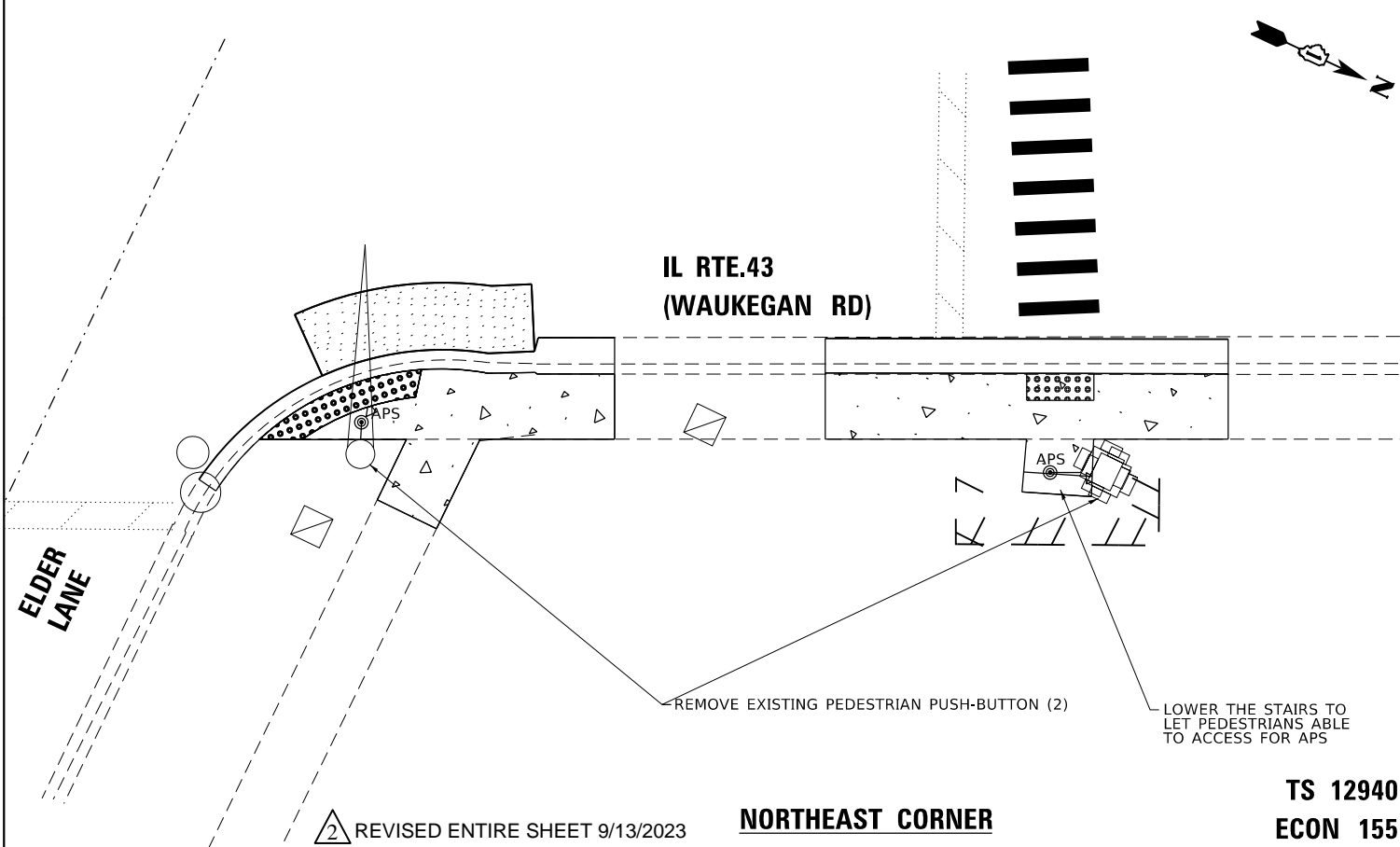
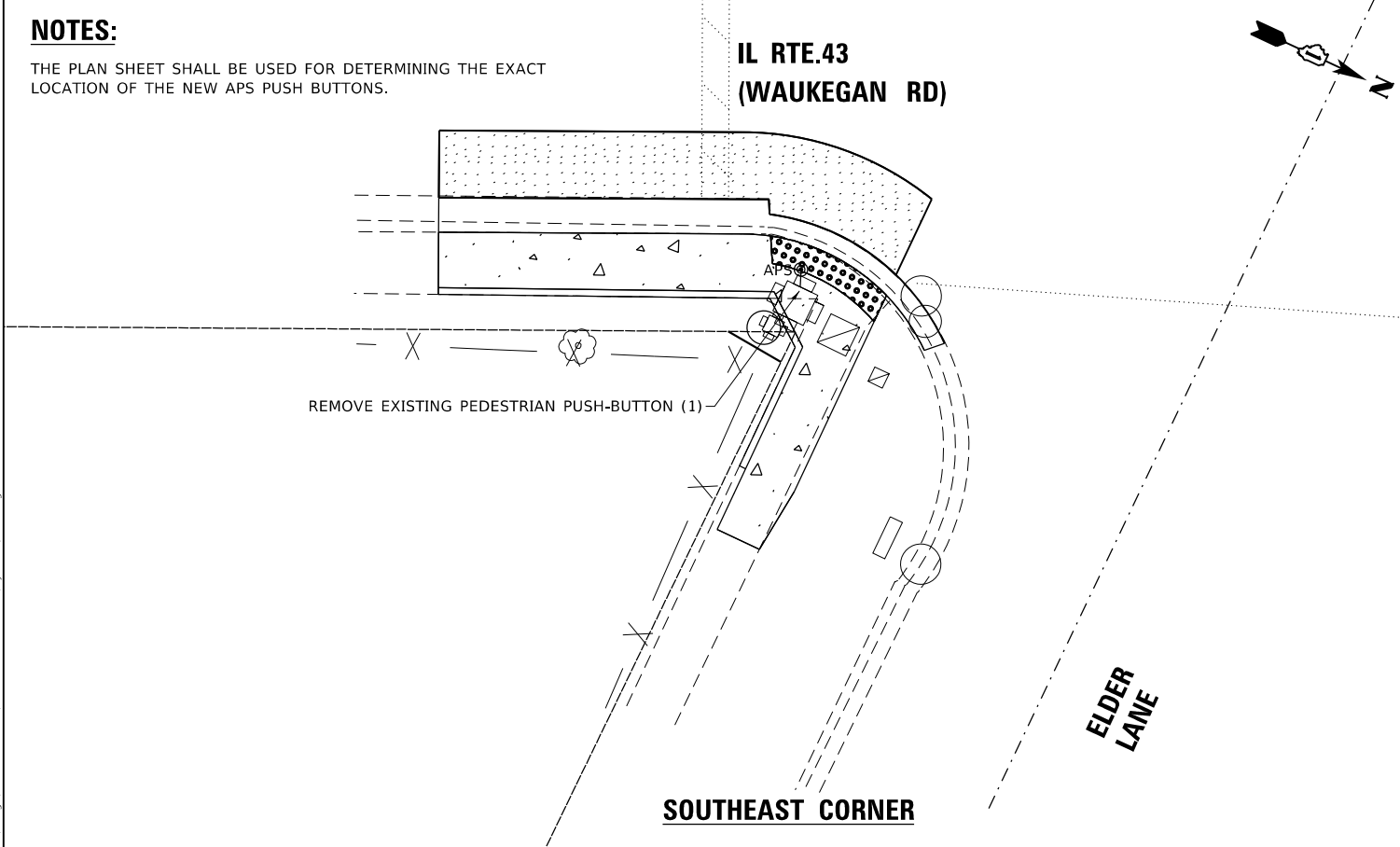
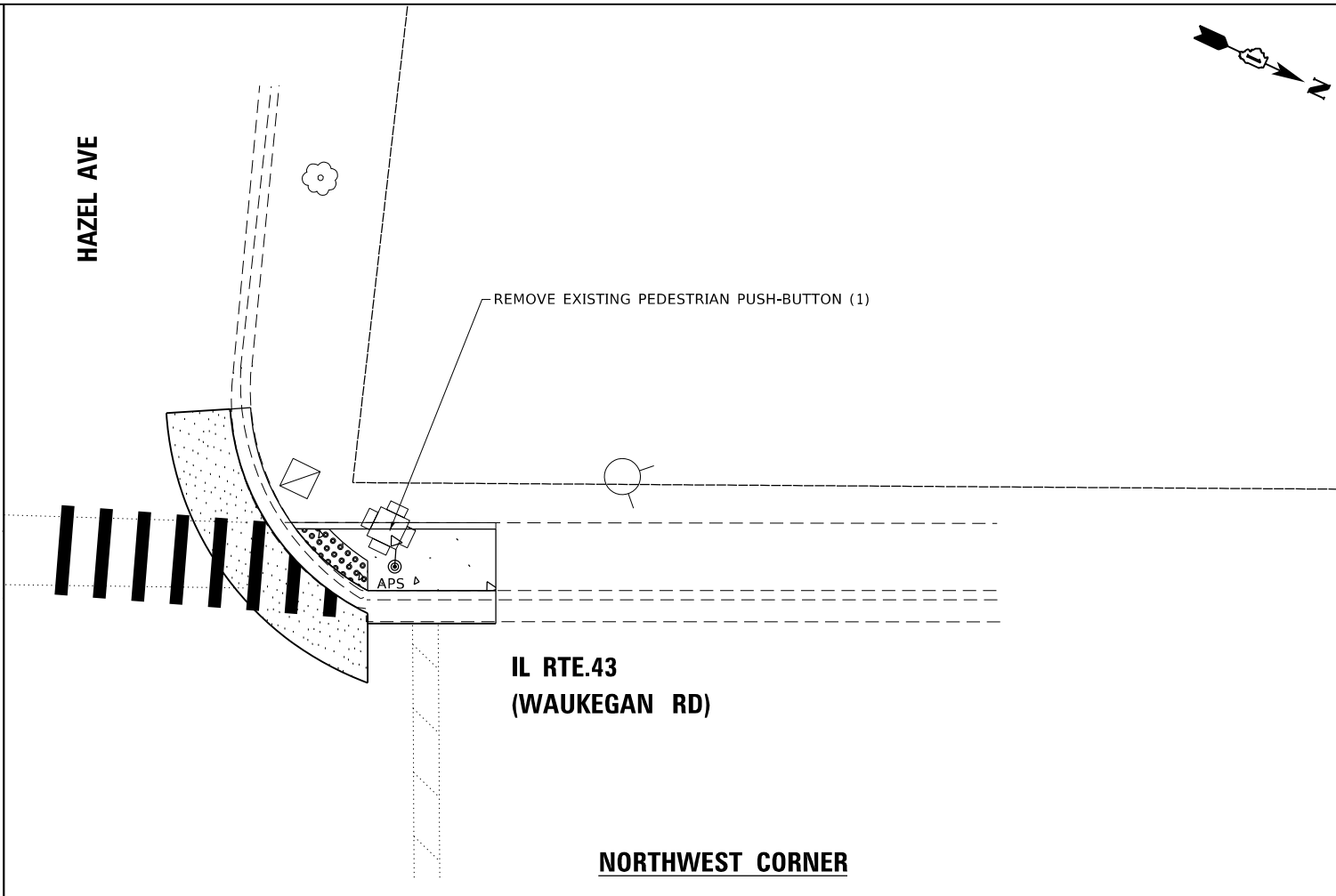
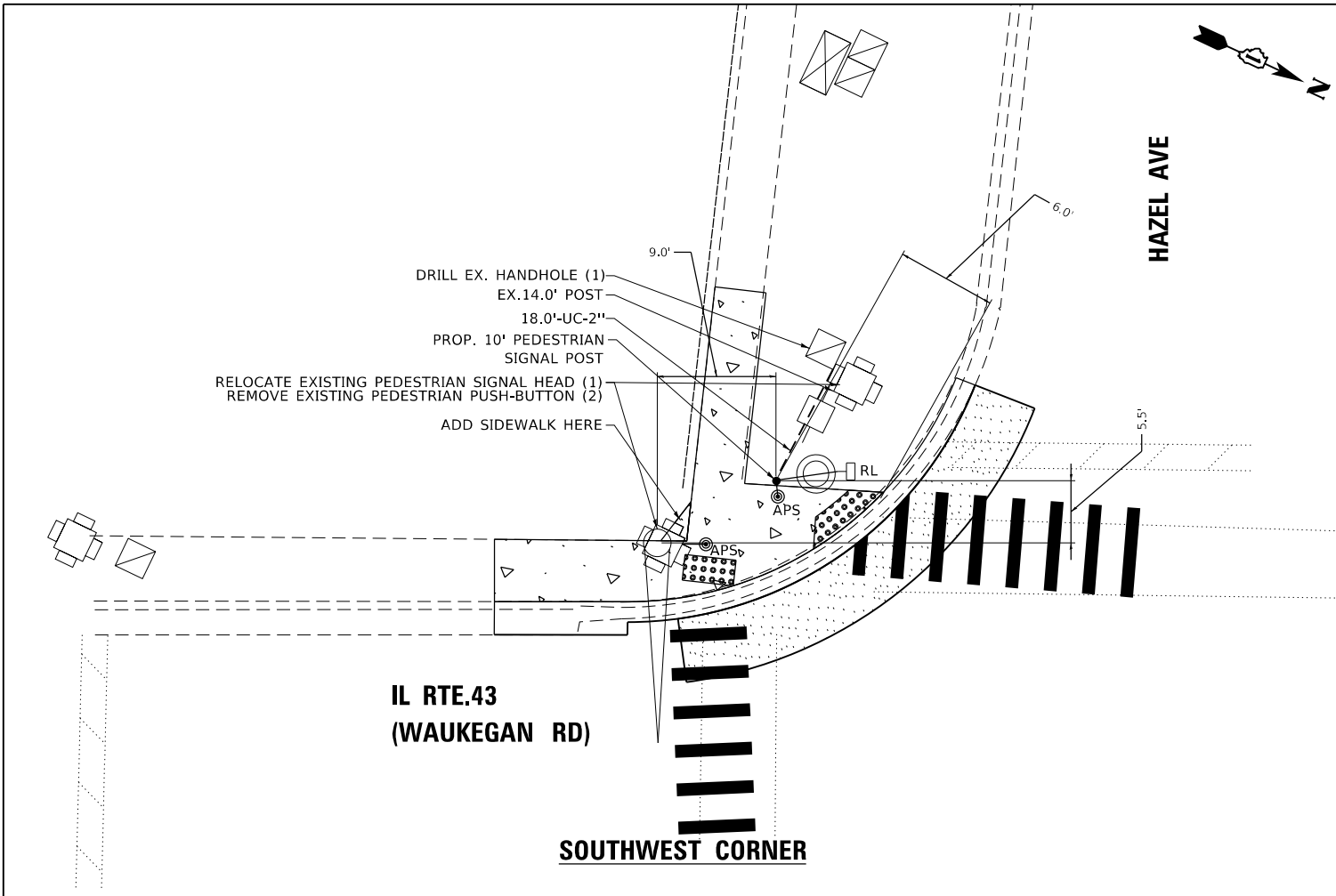

NOTES:
THE PLAN SHEET SHALL BE USED FOR DETERMINING THE EXACT LOCATION OF THE NEW APS PUSH BUTTONS.

TS SHT NO. 5

MODEL: D:\dtd\11...
FILE: Waukegan_Sign\Design\Main\tsht\tsht-no-5_Southwest_Lake.km4; Work\62729.dgn

USER NAME = mrcelmh	DESIGNED - MM	REVISED - ADD 2 - LP - 9-12-23
PLOT SCALE = 40.0000' / in.	DRAWN - MM	REVISED -
PLOT DATE = 7/15/2022	CHECKED - KK	REVISED -
	DATE - 7/15/2022	REVISED -

STATE OF ILLINOIS
DEPARTMENT OF TRANSPORTATION

2 REVISED ENTIRE SHEET 9/13/2023
PORPOSED APS PUSH BUTTONS WITH NEW ADA SIDEWALK PLAN
IL RTE. 43 (WAUKEGAN RD) AT HAZEL AVE / ELDER LN

SCALE: SHEET OF SHEETS STA. TO STA.

F.A. RTE.	SECTION	COUNTY	TOTAL SHEETS	SHEET NO.
	FAU 2706 22 RS	LAKE	72	59E
CONTRACT NO. 62T71				
ILLINOIS FED. AID PROJECT				

TS 12940
ECON 155

EXISTING CONTROLLER SEQUENCE

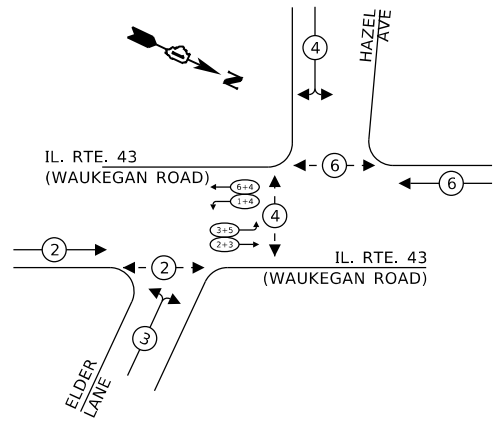

LEGEND:

- ← * → PROTECTED PHASE
- ← - * - → PROTECTED/PERMITTED PHASE
- ← * → PEDESTRIAN PHASE
- ← OL → OVERLAP

EXISTING EMERGENCY VEHICLE PREEMPTION SEQUENCE

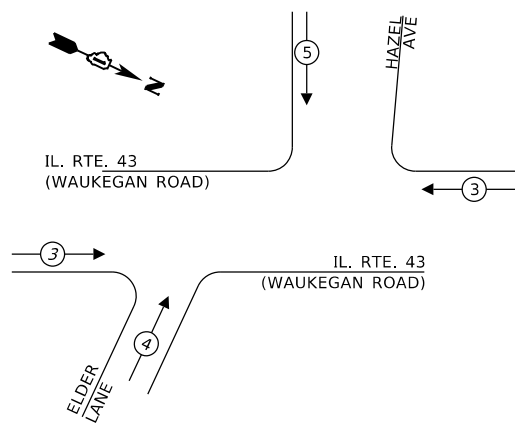

TRAFFIC SIGNAL ELECTRICAL SERVICE REQUIREMENTS

TYPE	NO. OF LAMPS	LED WATTAGE	% OPERATION	TOTAL WATTAGE
SIGNAL (RED)	16	11	50	88.0
(YELLOW)	16	20	5	16.0
(GREEN)	16	12	45	86.4
PERMISSIVE ARROW	8	10	10	8.0
PED. SIGNAL	6	20	100	120.0
CONTROLLER	1	100	100	100.0
UPS	1	25	100	25.0
VIDEO SYSTEM	-	150	100	-
BLANK-OUT SIGN	-	25	5	-
FLASHER	-	-	50	-
STREET NAME SIGN	-	120	50	-
LUMINAIRE	-	-	-	-
TOTAL =				443.4

ENERGY COSTS TO:

VILLAGE OF DEERFIELD
850 WAUKEGAN ROAD
DEERFIELD, IL 60015

ENERGY SUPPLY: CONTACT: TERRI BLECK
PHONE: 847-816-5239
COMPANY: ComEd
ACCOUNT NUMBER: 00171-45050

SCHEDULE OF QUANTITIES

ITEM DESCRIPTION	UNITS	TOTAL QTY
UNDERGROUND CONDUIT, GALVANIZED STEEL, 2" DIA.	FOOT	18
MAINTENANCE OF EXISTING TRAFFIC SIGNAL INSTALLATION.	EACH	1
ELECTRIC CABLE IN CONDUIT, SIGNAL NO. 14 2C.	FOOT	77
ELECTRIC CABLE IN CONDUIT, SIGNAL NO. 14 3C.	FOOT	84
ELECTRIC CABLE IN CONDUIT, EQUIPMENT GROUNDING CONDUCTOR, NO. 6 1C.	FOOT	29
DRILL EXISTING HANDHOLE.	EACH	1
* DETECTOR LOOP, TYPE I.	FOOT	118
RELOCATE EXISTING PEDESTRIAN SIGNAL HEAD.	EACH	1
REMOVE ELECTRIC CABLE FROM CONDUIT.	FOOT	137
REMOVE EXISTING TRAFFIC SIGNAL EQUIPMENT.	EACH	1
PEDESTRIAN SIGNAL POST, 10 FT.	EACH	1
ACCESSIBLE PEDESTRIAN SIGNALS.	EACH	6
CONCRETE FOUNDATION, TYPE A 12-INCH DIAMETER.	FOOT	4

* NOMINAL QUANTITY TO BE USED AS NEEDED AND AS APPROVED BY THE ENGINEER

**IL. RTE. 43
(WAUKEGAN ROAD)**

**IL. RTE. 43
(WAUKEGAN ROAD)**

EX. TRACER CABLE
EX. INTERCONNECT TO DEERFIELD ROAD

CABLE PLAN
(NOT TO SCALE)

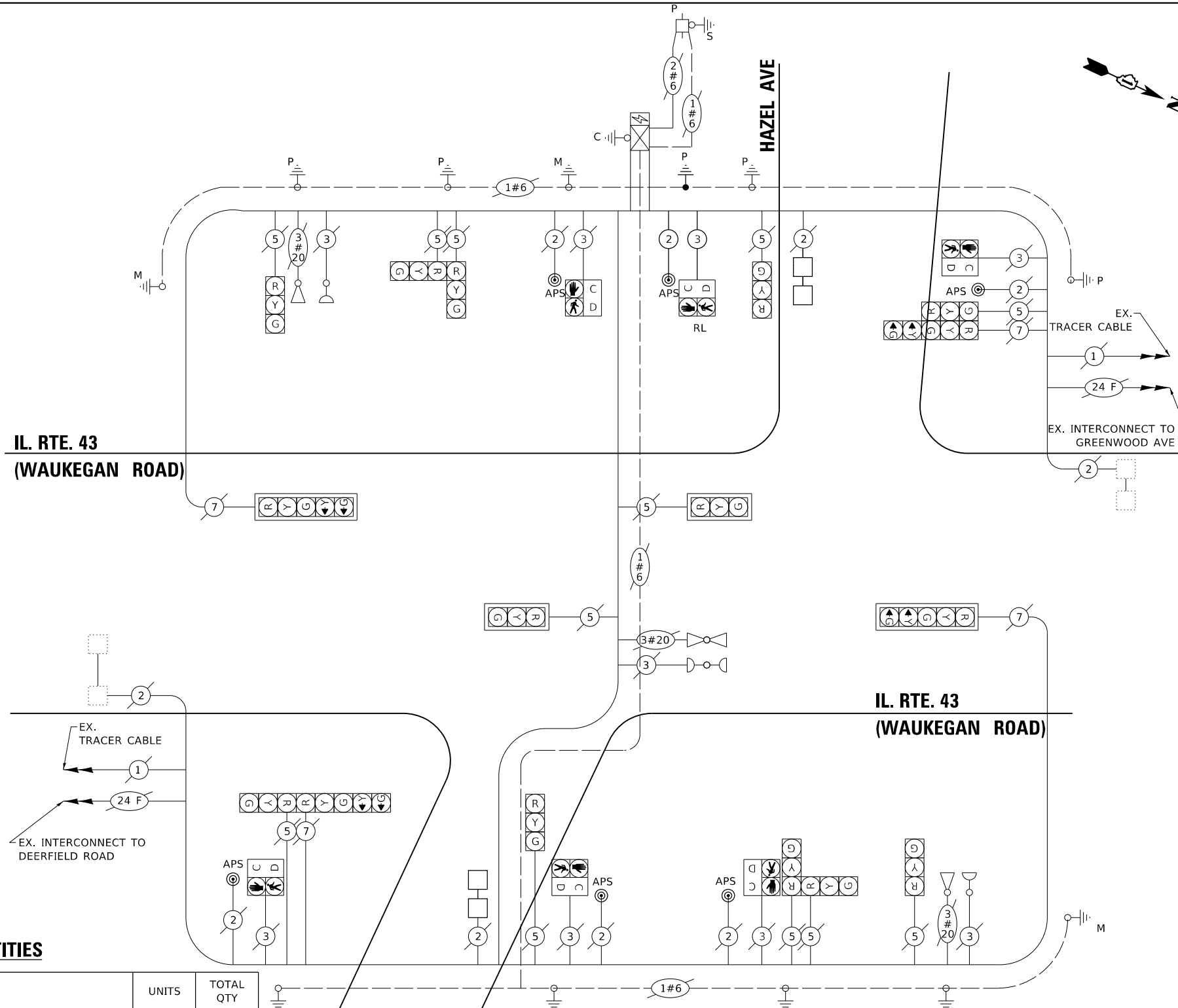

TS SHT NO. 6

MODEL: D:\p\m\ts\12940\CablePlan\12940_CablePlan.dwg
FILE: 12940_CablePlan.dwg
DATE: 7/15/2022

USER NAME = mereimh	DESIGNED - MM	REVISED - ADD 2 - LP - 9-12-23
PLOT SCALE = 40,0000 ' / in.	DRAWN - MM	REVISED -
PLOT DATE = 7/15/2022	CHECKED - KK	REVISED -
	DATE - 7/15/2022	REVISED -

**STATE OF ILLINOIS
DEPARTMENT OF TRANSPORTATION**

**CABLE PLAN, CONTROLLER SEQUENCE AND SCHEDULE OF QUANTITIES
IL. RTE. 43 (WAUKEGAN RD) AT HAZEL AVE / ELDER LN**

SCALE: SHEET OF SHEETS STA. TO STA.

REVISION 2 REVISED ENTIRE SHEET 9/13/2023

**TS 12940
ECON 155**

F.A. RTE.	SECTION	COUNTY	TOTAL SHEETS	SHEET NO.
	FAU 2706 22 RS	LAKE	72	59F
			CONTRACT NO. 62T71	
		ILLINOIS FED. AID PROJECT		

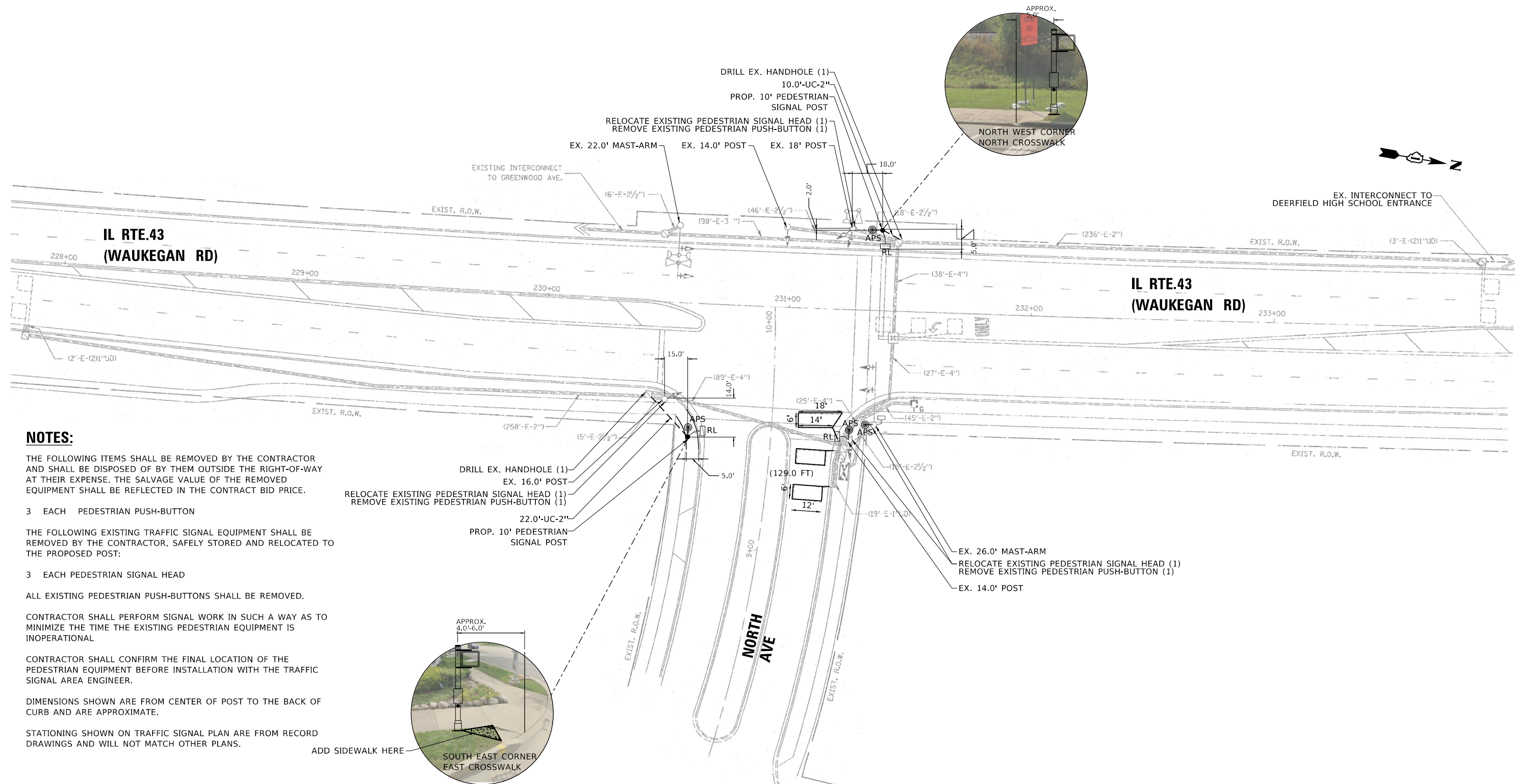

NOTES:

THE FOLLOWING ITEMS SHALL BE REMOVED BY THE CONTRACTOR AND SHALL BE DISPOSED OF BY THEM OUTSIDE THE RIGHT-OF-WAY AT THEIR EXPENSE. THE SALVAGE VALUE OF THE REMOVED EQUIPMENT SHALL BE REFLECTED IN THE CONTRACT BID PRICE.

3 EACH PEDESTRIAN PUSH-BUTTON

THE FOLLOWING EXISTING TRAFFIC SIGNAL EQUIPMENT SHALL BE REMOVED BY THE CONTRACTOR, SAFELY STORED AND RELOCATED TO THE PROPOSED POST:

3 EACH PEDESTRIAN SIGNAL HEAD

ALL EXISTING PEDESTRIAN PUSH-BUTTONS SHALL BE REMOVED.

CONTRACTOR SHALL PERFORM SIGNAL WORK IN SUCH A WAY AS TO MINIMIZE THE TIME THE EXISTING PEDESTRIAN EQUIPMENT IS INOPERATIONAL

CONTRACTOR SHALL CONFIRM THE FINAL LOCATION OF THE PEDESTRIAN EQUIPMENT BEFORE INSTALLATION WITH THE TRAFFIC SIGNAL AREA ENGINEER.

DIMENSIONS SHOWN ARE FROM CENTER OF POST TO THE BACK OF CURB AND ARE APPROXIMATE.

STATIONING SHOWN ON TRAFFIC SIGNAL PLAN ARE FROM RECORD DRAWINGS AND WILL NOT MATCH OTHER PLANS.

- DRILL EX. HANDHOLE (1)
- EX. 16.0' POST
- RELOCATE EXISTING PEDESTRIAN SIGNAL HEAD (1)
- REMOVE EXISTING PEDESTRIAN PUSH-BUTTON (1)
- 22.0'-UC-2"
- PROP. 10' PEDESTRIAN SIGNAL POST

ADD SIDEWALK HERE

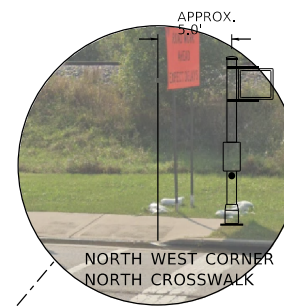
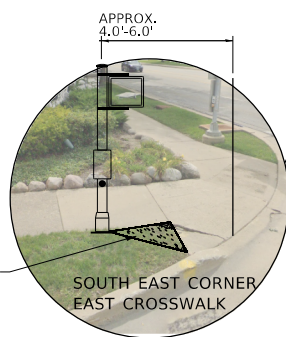

USER NAME = mereimh	DESIGNED - MM	REVISED - ADD 2 - LP - 9-12-23
PLOT SCALE = 40,0000 ' / in.	CHECKED - KK	REVISED -
PLOT DATE = 7/15/2022	DATE - 7/15/2022	REVISED -

F.A. RTE.	SECTION	COUNTY	TOTAL SHEETS	SHEET NO.
	FAU 2706 22 RS	LAKE	72	59G
			CONTRACT NO. 62T71	
		ILLINOIS	FED. AID PROJECT	

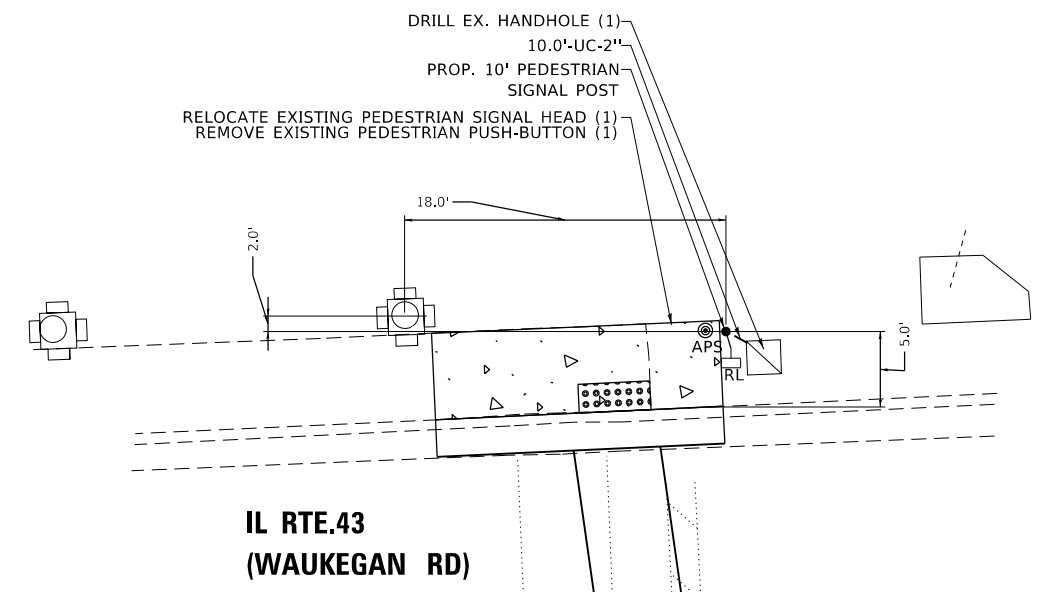

SOUTHWEST CORNER

NORTHWEST CORNER

NOTES:

THE PLAN SHEET SHALL BE USED FOR DETERMINING THE EXACT LOCATION OF THE NEW APS PUSH BUTTONS.

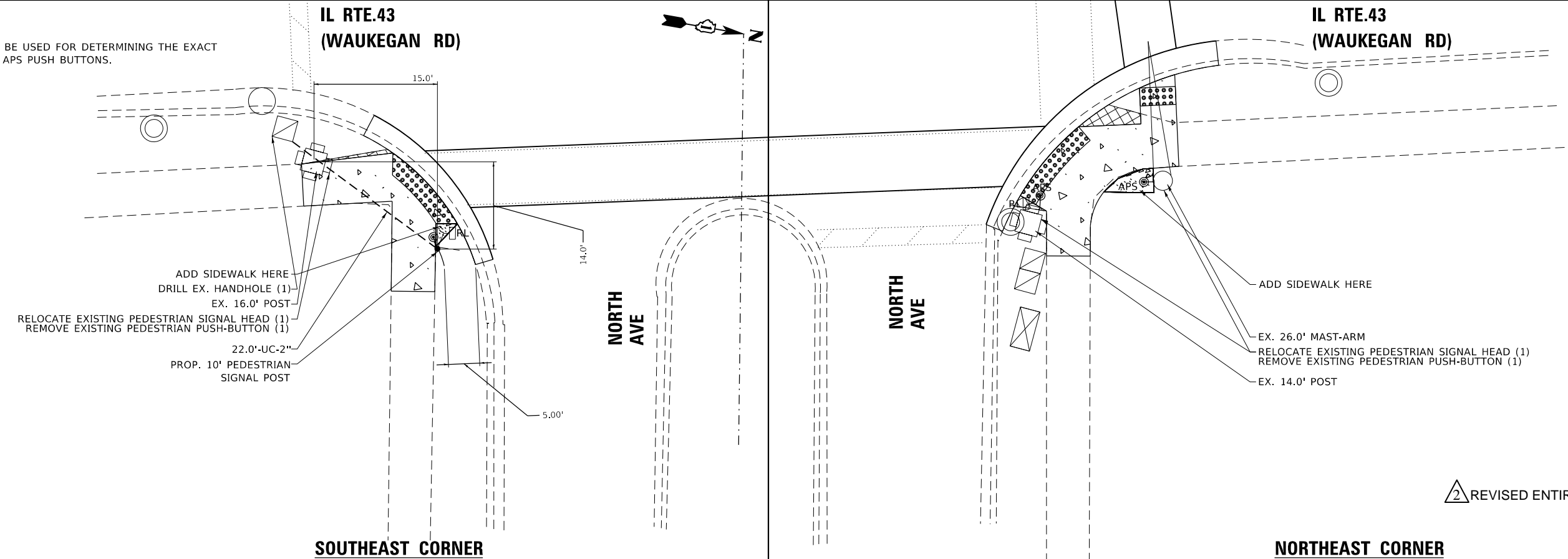

SOUTHEAST CORNER

NORTHEAST CORNER

△ REVISD ENTIRE SHEET 9/13/2023

**TS 12952
ECON 155**

TS SHT NO. 8

MODEL: Default
FILE NAME: S:\V\Projects\Waukegan\Misc\62706\62706_Southwest_Lake.klm; Work\62706.dgn

USER NAME = mereimh	DESIGNED - MM	REVISED - ADD 2 - LP - 9-12-23
PLOT SCALE = 40,0000 ' / in.	DRAWN - MM	REVISED -
PLOT DATE = 7/15/2022	CHECKED - KK	REVISED -
	DATE - 7/15/2022	REVISED -

**STATE OF ILLINOIS
DEPARTMENT OF TRANSPORTATION**

**PORPOSED APS PUSH BUTTONS WITH NEW ADA SIDEWALK PLAN
IL RTE. 43 (WAUKEGAN RD) AT NORTH AVE**

SCALE: SHEET OF SHEETS STA. TO STA.

F.A. RTE.	SECTION	COUNTY	TOTAL SHEETS	SHEET NO.
	FAU 2706 22 RS	LAKE	72	59H
			CONTRACT NO. 62T71	
		ILLINOIS	FED. AID PROJECT	

