

SUMMARY OF QUANTITIES			TOTAL QUANTITIES	CONSTRUCTION TYPE CODE					
CODE NO	ITEM	UNIT		80% FED 20% STATE 0005	100% STATE 0005	80% FED 20% STATE 0021			
20200100	EARTH EXCAVATION	CU YD	305	305					
20800150	TRENCH BACKFILL	CU YD	9	9					
21101615	TOPSOIL FURNISH AND PLACE, 4"	SO YD	1248	1248					
21400100	GRADING AND SHAPING DITCHES	FOOT	1500	1500					
25000210	SEEDING, CLASS 2A	ACRE	0.2	0.2					
25000400	NITROGEN FERTILIZER NUTRIENT	POUND	6.8	6.8					
25000600	POTASSIUM FERTILIZER NUTRIENT	POUND	6.8	6.8					
25100630	EROSION CONTROL BLANKET	SO YD	1000	1000					
25200110	SODDING, SALT TOLERANT	SO YD	1248	1248					
25200200	SUPPLEMENTAL WATERING	UNIT	5.5	5.5					
28000400	PERIMETER EROSION BARRIER	FOOT	540	540					
28100107	STONE RIPRAP, CLASS A4	SO YD	1200	1200					
35501316	HOT-MIX ASPHALT BASE COURSE, 8"	SO YD	140	140					
40600290	BITUMINOUS MATERIALS (TACK COAT)	POUND	48730	48730					
40600370	LONGITUDINAL JOINT SEALANT	FOOT	63344	63344					

SUMMARY OF QUANTITIES			TOTAL QUANTITIES	CONSTRUCTION TYPE CODE					
CODE NO	ITEM	UNIT		80% FED 20% STATE 0005	100% STATE 0005	80% FED 20% STATE 0021			
40600400	MIXTURE FOR CRACKS, JOINTS, AND FLANGEWAYS	TON	163	163					
40600982	HOT-MIX ASPHALT SURFACE REMOVAL - BUTT JOINT	SO YD	393	393					
40604060	HOT-MIX ASPHALT SURFACE COURSE, 1L-9.5, MIX "D", N50	TON	16	16					
40605026	POLYMERIZED HOT-MIX ASPHALT SURFACE COURSE, STONE MATRIX ASPHALT, 9.5, MIX "F", N80	TON	10613	10613					
42001300	PROTECTIVE COAT	SO YD	1912	1912					
42300400	PORTLAND CEMENT CONCRETE DRIVEWAY PAVEMENT, 8 INCH	SO YD	166	166					
42400200	PORTLAND CEMENT CONCRETE SIDEWALK 5 INCH	SO FT	8456	8456					
42400800	DETECTABLE WARNINGS	SO FT	1041	1041					
44000156	HOT-MIX ASPHALT SURFACE REMOVAL, 1 3/4"	SO YD	108288	108288					
44000200	DRIVEWAY PAVEMENT REMOVAL	SO YD	306	306					
44000600	SIDEWALK REMOVAL	SO FT	7461	7461					
	* SPECIALTY ITEM								

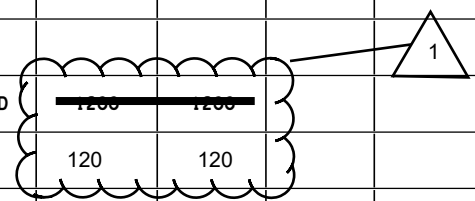

SUMMARY OF QUANTITIES			TOTAL QUANTITIES	CONSTRUCTION TYPE CODE				
CODE NO	ITEM	UNIT		80% FED 20% STATE 0005	100% STATE 0005	80% FED 20% STATE 0021		
44003100	MEDIAN REMOVAL	SO FT	20	20				
44201803	CLASS D PATCHES, TYPE II, 13 INCH	SO YD	690	690				
44201807	CLASS D PATCHES, TYPE III, 13 INCH	SO YD	114	114				
44201809	CLASS D PATCHES, TYPE IV, 13 INCH	SO YD	1187	1187				
48102100	AGGREGATE WEDGE SHOULDER, TYPE B	TON	3.7	3.7				
550A0330	STORM SEWERS, CLASS A, TYPE 2 10"	FOOT	12	12				
55100400	STORM SEWER REMOVAL 10"	FOOT	12	12				
60200305	CATCH BASINS, TYPE A, 4' -DIAMETER, TYPE 3 FRAME AND GRATE	EACH	1	1				
60257900	MANHOLES TO BE RECONSTRUCTED	EACH	5	5				
60266600	VALVE BOXES TO BE ADJUSTED	EACH	13	13				
60300105	FRAMES AND GRATES TO BE ADJUSTED	EACH	59	59				
60300305	FRAMES AND LIDS TO BE ADJUSTED	EACH	10	10				
60404950	FRAMES AND GRATES, TYPE 24	EACH	7	7				
60406000	FRAMES AND LIDS, TYPE 1, OPEN LID	EACH	5	5				
60406100	FRAMES AND LIDS, TYPE 1, CLOSED LID	EACH	20	20				

SUMMARY OF QUANTITIES			TOTAL QUANTITIES	CONSTRUCTION TYPE CODE				
CODE NO	ITEM	UNIT		80% FED 20% STATE 0005	100% STATE 0005	80% FED 20% STATE 0021		
60500050	REMOVING CATCH BASINS	EACH	1	1				
60618750	CONCRETE MEDIAN, TYPE M-4.06	SO FT	21	21				
* 66900200	NON-SPECIAL WASTE DISPOSAL	CU YD	305	305				1
* 66900530	SOIL DISPOSAL ANALYSIS	EACH	3	3				
* 66901001	REGULATED SUBSTANCES PRE-CONSTRUCTION PLAN	L SUM	1	1				
* 66901003	REGULATED SUBSTANCES FINAL CONSTRUCTION REPORT	L SUM	1	1				
* 66901006	REGULATED SUBSTANCES MONITORING	CAL DA	20	20				
67100100	MOBILIZATION	L SUM	1	1				
70102625	TRAFFIC CONTROL AND PROTECTION, STANDARD 701606	L SUM	1	1				
70102630	TRAFFIC CONTROL AND PROTECTION, STANDARD 701601	L SUM	1	1				
70102632	TRAFFIC CONTROL AND PROTECTION, STANDARD 701602	L SUM	1	1				
70102634	TRAFFIC CONTROL AND PROTECTION, STANDARD 701611	L SUM	1	1				
	* SPECIALTY ITEM							

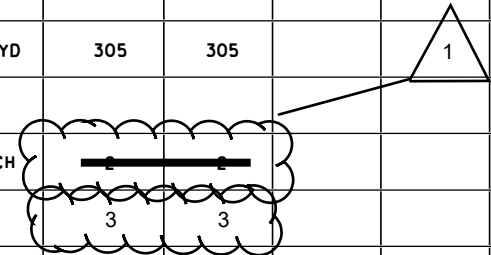



SUMMARY OF QUANTITIES			TOTAL QUANTITIES	CONSTRUCTION TYPE CODE		
CODE NO	ITEM	UNIT		80% FED 20% STATE 0005	100% STATE 0005	80% FED 20% STATE 0021
* 87301225	ELECTRIC CABLE IN CONDUIT, SIGNAL NO. 14 3C	FOOT	885		885	
* 87301900	ELECTRIC CABLE IN CONDUIT, EQUIPMENT GROUNDING CONDUCTOR, NO. 6 1C	FOOT	178		178	
* 87900200	DRILL EXISTING HANDHOLE	EACH	6		6	
* 88102717	PEDESTRIAN SIGNAL HEAD, LED, 1-FACE, BRACKET MOUNTED WITH COUNTDOWN TIMER	EACH	4		4	
* 88102747	PEDESTRIAN SIGNAL HEAD, LED, 2-FACE, BRACKET MOUNTED WITH COUNTDOWN TIMER	EACH	1		1	
* 88600100	DETECTOR LOOP, TYPE I	FOOT	3487		3487	
* 89502350	REMOVE AND REINSTALL ELECTRIC CABLE FROM CONDUIT	FOOT	17		17	
* 89502375	REMOVE EXISTING TRAFFIC SIGNAL EQUIPMENT	EACH	7		7	
* 89502376	REBUILD EXISTING HANDHOLE	EACH	6		6	
X0320050	CONSTRUCTION LAYOUT (SPECIAL)	L SUM	1		1	
X0327611	REMOVE AND REINSTALL EXISTING BRICK PAVERS	SO FT	2000	2000		
X0327989	REMOVE EXISTING BRICK PAVERS	SO FT	585	585		
* X1400378	PEDESTRIAN SIGNAL POST, 5 FT.	EACH	6		6	

SUMMARY OF QUANTITIES			TOTAL QUANTITIES	CONSTRUCTION TYPE CODE		
CODE NO	ITEM	UNIT		80% FED 20% STATE 0005	100% STATE 0005	80% FED 20% STATE 0021
* X1400450	REBUILD EXISTING HEAVY DUTY HANDHOLE	EACH	1		1	
X2020110	GRADING AND SHAPING SHOULDERS	UNIT	2.8	2.8		
X4400501	COMBINATION CURB AND GUTTER REMOVAL AND REPLACEMENT LESS THAN OR EQUAL TO 10 FEET	FOOT	1776	1776		
X4400503	COMBINATION CURB AND GUTTER REMOVAL AND REPLACEMENT GREATER THAN 10 FEET	FOOT	5709	5709		
X5537800	STORM SEWERS TO BE CLEANED 12"	FOOT	1000		1000	
X5538000	STORM SEWERS TO BE CLEANED 18"	FOOT	500		500	
X5538200	STORM SEWERS TO BE CLEANED 24"	FOOT	300		300	
X6030310	FRAMES AND LIDS TO BE ADJUSTED (SPECIAL)	EACH	172	172		
X6700407	ENGINEER'S FIELD OFFICE, TYPE A (D1)	CAL MO	12	12		
* X8140234	REPLACE HANDHOLE COVER	EACH	5		5	
* X8760200	ACCESSIBLE PEDESTRIAN SIGNALS	EACH	38		38	
* X8780012	CONCRETE FOUNDATION, TYPE A 12-INCH DIAMETER	FOOT	24		24	
	* SPECIALTY ITEM					

FILE NAME =	USER NAME = connor.mullane	DESIGNED -	REVISED - CM 8/31/2023
pw:\N\dot-pw-bentley.com\PW\DOT\Documents\UDOT	Projects\DI\31522\CAD\Drawn\Design\DI\31522-st-500	DRAWN -	REVISED -
	PLOT SCALE = 100.0000' / 1in	CHECKED -	REVISED -
	PLOT DATE = 6/30/2023	DATE -	REVISED -

**STATE OF ILLINOIS  
DEPARTMENT OF TRANSPORTATION**

**IL 43 ( WAUKEGAN RD) SOUTH OF IL 22 TO LAKE COOK RD  
SUMMARY OF QUANTITIES**

F.A. RTE.	SECTION	COUNTY	TOTAL SHEETS	SHEET NO.
2706	FAU 2706 22 RS	LAKE	72	6
CONTRACT NO. 62T71				
FED. ROAD DIST. NO. 1 ILLINOIS FED. AID PROJECT				

SCALE: SHEET NO. OF SHEETS STA. TO STA.

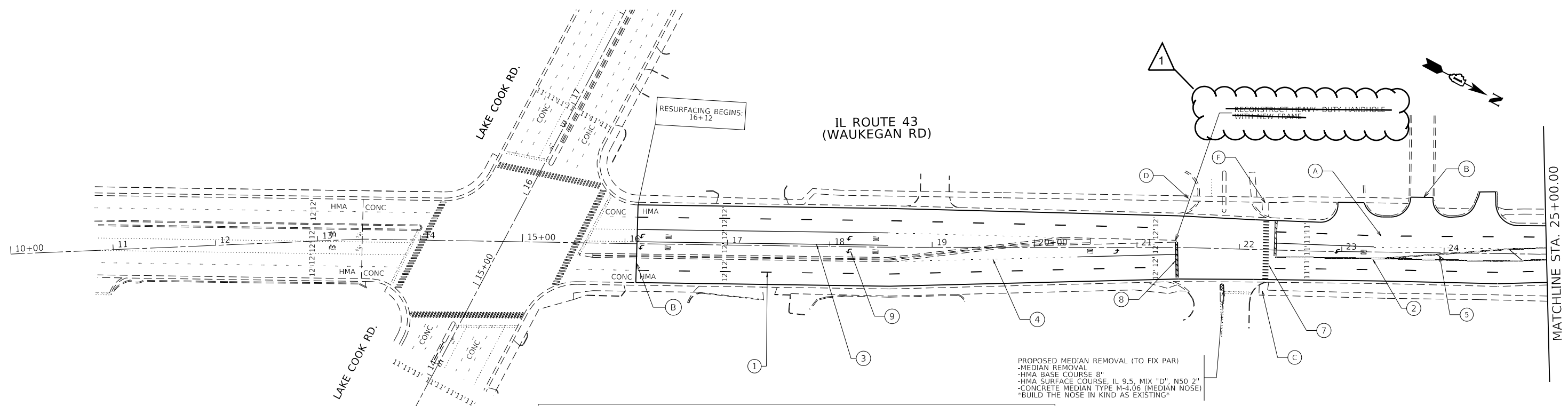

**ROADWAY AND SIDEWALK LEGEND**

(A)	PROP. HMA SURFACE REMOVAL, 1 3/4" PROP. POLYMERIZED HMA SC SMA 9.5, MIX F, N80; 1 3/4"
(B)	PROP. HMA SURFACE REMOVAL- BUTT JOINT (4.5' WIDE, TYP)
(C)	PROP. CURB RAMP IMPROVEMENT, SEE SIDEWALK DETAIL
(D)	PROP. CURB RAMP IMPROVEMENT, USE PD-01B
(E)	PROP. CURB RAMP IMPROVEMENT, USE PD-01C
(F)	PROP. CURB RAMP IMPROVEMENT, USE PD-03A
(G)	PROP. CURB RAMP IMPROVEMENT, REPLACE DETECTABLE WARING TILE

**PAVEMENT MARKING LEGEND**

(1)	PROP. THERMOPLASTIC PVMT MARKING LINE 4", 10' DASH 30' SKIP, WHITE (TYP.)	(6)	PROP. THERMOPLASTIC PVMT MARKING LINE 12", CONTINENTAL CROSSWALK, WHITE (TYP.)
(2)	PROP. THERMOPLASTIC PVMT MARKING LINE 4", DOUBLE YELLOW @ 11" C-C (TYP.)	(7)	PROP. THERMOPLASTIC PVMT MARKING LINE 6", CROSSWALK, WHITE (TYP.)
(3)	PROP. THERMOPLASTIC PVMT MARKING LINE 6", WHITE (TYP.)	(8)	PROP. THERMOPLASTIC PVMT MARKING LINE 24", STOPBAR, WHITE (TYP.)
(4)	PROP. THERMOPLASTIC PVMT MARKING LINE 6", 2' DASH 6' SKIP, WHITE (TYP.)	(9)	PROP. THERMOPLASTIC PVMT MARKING, LETTERS AND SYMBOLS, WHITE (TYP.)
(5)	PROP. THERMOPLASTIC PVMT MARKING LINE 12", DIAGONALS, YELLOW (TYP.)		

**NOTES**

- 1) ALL FINAL PAVEMENT MARKINGS SHALL BE PLACED IN ACCORDANCE WITH DISTRICT ONE DETAILS TC-11 AND TC-13
- 2) ALL RAISED REFLECTIVE PAVEMENT MARKERS SHALL BE PLACED IN ACCORDANCE WITH TC-11 AND TC-12 DISTRICT ONE STANDARD DETAIL.

PROPOSED MEDIAN REMOVAL (TO FIX PAR)  
 -MEDIAN REMOVAL  
 -HMA BASE COURSE 8"  
 -HMA SURFACE COURSE, IL 9.5, MIX "D", N50 2"  
 -CONCRETE MEDIAN TYPE M-4.06 (MEDIAN NOSE)  
 \*BUILD THE NOSE IN KIND AS EXISTING\*

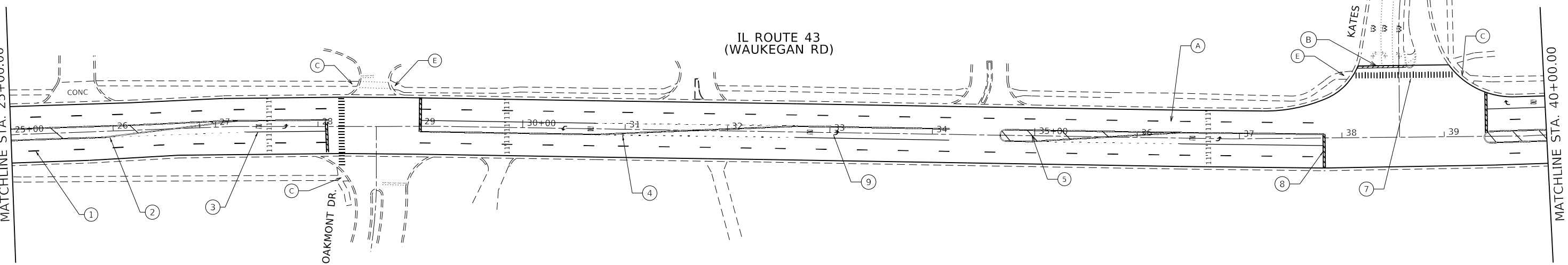

1 REVISED SHEET 9/8/2023

MODEL: Default  
 FILE: \\s:\caw\benetley.com\PI\DOT\Documents\DOT Office\Drawings\1\Projects\131522\CADD\Drawings\131522-Sub\plan.dgn

USER NAME = connor.mullane	DESIGNED -	REVISED - CM 9/7/2023
PLOT SCALE = 100,0000' / in.	DRAWN -	REVISED -
PLOT DATE = 8/8/2023	CHECKED -	REVISED -
	DATE -	REVISED -

**STATE OF ILLINOIS  
 DEPARTMENT OF TRANSPORTATION**

**ROADWAY PLAN**  
**IL. ROUTE 43 (S.E. OF HALF DAY RD. TO LAKE - COOK RD.)**  
 SCALE: 1"=50'    SHEET 1 OF 7 SHEETS    STA. 16+12 TO STA. 192+95

F.A. RTE.	SECTION	COUNTY	TOTAL SHEETS	SHEET NO.
2706	FAU 2706 22 RS	LAKE	72	12
CONTRACT NO. 62T71				
ILLINOIS FED. AID PROJECT				

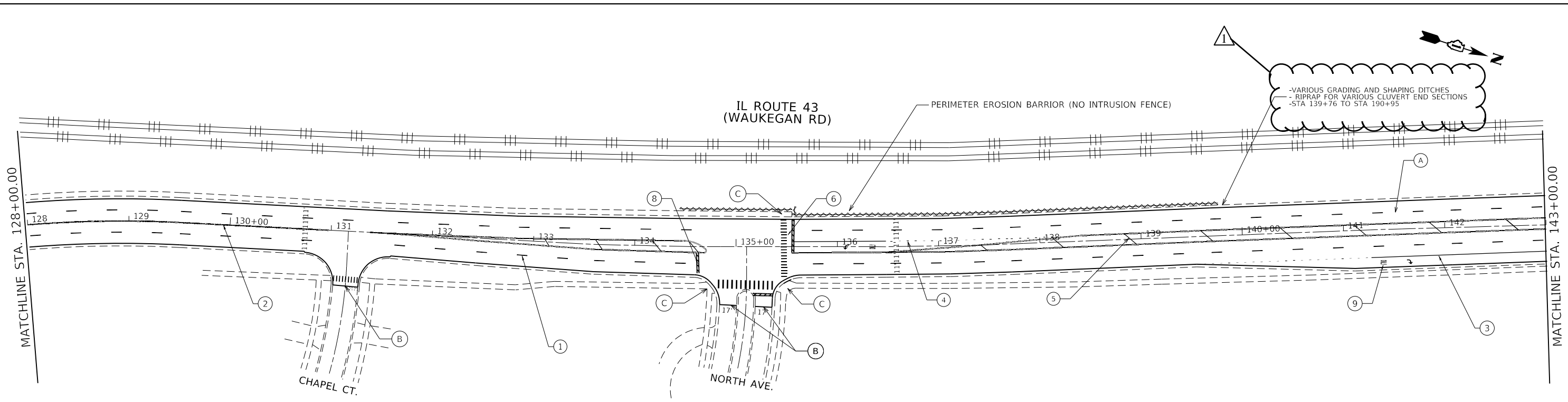

ROADWAY AND SIDEWALK LEGEND	
(A)	PROP. HMA SURFACE REMOVAL, 1 3/4" PROP. POLYMERIZED HMA SC SMA 9.5, MIX F, N80; 1 3/4"
(B)	PROP. HMA SURFACE REMOVAL- BUTT JOINT (4.5' WIDE, TYP)
(C)	PROP. CURB RAMP IMPROVEMENT, SEE SIDEWALK DETAIL
(D)	PROP. CURB RAMP IMPROVEMENT, USE PD-01B
(E)	PROP. CURB RAMP IMPROVEMENT, USE PD-01C
(F)	PROP. CURB RAMP IMPROVEMENT, USE PD-03A
(G)	PROP. CURB RAMP IMPROVEMENT, REPLACE DETECTABLE WARING TILE

PAVEMENT MARKING LEGEND			
(1)	PROP. THERMOPLASTIC PVMT MARKING LINE 4", 10' DASH 30' SKIP, WHITE (TYP.)	(6)	PROP. THERMOPLASTIC PVMT MARKING LINE 12", CONTINENTAL CROSSWALK, WHITE (TYP.)
(2)	PROP. THERMOPLASTIC PVMT MARKING LINE 4", DOUBLE YELLOW @ 11" C-C (TYP.)	(7)	PROP. THERMOPLASTIC PVMT MARKING LINE 6", CROSSWALK, WHITE (TYP.)
(3)	PROP. THERMOPLASTIC PVMT MARKING LINE 6", WHITE (TYP.)	(8)	PROP. THERMOPLASTIC PVMT MARKING LINE 24", STOPBAR, WHITE (TYP.)
(4)	PROP. THERMOPLASTIC PVMT MARKING LINE 6", 2' DASH 6' SKIP, WHITE (TYP.)	(9)	PROP. THERMOPLASTIC PVMT MARKING, LETTERS AND SYMBOLS, WHITE (TYP.)
(5)	PROP. THERMOPLASTIC PVMT MARKING LINE 12", DIAGONALS, YELLOW (TYP.)		

**NOTES**

1) ALL FINAL PAVEMENT MARKINGS SHALL BE PLACED IN ACCORDANCE WITH DISTRICT ONE DETAILS TC-11 AND TC-13

2) ALL RAISED REFLECTIVE PAVEMENT MARKERS SHALL BE PLACED IN ACCORDANCE WITH TC-11 AND TC-12 DISTRICT ONE STANDARD DETAIL.

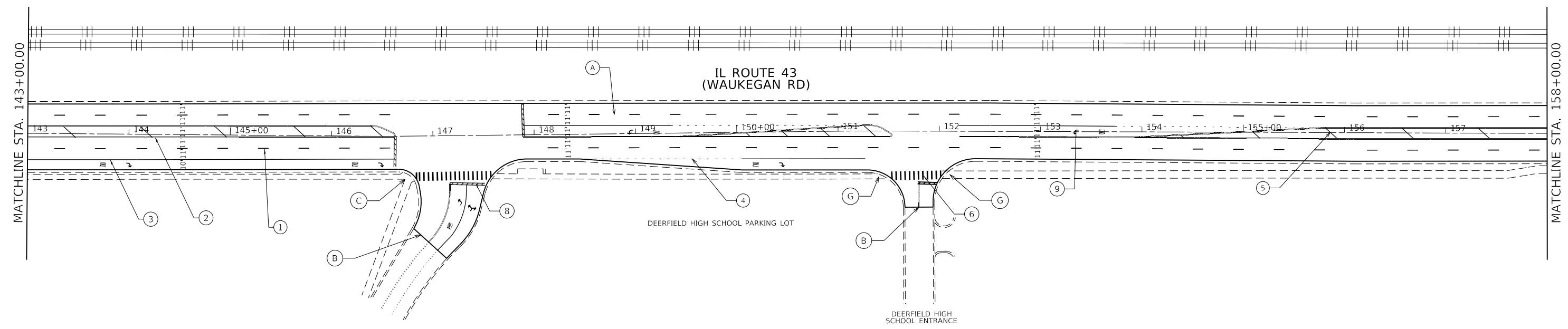

MODEL: Default  
 FILE: \\s:\caw\benetley.com\PI\DOT\Documents\DOT Office\B\Bartlett: I:\Projects\131522\CO\Drawings\Drawings\131522-sht-16-ban.dgn

REVISION SYMBOL: REVISED SHEET 9/8/2023

USER NAME = connor.mullane	DESIGNED -	REVISED - CM 9/6/2023
PLOT SCALE = 100.0000' / in.	DRAWN -	REVISED -
PLOT DATE = 9/6/2023	CHECKED -	REVISED -
	DATE -	REVISED -

**STATE OF ILLINOIS**  
**DEPARTMENT OF TRANSPORTATION**

**ROADWAY PLAN**  
**IL. ROUTE 43 (S.E. OF HALF DAY RD. TO LAKE - COOK RD.)**  
 SCALE: 1"=50'    SHEET 5 OF 7 SHEETS    STA. 16+12 TO STA. 192+95

F.A.U. RTE.	SECTION	COUNTY	TOTAL SHEETS	SHEET NO.
2706	FAU 2706 22 RS	LAKE	72	16
CONTRACT NO. 62T71				
ILLINOIS FED. AID PROJECT				