

STATE OF ILLINOIS  
DEPARTMENT OF TRANSPORTATION

|                       |                 |                  |              |           |                          |
|-----------------------|-----------------|------------------|--------------|-----------|--------------------------|
| ROUTE NO.             | SECTION         | COUNTY           | TOTAL SHEETS | SHEET NO. | SHEET NO. 2<br>10 SHEETS |
| F.A.P. 817            | 8BR-2,<br>8BR-3 | WASHINGTON       | 52           | 21        |                          |
| FED. ROAD DIST. NO. 7 | ILLINOIS        | FED. AID PROJECT |              |           |                          |

Contract #76946

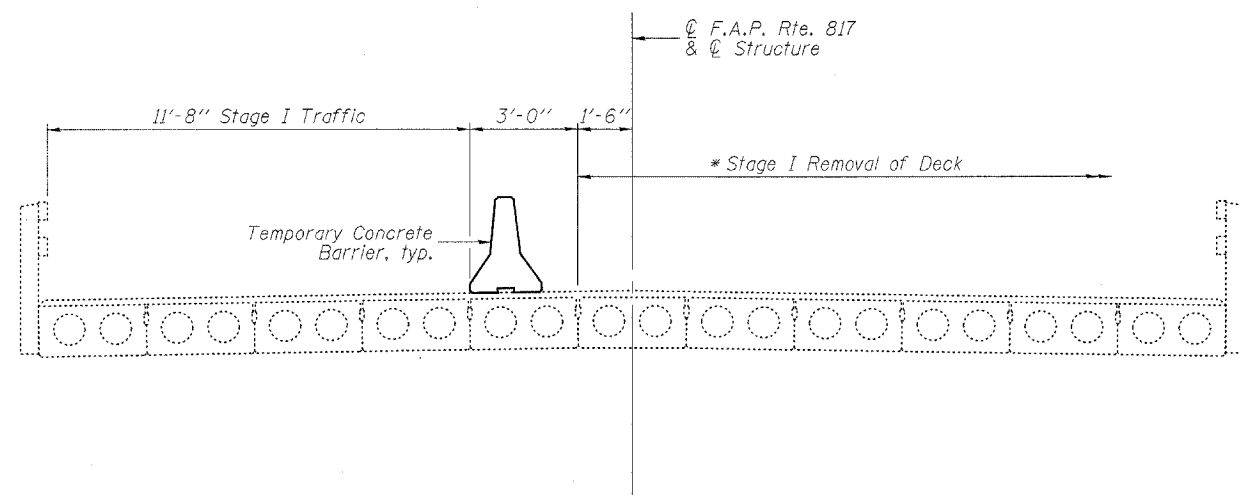

**STAGE I REMOVAL**

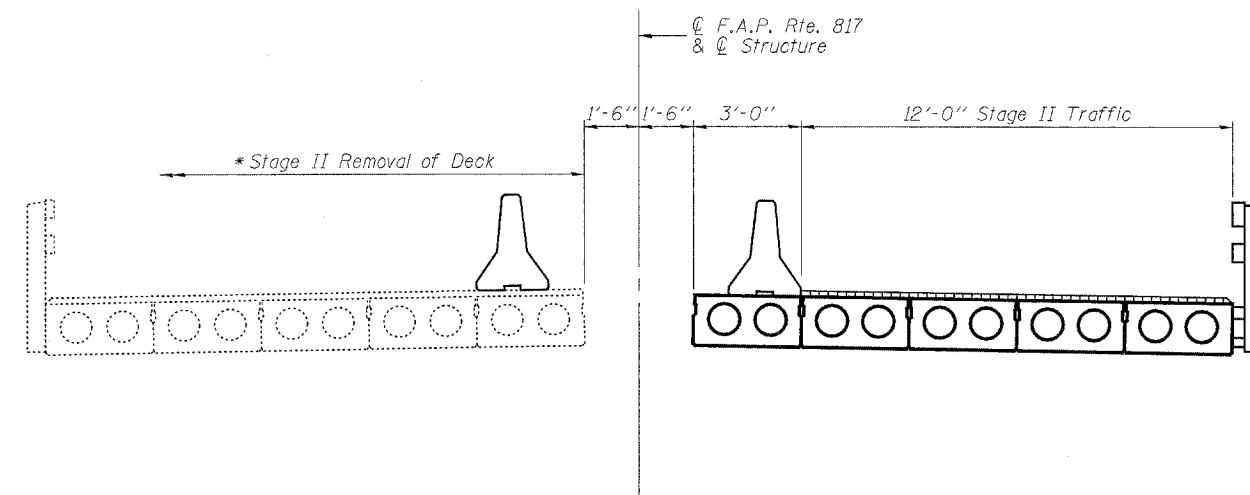

**STAGE II REMOVAL**

\* The Contractor is required to brace the abutments at the beam seats longitudinally prior to the deck beam removal process. The braces shall stay in place until all new deck beams are doweled into position. This is to prevent the development of excessive stresses in the abutments during construction. Bracing details and computations are to be submitted to the Engineer for approval. The cost is included in Removal of Existing Superstructures.

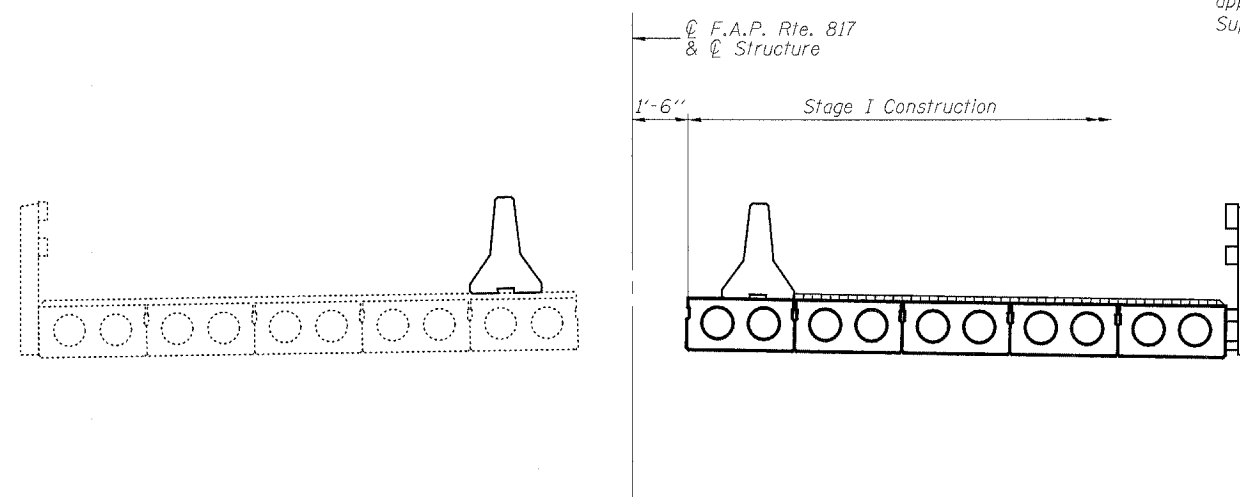

**STAGE I CONSTRUCTION**

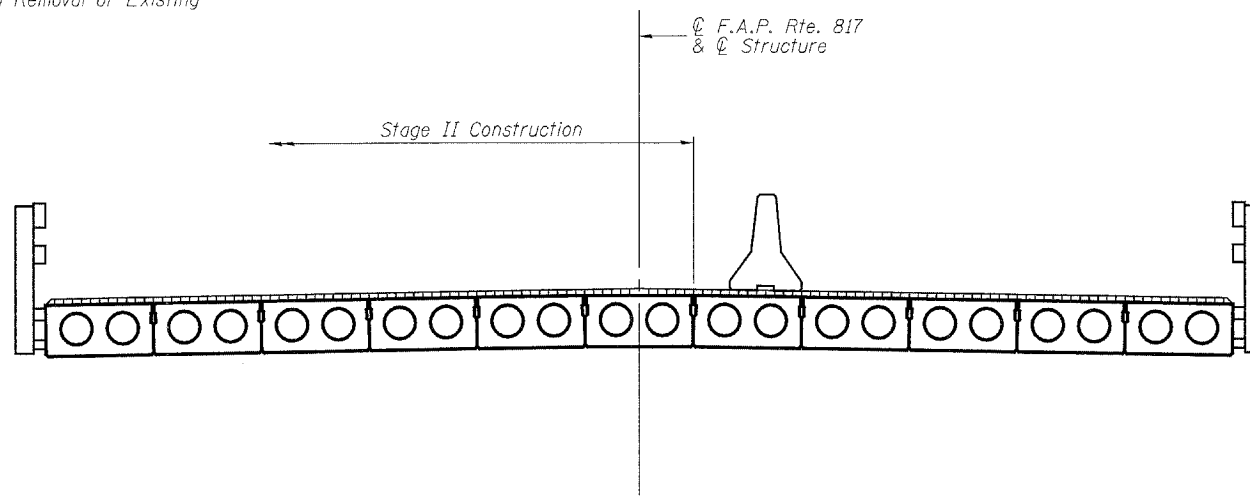

**STAGE II CONSTRUCTION**

Notes:  
All sections are looking East.  
For quantity of Temporary Concrete Barrier, see roadway plans.  
For details of Temporary Concrete Barrier, see sheet 3 of 10.  
For requirements for lapping waterproofing membrane, see notes on sheet 3 of 10.

|          |     |
|----------|-----|
| DESIGNED | EML |
| CHECKED  | NJM |
| DRAWN    | EML |
| CHECKED  | NJM |

**HORNER & SHIFRIN, INC.**  
ENGINEERS ■ ARCHITECTS ■ PLANNERS

**STAGE CONSTRUCTION DETAILS**  
**F.A.P. ROUTE 817 - SECTION 8BR-2**  
**WASHINGTON COUNTY**  
**STATION 25+18.00**  
**STRUCTURE NO. 095-0010**