

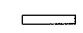



F.A.P. RTE.	SECTION	COUNTY	TOTAL SHEETS	SHEET NO.
817	8BR-2	WASHINGTON	52	13
STA. 22+20		TO STA. 28+20		
FED. ROAD DIST. NO.		ILLINOIS FED. AID PROJECT		

LEGEND

-  IMPACT ATTENUATOR
-  TEMPORARY CONCRETE BARRIER
-  BARRELS OR BARRICADES WITH STEADY BURNING LIGHT
-  TEMPORARY BRIDGE TRAFFIC SIGNALS
-  TYPE III BARRICADE

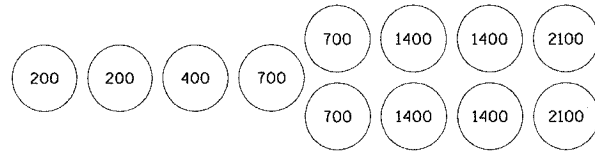

SAND BARREL LAYOUT  
(IF OPTION USED)

EXIST. CURVE C1  
PI STA. = 23+58.51  
 $\Delta = 4^\circ 41' 55''$  (RT)  
 $D = 1^\circ 19' 03''$   
 $R = 4,348.51'$   
 $T = 178.40'$   
 $L = 356.60'$   
 $E = 3.66'$   
 $e = \dots$   
 $T.R. = \dots$   
 $S.E. RUN = \dots$   
 $P.C. STA. = 21+80.11$   
 $P.T. STA. = 25+36.71$

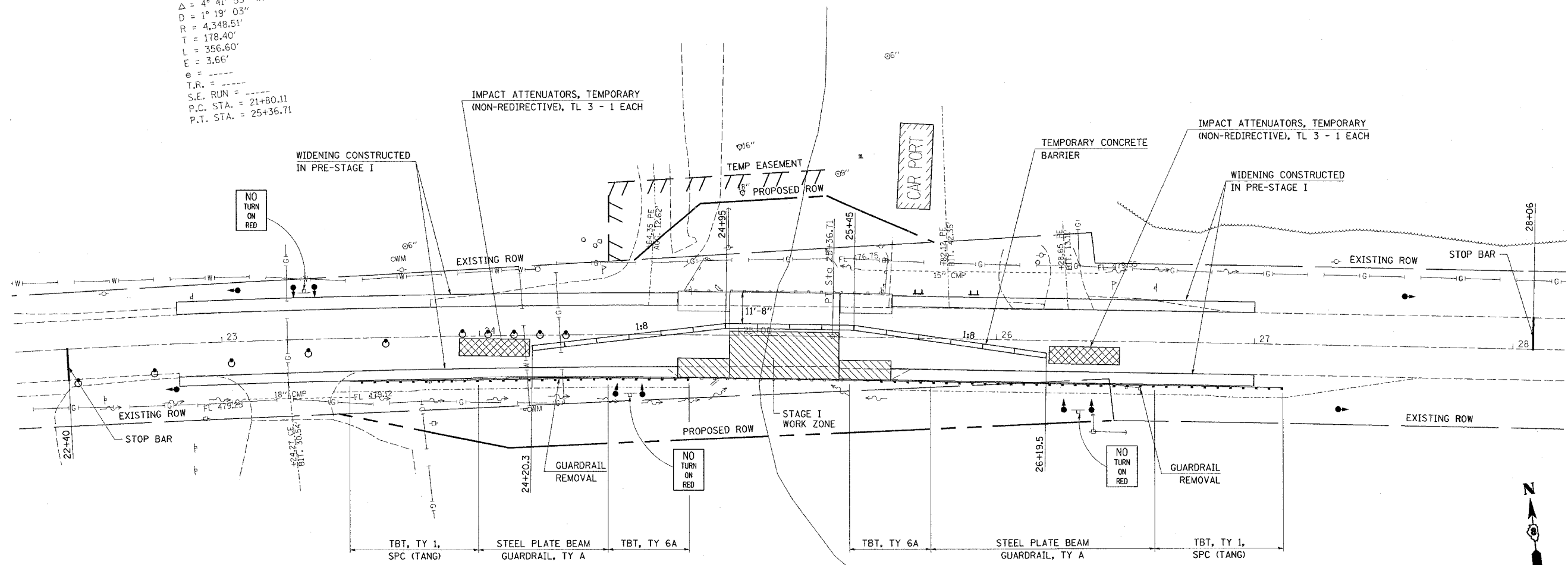

SEQUENCE OF CONSTRUCTION:

THE CONTRACTOR SHALL GIVE ILLINOIS DEPARTMENT OF TRANSPORTATION, BUREAU OF OPERATIONS TWO WEEKS NOTICE FOR PREPARATION OF THE STATE FURNISHED TRAFFIC CONTROLLER. THE CONTRACTOR SHALL PICK UP THE TRAFFIC CONTROLLER AT THE T.M. BUILDING.

PLACE STOP BARS AS SHOWN ON PLANS.

PLACE TEMPORARY RUMBLE STRIPS (3 EACH) EAST OF STRUCTURE FOR WESTBOUND TRAFFIC.

REMOVE CENTERLINE AND CONFLICTING SOLID EDGE PAVEMENT MARKINGS BETWEEN STOP BARS.

PLACE 200 FT TEMPORARY CONCRETE BARRIER AND 2 EACH IMPACT ATTENUATORS, TEMPORARY.

SEE STANDARD 701321 FOR DETAILS NOT SHOWN ON PLANS.

PERFORM ALL NECESSARY BRIDGE WORK IN STAGE I WORK ZONE.

REMOVE EXISTING GUARDRAIL ON SOUTH SIDE AND REPLACE WITH PROPOSED STEEL PLATE BEAM GUARDRAIL, TYPE A, TBT TYPE 6A AND TBT, TYPE 1 (SPECIAL) TANGENT IN SW AND SE QUADRANTS



REVISIONS	
NAME	DATE

ILLINOIS DEPARTMENT OF TRANSPORTATION  
**STAGE CONSTRUCTION**  
**STAGE I**  
FAP ROUTE 817  
SECTION 8BR-2  
WASHINGTON COUNTY  
SN 095-0010

PLOT DATE = 7/19/2006  
 FILE NAME = C:\Users\jg898989\Documents\817\817.dgn  
 PLOT SCALE = 20.000000 / IN.  
 USER NAME = jg898989