

F.A. RTE.	SECTION	COUNTY	TOTAL SHEETS	SHEET NO.
599	(26-15DM)	ROCK ISLAND	116	58
STA.		TO STA.		
FED. ROAD DIST. NO.		ILLINOIS FED. AID PROJECT		

DETOUR ROUTE DETAILS

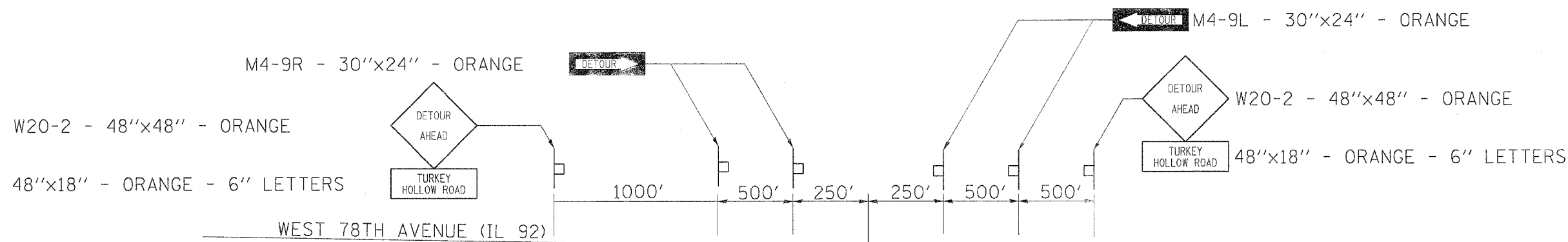

- M1-I100 - 24"x24" - WHITE *
- M6-4 - 21"x15" - WHITE
- M4-6 - 24"x12" - ORANGE
- M4-8 - 24"x12" - ORANGE

- M4-6 - 24"x12" - ORANGE ***
- M4-8 - 24"x12" - ORANGE

NOTE:
 DETOUR SIGNING WILL BE DONE BY THE CONTRACTOR

* PLACE SIGNS 100' TO 200' IN ADVANCE OF INTERSECTION
 ** PLACE SIGNS 200' TO 250' IN ADVANCE OF INTERSECTION
 *** PLACE SIGNS ± 100' IN ADVANCE OF INTERSECTION

W20-2 - 48"x48" - ORANGE
 48"x18" - ORANGE - 6" LETTERS

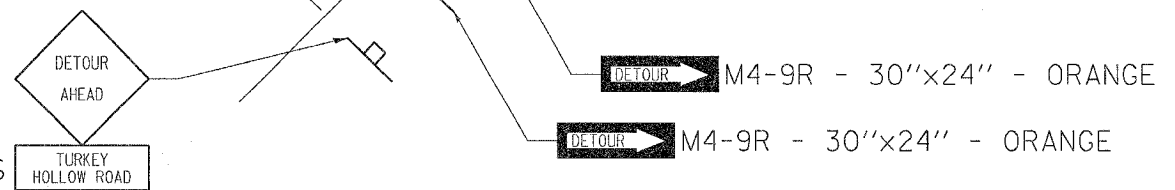

REVISIONS		ILLINOIS DEPARTMENT OF TRANSPORTATION
NAME	DATE	
		SCALE: VERT. DATE: HORIZ. DRAWN BY: CHECKED BY:

PLOT DATE = Wed Jul 21 11:00:23 2006
 FILE NAME = c:\p\projects\64a46\64a46.dwg
 PLOT SCALE = 3/8"=1'-0"
 USER NAME = mg11j