

DATE	
BY	
SURVEYED	
PLOTTED	
TEMPLATE	
NOTE BOOK	
NO.	

DATE	
BY	
SURVEYED	
PLOTTED	
TEMPLATE	
NOTE BOOK	
NO.	

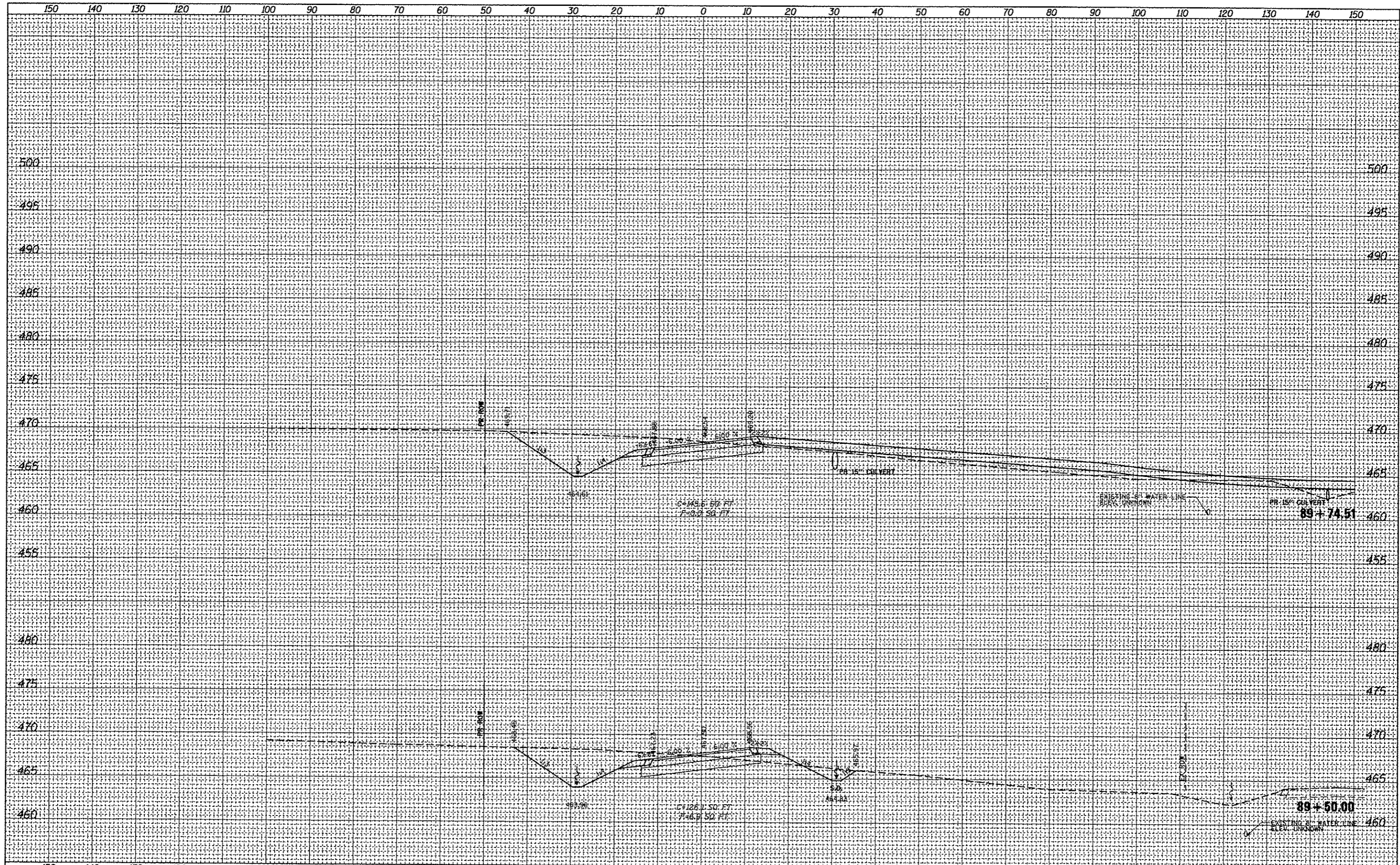

FILE NAME =	USER NAME = bergmd	DESIGNED -	REVISED -	STATE OF ILLINOIS DEPARTMENT OF TRANSPORTATION	PROPOSED SHATTUC CROSS SECTIONS	F.A.P. RTE.	SECTION	COUNTY	TOTAL SHEETS	SHEET NO.	
ar\pwwork\psvdat\bergmd\08389875\0876053-ah.t	xxah.t.dgn	DRAWN -	REVISED -			327	21-1-1, 27-1	CLINTON	96	45	
	PLOT SCALE = 20,0000' / in.	CHECKED -	REVISED -			CONTRACT NO. 76D53					
	PLOT DATE = 6/15/2012	DATE -	REVISED -			ILLINOIS FED. AID PROJECT					
SCALE:						SHEET 10 OF 21 SHEETS STA. 89+50.00 TO STA. 89+74.51					