

SHEET INDEX		
SHEET NO.	STATION TO STATION	DESCRIPTION
1	-	COVER SHEET
2	-	GENERAL NOTES
3	696+40 to 712+16	PLAT OF HIGHWAYS
4	86+67 to 95+82	PLAT OF HIGHWAYS
5	79+99 to 87+97	PLAT OF HIGHWAYS
6	-	TOTAL HOLDING DETAIL

STATE OF ILLINOIS
DEPARTMENT OF TRANSPORTATION
DIVISION OF HIGHWAYS
PLAT OF HIGHWAYS
FAP ROUTE 327 (US ROUTE 50)
SECTION 21-1-1, 27-1
CLINTON COUNTY
JOB NO.
R-98-002-10

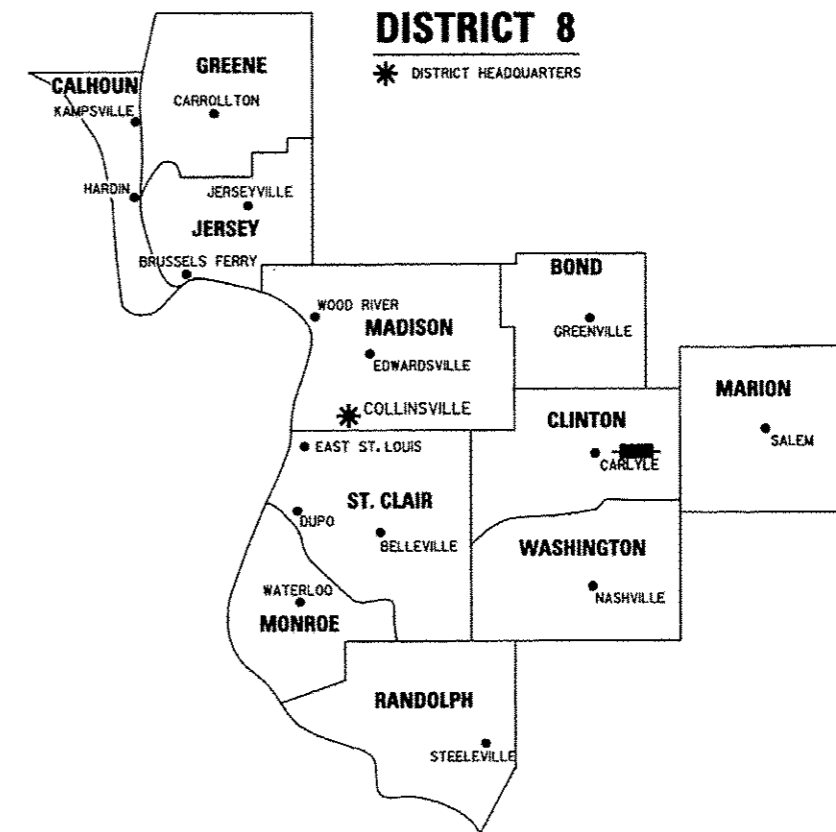
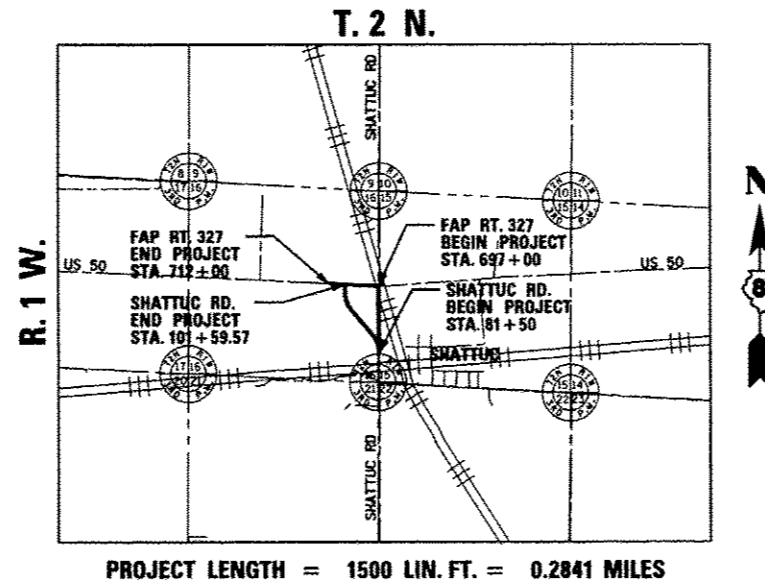

LOCATION OF SECTION INDICATED THUS:

PREPARED BY:

HDR HDR Engineering, Inc.
 1339 Walnut St. Murphysboro, IL 62966-2026
 618-664-5808
 Illinois Professional Design Firm #184000629

Gary W. Raines APRIL 25, 2011

GARY W. RAINES, PLS. NO. 2428
 LICENSE EXPIRATION DATE: 11/30/2012



SHEET 1 OF 6

ILLINOIS DEPARTMENT OF TRANSPORTATION DIVISION OF HIGHWAYS/REGION 5/DISTRICT 8 1102 EASTPORT PLAZA DRIVE COLLINSVILLE, ILLINOIS 62234-6198				
F.A.P. RYE	SECTION	COUNTY	TOTAL SHEETS	SHEET NO.
327	21-1-J, 27-1	CLINTON	96	25
CONTRACT NO. 76D53				
FED. ROAD DIST. NO. - ILLINOIS FED. AID PROJECT				