

STAGE 1 SUGGESTED SEQUENCE OF OPERATIONS

LEGEND

PROPOSED PAVEMENT PATCHING, TYPE III
10 INCH

1. TRAFFIC CONTROL WILL BE INSTALLED ACCORDING TO HIGHWAY STANDARD 701201 AT THE LOCATIONS WHERE CULVERTS ARE BEING INSTALLED OR THE EXISTING CULVERTS ARE BEING REMOVED AND REPLACED, OR EXTENDED. THIS WORK WILL BE COMPLETED UNDER TRAFFIC. OVERNIGHT LANE CLOSURES WILL NOT BE ALLOWED TO COMPLETE THIS WORK. IF THE CONTRACTOR ELECTS TO CONTINUE CONSTRUCTION ACTIVITIES INTO THE EVENING HOURS, HE SHALL TRANSITION THE TRAFFIC CONTROL INTO HIGHWAY STANDARDS 701206.

THE EXISTING CULVERT AT STATION 85+25 (EXISTING SHATTUC ROAD) SHALL
2. BE REMOVED AND REPLACED. THE EXISTING PAVEMENT SHALL BE PATCHED WITH PAVEMENT PATCHING, TYPE III, 10 INCH.

3. INSTALL THE PROPOSED TEMPORARY PIPE CULVERT AT STATION 88+00 (EXISTING SHATTUC ROAD) REGRADE AND CUT DITCHES AS NECESSARY TO MAINTAIN POSITIVE DRAINAGE AND INSTALL PAVEMENT PATCHING.

4. EXTEND THE BOX CULVERT AT STA. 698+72.36 (US 50)

5. INSTALL THE PROPOSED TEMPORARY CULVERT, CATCH BASIN AND TYPE IV FRAME AND GRATE AT STA 105+82.5 FOR THE RUNAROUND.

6. CONSTRUCT THE RUNAROUND, CONSTRUCT PORTIONS OF PROPOSED SHATTUC ROAD AND SERVICE DRIVE AND CONSTRUCT WIDENING ON US 50.

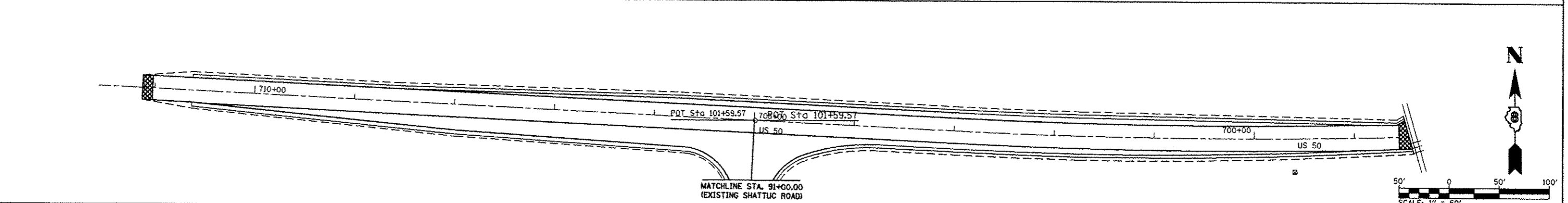
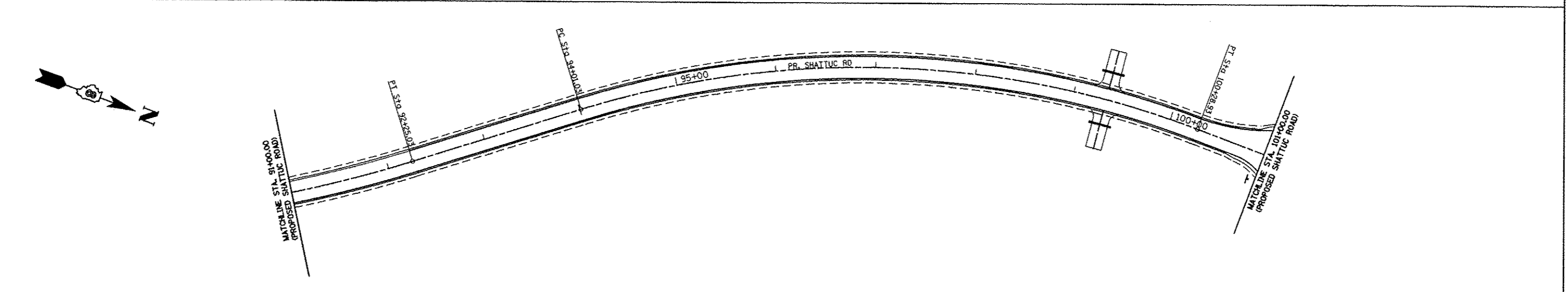
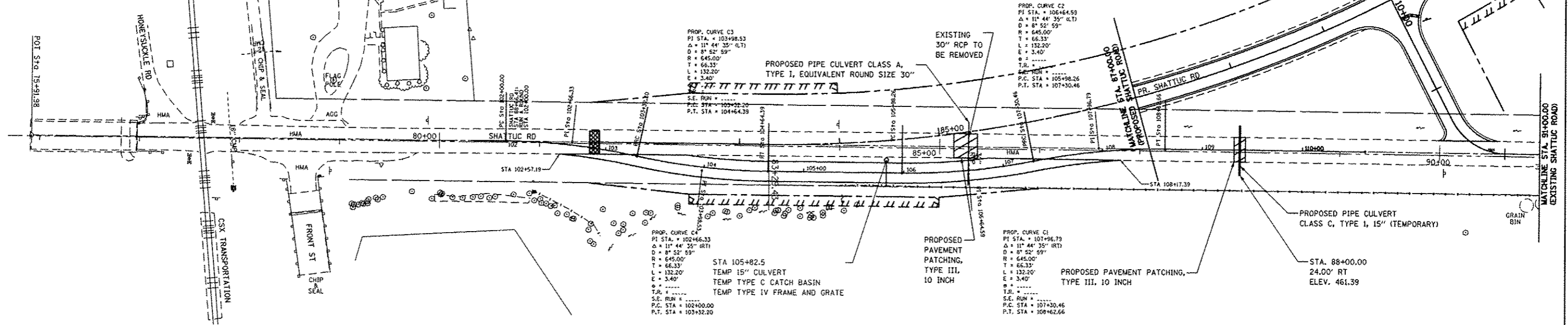

FILE NAME =	USER NAME = bargnd	DESIGNED -	REVISED -	STATE OF ILLINOIS DEPARTMENT OF TRANSPORTATION	SHATTUC ROAD REALIGNMENT STAGE 1 CONSTRUCTION	F.A.P. RTE.	SECTION	COUNTY	TOTAL SHEETS	SHEET NO.	
c:\pwork\p\dot\bargnd\0309075\08750	33-shi-staging1.dgn	DRAWN -	REVISED -			327	21-I-1, 27-1	CLINTON	96	19	
PLOT SCALE = 100.0000 ' / in	CHECKED -	REVISED -	REVISED -			CONTRACT NO. 76D53					
PLOT DATE = 6/15/2012	DATE -	REVISED -	REVISED -			ILLINOIS FED. AID PROJECT					