

F.A.U. RTE.	SECTION	COUNTY	TOTAL SHEETS	SHEET NO.
7622	06-00085-00-BR	COLES	16	6
STA. 14+06		TO STA. 16+75		
FED. ROAD DIST. NO.		ILLINOIS FED. AID PROJECT		

BITUMINOUS MATERIALS, PRIME COAT		GALLONS
14+06.38 TO 15+60.00		38
15+60 RT TO 16+50.00 RT		10
15+60 LT TO 16+50.00 LT		9
<b>TOTAL</b>		<b>57</b>

PORTLAND CEMENT CONCRETE BASE COURSE 8"		SQ. YD.
14+06.38 TO 15+60.00		376.4
15+60 RT TO 16+50.00 RT		93.2
<b>TOTAL</b>		<b>469.6</b>

HOT-MIX ASPHALT SURFACE COURSE MIX "C" N50		TONS
14+06.38 TO 15+60.00		53
15+60 RT TO 16+50.00 RT		13
15+60 LT TO 16+50.00 LT		8
<b>TOTAL</b>		<b>74</b>

STORM SEWERS CLASS A TYPE 1 12"		FEET
STRUCT. #1 TO STRUCT #2		21.8
STRUCT. #2 TO STRUCT #3		8.2
STRUCT. #3 TO STRUCT #4		30.3
<b>TOTAL</b>		<b>60.3</b>

PIPE UNDERDRAINS 4"		FEET
14+66 TO STRUCT #2		65.4
14+85 TO STRUCT #1		55.2
<b>TOTAL</b>		<b>120.6</b>

PRC FLARED END SECTION EACH		STATION, OFFSET, & INVERT AT END OF STORM SEWER
14+98.36, 22.55' LT (*4)	1	INVERT=630.50

MANHOLES, TYPE A, 4'-DIAMETER TYPE 1 FRAME, CLOSED LID EACH		STATION, OFFSET, & RIM AT CENTER OF STRUCTURE
15+30.70, 12.55' LT (*3)	1	RIM=644.55, S. INVERT=641.55, W. INVERT=630.64

INLET TYPE A TYPE 11 FRAME AND GRATE EACH		STATION, OFFSET, & RIM AT EDGE OF PAVEMENT
15+31.50, 10.88' LT (*2)	1	RIM=645.20, S. INVERT=642.20, N. INVERT=641.70
15+39.84, 10.47' RT (*1)	1	RIM=645.36, N. INVERT=642.36
<b>TOTAL</b>	<b>2</b>	

ARTICULATED BLOCK REVETMENT MAT		SQ. YD.
14+40.0 LT TO 14+86.0 LT		48.7
14+60.0 RT TO 14+86.0 RT		74.7
15+04.5 LT TO 15+10.5 LT		74.0
15+04.5 RT TO 15+60.0 RT		79.5
<b>TOTAL</b>		<b>276.9</b>

COMBINATION CONCRETE CURB & GUTTER TYPE B-6.12		FEET
14+06.4 LT TO 14+50.0 LT		43.7
14+06.4 RT TO 14+50.0 RT		43.7
14+50.0 LT TO 15+30.0 LT		80.0
14+50.0 RT TO 15+30.0 RT		80.0
15+30.0 LT TO 15+60.0 LT		30.2
15+30.0 RT TO 15+60.0 RT		30.0
15+60.0 RT TO 15+60.0 RT		90.0
15+60.0 LT TO 16+50.0 LT		90.0
<b>TOTAL</b>		<b>487.6</b>

PORTLAND CEMENT CONCRETE SIDEWALK 5"		SQ. FT.
14+06.4 RT TO 14+26.3 RT		98.6
14+06.4 LT TO 14+18.4 LT		58.5
14+18.4 LT TO 14+50.0 LT		168.5
14+26.3 RT TO 14+50.0 RT		129.8
14+50.0 LT TO 15+10.0 LT		302.1
14+50.0 RT TO 15+50.0 RT		529.1
15+50.0 RT TO 16+75.0 RT		541.2
<b>TOTAL</b>		<b>1827.8</b>

STEEL RAILING		FEET
14+41.0 LT TO 14+65.0 LT		24.0
14+61.4 RT TO 14+85.4 RT		24.0
15+05.0 LT TO 15+17.0 LT		12.0
15+25.6 RT TO 16+63.6 RT		138.0
<b>TOTAL</b>		<b>198.0</b>

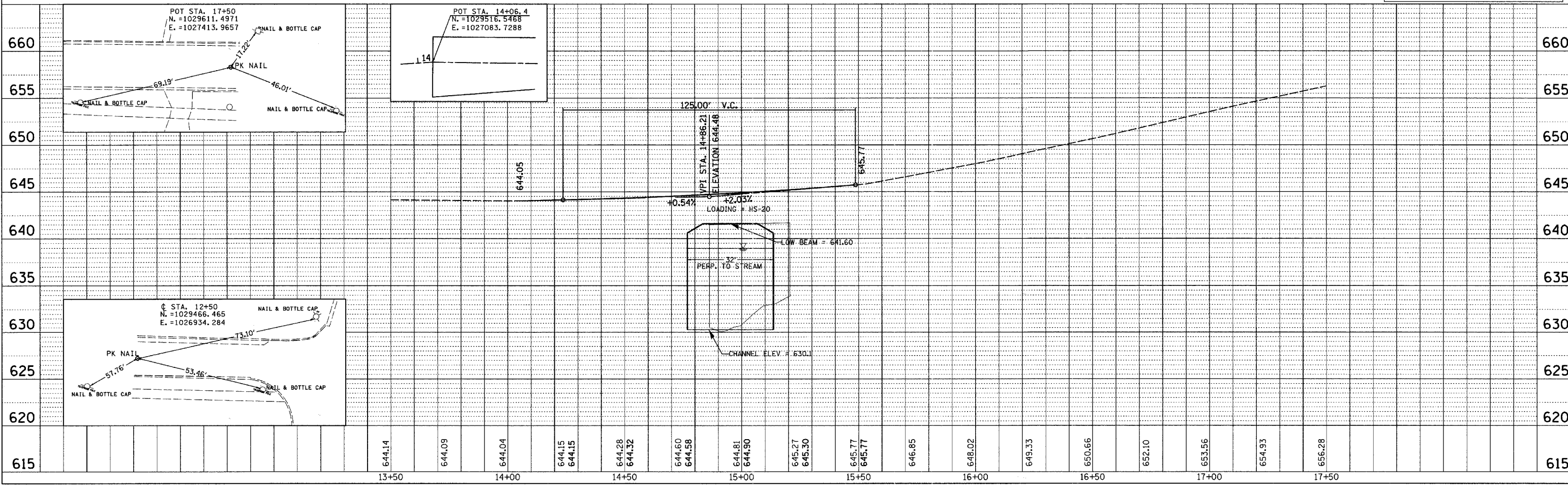
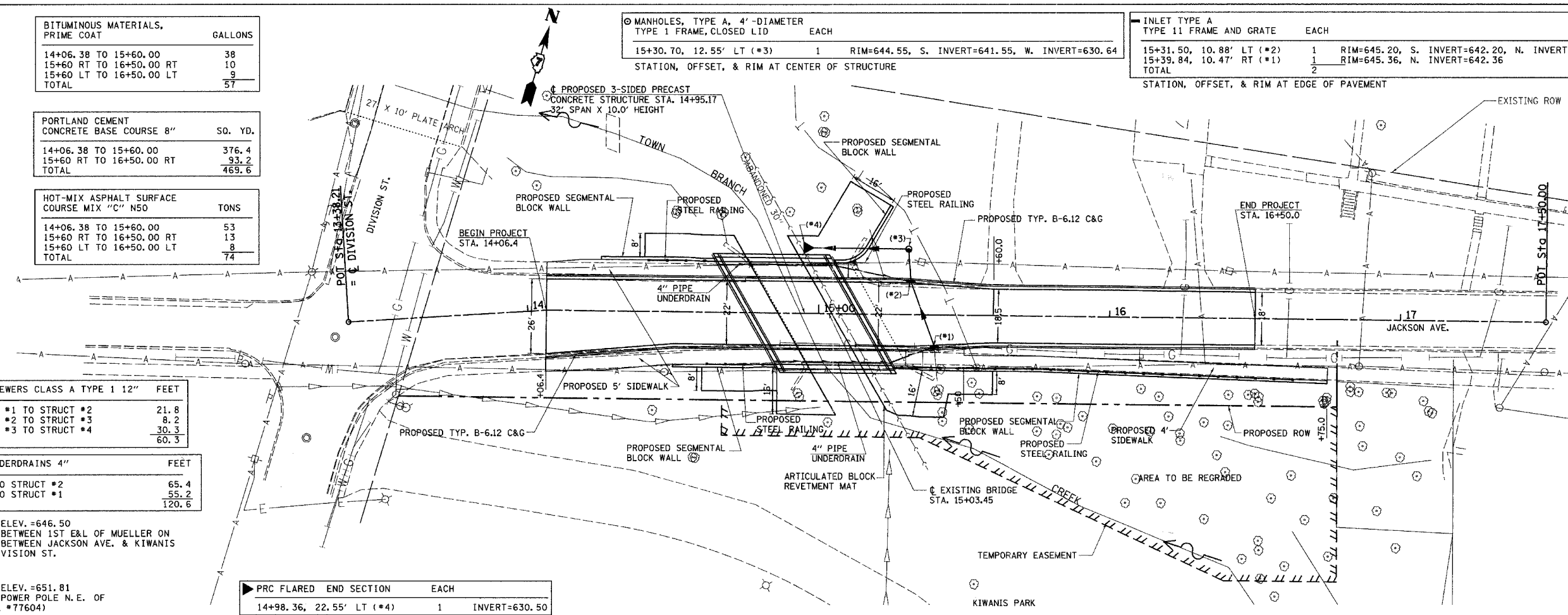

DATE: \_\_\_\_\_ BY: \_\_\_\_\_  
 CHECKED: \_\_\_\_\_  
 DATE: \_\_\_\_\_ BY: \_\_\_\_\_  
 CHECKED: \_\_\_\_\_

DATE: \_\_\_\_\_ BY: \_\_\_\_\_  
 CHECKED: \_\_\_\_\_  
 DATE: \_\_\_\_\_ BY: \_\_\_\_\_  
 CHECKED: \_\_\_\_\_

PLOT DATE = 6/28/2007  
 FILE NAME = P:\Civil\Charleston\Jackson Ave Bridge\Drawings\Plan\_Prof\p06.dwg  
 PLOT SCALE = 20.0000' / 1" = 100.0000'  
 USER NAME = jusepl