

MUNICIPALITY	SECTION	COUNTY	TOTAL SHEETS	SHEET NO.
QUINCY	06-00300-00-LS	ADAMS	69	56

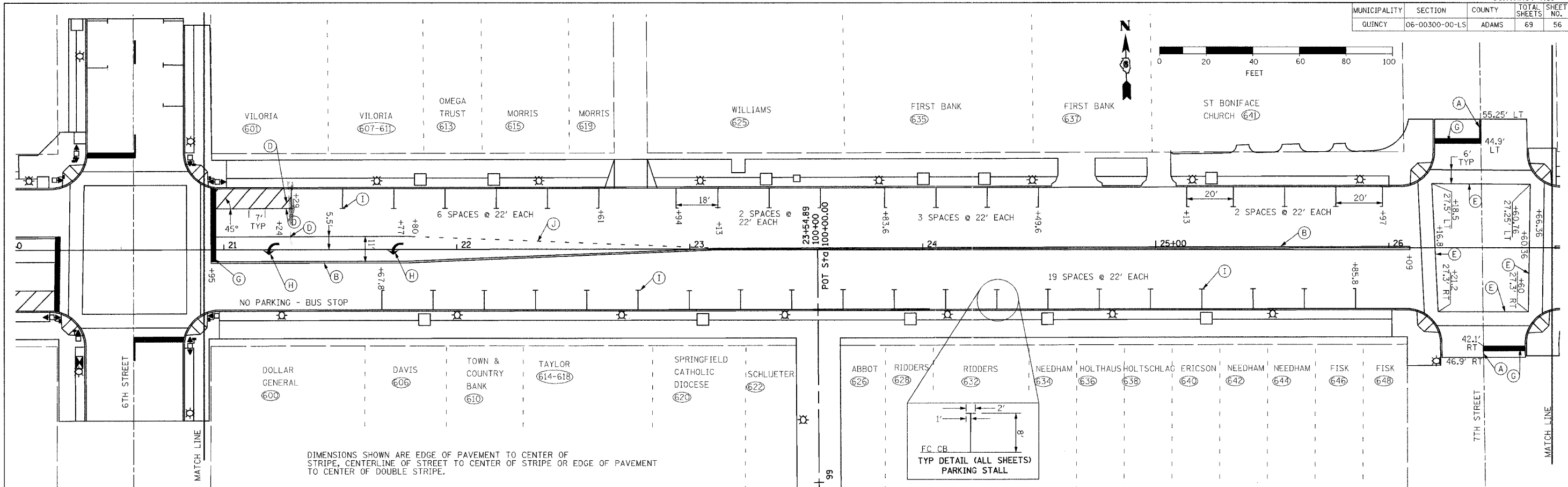

DIMENSIONS SHOWN ARE EDGE OF PAVEMENT TO CENTER OF STRIPE, CENTERLINE OF STREET TO CENTER OF STRIPE OR EDGE OF PAVEMENT TO CENTER OF DOUBLE STRIPE.

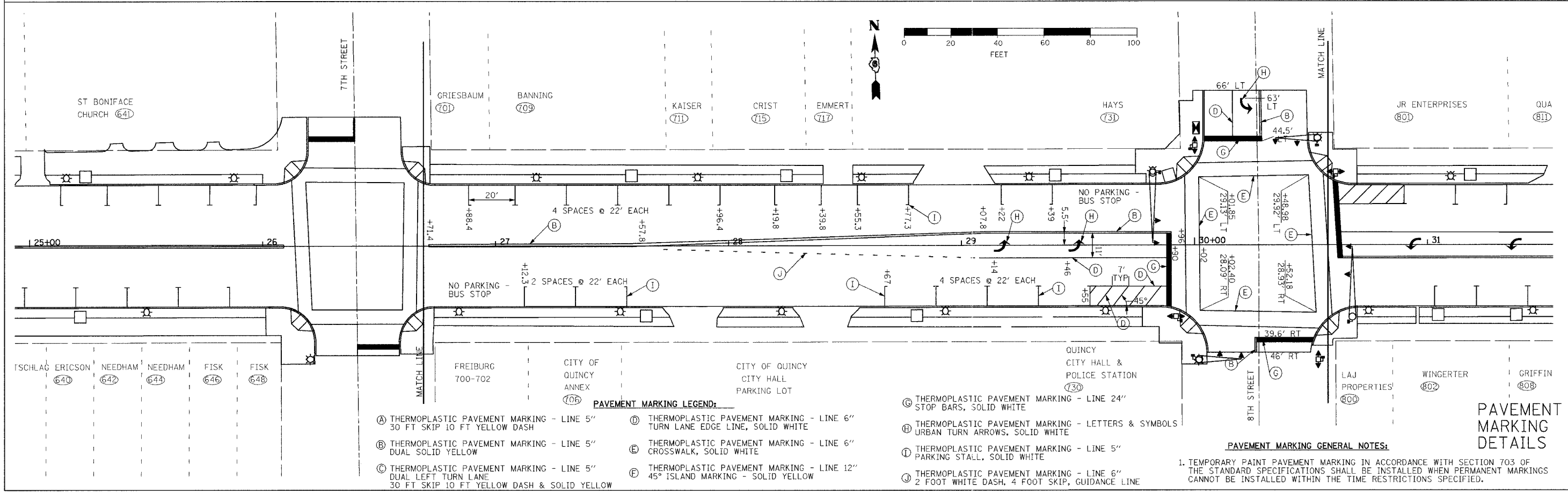

- PAVEMENT MARKING LEGEND:**
- (A) THERMOPLASTIC PAVEMENT MARKING - LINE 5" 30 FT SKIP 10 FT YELLOW DASH
 - (B) THERMOPLASTIC PAVEMENT MARKING - LINE 5" DUAL SOLID YELLOW
 - (C) THERMOPLASTIC PAVEMENT MARKING - LINE 5" DUAL LEFT TURN LANE 30 FT SKIP 10 FT YELLOW DASH & SOLID YELLOW
 - (D) THERMOPLASTIC PAVEMENT MARKING - LINE 6" TURN LANE EDGE LINE, SOLID WHITE
 - (E) THERMOPLASTIC PAVEMENT MARKING - LINE 6" CROSSWALK, SOLID WHITE
 - (F) THERMOPLASTIC PAVEMENT MARKING - LINE 12" 45° ISLAND MARKING - SOLID YELLOW
 - (G) THERMOPLASTIC PAVEMENT MARKING - LINE 24" STOP BARS, SOLID WHITE
 - (H) THERMOPLASTIC PAVEMENT MARKING - LETTERS & SYMBOLS
 - (I) THERMOPLASTIC PAVEMENT MARKING - LINE 5" PARKING STALL, SOLID WHITE
 - (J) THERMOPLASTIC PAVEMENT MARKING - LINE 6" 2 FOOT WHITE DASH, 4 FOOT SKIP, GUIDANCE LINE

PAVEMENT MARKING GENERAL NOTES:
 1. TEMPORARY PAINT PAVEMENT MARKING IN ACCORDANCE WITH SECTION 703 OF THE STANDARD SPECIFICATIONS SHALL BE INSTALLED WHEN PERMANENT MARKINGS CANNOT BE INSTALLED WITHIN THE TIME RESTRICTIONS SPECIFIED.

PAVEMENT MARKING DETAILS

NOTE BOOK NO. _____
 DATE CHECKED _____
 FILE NAME _____
 PLOT SCALE = 1/8" = 10'

NOTE BOOK NO. _____
 DATE CHECKED _____
 FILE NAME _____
 PLOT SCALE = 1/8" = 10'

PLOT DATE = 8/7/2007
 FILE NAME = PavementMarking.dgn
 PLOT SCALE = 1/8" = 10'
 USER NAME = default