

MUNICIPALITY	SECTION	COUNTY	TOTAL SHEETS	SHEET NO.
QUINCY	06-00300-00-LS	ADAMS	69	45

TRAFFIC SIGNALS AT 7TH AND MAINE ARE TO BE PERMANENTLY REMOVED.

- 7TH & MAINE
REMOVE SIGNAL EQUIPMENT
- NW CORNER
ALL SIGNAL HEADS AND PED HEADS
ALL TYPE A CONC FOUNDATIONS
- SW CORNER
ALL SIGNAL HEADS AND PED HEADS
ALL TYPE A CONC FOUNDATIONS
REMOVE CONTROLLER
CABINET AND FOUNDATION TO REMAIN
- SE CORNER
ALL SIGNAL HEADS AND PED HEADS
ALL TYPE A CONC FOUNDATIONS
- NE CORNER
ALL SIGNAL HEADS AND PED HEADS
ALL TYPE A CONC FOUNDATIONS

PLAN	DATE
DESIGNED	
PLOTTED	
CHECKED	
BY	
NO. _____	
DATE _____	

PROFILE	DATE
DESIGNED	
PLOTTED	
CHECKED	
BY	
NO. _____	
DATE _____	

PLOT DATE = 8/7/2007
 FILE NAME = S:\2006\12\7th.dwg
 PLOT SCALE = 1/8"=1'-0"
 USER NAME = default

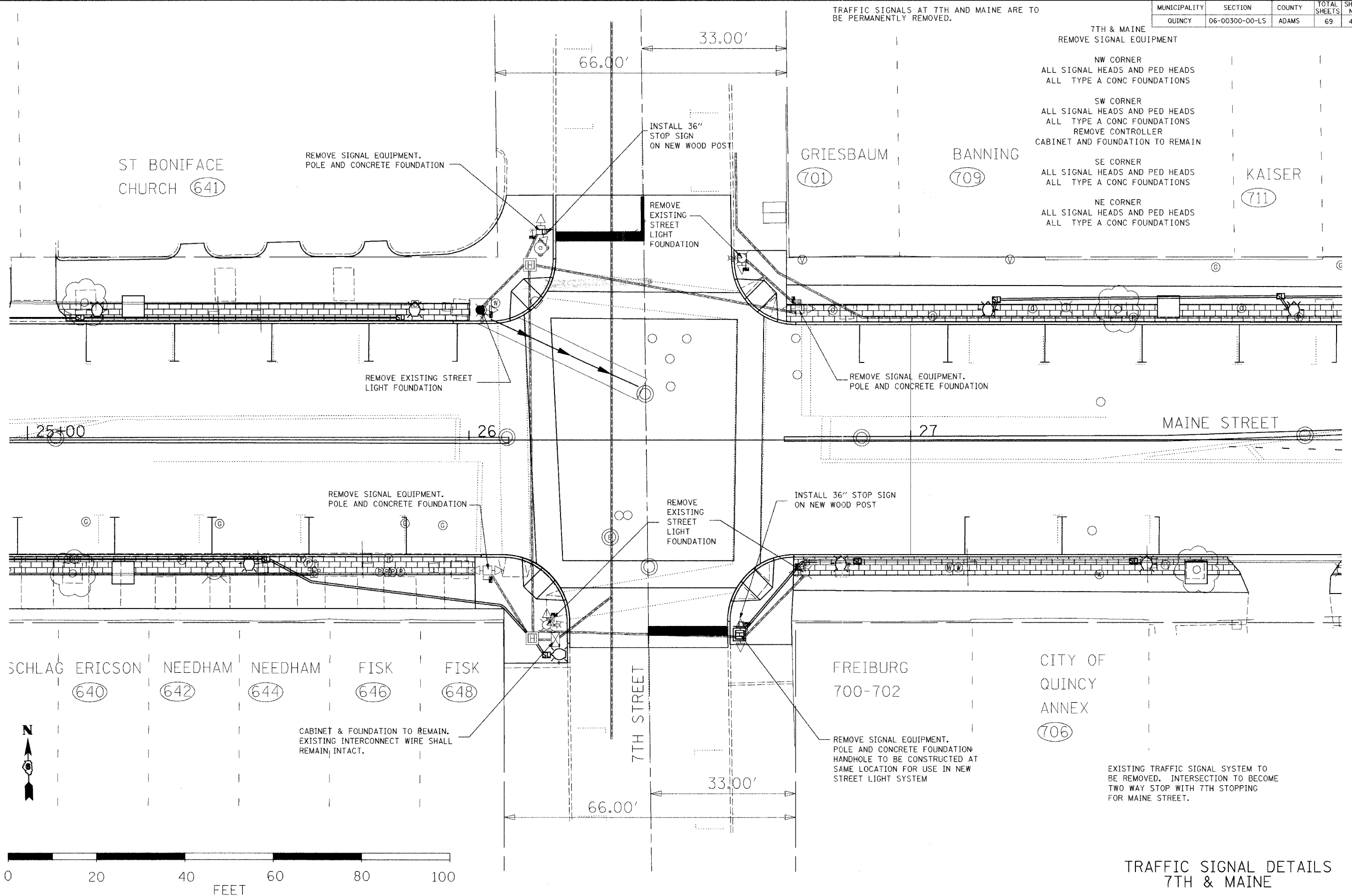

TRAFFIC SIGNAL DETAILS
7TH & MAINE

EXISTING TRAFFIC SIGNAL SYSTEM TO BE REMOVED. INTERSECTION TO BECOME TWO WAY STOP WITH 7TH STOPPING FOR MAINE STREET.

CABINET & FOUNDATION TO REMAIN. EXISTING INTERCONNECT WIRE SHALL REMAIN INTACT.

REMOVE SIGNAL EQUIPMENT. POLE AND CONCRETE FOUNDATION. HANDHOLE TO BE CONSTRUCTED AT SAME LOCATION FOR USE IN NEW STREET LIGHT SYSTEM

REMOVE EXISTING STREET LIGHT FOUNDATION

REMOVE SIGNAL EQUIPMENT. POLE AND CONCRETE FOUNDATION

REMOVE EXISTING STREET LIGHT FOUNDATION

REMOVE EXISTING STREET LIGHT FOUNDATION

REMOVE SIGNAL EQUIPMENT. POLE AND CONCRETE FOUNDATION

ST BONIFACE CHURCH (641)

GRIESBAUM (701)

BANNING (709)

KAISER (711)

SCHLAG ERICSON (640)

NEEDHAM (642)

NEEDHAM (644)

FISK (646)

FISK (648)

FREIBURG 700-702

CITY OF QUINCY ANNEX (706)

7TH STREET

MAINE STREET