

SECTION	COUNTY	TOTAL SHEETS	SHEET NO.
00-00048-00-BT	COOK	39	19
STA. 9+95 TO STA. 31+58		ILLINOIS FED. AID PROJECT	
FED. ROAD DIST. NO. 1		CONTRACT NO. 83864	

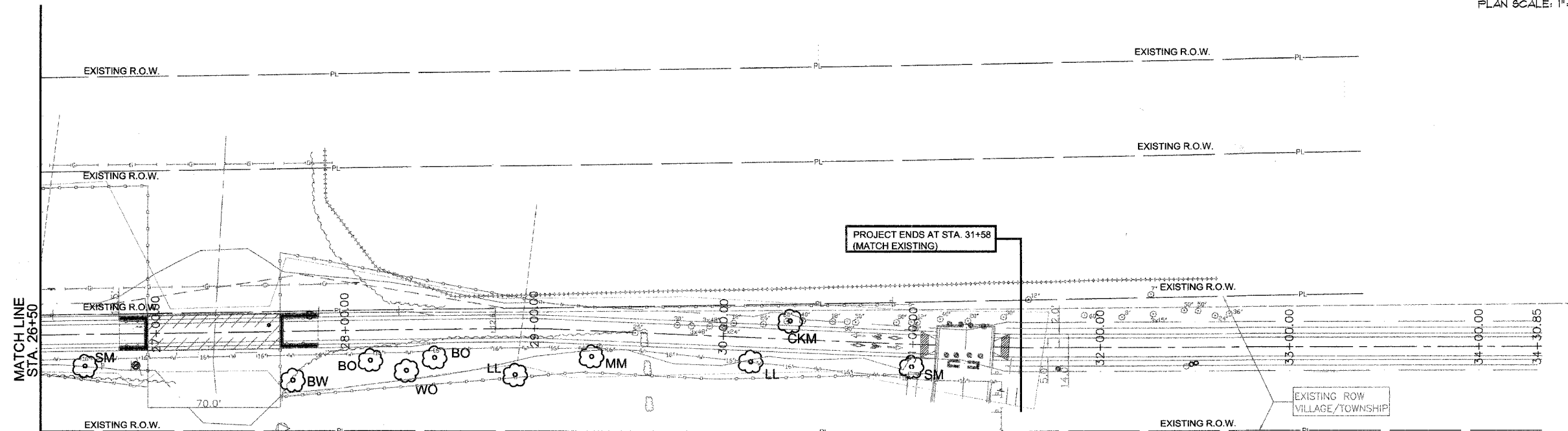
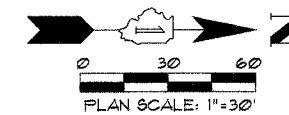

THORNWOOD AVE.
THORNWOOD AVE.

NOTES:

1. EXCAVATION FOR TREE PITS SHALL BE PER DETAILS, SET ON UNDISTURBED SUB-BASE.
2. REMOVE ALL PLASTIC TWINE, ROPE, BURLAP, AND/OR WIRE BASKET FROM TOP 1/3 OF TREE BALL.
3. REMOVE ALL RIBBONS OR TREE TAGS AFTER APPROVAL BY THE ARCHITECT.
4. TREE TO BE ALIGNED AND PLUMB AFTER WATERING AND SETTLING.
5. PRUNE TREE AS DIRECTED BY ARCHITECT. (SEE SPECIFICATIONS)
6. T-POSTS SHALL BE USED AS APPROVED BY THE COMMISSIONER & INSTALLATION SHALL BE DETERMINED BY THE COMMISSIONER.

PROVIDE T-POST AS APPROVED BY THE COMMISSIONER

DOUBLE STRAND #10 WIRE GALVANIZED W/6" TURNBUCKLE

REINFORCED RUBBER HOSE FRICTION GUARD AT FIRST BRANCHING

TREE WRAP SHALL BE OF A CRAY PAPER TYPE AND ONLY INSTALLED IN THE FALL ON SMOOTH BARKED TREES

12"x6" DIA. CORRUGATED PLASTIC PIPE FOR TREE PROTECTION OF 4" CALIBER TREE OR LESS IN LAWN AREA ONLY.

ROOT FLARE (SET 3" ABOVE FINISH GRADE AFTER SETTLING)

FINISH GRADE

SPADED EDGE OF SOD

4'-0"x3" CIRCLE MULCH (DO NOT PLACE AT BASE OF TRUNK)

CREATE SAUCER WITH MULCH 6" AT PERIMETER

PLANTING SOIL MIX AS SPECIFIED

REMOVE ROPES AND BURLAP FROM TOP 1/3 OF ROOT BALL

UNDISTURBED SOIL

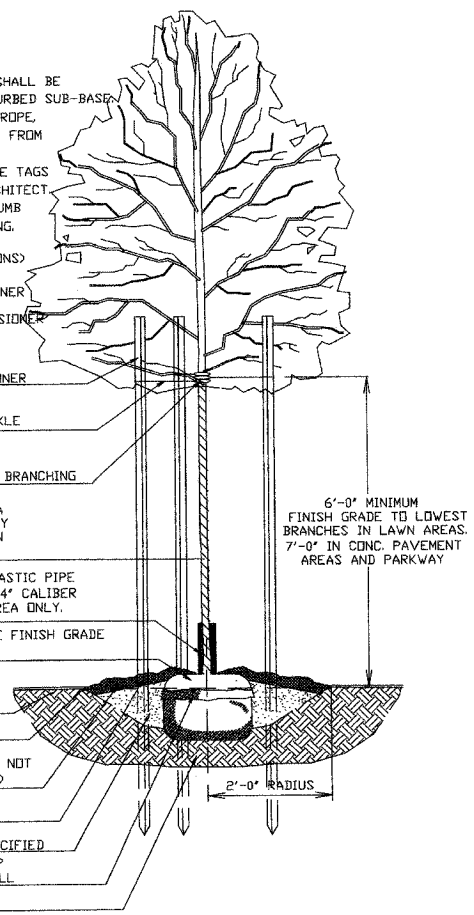

TREE PLANTING DETAIL
SCALE: N.T.S.

EXISTING LEGEND

- ⊙ TREES
- WATER
- BEAN FIELD LINE
- GAS
- CORN FIELD LINE
- FIRE HYDRANT
- EXISTING R.O.W.

PROPOSED LEGEND

- ⊙ LL LITTLE LEAF LINDEN
- ⊙ BO BUR OAK
- ⊙ WO WHITE OAK
- ⊙ BW BLACK WALNUT
- ⊙ SM SUGAR MAPLE
- ⊙ CKM CRIMSON KING NORWAY MAPLE
- ⊙ MM MARMO FREEMAN MAPLE
- ⊙ G GLEDITSIA CENTER LINE

REVISIONS	
NAME	DATE

ILLINOIS DEPARTMENT OF TRANSPORTATION

PRESERVATION BIKE PATH
LANDSCAPE 26+50.00 - 31+58.00

SCALE: 1"=30'
DATE: MAY 04, 2007

DRAWN BY: CC
CHECKED BY: SC

505 N. LASALLE SUITE 250
CHICAGO, IL 60610
(312)467-0123

