

FOR INDEX OF SHEETS, SEE SHEET NO. 2

STATE OF ILLINOIS
DEPARTMENT OF TRANSPORTATION

F.A.P. FILE	SECTION	COUNTY	TOTAL SHEETS	SHEET NO.
586/592	(51, 117)TR	MADISON	4	1
		ILLINOIS	CONTRACT NO. 76T73	

TRAFFIC DATA

FAP 586 (IL 162) – WEST LEG

2021 ADT = 5,650 (ACTUAL)
2024 ADT = 5,900 (ESTIMATED)
2044 ADT = 7,400 (ESTIMATED)
SU = 4.0% MU = 1.6%

FAP 586 (IL 162) – EAST LEG

2021 ADT = 6,800 (ACTUAL)
2024 ADT = 7,000 (ESTIMATED)
2044 ADT = 8,900 (ESTIMATED)
SU = 3.3% MU = 1.0%

FAP 592 (IL 157) – NORTH LEG

2021 ADT = 11,100 (ACTUAL)
2024 ADT = 11,500 (ESTIMATED)
2044 ADT = 14,600 (ESTIMATED)
SU = 4.5% MU = 2.5%

FAP 592 (IL 157) – SOUTH LEG

2021 ADT = 5,750 (ACTUAL)
2024 ADT = 6,000 (ESTIMATED)
2044 ADT = 7,600 (ESTIMATED)
SU = 3.9% MU = 3.3%

FAP 586/592 (IL 162/157) – BETWEEN STRUCTURES

2021 ADT = 10,100 (ACTUAL)
2024 ADT = 10,500 (ESTIMATED)
2044 ADT = 13,300 (ESTIMATED)
SU = 3.7% MU = 2.6%

PROPOSED
HIGHWAY PLANS

FAP ROUTE 586/592 (IL 162 / IL 157)
SECTION (51, 117)TR
PROJECT STP-2NU5(824)
TREE REMOVAL
MADISON COUNTY

C-98-177-24

R 8 W

PROJECT LOCATION
LAT: 38.740813
LONG: -90.002681

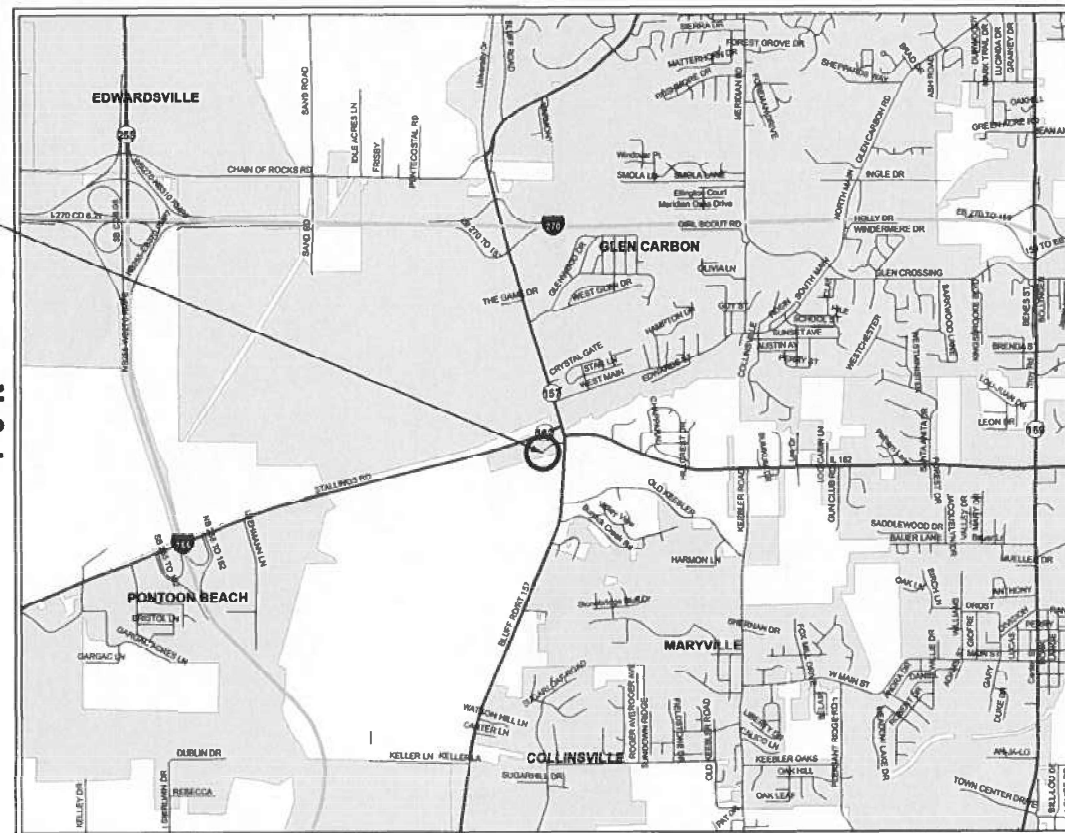

FUNCTIONAL CLASSIFICATION
MINOR ARTERIAL /OTHER PRINCIPAL ARTERIAL

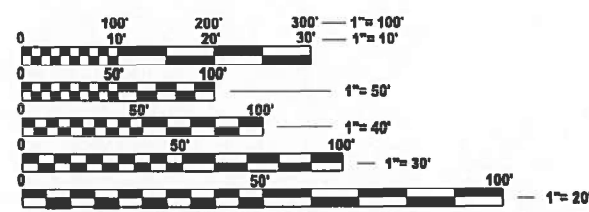

FULL SIZE PLANS HAVE BEEN PREPARED USING STANDARD ENGINEERING SCALES. REDUCED SIZED PLANS WILL NOT CONFORM TO STANDARD SCALES. IN MAKING MEASUREMENTS ON REDUCED PLANS, THE ABOVE SCALES MAY BE USED.

J.U.L.I.E.
JOINT UTILITY LOCATION INFORMATION FOR EXCAVATION
1-800-892-0123
OR 811

PROJECT ENGINEER: CHERYL KEPLAR
PROJECT MANAGER: EDISON ZOHFONYI

GROSS LENGTH = 3168 FT. = 0.60 MILE
NET LENGTH = 3168 FT. = 0.60 MILE

CONTRACT NO. 76T73

STATE OF ILLINOIS
DEPARTMENT OF TRANSPORTATION

SUBMITTED *June 20, 2024*
Kil H Pa
REGIONAL ENGINEER

August 16, 2024
Scott A. Etk
ENGINEER OF DESIGN AND ENVIRONMENT

August 16, 2024
James J. An
DIRECTOR OF HIGHWAYS PROJECT IMPLEMENTATION

PRINTED BY THE AUTHORITY
OF THE STATE OF ILLINOIS

INDEX OF SHEETS

- 1 COVER SHEET
- 2 INDEX OF SHEETS, HIGHWAY STANDARDS, GENERAL NOTES AND COMMITMENTS
- 3 SUMMARY OF QUANTITIES
- 4 PLAN SHEET

HIGHWAY STANDARDS

000001-08
 001006
 701001-02
 701006-05
 701011-04
 701201-05
 701301-04
 701901-09

GENERAL NOTES

- UTILITIES KNOWN TO HAVE FACILITIES WITHIN THE PROJECT AREA:

AMEREN ILLINOIS
 AT&T
 CHARTER COMMUNICATIONS
 CONSOLIDATED COMMUNICATION
 EVERSTREAM GLC
 VILLAGE OF GLEN CARBON
 ILLINOIS AMERICAN WATER
 VILLAGE OF MARYVILLE
 SOUTHWESTERN ELECTRIC COOP
 WINDSTREAM KDL
 ZAYO GROUP LLC

- ALL STATION/OFFSET REFER TO EXISTING IL 162 AND IL 157 CENTERLINE.
- IF THE CONTRACTOR, FOR HIS CONSTRUCTION ACTIVITY, REMOVES TREES WITHIN THE RIGHT-OF-WAY LIMITS WHICH ARE NOT DESIGNATED ON THE PLANS FOR REMOVAL, I.E. IN ORDER TO GAIN ACCESS TO THE PROJECT SITE; IT WILL BE HIS RESPONSIBILITY TO REPLACE THE TREES AT A 1:1 RATIO. THE TREES WILL BE REPLACED WITH A 1 GALLON NATIVE ILLINOIS TREE SPECIES AND SHALL BE APPROVED BY THE ENGINEER. THE TREE REMOVAL AND TREE REPLACEMENT WILL BE AT THE CONTRACTOR'S EXPENSE, AND NO ADDITIONAL COMPENSATION WILL BE ALLOWED.
- THE DEPARTMENT STRONGLY ENCOURAGES THE PRIME CONTRACTOR AND THEIR APPROVED SUB-CONTRACTORS TO HIRE MINORITY, WOMEN AND DISADVANTAGED INDIVIDUALS FROM ITS FEDERALLY FUNDED HIGHWAY CONSTRUCTION CAREERS TRAINING PROGRAM (HCCTP) TO HELP MEET WORKFORCE AND TRAINEE GOALS. THIS PROGRAM IS TRAINING MINORITIES, WOMEN AND DISADVANTAGED INDIVIDUALS IN HIGHWAY CONSTRUCTION-RELATED SKILLS, E.G., MATH FOR THE TRADES, JOB READINESS, TECHNICAL SKILLS COURSEWORK (CARPENTRY, CONCRETE FLATWORK, BLUEPRINT READING, SITE PLANS, SITE WORK, TOOLS USE, ETC.) AND OSHA 10 HOUR CERTIFICATION, TO PREPARE THEM FOR A CAREER IN THE HIGHWAY CONSTRUCTION TRADES. GRADUATES ARE WELL-TRAINED AND READY TO BECOME PRODUCTIVE ENTRY-LEVEL CONSTRUCTION WORKERS. CONTACT THE DISTRICT 8 EEO OFFICE AT 618-346-3360 AND/OR THE HCCTP COORDINATOR AT 618-874-6528 TO LEARN MORE ABOUT THE PROGRAM AND FOR ASSISTANCE IN MEETING WORKFORCE AND TRAINEE GOALS.
- THE PAY ITEMS, TEMPORARY EROSION CONTROL SEEDING AND MULCH HAS BEEN INCLUDED IN THE PLAN FOR THE DISTURBED BY THE TREE REMOVAL OPERATION. THE LIMITS WILL BE THE SAME AS THAT OF THE TREE REMOVAL SHOWN IN THE PLAN, IN ARCRES, THE QUANTITIES FOR TEMPORARY EROSION CONTROL SEEDING WAS CALCULATED USING THREE APPLICATIONS.
- PERIMETER EROSION BARRIER SHALL BE PLACED ALONG THE PERIMETER OF THE TREE REMOVAL(ACRE) LIMITS.

COMMITMENTS

TREES THREE (3) INCHES IN DIAMETER AT BREAST HEIGHT SHALL NOT BE CLEARED FROM APRIL 1ST THROUGH SEPTEMBER 30TH OF ANY GIVEN YEAR.

MODEL: Gen Notes (Sheet)
 FILE NAME: c:\p\work\evr\illinois.gov\1007327\ID87673-shr-gennote.dgn

USER NAME = edison.zohfonyi	DESIGNED -	REVISED -	STATE OF ILLINOIS DEPARTMENT OF TRANSPORTATION	GENERAL NOTES, HIGHWAY STANDARDS INDEX OF SHEETS AND COMMITMENT	F.A.P RTE.	SECTION	COUNTY	TOTAL SHEETS	SHEET NO.	
	DRAWN -	REVISED -			586/592	(51, 117)TR	MADISON	4	2	
	CHECKED -	REVISED -			CONTRACT NO. 76T73					
PLOT DATE = 6/20/2024	DATE -	REVISED -			SCALE: NONE	SHEET 1	OF 1	SHEETS	STA.	TO STA.

MODEL: SOQ (Sheet)
 FILE NAME: c:\p\work\wiscon\illinois.gov\edison.zohfanyi@illinois.gov\107327\087673-shh-SOQ.dgn

CODE NO.	ITEM	UNIT	TOTAL QUANTITY	CONSTR. CODE	
				80% FED 20% STATE	
				NONE	
				0031	
				URBAN	
20100110	TREE REMOVAL (6 TO 15 UNITS DIAMETER)	UNIT	30	30	
20100210	TREE REMOVAL (OVER 15 UNITS DIAMETER)	UNIT	128	128	
20100500	TREE REMOVAL, ACRES	ACRE	2.25	2.25	
25100105	MULCH, METHOD 1	ACRE	2.25	2.25	
28000250	TEMPORARY EROSION CONTROL SEEDING	POUND	625	625	
28000400	PERIMETER EROSION BARRIER	FOOT	1908	1908	
67100100	MOBILIZATION	L SUM	1	1	
70100450	TRAFFIC CONTROL AND PROTECTION, STANDARD 701201	L SUM	1	1	

USER NAME = edison.zohfanyi	DESIGNED -	REVISED -
	DRAWN -	REVISED -
	CHECKED -	REVISED -
PLOT DATE = 6/20/2024	DATE -	REVISED -

**STATE OF ILLINOIS
 DEPARTMENT OF TRANSPORTATION**

SUMMARY OF QUANTITIES		
SCALE: NONE	SHEET 1	OF 1 SHEETS
STA.		TO STA.

F.A.P. RTE. 586/592	SECTION (51.117)TR	COUNTY MADISON	TOTAL SHEETS 4	SHEET NO. 3
CONTRACT NO. 76T73				
ILLINOIS FED. AID PROJECT				

TREE REMOVAL			TREE REMOVAL		
LOCATION			ACRES	(6 TO 15 UNITS DIAMETER)	(OVER 15 UNITS DIAMETER)
STATION (TO STATION)	SIDE	ROADWAY	(ACRE)	(UNIT)	(UNIT)
9+75 TO 18+47	RT/LT	IL 162	2.07		
582+08.88	LT	IL 157			30
582+26.38	LT	IL 157		10	26
582+54.45	LT	IL 157			20
582+81.46	LT	IL 157			22
582+81.01	LT	IL 157		8	
582+86.01	LT	IL 157		6	
582+90.06	LT	IL 157			30
582+91.93	LT	IL 157		6	
502+94.25	LT	IL 157			128
SUBTOTAL			2.07	30	128
PAY TOTAL			2.25	30	128

THE PURPOSE OF THIS PLAN SHEET IS TO SHOW THE LIMITS OF TREE REMOVAL INDICATED FOR CONTRACT 76T73. ALL OTHER DESIGN LINE WORK SHOWN SHALL BE USED FOR REFERENCE PURPOSES ONLY AND IS INCLUDED IN CONTRACT 76A46.

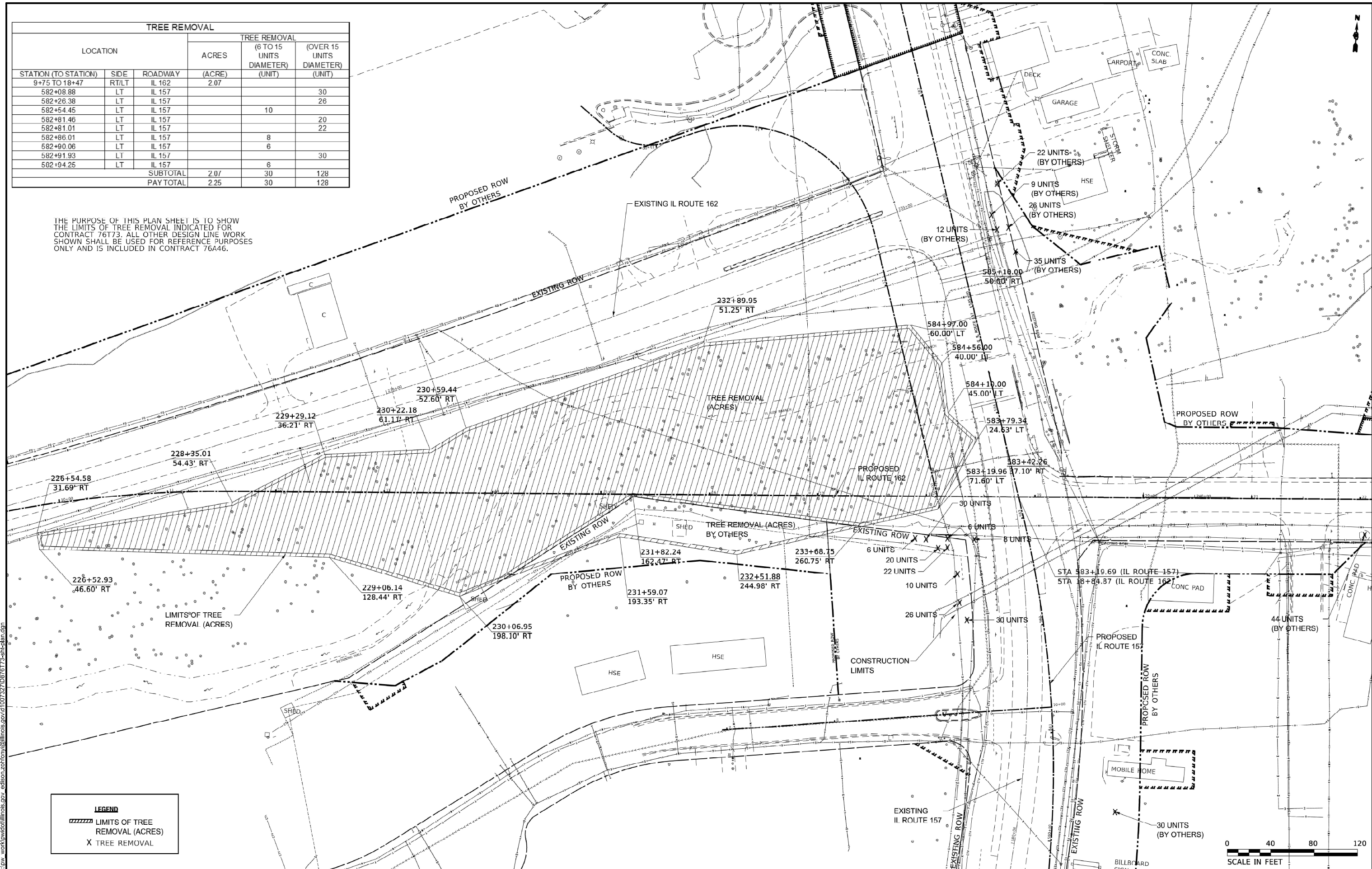

LEGEND	
	LIMITS OF TREE REMOVAL (ACRES)
	TREE REMOVAL



MODEL: Unfiled (Sheet)
FILE NAME: c:\p\work\wisconsin\illinois.gov\1007327\0876173-shb\plan.dgn

USER NAME = edison.zohfonyi	DESIGNED -	REVISED -
	DRAWN -	REVISED -
	CHECKED -	REVISED -
PLOT DATE = 6/25/2024	DATE -	REVISED -

**STATE OF ILLINOIS
DEPARTMENT OF TRANSPORTATION**

**TREE REMOVAL PLAN
IL ROUTE 162**

SCALE: SHEET 1 OF 1 SHEETS STA. TO STA.

F.A.P. RTE.	SECTION	COUNTY	TOTAL SHEETS	SHEET NO.
586/592	(51, 117)TR	MADISON	4	4

CONTRACT NO. 76T73
ILLINOIS FED. AID PROJECT