

STATE OF ILLINOIS  
DEPARTMENT OF TRANSPORTATION

F.A. RTE.	SECTION	COUNTY	TOTAL SHEETS	SHEET NO.
327	D7 BRIDGE REPAIRS 2025-10	CLAY	24	1
		ILLINOIS	CONTRACT NO. 74C59	

D-97-105-23



# PROPOSED HIGHWAY PLANS

FAP ROUTE 327 (US 50)  
SECTION D7 BRIDGE REPAIRS 2025-10  
PROJECT NHPP-F7HI(645)  
BRIDGE DECK OVERLAY, SLOPEWALL REPAIR  
CLAY COUNTY

C-97-136-23

FOR INDEX OF SHEETS, SEE SHEET NO. 2  
ADT = (3900) (2021)

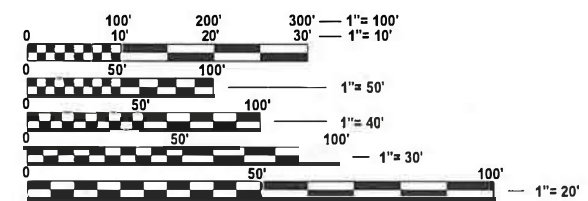

FULL SIZE PLANS HAVE BEEN PREPARED USING STANDARD ENGINEERING SCALES. REDUCED SIZED PLANS WILL NOT CONFORM TO STANDARD SCALES. IN MAKING MEASUREMENTS ON REDUCED PLANS, THE ABOVE SCALES MAY BE USED.

J.U.L.I.E.  
JOINT UTILITY LOCATION INFORMATION FOR EXCAVATION  
1-800-892-0123  
OR 811

SN 013-0036  
STA 573 + 44.50

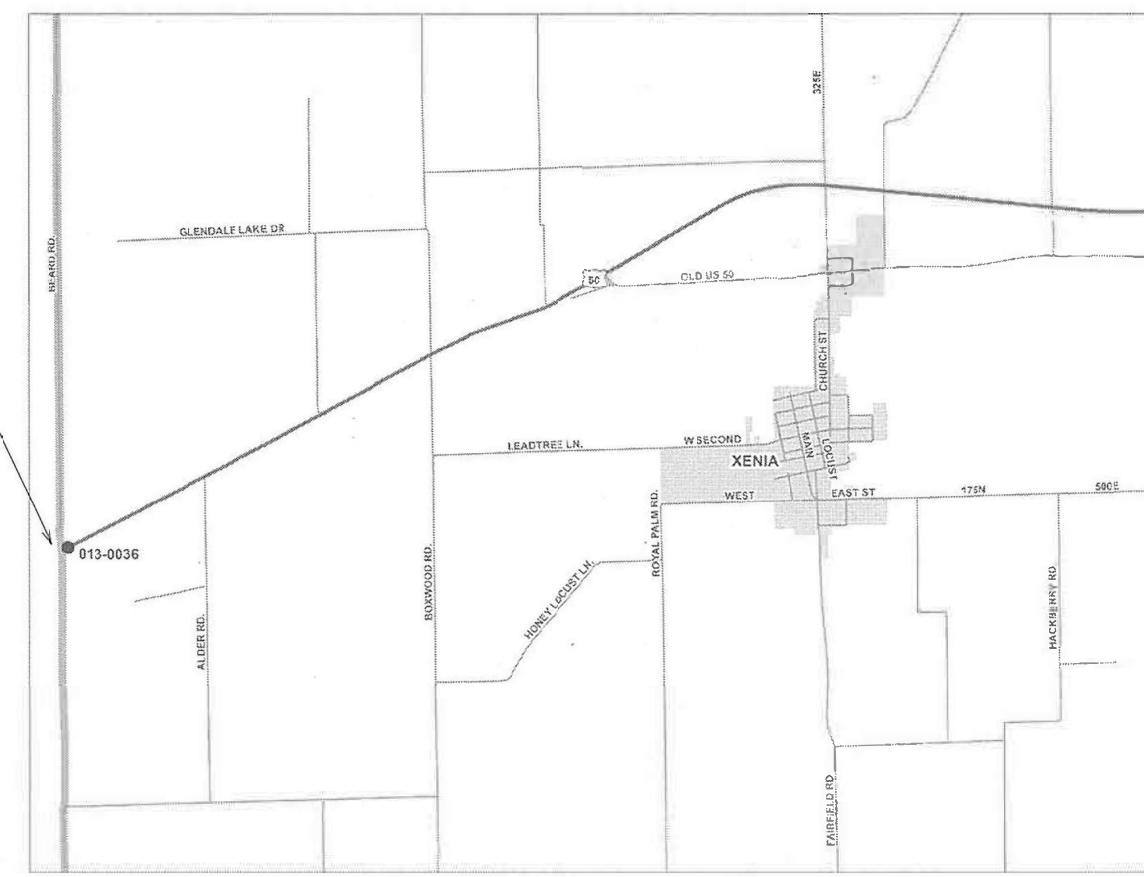

GROSS LENGTH = 176.50 FT. = 0.0334 MILE  
NET LENGTH = 176.50 FT. = 0.0334 MILE

PROJECT ENGINEER: MATT BOWER  
PROJECT MANAGER: STACY ANDERSON

CONTRACT NO. 74C59

STATE OF ILLINOIS  
DEPARTMENT OF TRANSPORTATION

SUBMITTED July 03 2024  
Jeffrey P. Meyer  
REGIONAL ENGINEER

August 16, 2024  
Scott A. Elk  
ENGINEER OF DESIGN AND ENVIRONMENT

August 16, 2024  
James J. Quinn  
DIRECTOR OF HIGHWAYS PROJECT IMPLEMENTATION 13

PRINTED BY THE AUTHORITY  
OF THE STATE OF ILLINOIS

## INDEX OF SHEETS

1	TITLE SHEET
2	INDEX OF SHEETS, GENERAL NOTES, LOCATION DESCRIPTION
3-4	SUMMARY OF QUANTITIES
5	TYPICAL SECTIONS
6-7	SCHEDULE OF QUANTITIES
8-11	STAGING PLAN SHEETS
12-19	BRIDGE REPAIR PLANS
20	MISC DETAILS
21-24	D7 DETAIL PAVEMENT MARKING AND RAISED REFLECTIVE PAVEMENT MARKERS

000001-08	STANDARD SYMBOLS, ABBREVIATIONS, AND PATTERNS
001001-02	AREA OF REINFORCEMENT BARS
001006	DECIMAL OF AN INCH AND OF A FOOT
420001-10	PAVEMENT JOINTS
420401-13	PAVEMENT CONNECTOR (PCC) FOR BRIDGE APPROACH SLAB
420701-03	PAVEMENT WELDED WIRE REINFORCEMENT
701001-02	OFF-ROAD OPERATIONS, 2L,2W, MORE THAN 15' AWAY
701006-05	OFF-ROAD OPERATIONS, 2L,2W, 15' TO 24' FROM PAVEMENT EDGE
701011-04	OFF-ROAD OPERATIONS, 2L,2W, 15' DAY ONLY
701201-05	LANE CLOSURE, 2L,2W, DAY ONLY FOR SPEEDS >=45 MPH
701311-03	LANE CLOSURE, 2L,2W, MOVING OPERATIONS-DAY ONLY
701321-18	LANE CLOSURE, 2L,2W, BRIDGE REPAIR WITH BARRIER
701326-04	LANE CLOSURE, 2L,2W, PAVEMENT WIDENING FOR SPEEDS >=45 MPH
701901-09	TRAFFIC CONTROL DEVICES
704001-08	TEMPORARY CONCRETE BARRIER
780001-05	TYPICAL PAVEMENT MARKINGS
782006-01	GUARDRAIL AND BARRIER WALL REFLECTOR MOUNTING DETAILS

## GENERAL NOTES

THE PROPOSED PROJECT IS LOCATED ON US-50 OVER IL RAILROAD AT THE MARION COUNTY LINE. THE WORK IN THIS SECTION CONSISTS OF BRIDGE DECK SCARIFICATION, FULL DEPTH DECK PATCHING, BRIDGE DECK CONCRETE OVERLAY, NEW APPROACH PAVEMENT AND PAVEMENT CONNECTORS, REMOVE AND RE-ERECT TYPE 6 TRAFFIC BARRIER TERMINALS, SHOULDER REMOVAL, PCC SHOULDER, PAVEMENT MARKING, SLOPEWALL REPAIR AND ANY OTHER WORK NEEDED TO COMPLETE THIS SECTION.

IF THE PAVEMENT SENSORS FOR THE WEATHER STATION ARE DISTURBED CONTACT D-7 OPERATIONS, (217) 342-8261.

## MIX DESIGN TABLE

LOCATION(S)	MIXTURE USE(S)	PG	DESIGN AIR Voids	MIXTURE COMPOSITION	FRICTION AGGREGATE	QUALITY MANAGEMENT PROGRAM	SUBLOT SIZE	MATERIAL TRANSFER DEVICE (REQUIRED?)
MAINLINE	HMA SURFACE COURSE, IL-9.5, MIX "C", N70	PG 64-22	4.0% @ N=70	IL - 9.5	MIXTURE C	OCQA	3000	N/A

REV - MS

MODEL: Default  
FILE NAME: c:\pw\work\paw\chilley\ad090745D774C59-shi-gennotes.dgn

USER NAME = Stacy Anderson	DESIGNED -	REVISED -	<b>STATE OF ILLINOIS DEPARTMENT OF TRANSPORTATION</b>	<b>GENERAL NOTES, INDEX SHEETS, STANDARDS</b>	F.A. RTE.	SECTION	COUNTY	TOTAL SHEETS	SHEET NO.	
	DRAWN -	REVISED -			327	D7 BRIDGE REPAIRS 2025-10	CLAY	24	2	
	CHECKED -	REVISED -			CONTRACT NO. 74C59					
PLOT DATE = 7/3/2024	DATE -	REVISED -			SCALE:	SHEET	OF	SHEETS	STA.	TO
					ILLINOIS FED. AID PROJECT					

80% FED  
20% STATE

80% FED  
20% STATE

SUMMARY OF QUANTITIES			TOTAL QUANTITIES	CONSTRUCTION TYPE CODE		
CODE NO	ITEM	UNIT		0059		
28100803	STONE DUMPED RIPRAP, CLASS A2	TON	50	50		
35400400	PORTLAND CEMENT CONCRETE BASE COURSE WIDENING 9"	SQ YD	452	452		
40600290	BITUMINOUS MATERIALS (TACK COAT)	POUND	72	72		
40600982	HOT-MIX ASPHALT SURFACE REMOVAL- BUTT JOINT	SQ YD	160	160		
40600990	TEMPORARY RAMP	SQ YD	27	27		
40604052	HOT-MIX ASPHALT SURFACE COURSE, 1L-9.5, MIX "C", N70	TON	13	13		
42000080	PAVEMENT CONNECTOR (PCC)	SQ YD	260	260		
44000100	PAVEMENT REMOVAL	SQ YD	260	260		
44004250	PAVED SHOULDER REMOVAL	SQ YD	226	226		
44200050	WELDED WIRE REINFORCEMENT	SQ YD	260	260		
48102100	AGGREGATE WEDGE SHOULDER, TYPE B	TON	8	8		
50157300	PROTECTIVE SHIELD	SQ YD	291	291		
50300225	CONCRETE STRUCTURES	CU YD	30.4	30.4		

SUMMARY OF QUANTITIES			TOTAL QUANTITIES	CONSTRUCTION TYPE CODE		
CODE NO	ITEM	UNIT		0059		
50300300	PROTECTIVE COAT	SQ YD	1070	1070		
50301350	CONCRETE SUPERSTRUCTURE (APPROACH SLAB)	CU YD	121.1	121.1		
50800205	REINFORCEMENT BARS, EPOXY COATED	POUNDS	51,320	51,320		
50800515	BAR SPLICERS	EACH	290	290		
50800530	MECHANICAL SPLICERS	EACH	78	78		
63302700	REMOVE AND REERECT TRAFFIC BARRIER TERMINALS, TYPE 6	EACH	4	4		
67000400	ENGINEER'S FIELD OFFICE TYPE A	CAL MO	5	5		
67100100	MOBILIZATION	L SUM	1	1		
70100405	TRAFFIC CONTROL AND PROTECTION, STANDARD 701321	EACH	1	1		
70100450	TRAFFIC CONTROL AND PROTECTION, STANDARD 701201	L SUM	1	1		
70100500	TRAFFIC CONTROL AND PROTECTION, STANDARD 701326	L SUM	1	1		
70106500	TEMPORARY BRIDGE TRAFFIC SIGNALS	EACH	1	1		
70107005	PAVEMENT MARKING BLACKOUT TAPE, 5"	FOOT	1075	1075		

MODEL: Default  
FILE NAME: c:\pwworkspace\hillej\p072450774C59-800.dgn

REV - MS

USER NAME = jessica.hille	DESIGNED -	REVISED -	<b>STATE OF ILLINOIS DEPARTMENT OF TRANSPORTATION</b>	<b>SUMMARY OF QUANTITIES</b>			F.A. RTE.	SECTION	COUNTY	TOTAL SHEETS	SHEET NO.			
PLOT SCALE = \$SCALE\$	DRAWN -	REVISED -		SCALE:	SHEET	OF	SHEETS	STA.	TO STA.	327	D7 BRIDGE REPAIRS 2025-10	CLAY	24	3
PLOT DATE = 7/5/2024	CHECKED -	REVISED -		CONTRACT NO. 74C59										
	DATE -	REVISED -		ILLINOIS   FED. AID PROJECT										

SUMMARY OF QUANTITIES			TOTAL QUANTITIES	CONSTRUCTION TYPE CODE		
CODE NO	ITEM	UNIT		0059		
70107025	CHANGEABLE MESSAGE SIGN	CAL DA	28	28		
70300100	SHORT TERM PAVEMENT MARKING	FOOT	49	49		
70300150	SHORT TERM PAVEMENT MARKING REMOVAL	SO FT	465	465		
70400100	TEMPORARY CONCRETE BARRIER	FOOT	577	577		
70400125	PINNING TEMPORARY CONCRETE BARRIER	EACH	84	84		
70400200	RELOCATE TEMPORARY CONCRETE BARRIER	FOOT	501	501		
70600250	IMPACT ATTENUATORS, TEMPORARY (NON-REDIRECTIVE), TEST LEVEL 3	EACH	2	2		
70600350	IMPACT ATTENUATORS, RELOCATE (NON-REDIRECTIVE), TEST LEVEL 3	EACH	2	2		
•78001110	PAINT PAVEMENT MARKING - LINE 4"	FOOT	796	796		
78300200	RAISED REFLECTIVE PAVEMENT MARKER REMOVAL	EACH	5	5		
X5030250	BRIDGE DECK GROOVING (LONGITUDINAL)	SO YD	631	631		
X5110304	SLOPE WALL (SPECIAL)	SO YD	785	785		

SUMMARY OF QUANTITIES			TOTAL QUANTITIES	CONSTRUCTION TYPE CODE		
CODE NO	ITEM	UNIT		0059		
X5503101	PLUG EXISTING PIPE	CU YD	6	6		
X6060700	REMOVE INLET BOX	EACH	4	4		
Z0004552	APPROACH SLAB REMOVAL	SO YD	267	267		
Z0012111	BRIDGE DECK FLY ASH OR GGBF SLAG CONCRETE OVERLAY, 2 1/2"	SO YD	785	785		
Z0012130	BRIDGE DECK SCARIFICATION 3/4"	SO YD	785	785		
Z0016001	DECK SLAB REPAIR (FULL DEPTH, TYPE I)	SO YD	6	6		
Z0016002	DECK SLAB REPAIR (FULL DEPTH, TYPE II)	SO YD	4	4		
Z0029090	DIAMOND GRINDING (BRIDGE SECTION)	SO YD	954	954		
Z0048665	RAILROAD PROTECTIVE LIABILITY INSURANCE	L SUM	1	1		

• SPECIALTY ITEM

REV - MS

MODEL: Default  
FILE NAME: c:\pwworkspace\hillej\p007245D774C59-500.dgn

USER NAME = jessica.hille	DESIGNED -	REVISED -
	DRAWN -	REVISED -
PLOT SCALE = \$SCALE\$	CHECKED -	REVISED -
PLOT DATE = 7/5/2024	DATE -	REVISED -

STATE OF ILLINOIS  
DEPARTMENT OF TRANSPORTATION

SUMMARY OF QUANTITIES

SCALE: SHEET OF SHEETS STA. TO STA.

F.A. RTE.	SECTION	COUNTY	TOTAL SHEETS	SHEET NO.
327	D7 BRIDGE REPAIRS 2025-10	CLAY	24	4
CONTRACT NO. 74C59			ILLINOIS   FED. AID PROJECT	

TYPICAL CROSS SECTION

STA. 570+39 TO STA. 572+26 RT  
 STA. 574+63 TO STA. 576+20 RT  
 STA. 570+70 TO STA. 572+26 LT  
 STA. 574+63 TO STA. 576+40 LT

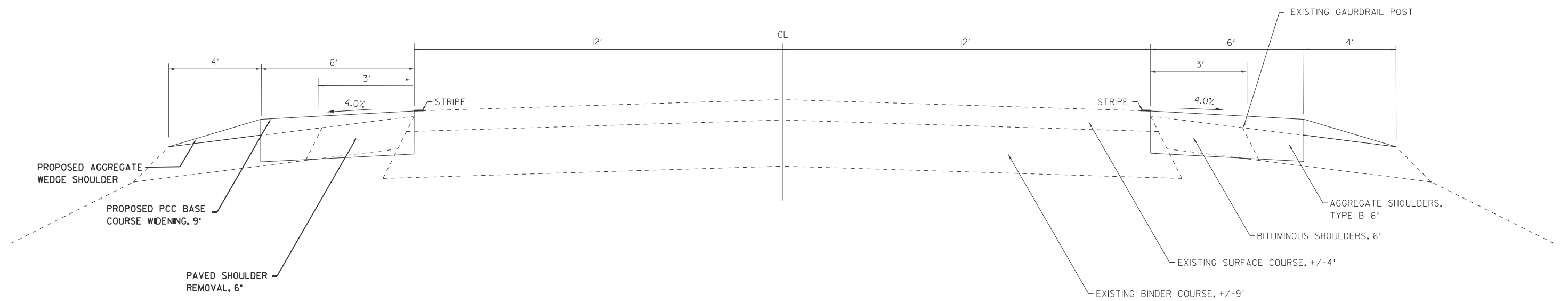

NOTE: NOT DRAWN TO SCALE

MODEL: Default  
 FILE NAME: c:\p\work\pww\hills\ad090724\5D774C59-shh\typical.dgn

USER NAME = Stacy.Anderson	DESIGNED -	REVISED -
	DRAWN -	REVISED -
PLOT SCALE = \$SCALE\$	CHECKED -	REVISED -
PLOT DATE = 7/3/2024	DATE -	REVISED -

STATE OF ILLINOIS  
 DEPARTMENT OF TRANSPORTATION

TYPICAL SECTION

SCALE: SHEET OF SHEETS STA. TO STA.

F.A.P. RTE.	SECTION	COUNTY	TOTAL SHEETS	SHEET NO.
327	D7 BRIDGE REPAIRS 2025-10	CLAY	24	5
CONTRACT NO. 74C59				
		ILLINOIS	FED. AID PROJECT	

BITUMINOUS MATERIALS (TACK COAT)					
STATIONING		LENGTH (FEET)	WIDTH (FEET)	AREA (SQ FT)	40600290 BITUMINOUS MATERIALS (TACK COAT) MAINLINE (POUND)
FROM	TO				
571+68.55	571+98.55	30	24.0	720	36.0
574+90.45	575+20.45	30	24.0	720	36.0
TOTAL					72

PCC BASE COURSE WIDENING 9"						
STATIONING				WIDENING WIDTH (FOOT)	WIDENING LENGTH (FOOT)	WIDENING AREA (SQ YD)
FROM		TO				
570+39	RT	572+26	RT	6	187.3	124.8
574+63	RT	576+20	RT	6	157.3	104.8
570+70	LT	572+26	LT	6	156.3	104.2
574+63	LT	576+10	LT	6	177.3	118.2
TOTAL						452

HOT-MIX ASPHALT SURFACE REMOVAL - BUTT JOINT					
STATIONING		LENGTH (FEET)	WIDTH (FEET)	AREA (SQ FT)	AREA (SQ YD)
FROM	TO				
571+69	571+99	30	24.0	720	80.0
574+90	575+20	30	24.0	720	80.0
TOTALS					160

TEMPORARY RAMP					
LOCATION		RAMP WIDTH (FOOT)	DROP- OFF DEPTH (INCH)	RAMP LENGTH (FOOT)	RAMP AREA (SQ YD)
STATION	SIDE				
572+26.25	CL	24.0	1.5	5.0	13.3
574+62.75	CL	24.0	1.5	5.0	13.3
TOTAL					27

HOT-MIX ASPHALT SURFACE COURSE, IL-9.5, MIX "C", N70						
STATIONING		LENGTH (FEET)	WIDTH (FEET)	AVG LIFT THICKNESS (INCH)	AREA MAINLINE (SQ FT)	HMA SURFACE COURSE IL-9.5 N70 (TON)
FROM	TO					
571+69	571+99	30	24.0	1.50	720	6.7
574+90	575+20	30	24.0	1.50	720	6.7
TOTALS						13

AGGREGATE WEDGE SHOULDER, TYPE B						
STATIONING		LENGTH (FEET)	WIDTH (FEET)	AREA (SQ YD)	VOLUME (CU YD)	AGGREGATE WEDGE SHOULDER, TYPE B (TON)
FROM	TO					
570+39.00	572+26.25	48	4.0	21.1	1	2.1
574+62.75	576+20.00	48	4.0	21.1	1	2.1
570+70.00	572+26.25	48	4.0	21.1	1	2.1
574+62.75	575+40.00	48	4.0	21.1	1	2.1
TOTAL						8

PAVED SHOULDER REMOVAL						
STATIONING				WIDENING WIDTH (FOOT)	WIDENING LENGTH (FOOT)	WIDENING AREA (SQ YD)
FROM		TO				
570+39	RT	572+26	RT	3	187.3	62.4
574+63	RT	576+20	RT	3	157.3	52.4
570+70	LT	572+26	LT	3	156.3	52.1
574+63	LT	576+40	LT	3	177.3	59.1
TOTAL						226

TRAFFIC CONTROL SCHEDULE					
STATIONING		70400100 TEMPORARY CONCRETE BARRIER (FEET)	70400200 RELOCATE TEMPORARY CONCRETE BARRIER (FEET)	70600250 IMPACT ATTENUATORS TEMPORARY (NON- REDIRECTIVE), TEST LEVEL 3 (EACH)	70600350 IMPACT ATTENUATORS, RELOCATE (NON REDIRECTIVE), TEST LEVEL 3 (EACH)
FROM	TO				
STAGE 1					
570+03.00	576+36.00	577.0		2	
STAGE 2					
570+65	576+20.00		501		2

MODEL: Default  
 FILE NAME: c:\p\work\pww\hills\p007245D774C59-shi-schedule.dgn

USER NAME = Stacy.Anderson	DESIGNED -	REVISED -
	DRAWN -	REVISED -
PLOT SCALE = \$SCALE\$	CHECKED -	REVISED -
PLOT DATE = 7/3/2024	DATE -	REVISED -

**STATE OF ILLINOIS**  
**DEPARTMENT OF TRANSPORTATION**

**SCHEDULE OF QUANTITIES**

SCALE: SHEET OF SHEETS STA. TO STA.

F.A.P. RTE.	SECTION	COUNTY	TOTAL SHEETS	SHEET NO.
327	D7 BRIDGE REPAIRS 2025-10	CLAY	24	6
CONTRACT NO. 74C59				
ILLINOIS FED. AID PROJECT				

		PAVEMENT REMOVAL	WELDED WIRE REINFORCEMENT	PAVEMENT CONNECTOR (PCC)
STATIONING		AREA (SQ YD)	AREA (SQ YD)	AREA (SQ YD)
FROM	TO			
571+98.55	572+26.25	130.0	130.0	130.0
574+62.75	574+90.05	130.0	130.0	130.0
TOTAL=		260	260	260

SHORT TERM PAVEMENT MARKING SCHEDULE			
FROM	TO		FOOT
STAGE 1			
571+68	575+21	CL	35
571+68	575+21	LT/RT	14
TOTAL =			49

PAVEMENT MARKING SCHEDULE				
STATION		SIDE	LENGTH FOOT	PAVEMENT MARKING BLACKOUT TAPE, 5"
FROM	TO			
STAGE 1				
569+00	571+23	CL	223	56
570+39	576+50	RT	611	611
575+66	578+06	CL	240	60
STAGE 2				
570+51	572+26	LT	175	175
574+63	576+36	LT	173	173
TOTAL				1075

PAINT PAVEMENT MARKING 4"					
			FOOT	SOLID EDGE WHITE	SKIP DASH YELLOW
FROM	TO			FOOT	FOOT
571+68	575+21	CL	353		90
571+68	575+21	LT/RT	353	706.0	
SUBTOTALS				706	90
TOTALS				796	

MODEL: Default  
 FILE NAME: c:\p\work\pav\illinois.gov\_stacy\_anderson@illinois.gov\090724\6D74C59-shr-schedule.dgn

USER NAME = jessica.hille	DESIGNED -	REVISED -
PLOT SCALE = \$SCALE\$	DRAWN -	REVISED -
PLOT DATE = 7/5/2024	CHECKED -	REVISED -
	DATE -	REVISED -

**STATE OF ILLINOIS**  
**DEPARTMENT OF TRANSPORTATION**

**SCHEDULE OF QUANTITIES**

SCALE: SHEET OF SHEETS STA. TO STA.

F.A. RTE.	SECTION	COUNTY	TOTAL SHEETS	SHEET NO.
327	D7 BRIDGE REPAIRS 2025-10	CLAY	24	7
CONTRACT NO. 74C59				
ILLINOIS FED. AID PROJECT				

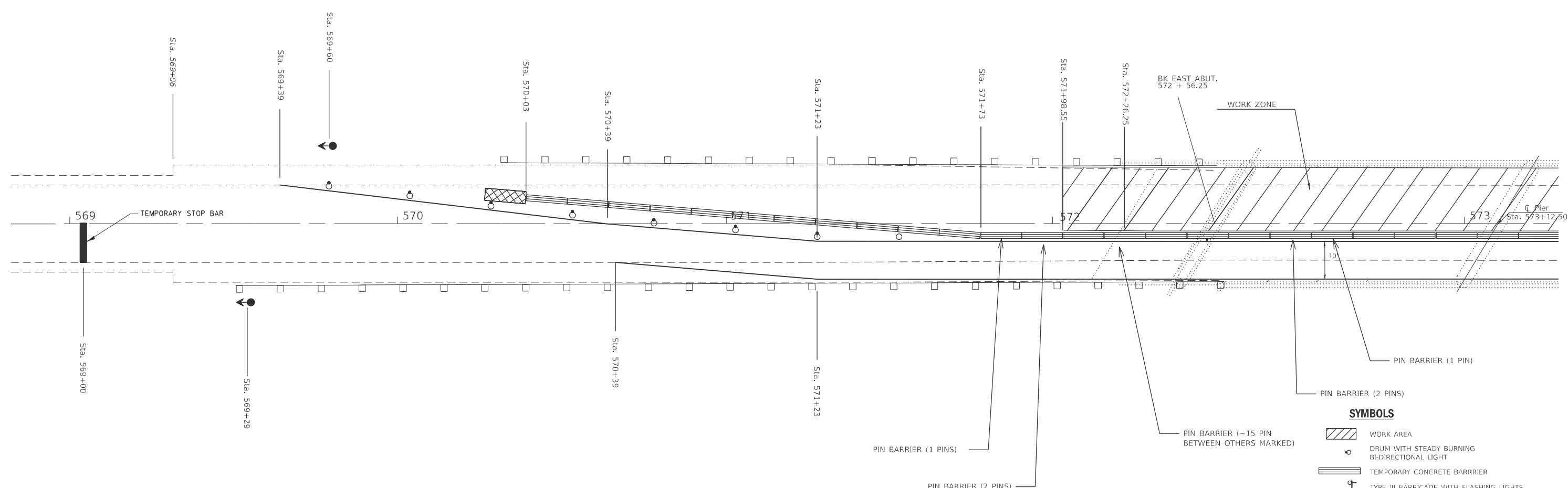
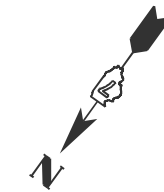

- SYMBOLS**
- WORK AREA
  - DRUM WITH STEADY BURNING BI-DIRECTIONAL LIGHT
  - TEMPORARY CONCRETE BARRIER
  - TYPE III BARRICADE WITH FLASHING LIGHTS
  - TRAFFIC SIGNAL
  - IMPACT ATTENUATOR
  - DRUM

REFER TO STANDARD 701321 FOR LOCATIONS AND SPACING OF RUMBLE STRIPS, SIGNAGE, DETECTOR LOOP

MODEL: Default  
FILE NAME: c:\p\work\wv\cd\hills\ad0907245D774C59-sh1-plan.dgn

USER NAME = Stacy.Anderson	DESIGNED -	REVISED -
	DRAWN -	REVISED -
	CHECKED -	REVISED -
PLOT DATE = 7/1/2024	DATE -	REVISED -

**STATE OF ILLINOIS  
DEPARTMENT OF TRANSPORTATION**

**TRAFFIC CONTROL STAGING  
STAGE 1**

SCALE: SHEET OF SHEETS STA. TO STA.

F.A.P. RTE.	SECTION	COUNTY	TOTAL SHEETS	SHEET NO.
327	D7 BRIDGE REPAIRS 2025-10	CLAY	24	8
CONTRACT NO. 74C59			ILLINOIS FED. AID PROJECT	



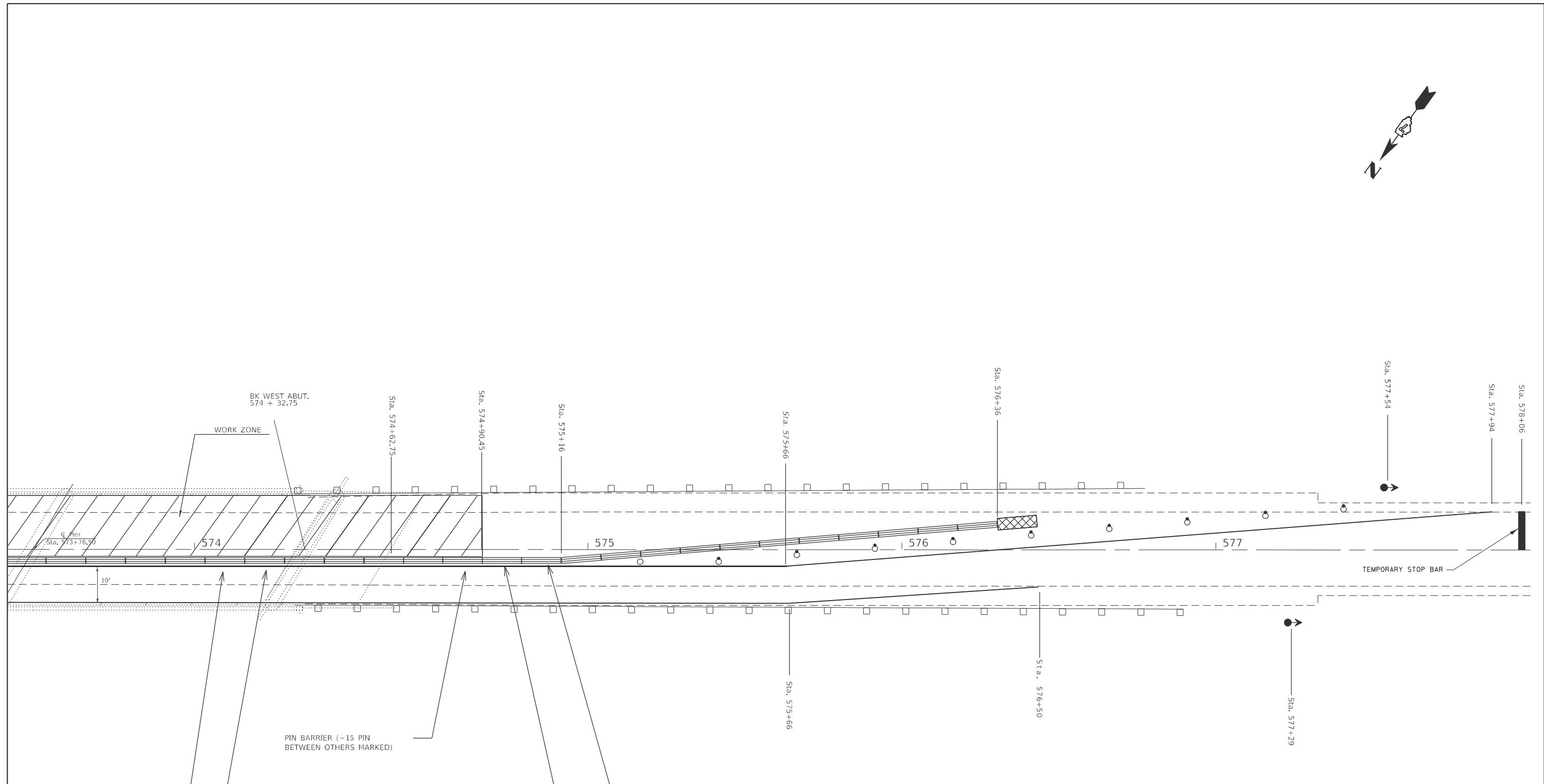
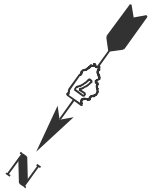

- SYMBOLS**
- WORK AREA
  - DRUM WITH STEADY BURNING BI-DIRECTIONAL LIGHT
  - TEMPORARY CONCRETE BARRIER
  - TYPE III BARRICADE WITH FLASHING LIGHTS
  - TRAFFIC SIGNAL
  - IMPACT ATTENUATOR
  - DRUM

MODEL: Default  
 FILE NAME: c:\pwworking\hills\d0907245D774C59-sh1r-plan.dgn

USER NAME = Stacy.Anderson	DESIGNED -	REVISED -
	DRAWN -	REVISED -
	CHECKED -	REVISED -
PLOT DATE = 7/1/2024	DATE -	REVISED -

**STATE OF ILLINOIS  
DEPARTMENT OF TRANSPORTATION**





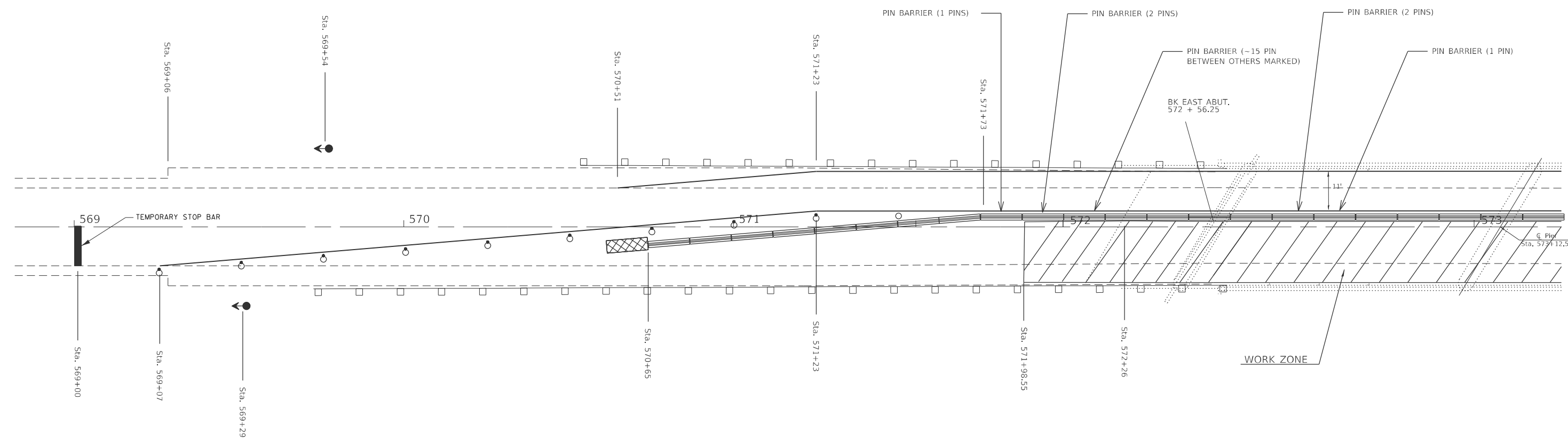
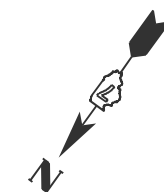

**TRAFFIC CONTROL STAGING  
STAGE 1**

F.A.P. RTE.	SECTION	COUNTY	TOTAL SHEETS	SHEET NO.
327	D7 BRIDGE REPAIRS 2025-10	CLAY	24	9
CONTRACT NO. 74C59				
ILLINOIS FED. AID PROJECT				

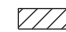
SCALE: SHEET OF SHEETS STA. TO STA.



**SYMBOLS**

	WORK AREA
	DRUM WITH STEADY BURNING BI-DIRECTIONAL LIGHT
	TEMPORARY CONCRETE BARRRIER
	TYPE III BARRICADE WITH FLASHING LIGHTS
	TRAFFIC SIGNAL
	IMPACT ATTENUATOR
	DRUM

MODEL: Default  
 FILE NAME: c:\p\work\pwr\hillead\090724\5D774C59-shh-plan.dgn

USER NAME = Stacy.Anderson	DESIGNED -	REVISED -
	DRAWN -	REVISED -
PLOT SCALE = \$SCALE\$	CHECKED -	REVISED -
PLOT DATE = 7/1/2024	DATE -	REVISED -

**STATE OF ILLINOIS  
 DEPARTMENT OF TRANSPORTATION**

**TRAFFIC CONTROL STAGING  
 STAGE 2**

SCALE: SHEET OF SHEETS STA. TO STA.

F.A. RTE.	SECTION	COUNTY	TOTAL SHEETS	SHEET NO.
327	D7 BRIDGE REPAIRS 2025-10	CLAY	24	10
ILLINOIS FED. AID PROJECT			CONTRACT NO. 74C59	

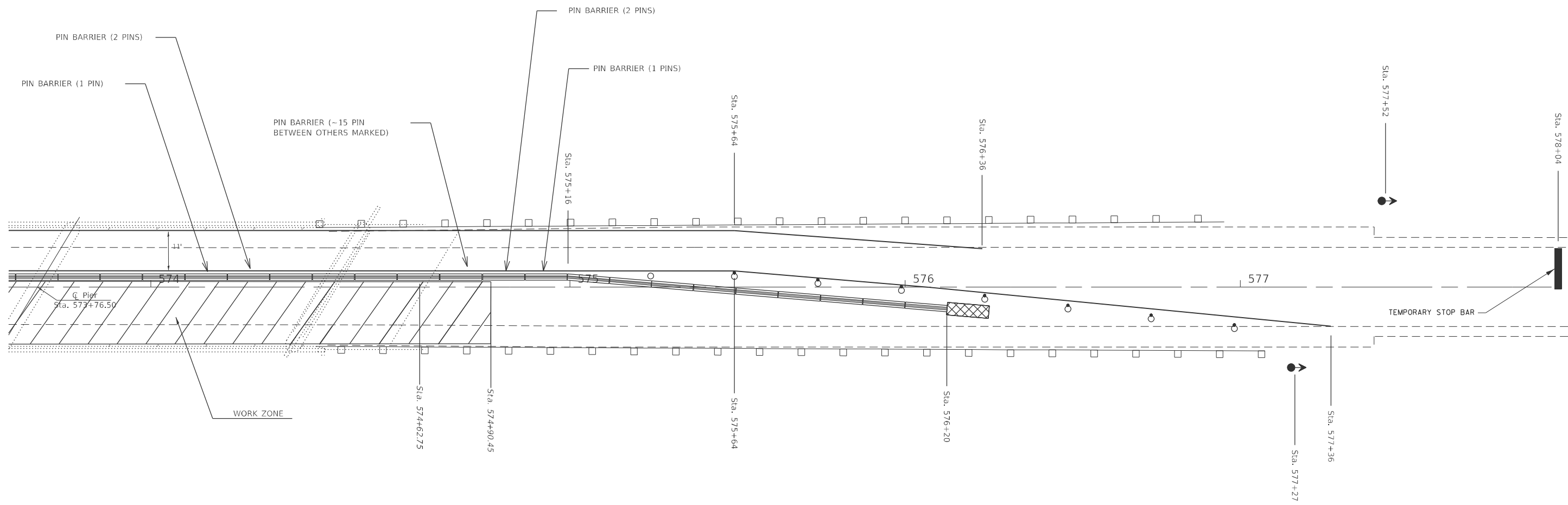
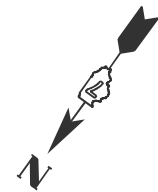

**SYMBOLS**

	WORK AREA
	DRUM WITH STEADY BURNING BI-DIRECTIONAL LIGHT
	TEMPORARY CONCRETE BARRIER
	TYPE III BARRICADE WITH FLASHING LIGHTS
	TRAFFIC SIGNAL
	IMPACT ATTENUATOR
	DRUM

MODEL: Default  
 FILE NAME: c:\p\work\pwr\hille\ad0907245D774C59-shr-plan.dgn

USER NAME = jessica.hille	DESIGNED -	REVISED -
	DRAWN -	REVISED -
PLOT SCALE = \$SCALE\$	CHECKED -	REVISED -
PLOT DATE = 7/5/2024	DATE -	REVISED -

**STATE OF ILLINOIS**  
**DEPARTMENT OF TRANSPORTATION**

**TRAFFIC CONTROL STAGING**  
**STAGE 2**

SCALE: SHEET OF SHEETS STA. TO STA.

F.A.P. RTE.	SECTION	COUNTY	TOTAL SHEETS	SHEET NO.
327	D7 BRIDGE REPAIRS 2025-10	CLAY	24	11
ILLINOIS FED. AID PROJECT			CONTRACT NO. 74C59	

EXISTING STRUCTURE: SN 013-0036 carries US-50 over Illinois Central Railroad. The three span, P.P.C I-beam structure was built in 1996. The proposed project consists of scarification, full depth deck patching, concrete overlay, new approaches, and slopewall repair.

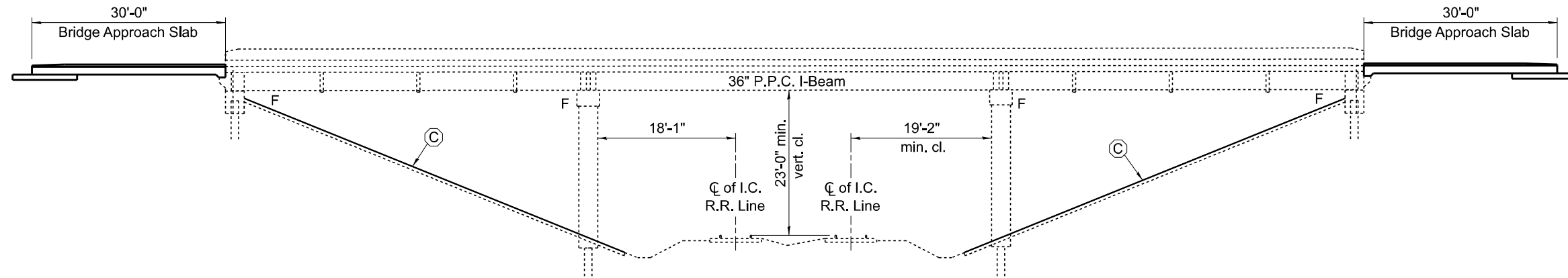

ELEVATION

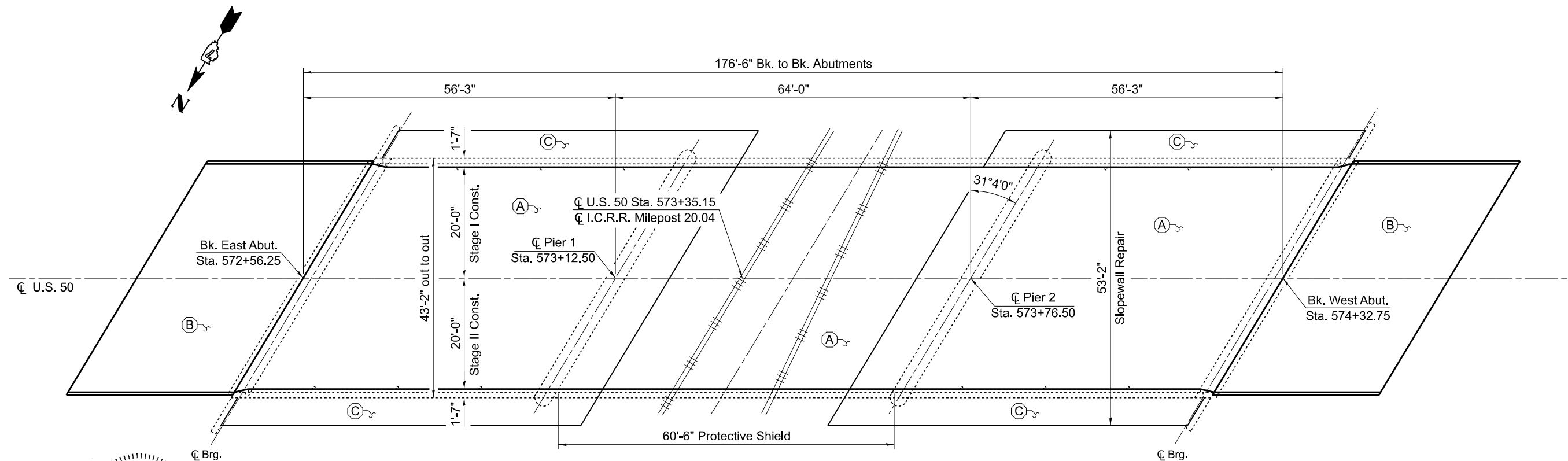

PLAN

- (A) - Bridge Deck Scarification  $\frac{3}{4}$ " , Deck Patching, Bridge Deck Fly Ash or GGBF Slag Concrete Overlay  $2\frac{1}{2}$ " , Diamond Grinding (Bridge Section), & Bridge Deck Grooving (Longitudinal)
- (B) - Remove Existing Approaches & Construct New Bridge Approach slabs, Diamond Grinding (Bridge Section), & Bridge Deck Grooving (Longitudinal)
- (C) - Slopewall Repair

DESIGN SPECIFICATIONS

2002 AASHTO Standard Specifications for Highway Bridges

DESIGN STRESSES

$f_y = 60,000$  psi (Reinforcement)  
 $f_y = 50,000$  psi (M270 Grade 50)

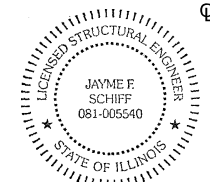

EXPIRES 11-30-2024

*Jayme F. Schiff*

STATE OF ILLINOIS  
 DEPARTMENT OF TRANSPORTATION

GENERAL PLAN & ELEVATION  
 S.N. 013-0036

USER NAME =	DESIGNED - T. Walk	REVISED -
	DRAWN - T. Walk	REVISED -
PLOT SCALE = 100,000' / 1"	CHECKED - D. Macklin	REVISED -
PLOT DATE = 7/8/2024	DATE - August 2023	REVISED -

SCALE: SHEET 1 OF 8 SHEETS STA. TO STA.

F.A.P. RTE.	SECTION	COUNTY	TOTAL SHEETS	SHEET NO.
327	D7 BRIDGE REPAIRS 2025-10	CLAY	24	12
CONTRACT NO. 74C59				
ILLINOIS FED. AID PROJECT				

MODEL: D:\infra\...  
 FILE NAME: ...  
 PROJECT: ...  
 DATE: ...

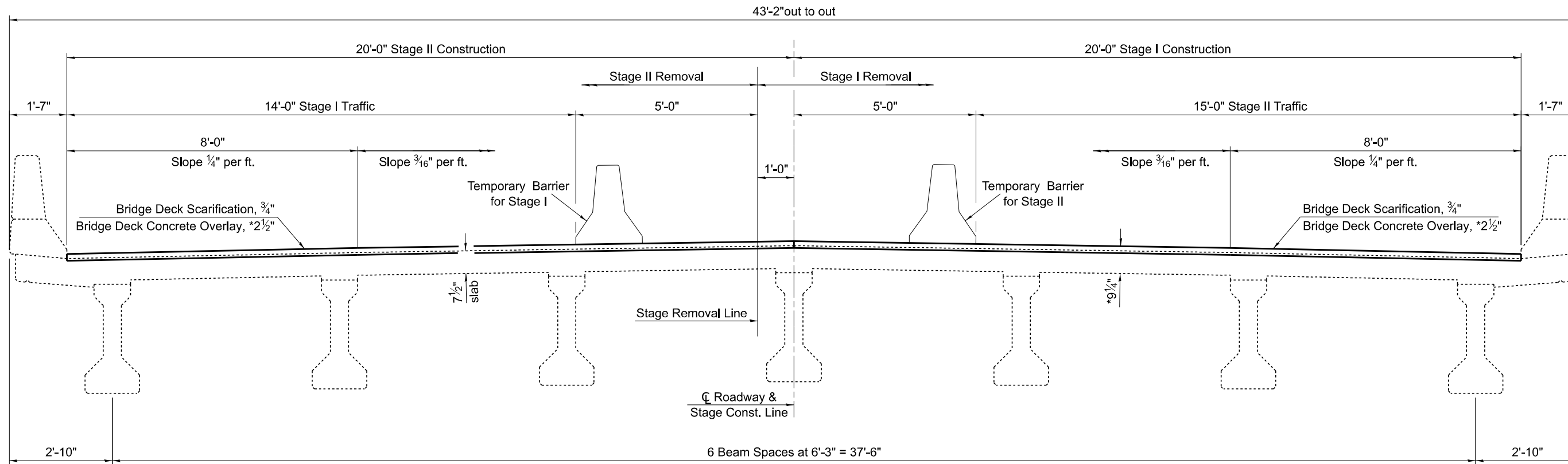

**STAGE CONSTRUCTION DETAIL**

Looking East

**GENERAL NOTES**

Plan dimensions and details relative to the existing structure have been taken from existing plans and are subject to nominal construction variations. The Contractor shall field verify existing dimensions and details affecting new construction and make necessary approved adjustments prior to construction or ordering of materials. Such variations shall not be cause for additional compensation for a change in scope of the work, however, the Contractor will be paid for the quantity actually furnished at the unit price bid for the work.

Reinforcement Bars designated (E) shall be epoxy coated.

Existing reinforcement bars extending into the removal area shall be cleaned, straightened and incorporated into the new construction. Any reinforcement bars that are damaged during concrete removal operations shall be replaced with an approved bar splicer or anchorage system at the Contractor's expense. Cost included with CONCRETE SUPERSTRUCTURE (APPROACH SLAB).

Protective Coat to be applied to areas of new concrete only, including bridge deck concrete overlay.

Areas of deck repairs shown are estimated. The Engineer shall show actual locations of deck repairs on as-built plans.

Full depth deck slab repairs performed in the exterior bays of the bridge deck (between the parapet walls and the first interior beams) shall be limited to individual lengths no greater than 10'. In these portions of the deck, repair areas longer than 10' shall be divided into segments not greater than 10' in length, and the segments shall be poured in alternating sequence. Subsequent segments repaired in sequence shall not be removed until 72 hours shall have elapsed from the end of the previous, adjacent pour, and the adjacent pour shall have attained a minimum modulus of rupture of 650psi.

The contractor shall take all measures necessary to ensure that the RWIS Weather Station conduit attached to the bottom of bridge shall be undisturbed.

The contractor shall take all measures necessary to ensure that no debris from deck repair or slope wall repair is allowed to reach the railroad track or ballast. Cost to be included with the appropriate pay item.

The work shall not change the quantity and/or character of flow in the Railway's ditches and/or drainage structures. The railway ditches shall be maintained at the same slope and grade as existing conditions

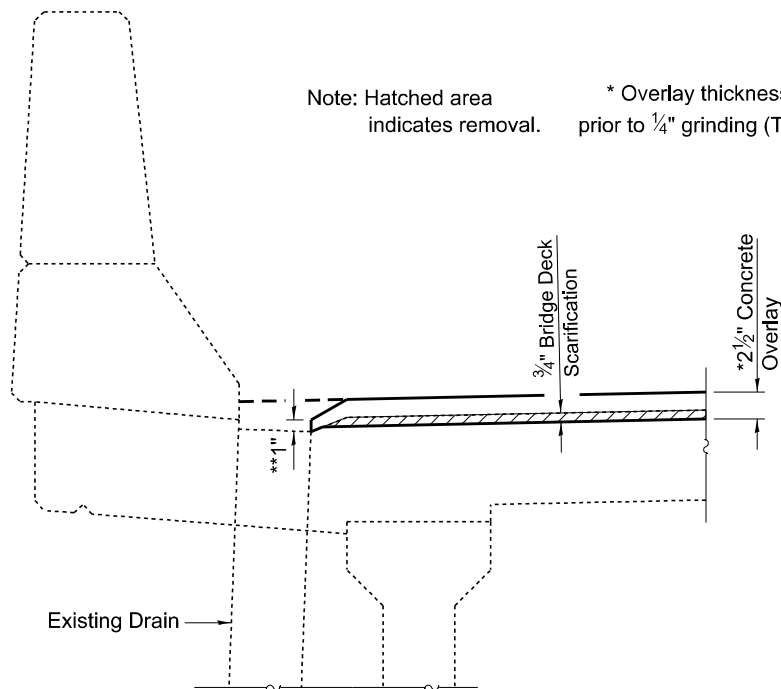

**FLOOR DRAIN PRESERVATION**

\*\* Minimum thickness of overlay at edge of drain = 1"

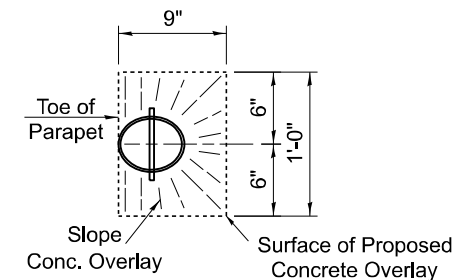

**TOP PLAN OF FLOOR DRAIN**

**TOTAL BILL OF MATERIALS**

ITEM	UNIT	QUANTITY
Concrete Structures	Cu. Yd.	30.4
Concrete Superstructure (Approach Slab)	Cu. Yd.	121.1
Reinforcement Bars, Epoxy Coated	Pound	51,320
Bar Splicers	Each	290
Mechanical Splicers	Each	78
Bridge Deck Scarification, 3/4"	Sq. Yd.	785
Bridge Deck Fly Ash or GGBF Slag Concrete Overlay, 2 1/2"	Sq. Yd.	785
Diamond Grinding (Bridge Section)	Sq. Yd.	954
Bridge Deck Grooving (Longitudinal)	Sq. Yd.	631
Protective Coat	Sq. Yd.	1,070
Deck Slab Repair (Full Depth, Type I)	Sq. Yd.	6.0
Deck Slab Repair (Full Depth, Type II)	Sq. Yd.	4.0
Protective Shield	Sq. Yd.	291
Slope Wall (Special)	Sq. Yd.	768
Stone Dumped Riprap, Class A2	Ton	50

MODEL: D:\in\...  
 FILE NAME: ...  
 PROJECT: ...  
 DATE: ...

USER NAME =	DESIGNED - T. Walk	REVISED -
	DRAWN - T. Walk	REVISED -
PLOT SCALE = 1/8" = 1'-0"	CHECKED - D. Macklin	REVISED -
PLOT DATE = 7/8/2024	DATE - August 2023	REVISED -

**STATE OF ILLINOIS  
DEPARTMENT OF TRANSPORTATION**

**STAGE CONSTRUCTION, GENERAL NOTES, &  
BILL OF MATERIALS S.N. 013-0036**

SCALE: SHEET 2 OF 8 SHEETS STA. TO STA.

F.A.P. RTE.	SECTION	COUNTY	TOTAL SHEETS	SHEET NO.
327	D7 BRIDGE REPAIRS 2025-10	CLAY	24	13
CONTRACT NO. 74C59				
ILLINOIS FED. AID PROJECT				



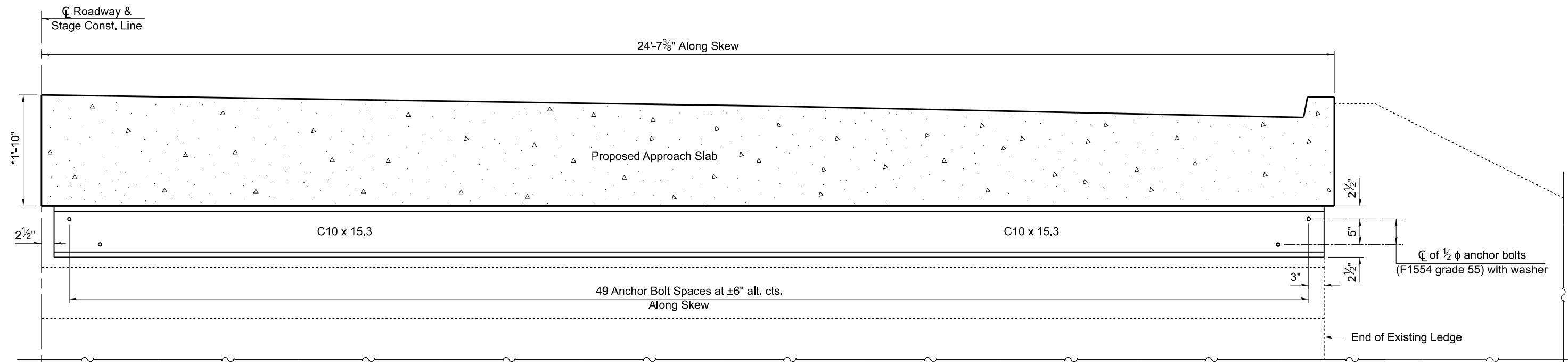

HALF ELEVATION OF BACK SIDE OF ABUTMENT

Notes:

- Channel shall be AASHTO M270 Grade 50.
- All steel shall be galvanized per AASHTO M111.
- Anchor Bolts shall be ASTM F1554 Grade 55 all-thread (or an Engineer approved alternative material) of the grade and diameter specified. Bolts 1/2 in. diameter, holes 3/4 in. diameter, unless otherwise noted.
- Drilled and set anchor bolts shall be installed according to Article 521.06 of the Standard Specifications.
- Cost of channels and anchor bolts is included in Concrete Superstructure (Approach Slab).

Note: Hatched area indicates removal.

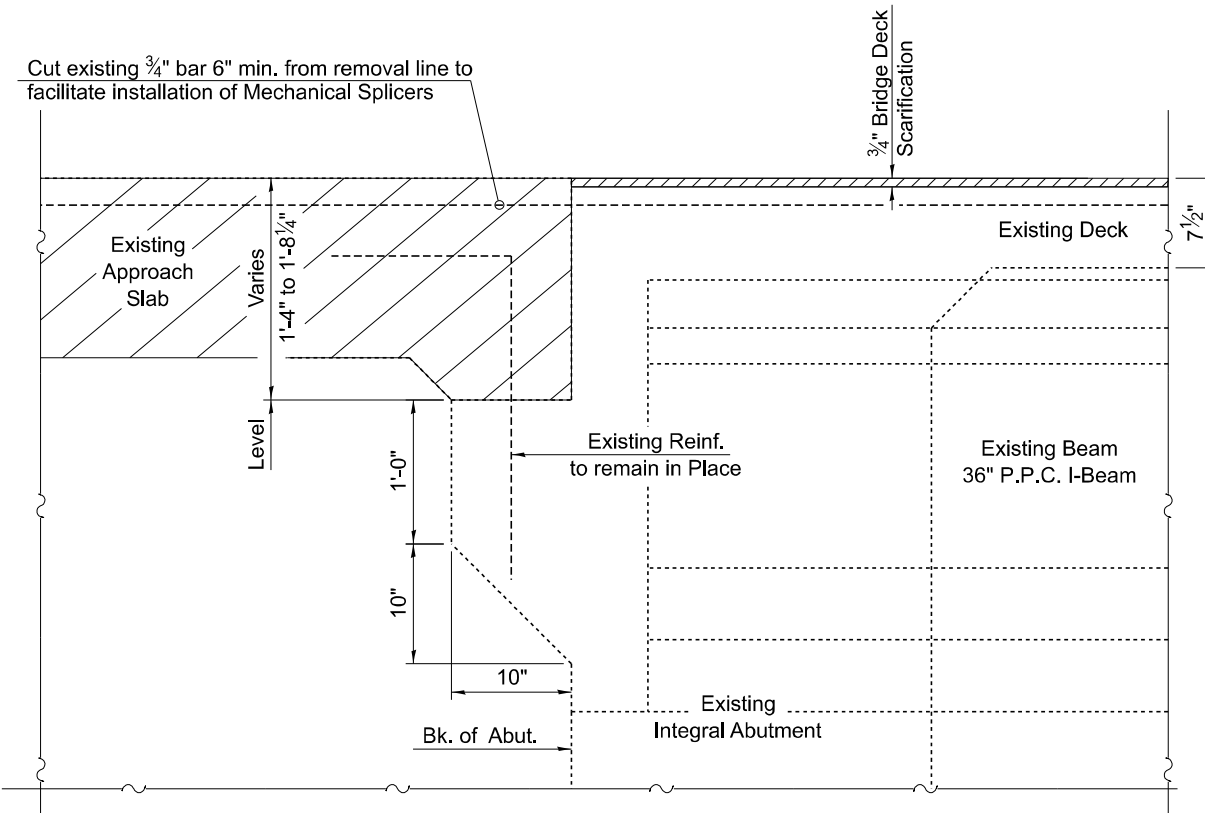

EXISTING SECTION THRU INTEGRAL ABUTMENT

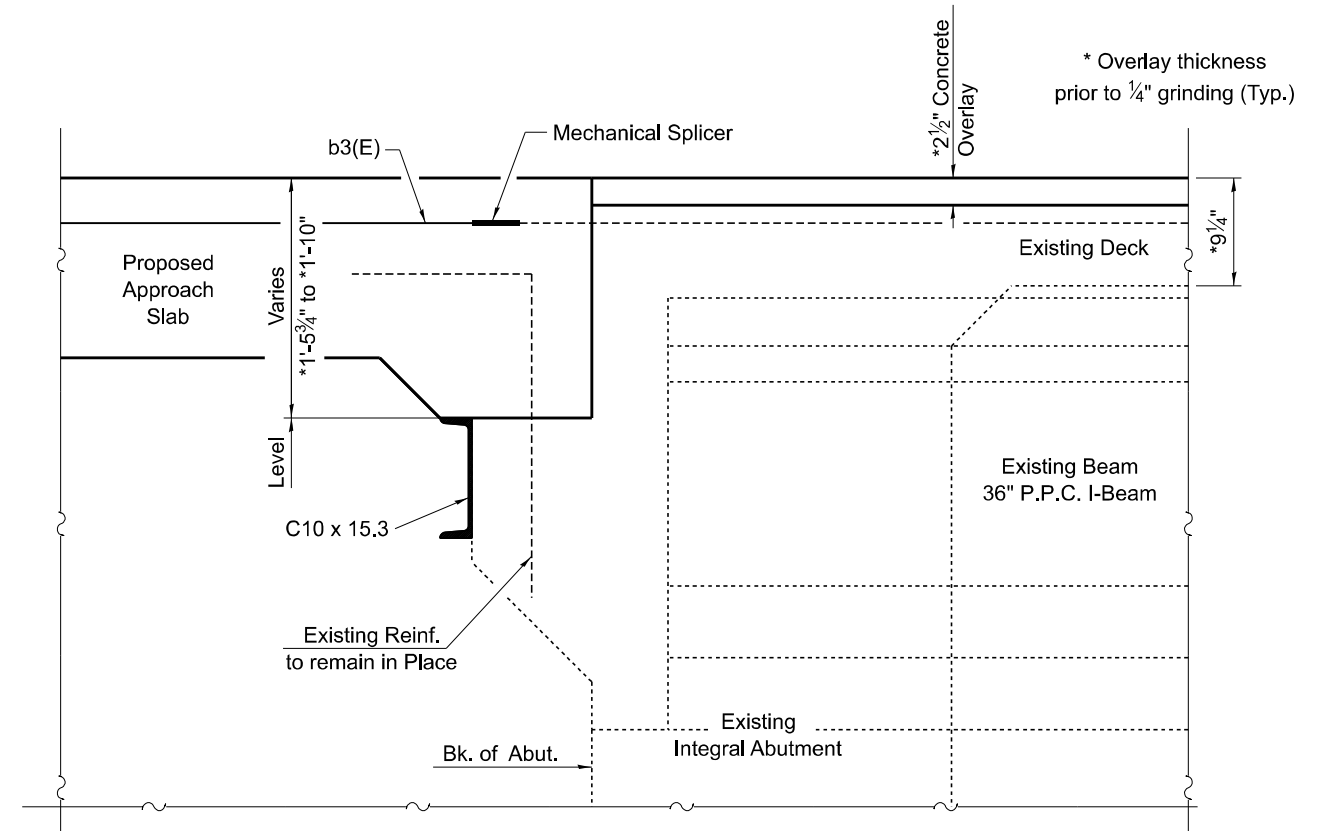

PROPOSED SECTION THRU INTEGRAL ABUTMENT

MODEL: D:\infra\...  
 FILE NAME: ...  
 PROJECT: ...  
 PLOT DATE: 7/8/2024

USER NAME =	DESIGNED - T. Walk	REVISED -
	DRAWN - T. Walk	REVISED -
PLOT SCALE = 100,000' / 1"	CHECKED - D. Macklin	REVISED -
PLOT DATE = 7/8/2024	DATE - August 2023	REVISED -

STATE OF ILLINOIS  
DEPARTMENT OF TRANSPORTATION

BRIDGE APPROACH DETAILS  
S.N. 013-0036

SCALE: SHEET 4 OF 8 SHEETS STA. TO STA.

F.A.P. RTE.	SECTION	COUNTY	TOTAL SHEETS	SHEET NO.
327	D7 BRIDGE REPAIRS 2025-10	CLAY	24	15
CONTRACT NO. 74C59				
ILLINOIS FED. AID PROJECT				

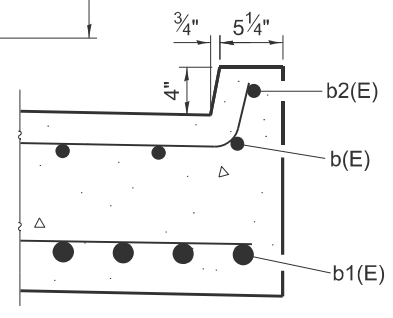
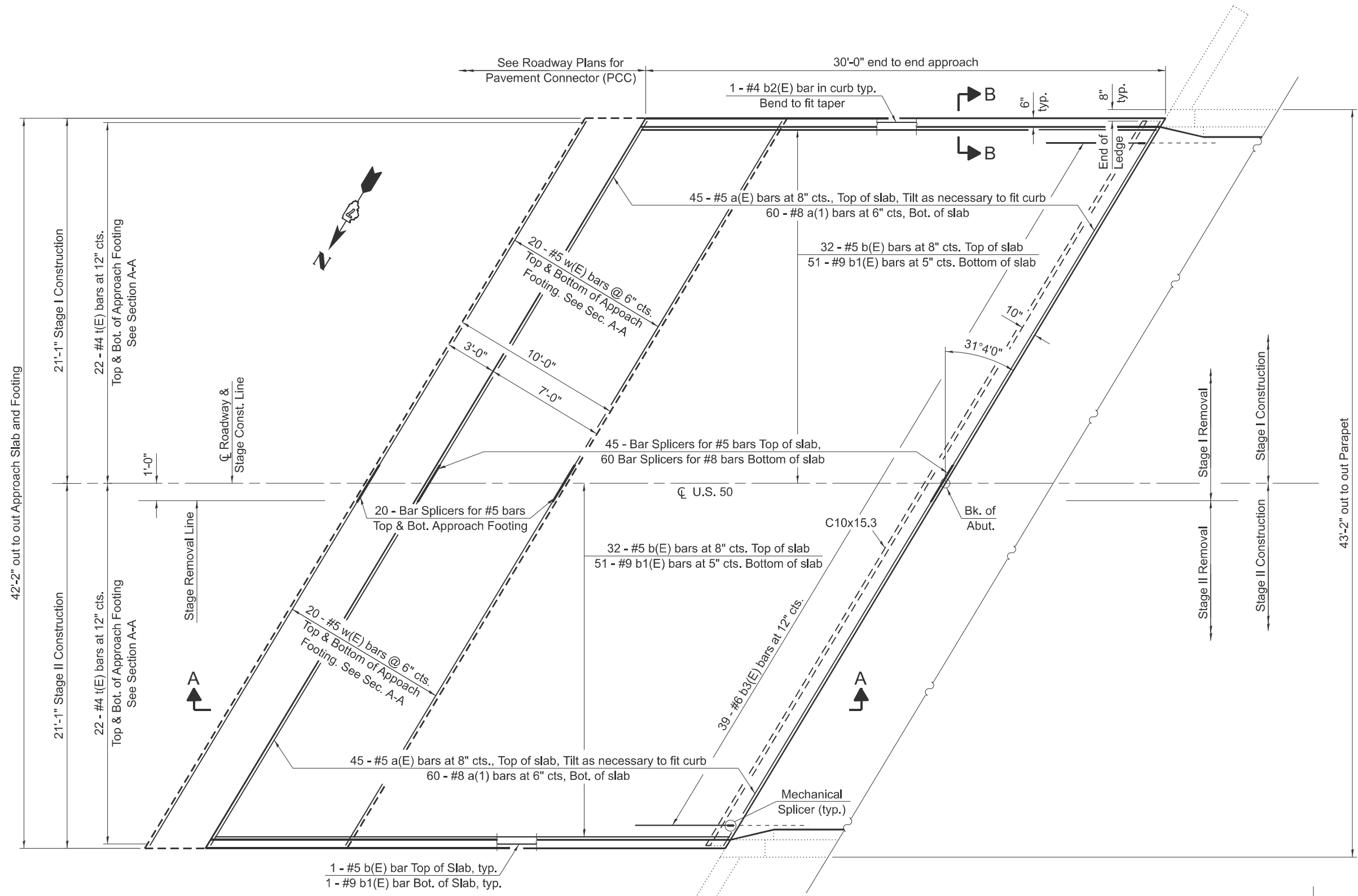

**Notes:**  
 The joint opening shall be adjusted for temperature per Article 520.04 of the Standard Specifications. However, since this detail is for jointless structures, the length of bridge used to calculate the adjustments shall be equal to half the total bridge length plus the length of the bridge approach slab.  
 Approach slab shall be paid for as Concrete Superstructure (Approach Slab).  
 Approach footing concrete shall be paid as Concrete Structures.  
 The approach footing maximum applied service bearing pressure (Qmax) = 2.0 ksf.  
 Cost of excavation for approach footing included with Concrete Structures.

**APPROACH PLAN**  
 East Approach Shown  
 West Approach Similar

**SECTION B-B**

MODEL: D:\info\...  
 FILE NAME: ...

USER NAME = jessica.nille	DESIGNED - T. Walk	REVISED -
	DRAWN - T. Walk	REVISED -
PLOT SCALE = \$SCALES	CHECKED - D. Macklin	REVISED -
PLOT DATE = 7/5/2024	DATE - August 2023	REVISED -

**STATE OF ILLINOIS**  
**DEPARTMENT OF TRANSPORTATION**

**BRIDGE APPROACH SLAB DETAILS - SHEET 1 OF 2**  
**S.N. 013-0036**

SCALE: SHEET 5 OF 8 SHEETS STA. TO STA.

F.A.P. RTE.	SECTION	COUNTY	TOTAL SHEETS	SHEET NO.
327	D7 BRIDGE REPAIRS 2025-10	CLAY	24	16
CONTRACT NO. 74C59				
ILLINOIS FED. AID PROJECT				



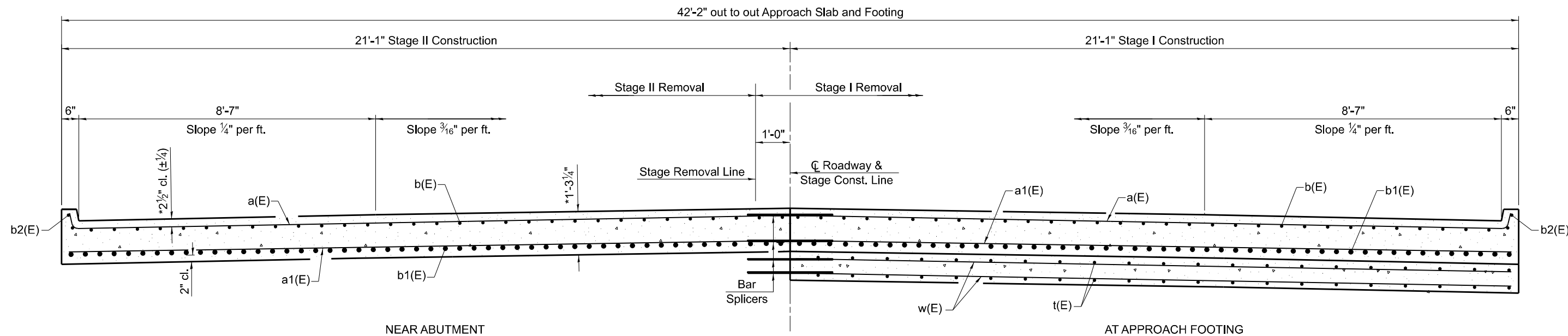

**APPROACH CROSS SECTION**  
Looking East

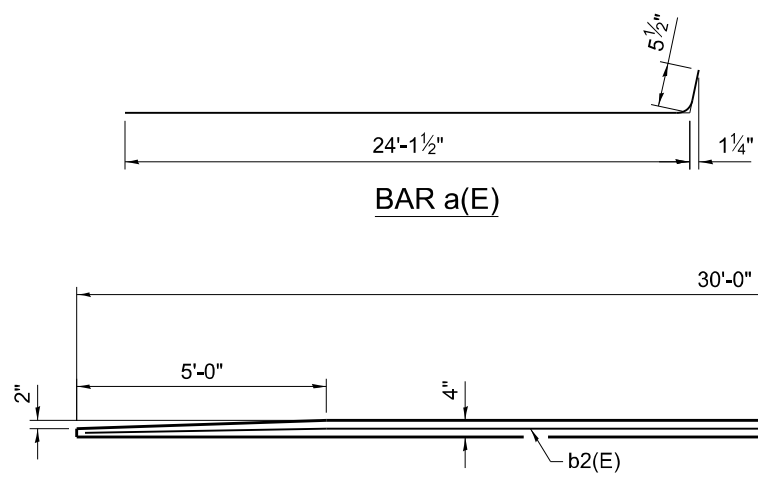

**INSIDE ELEVATION OF CURB**

\*\* Preformed Elastomeric Joint Seal according to Article 1053.01 of the Standard Specifications. Recess  $\frac{1}{2}$ " minimum. Run out to out of curb

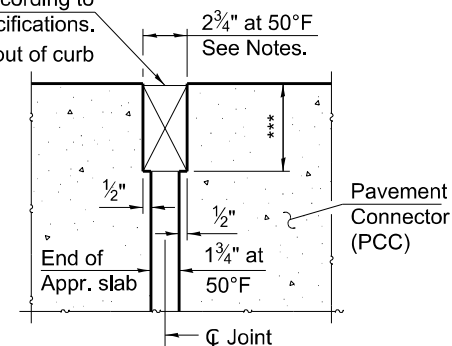

**DETAIL A**  
(@ Rt.  $\angle$ 's)

\*\*\* Per manufacturer recommendations

**BILL OF MATERIALS - TWO APPROACHES**

Bar	No.	Size	Length	Shape	
a(E)	180	#5	24'-7"	—	
a1(E)	240	#8	24'-3"	—	
b(E)	132	#5	29'-8"	—	
b1(E)	208	#9	29'-8"	—	
b2(E)	4	#4	29'-8"	—	
b3(E)	78	#6	5'-6"	—	
t(E)	176	#4	11'-3"	—	
w(E)	160	#5	24'-3"	—	
<b>ITEM</b>				<b>UNIT</b>	<b>QUANTITY</b>
Concrete Structures				Cu. Yd.	30.4
Concrete Superstructure (Approach Slab)				Cu. Yd.	121.1
Reinforcement Bars, Epoxy Coated				Pound	51,320
Bar Splicers				Each	290

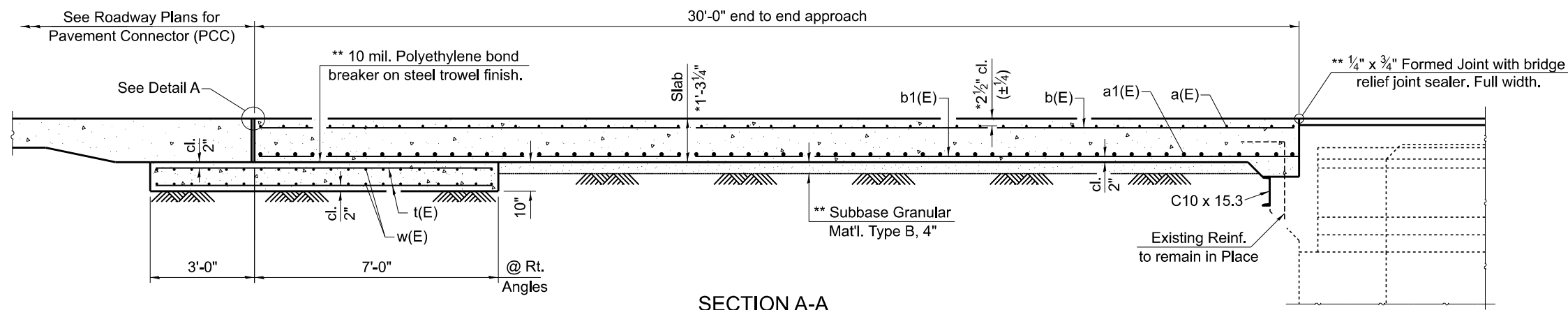

**SECTION A-A**

\* Thickness prior to  $\frac{1}{4}$ " grinding, (Typ.).  
\*\* Cost included with Concrete Superstructure (Approach Slab).

MODEL: D:\info\...  
 FILE NAME: ...  
 PROJECT: ...  
 DATE: ...

USER NAME =	DESIGNED - T. Walk	REVISED -
DRAWN - T. Walk	REVISED -	
PLOT SCALE = 100,000' / in.	CHECKED - D. Macklin	REVISED -
PLOT DATE = 7/8/2024	DATE - August 2023	REVISED -

**STATE OF ILLINOIS**  
**DEPARTMENT OF TRANSPORTATION**

**BRIDGE APPROACH SLAB DETAILS - SHEET 2 OF 2**  
**S.N. 013-0036**

SCALE: SHEET 6 OF 8 SHEETS STA. TO STA.

F.A.P. RTE.	SECTION	COUNTY	TOTAL SHEETS	SHEET NO.
327	D7 BRIDGE REPAIRS 2025-10	CLAY	24	17
CONTRACT NO. 74C59				
ILLINOIS FED. AID PROJECT				

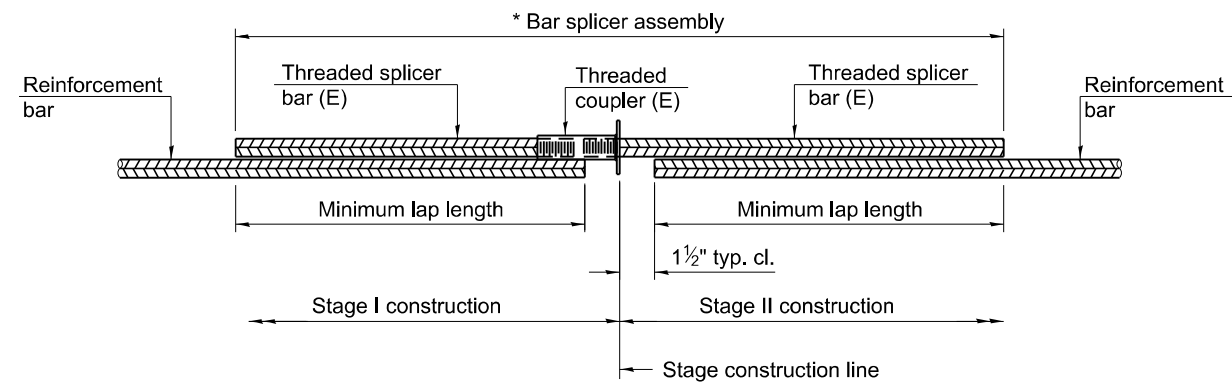

**STANDARD BAR SPLICER ASSEMBLY PLAN**

Only bar splicer assemblies as presented on the approved QPL list may be used.

Threaded splicer bar length = min. lap length + 1 1/2" + thread length

\* Epoxy not required on Bar Splicer Assembly components used in conjunction with black bars.

Location	Bar Size	No. assemblies required	Minimum lap length
Approach	#5	90	3'-0"
Approach	#8	120	4'-9"
Approach Footing	#5	80	3'-4"

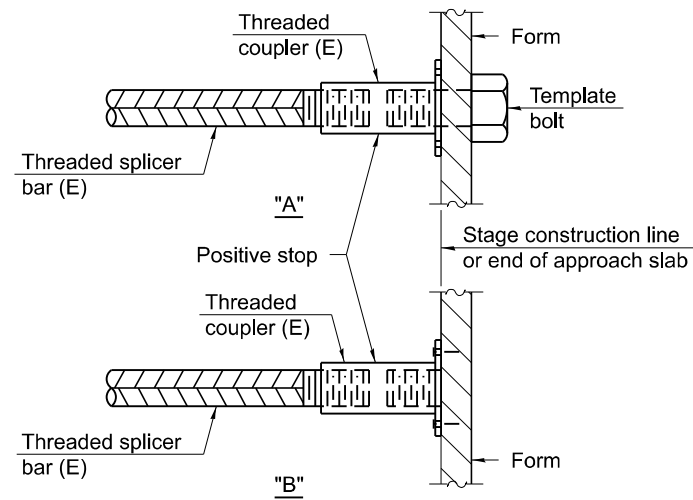

**INSTALLATION AND SETTING METHODS**

"A" : Set bar splicer assembly by means of a template bolt.

"B" : Set bar splicer assembly by nailing to wood forms or cementing to steel forms.

(E) : Indicates epoxy coating.

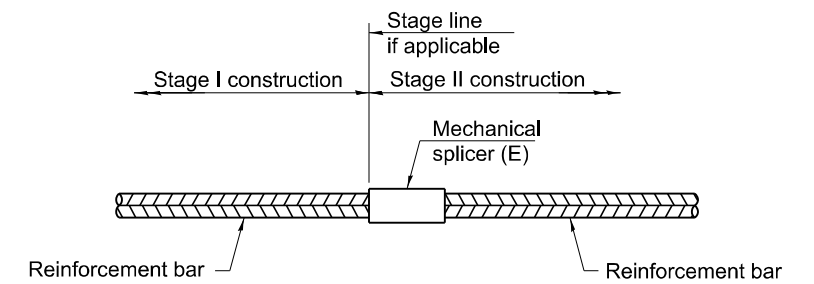

**STANDARD MECHANICAL SPLICER**

Location	Bar Size	No. assemblies required
Approach	#6	78

Notes:  
 Splicer bars shall be deformed with threaded ends and have a minimum 60 ksi yield strength.  
 All reinforcement shall be lapped and tied to the splicer bars.  
 Bar splicer assemblies shall be epoxy coated according to the requirements for reinforcement bars. See Section 508 of the Standard Specifications.  
 See approved list of bar splicer assemblies and mechanical splicers for alternatives.

BSD-1

5-15-2023

STATE OF ILLINOIS  
 DEPARTMENT OF TRANSPORTATION

BAR SPLICER ASSEMBLY AND MECHANICAL SPLICER DETAILS  
 S.N. 013-0036

F.A.P. RTE.	SECTION	COUNTY	TOTAL SHEETS	SHEET NO.
327	D7 BRIDGE REPAIRS 2025-10	CLAY	24	18
CONTRACT NO. 74C59				
ILLINOIS FED. AID PROJECT				

SCALE: SHEET 7 OF 8 SHEETS STA. TO STA.

MODEL: D:\info\...  
 FILE NAME: ...  
 PROJECT: ...  
 DATE: 7/8/2024

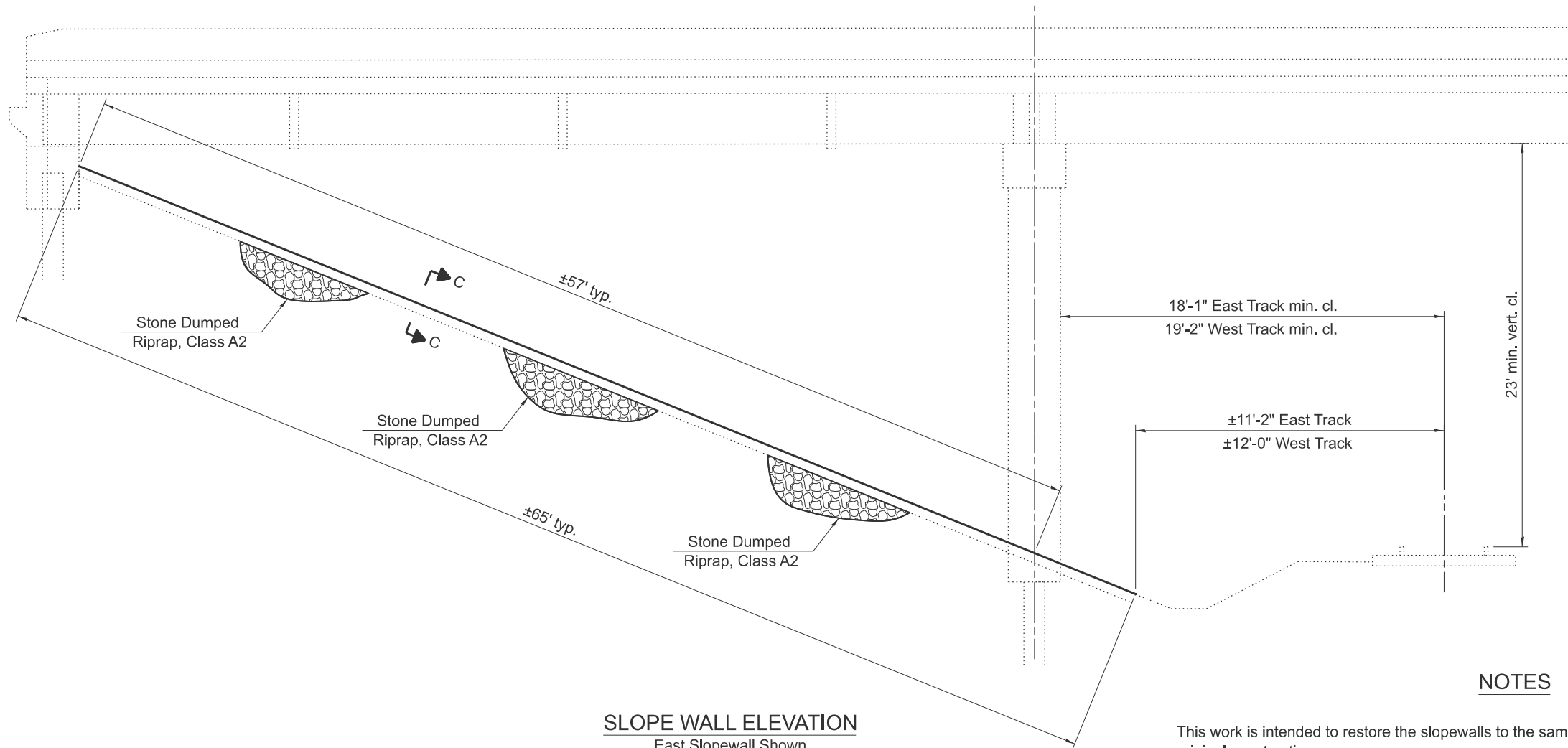

**SLOPE WALL ELEVATION**

East Slopewall Shown  
West Slopewall Similar

**NOTES**

This work is intended to restore the slopewalls to the same shape, dimensions, and surface type as original construction.

SLOPEWALL (SPECIAL) shall include grading and reshaping of existing slopewall aggregate to the satisfaction of the Engineer. Eroded or settled areas in the existing slopewall shall be restored to original slopewall grade. Any additional aggregate required to restore the slopewall shall be paid for as STONE DUMPED RIPRAP, CLASS A2. Any existing vegetation within the limits of the existing slopewall shall be removed, while minimizing disturbance of existing slopewall material.

SLOPEWALL (SPECIAL) shall include application of bituminous material to existing slopewall as specified in the special provisions.

The work shall not change the quantity and/or character of flow in the Railway's ditches and/or drainage structures. The railway ditches shall be maintained at the same slope and grade as existing conditions.

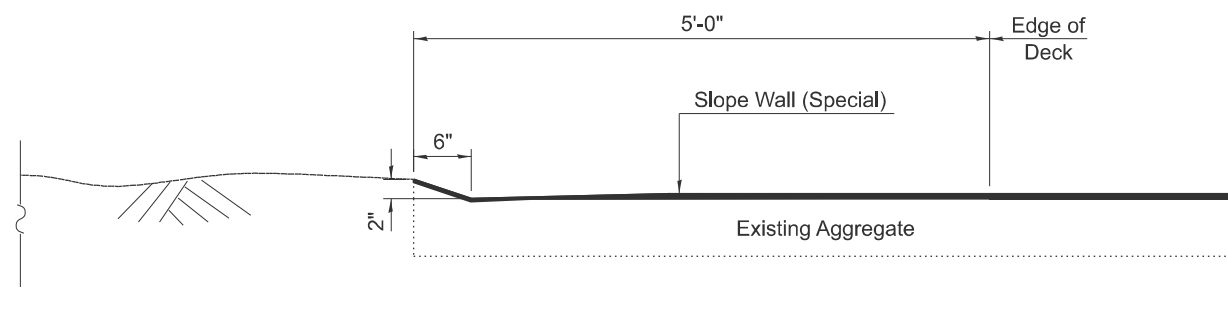

**SECTION C-C**

**BILL OF MATERIAL**

Item	Unit	Total
Slopewall (Special)	Sq. Yd.	768
Stone Dumped Riprap, Class A2	Ton	50

MODEL: D:\info\...  
 FILE NAME: ...  
 PROJECT: ...  
 DRAWING: ...  
 DATE: ...

USER NAME = jessica.nille	DESIGNED - T. Walk	REVISED -
	DRAWN - T. Walk	REVISED -
PLOT SCALE = \$SCALE\$	CHECKED - D. Macklin	REVISED -
PLOT DATE = 7/5/2024	DATE - August 2023	REVISED -

**STATE OF ILLINOIS  
DEPARTMENT OF TRANSPORTATION**

**SLOPEWALL REPAIR  
S.N. 013-0036**

SCALE: SHEET 8 OF 8 SHEETS STA. TO STA.

F.A.P. RTE.	SECTION	COUNTY	TOTAL SHEETS	SHEET NO.
327	D7 BRIDGE REPAIRS 2025-10	CLAY	24	19
CONTRACT NO. 74C59				
		ILLINOIS	FED. AID PROJECT	

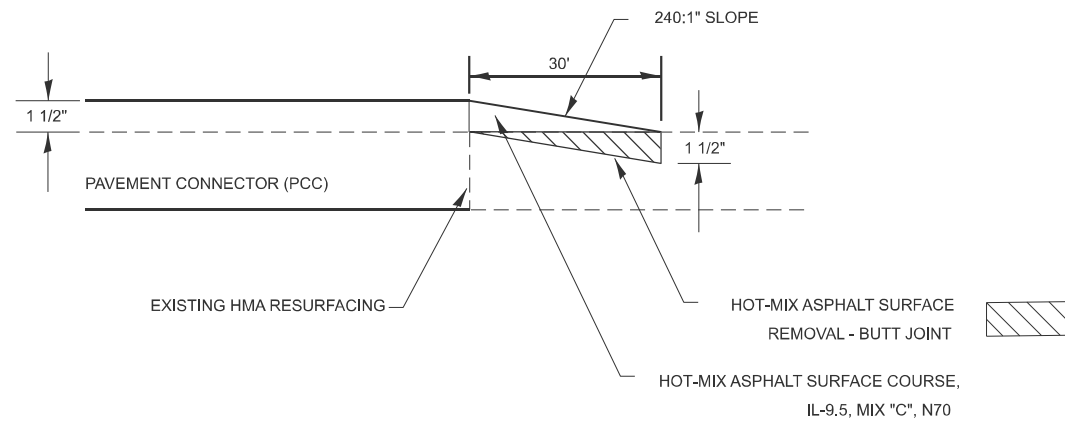

**BUTT JOINT DETAIL**

STA 571+68.55 TO 571+98.55  
 STA 574+90.45 TO 575+20.45

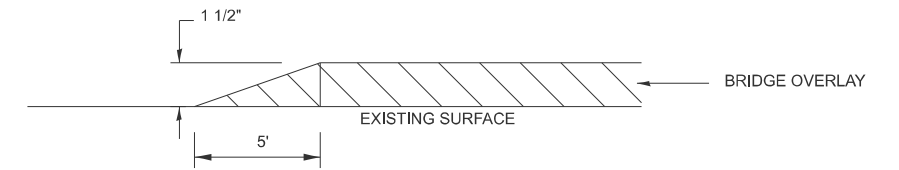

**TEMPORARY RAMP**

STA 571+93.55 TO 571+98.55  
 STA 574+90.45 TO 574+95.55

MODEL: Default  
 FILE NAME: c:\p\work\pww\chillico\ad0907245\D774C59-shi-details.dgn

USER NAME = Stacy.Anderson	DESIGNED -	REVISED -
	DRAWN -	REVISED -
	CHECKED -	REVISED -
PLOT DATE = 7/3/2024	DATE -	REVISED -

**STATE OF ILLINOIS  
 DEPARTMENT OF TRANSPORTATION**

**TRANSITION DETAILS**

SCALE: SHEET OF SHEETS STA. TO STA.

F.A.P. RTE.	SECTION	COUNTY	TOTAL SHEETS	SHEET NO.
327	D7 BRIDGE REPAIRS 2025-10	CLAY	24	20
CONTRACT NO. 74C59				
ILLINOIS			FED. AID PROJECT	

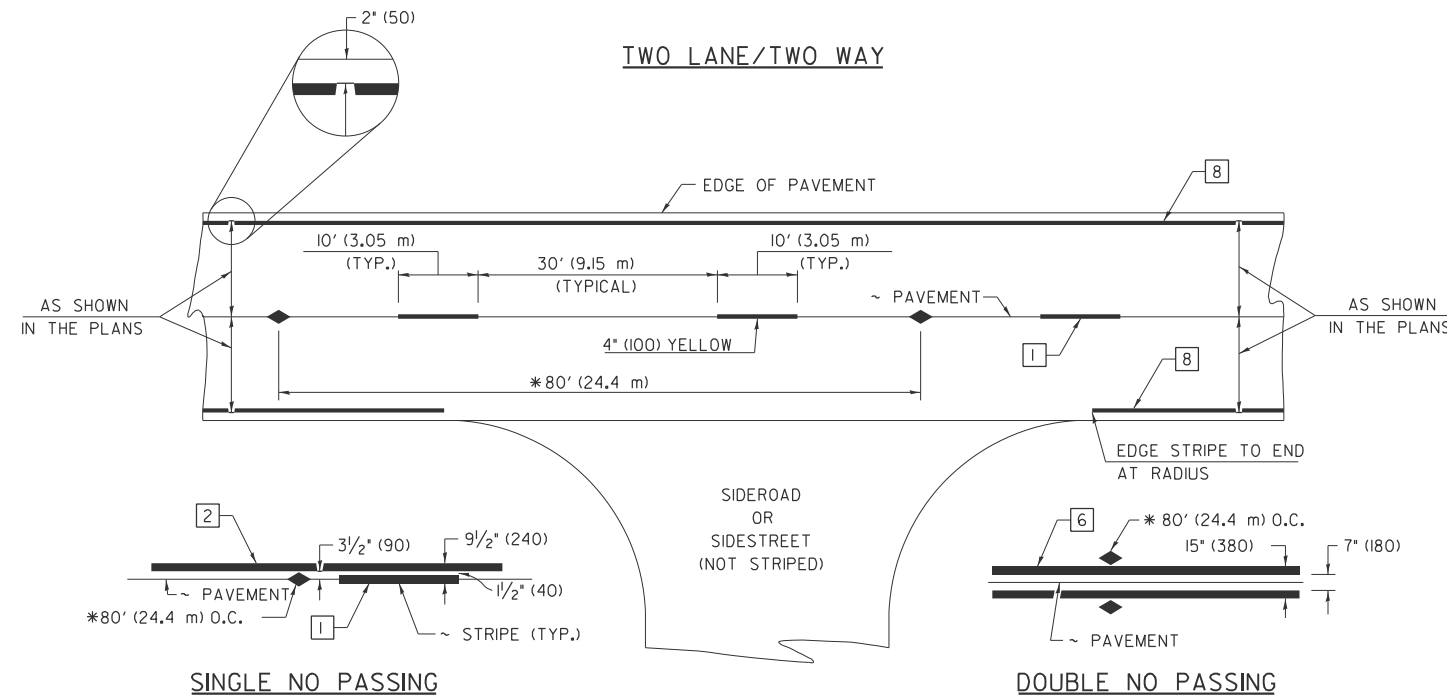

\* REDUCE TO 40' (12.2 m) O.C. ON CURVES WITH POSTED OR ADVISORY SPEEDS OF 45 mph (70 km/h) OR LESS.

**PAVEMENT MARKING LEGEND**

- 1 4" (100) SKIP-DASH (YELLOW)
- 2 4" (100) SOLID (YELLOW)
- 3 12" (300) DIAGONAL (YELLOW)
- 4 4" (100) DOUBLE YELLOW (NARROW)
- 5 12" (300) SOLID WHITE
- 6 4" (100) DOUBLE YELLOW (WIDE)
- 7 6" (150) SKIP-DASH (WHITE)
- 8 4" (100) SOLID (WHITE)
- 9 12" (300) DIAGONAL (WHITE)
- 10 6" (150) SOLID (WHITE)
- 11 24" (600) STOP BAR (WHITE)
- 12 8" (200) SOLID (WHITE)
- 13 4" (100) PARKING WHITE

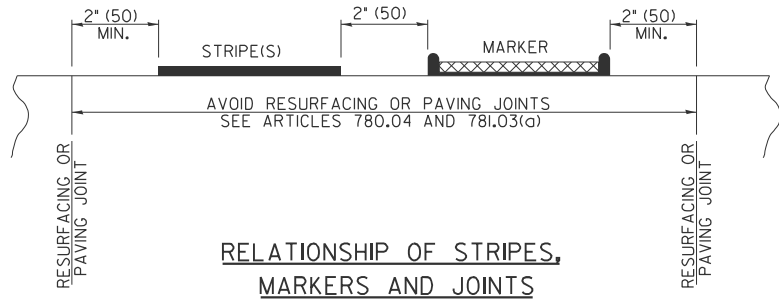
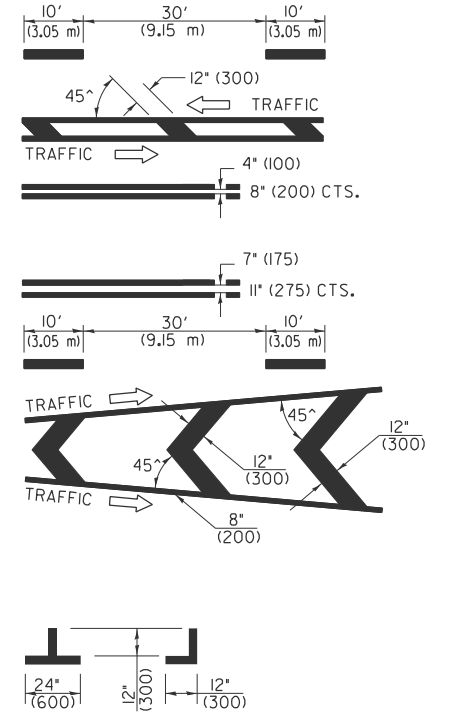

**TYPICAL PAVEMENT MARKERS LEGEND**

- ◆ TWO-WAY AMBER MARKER
- ▶ ONE-WAY AMBER MARKER
- ▷ ONE-WAY CRYSTAL MARKER

**RAISED REFLECTIVE PAVEMENT MARKERS**

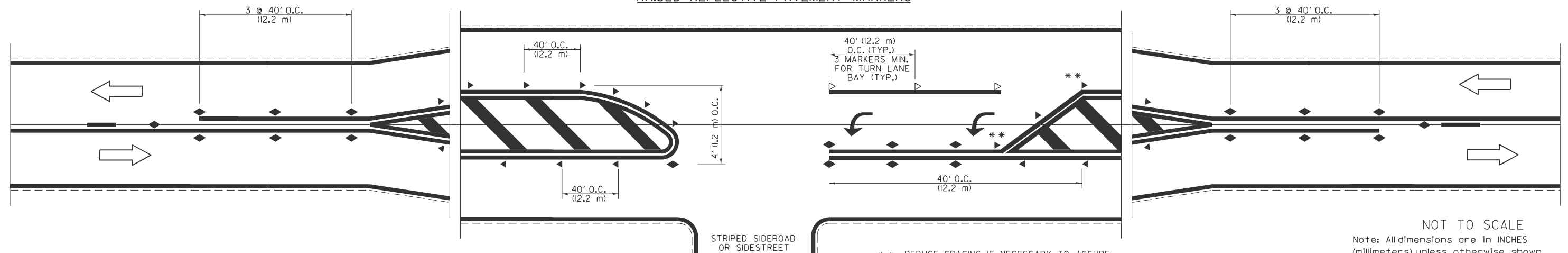

\*\* REDUCE SPACING IF NECESSARY TO ASSURE MARKERS AT CORNER POINTS.

NOT TO SCALE  
Note: All dimensions are in INCHES (millimeters) unless otherwise shown.

**DISTRICT 7 DETAIL NO. 78000001**

FILE NAME =	USER NAME = jessica.hille	DESIGNED -	REVISED - NAS 06/22
pw:/ildot-pw/bentley.com/PWIDOT/Documents/IDOT Offices/District 7/ORD Projects/D774C59/Drawings/CAOSheets/D774C59-sht-detail.dwg		CHECKED -	REVISED -
		DATE -	REVISED -

**STATE OF ILLINOIS  
DEPARTMENT OF TRANSPORTATION**

**PAVEMENT MARKING AND RAISED REFLECTIVE PAVEMENT MARKERS  
(RURAL & URBAN APPLICATIONS)**

SCALE: SHEET NO. 1 OF 4 SHEETS STA. TO STA.

F.A. RTE.	SECTION	COUNTY	TOTAL SHEETS	SHEET NO.
327	D7 BRIDGE REPAIRS 2025-10	CLAY	24	21
CONTRACT NO. 74C59			ILLINOIS FED. AID PROJECT	

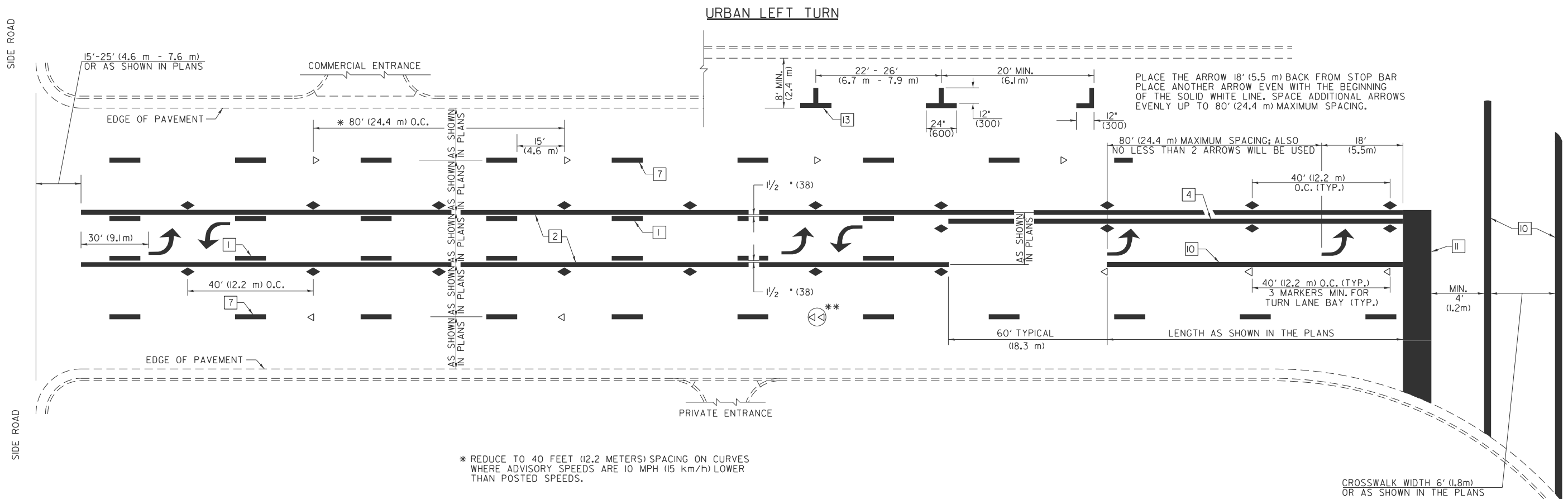

PLACE THE ARROW 18' (5.5 m) BACK FROM STOP BAR  
 PLACE ANOTHER ARROW EVEN WITH THE BEGINNING  
 OF THE SOLID WHITE LINE. SPACE ADDITIONAL ARROWS  
 EVENLY UP TO 80' (24.4 m) MAXIMUM SPACING.

\* REDUCE TO 40 FEET (12.2 METERS) SPACING ON CURVES  
 WHERE ADVISORY SPEEDS ARE 10 MPH (15 km/h) LOWER  
 THAN POSTED SPEEDS.

\*\* DOUBLE LANE LINE MARKERS SHALL BE SPECIFIED  
 AND SPACED AS SHOWN IN HIGHWAY STANDARD  
 781001 FOR MULTI-LANE DIVIDED AND UNDIVIDED  
 HIGHWAYS.

**PAVEMENT MARKING LEGEND**

- 1 4" (100) SKIP-DASH (YELLOW)
- 2 4" (100) SOLID (YELLOW)
- 3 12" (300) DIAGONAL (YELLOW)
- 4 4" (100) DOUBLE YELLOW (NARROW)
- 5 12" (300) SOLID WHITE
- 6 4" (100) DOUBLE YELLOW (WIDE)
- 7 6" (150) SKIP-DASH (WHITE)
- 8 4" (100) SOLID (WHITE)
- 9 12" (300) DIAGONAL (WHITE)
- 10 6" (150) SOLID (WHITE)
- 11 24" (600) STOP BAR (WHITE)
- 12 8" (200) SOLID (WHITE)
- 13 4" (100) PARKING WHITE

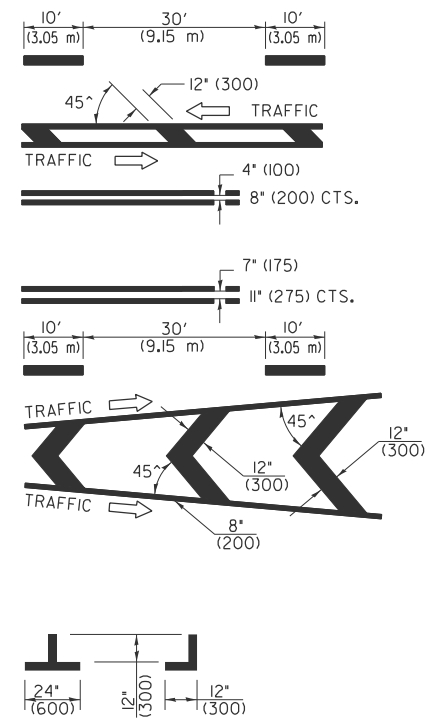

**GENERAL NOTES**

1. TURN ARROW PAIRS SHALL BE PLACED AT 250' (75 m) INTERVALS AND SHALL BE EVENLY SPACED BETWEEN BOTH ENDS OF THE BIDIRECTIONAL LEFT TURN LANE. USE A MINIMUM OF TWO PAIRS PER BLOCK.
2. THE SOLID YELLOW PAVEMENT MARKINGS 2 SHOULD GENERALLY START OR END NEAR THE RADIUS POINT OF EACH STREET RETURN EXCEPT WHERE ONE OR BOTH ENDS WOULD INCLUDE STOP BARS.
3. THE SKIP-DASH PAVEMENT MARKINGS 1 OR 7 SHOULD BE CENTERED BETWEEN BOTH ENDS OF EACH CITY BLOCK AND SHALL BE PLACED SO THEY LINE UP ACROSS FROM EACH OTHER.
4. USE LARGE ARROW SIZE FOR BOTH RURAL AND URBAN LOCATIONS. (SEE SECTION 780 FOR SYMBOLS TABLE)
5. LANE LINE EXTENSIONS SHALL BE THE SAME COLOR AND WIDTH AS THE LANE LINE BEING EXTENDED.
6. ALL WHITE SKIP-DASH LINES SHALL BE 6" IN WIDTH.

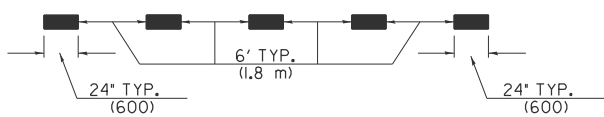

**LANE LINE EXTENSIONS**

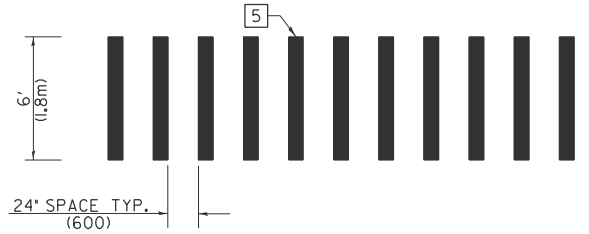

**CROSSWALK DETAIL  
(DECATUR CITY LIMITS ONLY)**

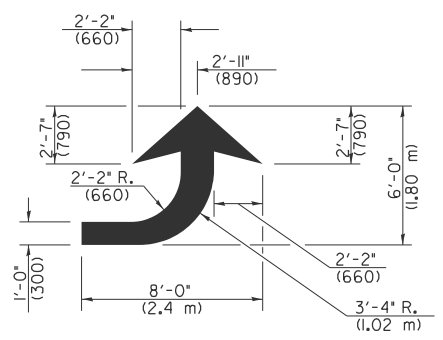

**LEFT ARROW**  
 REVERSE FOR RIGHT ARROW  
 AREA = 15.6 SQ. FT. (1.47 m<sup>2</sup>)  
 (WHITE)

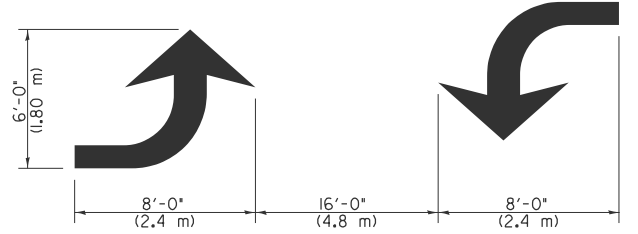

**TYPICAL DOUBLE  
TURN ARROWS (WHITE)**

NOT TO SCALE

Note: All dimensions are in INCHES (millimeters) unless otherwise shown.

**DISTRICT 7 DETAIL NO. 7800001**

FILE NAME =	USER NAME = jessica.hille	DESIGNED -	REVISED - NAS 06/22	<b>STATE OF ILLINOIS DEPARTMENT OF TRANSPORTATION</b>	<b>PAVEMENT MARKING AND RAISED REFLECTIVE PAVEMENT MARKERS (RURAL &amp; URBAN APPLICATIONS)</b>	F.A. RTE.	SECTION	COUNTY	TOTAL SHEETS	SHEET NO.	
pw:/ildot-pw.bentley.com/PWIDOT/Documents/IDOT Offices/District 7/ORD Projects/D77455/Drawings/CAOSheets/D774C59-sht-detail	PLANNED BY	CHECKED -	REVISED -			327	D7 BRIDGE REPAIRS 2025-10	CLAY	24	22	
	PLOT SCALE = *SCALE*	DATE -	REVISED -			CONTRACT NO. 74C59					
	PLOT DATE = 7/5/2024					ILLINOIS FED. AID PROJECT					
					SCALE:	SHEET NO. 2 OF 4 SHEETS		STA. TO STA.			

**ISLANDS**

**OPTION 1**

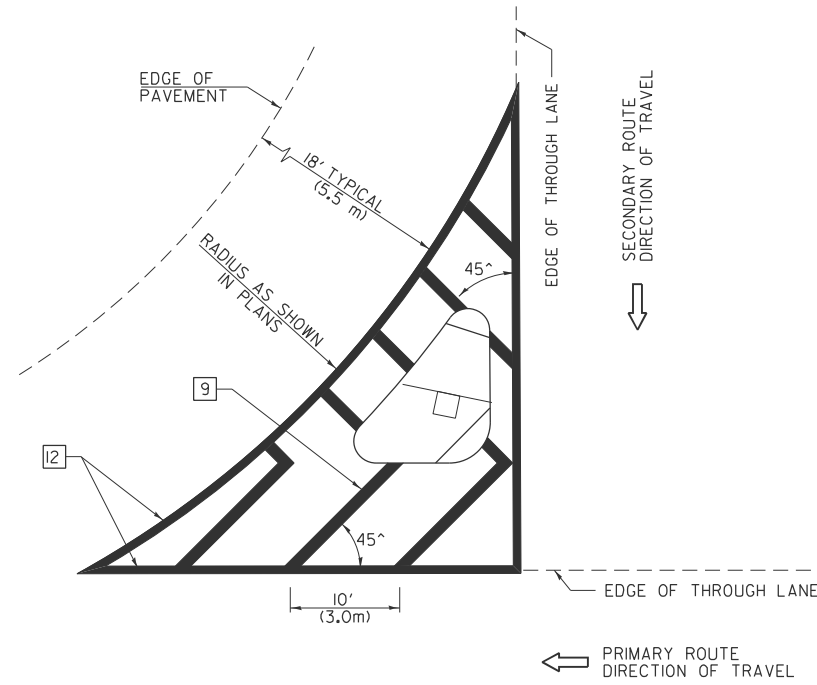

**GENERAL NOTES**

1. RAISED AND CORRUGATED MEDIANS SHALL BE OUTLINED WITH [2].
2. SOME OF THE INFORMATION INCLUDED WITH THIS DETAIL MAY NOT BE APPLICABLE TO THIS IMPROVEMENT.
3. PAVEMENT MARKINGS ARE TO BE EXTENDED THROUGH OMISSIONS WHEN APPLICABLE.
4. FINAL PAVEMENT MARKINGS SHALL BE IN PLACE PRIOR TO PLACING ANY RAISED REFLECTIVE PAVEMENT MARKERS.
5. THE FOLLOWING CRITERIA SHALL BE USED FOR SELECTING THE DIAGONAL PAVEMENT MARKING SPACING:
 

<30 MPH (<50 km/h)	15' (4.5 m)
30-45 MPH (50-75 km/h)	20' (6.0 m)
>45 MPH (>75 km/h)	30' (9.0 m)
6. THE USE OF ISLAND STRIPING OPTION 1 OR OPTION 2 SHALL BE AS SHOWN ON THE PLANS.

**PAVEMENT MARKING LEGEND**

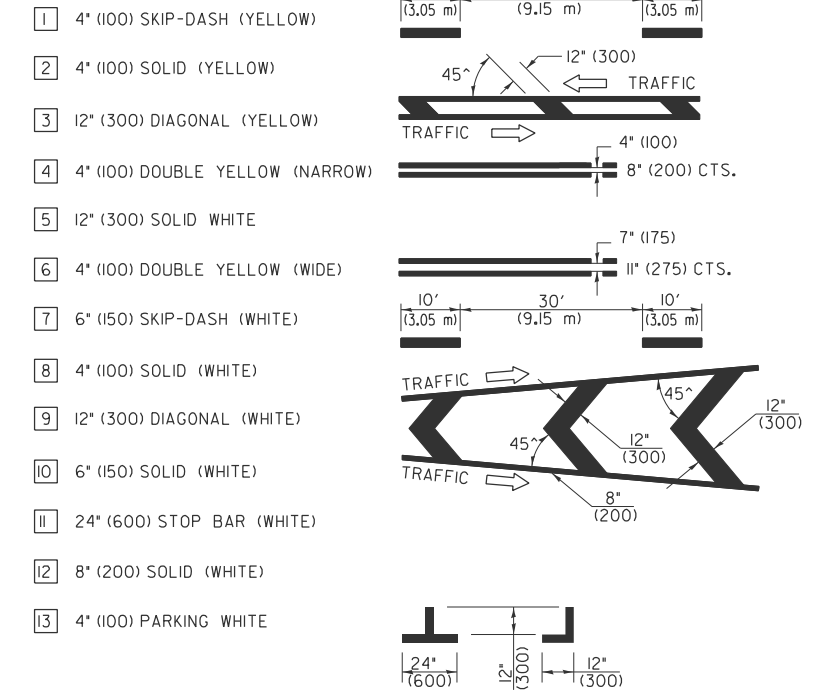

**OPTION 2**

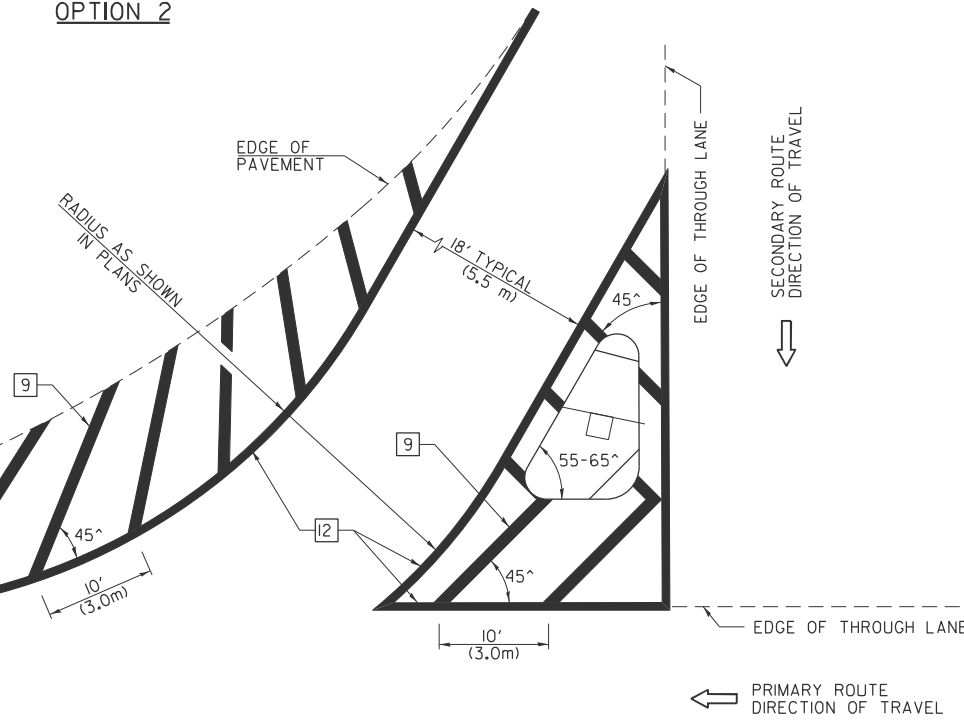

**RURAL LEFT TURN STRIPING**

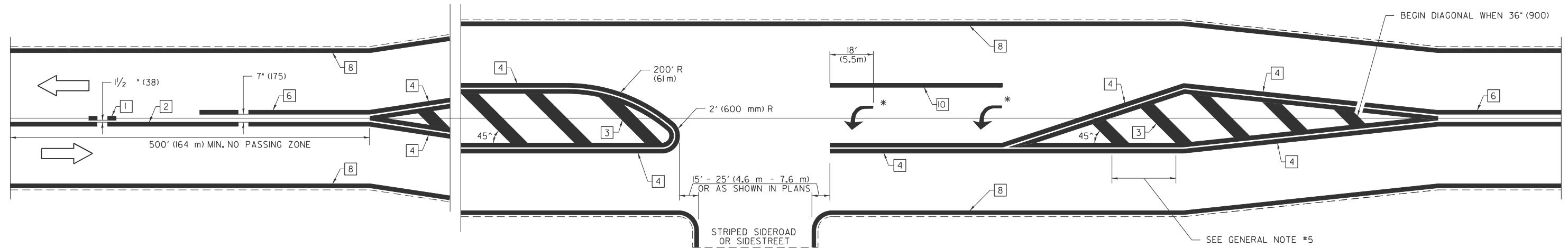

\* PLACE AN ARROW 18' (5.5 m) BACK FROM END OF THE SOLID WHITE LINE. PLACE ANOTHER ARROW EVEN WITH THE BEGINNING OF THE SOLID WHITE LINE. SPACE ADDITIONAL ARROWS EVENLY UP TO 80' (24.4 m) MAXIMUM SPACING. USE MINIMUM OF 2 ARROWS.

NOT TO SCALE  
Note: All dimensions are in INCHES (millimeters) unless otherwise shown.

**DISTRICT 7 DETAIL NO. 78000001**

FILE NAME =	USER NAME = jessica.hille	DESIGNED -	REVISED - NAS 06/22
pw:/ildot-pw.bentley.com/PWIDOT/Documents/IDOT Offices/District 7/ORD Projects/D774C59/Drawings/CAOSheets/D774C59-sht-detail.dwg		CHECKED -	REVISED -
		DATE -	REVISED -

**STATE OF ILLINOIS  
DEPARTMENT OF TRANSPORTATION**

**PAVEMENT MARKING AND RAISED REFLECTIVE PAVEMENT MARKERS  
(RURAL & URBAN APPLICATIONS)**

SCALE: SHEET NO. 3 OF 4 SHEETS STA. TO STA.

F.A. RTE.	SECTION	COUNTY	TOTAL SHEETS	SHEET NO.
327	D7 BRIDGE REPAIRS 2025-10	CLAY	24	23
CONTRACT NO. 74C59			ILLINOIS FED. AID PROJECT	

# SUPPLEMENTAL PAVEMENT MARKING TREATMENT FOR RAILROAD-HIGHWAY GRADE CROSSING

## PAVEMENT MARKING LEGEND

### PAVEMENT MARKINGS AT RAILROAD-HIGHWAY GRADE CROSSING

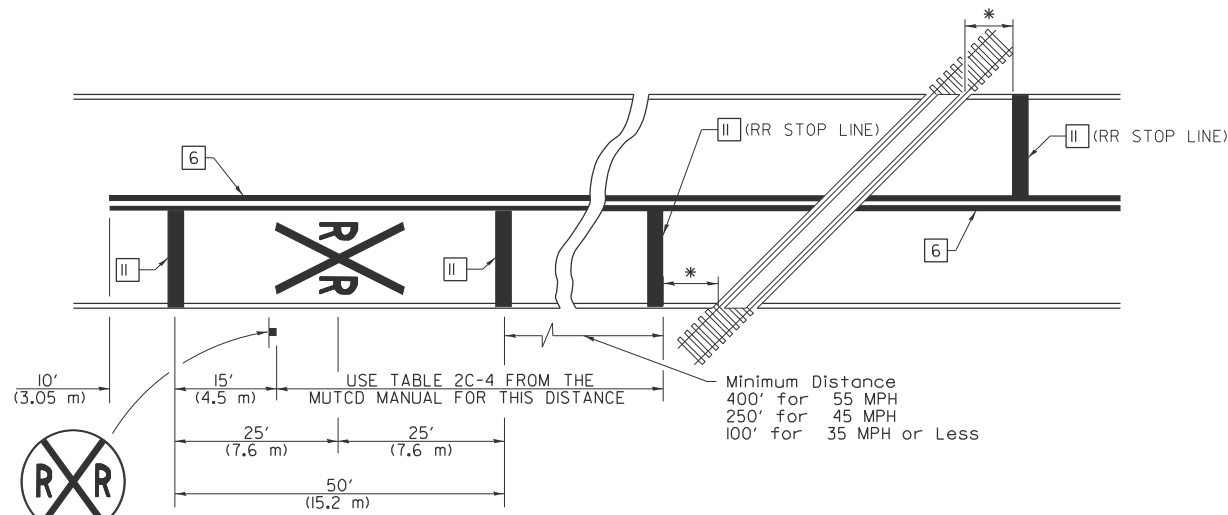

### RAILROAD CROSSING WITH NON-SIGNALIZED INTERSECTION

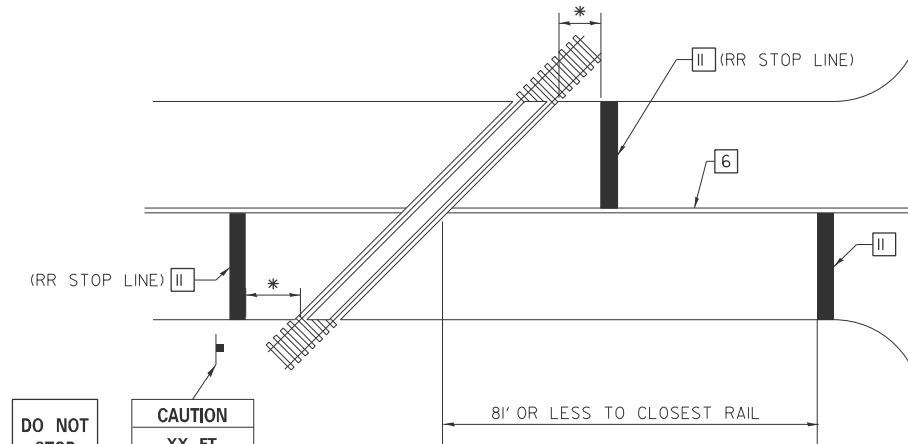

### RAILROAD CROSSING WITH INTERCONNECT AND PRE-SIGNALS

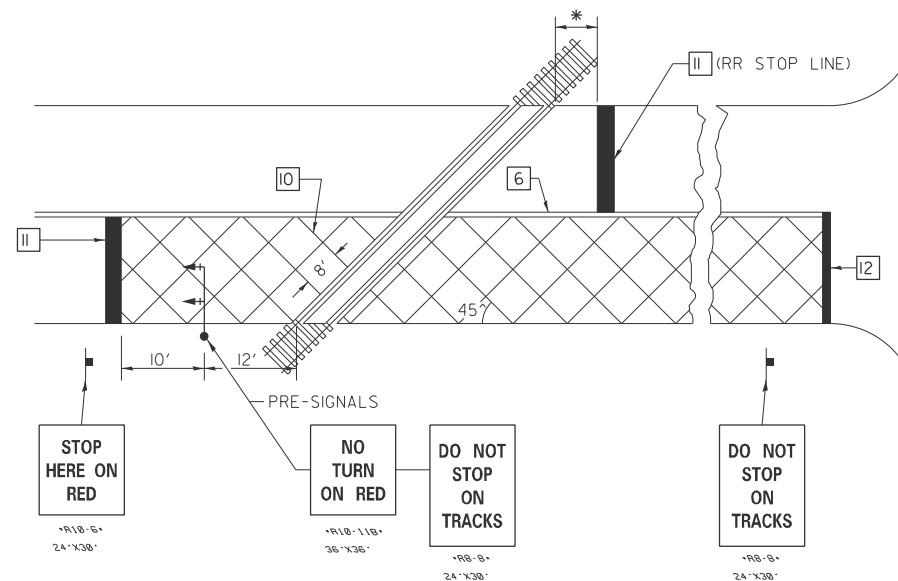

### RAILROAD CROSSING WITH INTERCONNECT ONLY

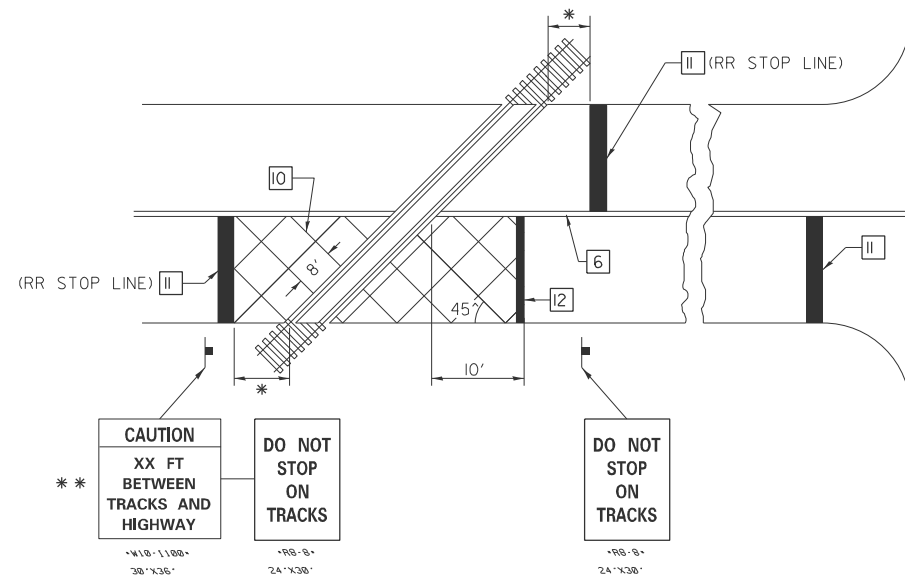

### NOTES

THE TRAVERSE SPREAD OF THE "X" MAY VARY ACCORDING TO LANE WIDTH.

ON MULTI-LANE ROADS, THE STOP LINES SHALL EXTEND ACROSS ALL APPROACH LANES AND SEPARATE RRR SYMBOLS SHALL BE PLACED ADJACENT TO EACH OTHER IN EACH LANE.

WHEN THE PAVEMENT MARKING SYMBOL IS USED, A PORTION OF THE SYMBOL SHOULD BE LOCATED DIRECTLY ADJACENT TO THE ADVANCE WARNING SIGN (W10-1) AS PLACED BY TABLE II-1, CONDITION B OF THE MUTCD.

- 1 4" (100) SKIP-DASH (YELLOW)
- 2 4" (100) SOLID (YELLOW)
- 3 12" (300) DIAGONAL (YELLOW)
- 4 4" (100) DOUBLE YELLOW (NARROW)
- 5 12" (300) SOLID WHITE
- 6 4" (100) DOUBLE YELLOW (WIDE)
- 7 6" (150) SKIP-DASH (WHITE)
- 8 4" (100) SOLID (WHITE)
- 9 12" (300) DIAGONAL (WHITE)
- 10 6" (150) SOLID (WHITE)
- 11 24" (600) STOP BAR (WHITE)
- 12 8" (200) SOLID (WHITE)
- 13 4" (100) PARKING WHITE

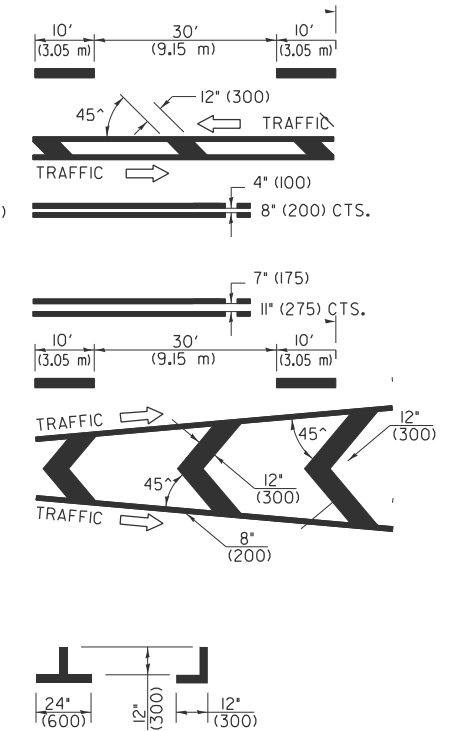

### GENERAL NOTES

1. SUPPLEMENTAL PAVEMENT MARKINGS TO BE INSTALLED ONLY ON APPROACHES TO INTERSECTIONS CONTROLLED BY TRAFFIC SIGNALS WHICH ARE INTERCONNECTED WITH THE RAILROAD WARNING SIGNALS.
2. EXTEND PAVEMENT MARKINGS TO THE INTERSECTION ONLY WHERE PRE-SIGNALS ARE USED.
3. WHEN PEDESTRIAN SIGNALS ARE PRESENT WITH INTERCONNECTED SIGNALS, WARNING SIGN W10-1101 (18"x24") SHALL BE PLACED NEAR EACH PEDESTRIAN SIGNAL HEAD. COUNTDOWN PEDESTRIAN SIGNAL HEADS SHALL NOT BE UTILIZED ALONG WITH INTERCONNECTED SIGNALS.
4. PLEASE REFER TO THE IDOT BUREAU OF OPERATION MEMO OPS T-06 DATED DECEMBER 1, 2020 FOR ADDITIONAL INFORMATION

**CAUTION**  
WALK TIME SHORTENED WHEN TRAIN APPROACHES

\* 15' FROM NEAR RAIL OR 8' FROM AND PARALLEL TO GATE IF PRESENT

\*\* WARNING SIGN W10-1100 SHALL BE USED AS AN INTERIM MEASURE AT INTERCONNECTED SIGNAL LOCATIONS WHERE PRE-SIGNALS ARE TO BE INSTALLED IN THE FUTURE. THIS SIGN SHALL BE REMOVED WHEN THE PRE-SIGNALS ARE INSTALLED AND THE PAVEMENT MARKINGS ARE EXTENDED TO THE INTERSECTION.

NOT TO SCALE

Note: All dimensions are in INCHES (millimeters) unless otherwise shown.

### DISTRICT 7 DETAIL NO. 78000001

FILE NAME =	USER NAME = jessica.hille	DESIGNED -	REVISED - NAS 06/22
pw:/idot-pw/bentley.com/PWIDOT/Documents/IDOT Offices/District 7/ORD Projects/D77455/Drawings/CAOSheets/D774C59-sht-detail		CHECKED -	REVISED -
		DATE -	REVISED -

STATE OF ILLINOIS  
DEPARTMENT OF TRANSPORTATION

PAVEMENT MARKING AND RAISED REFLECTIVE PAVEMENT MARKERS  
(RURAL & URBAN APPLICATIONS)

SCALE: SHEET NO. 4 OF 4 SHEETS STA. TO STA.

F.A. RTE.	SECTION	COUNTY	TOTAL SHEETS	SHEET NO.
327	D7 BRIDGE REPAIRS 2025-10	CLAY	24	24
CONTRACT NO. 74C59				
ILLINOIS FED. AID PROJECT				