

EXISTING CONTROLLER SEQUENCE

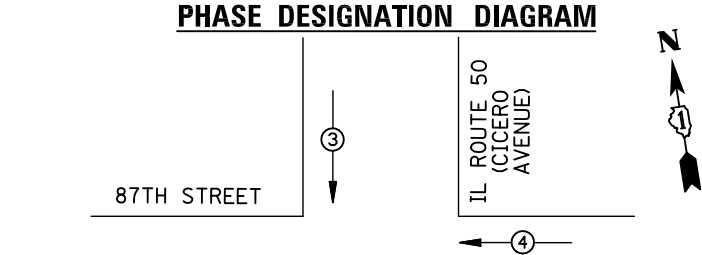
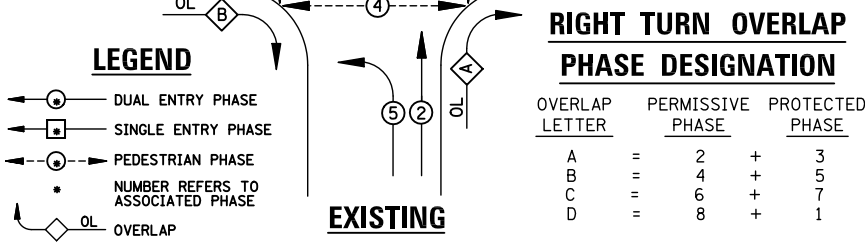
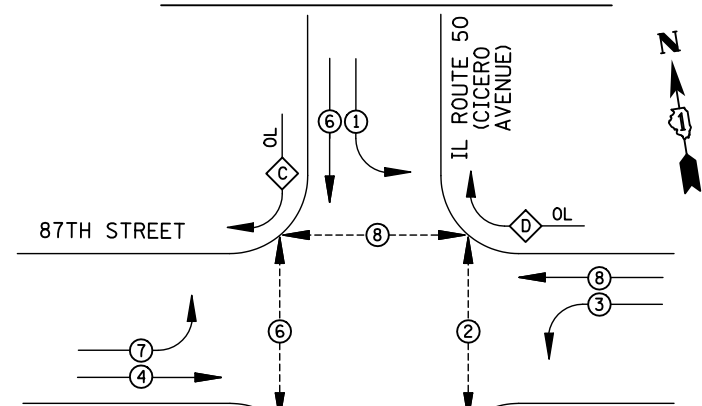

EMERGENCY VEHICLE PREEMPTORS

EMERGENCY VEHICLE PREEMPTOR	3	4
MOVEMENT	↑	→

EXISTING EMERGENCY VEHICLE PREEMPTION SEQUENCE

I.D.O.T TRAFFIC SIGNAL INSTALLATION ELECTRICAL SERVICE REQUIREMENTS

TYPE	NO. LAMPS	WATTAGE INCAND.	WATTAGE LED	%OPERATION	TOTAL WATTAGE
SIGNAL (RED)	20	135	17	0.50	170
(YELLOW)	20	135	25	0.25	125
(GREEN)	20	135	15	0.25	75
ARROW	32	135	12	0.10	38.4
PED. SIGNAL	8	90	25	1.00	200
CONTROLLER	1	100	100	1.00	100
ILLUM. SIGN		84		0.05	
FLASHER		135	25	0.50	

ENERGY COSTS TO: TOTAL = **708.4**

ILLINOIS DEPARTMENT OF TRANSPORTATION
201 WEST CENTER COURT
SCHAUMBURG, IL 60196-1096

ENERGY SUPPLY CONTACT: X
PHONE: X
COMPANY: X

REMOVAL OF EXISTING TRAFFIC SIGNAL EQUIPMENT

THE FOLLOWING ITEMS SHALL BE REMOVED BY THE CONTRACTOR AND SHALL BE DISPOSED OF BY THEM OUTSIDE THE RIGHT-OF-WAY AT THEIR EXPENSE. THE SALVAGE VALUE OF THE REMOVED EQUIPMENT SHALL BE REFLECTED IN THE CONTRACT BID PRICE.

- 3 EACH TRAFFIC SIGNAL POST
- 8 EACH PEDESTRIAN SIGNAL HEAD
- 4 EACH PEDESTRIAN PUSH-BUTTON

- ① REPLACE 14 FT. PAINTED POST, RE-USE EXISTING TYPE A CONCRETE FOUNDATION
- ② REPLACE 15 FT. PAINTED POST, RE-USE EXISTING TYPE A CONCRETE FOUNDATION
- ③ REPLACE 16 FT. PAINTED POST, RE-USE EXISTING TYPE A CONCRETE FOUNDATION
- ④ REPLACE 18 FT. PAINTED POST, RE-USE EXISTING TYPE A CONCRETE FOUNDATION
- ⑤ REPLACE 10 FT. PAINTED POST, RE-USE EXISTING TYPE A CONCRETE FOUNDATION

87TH STREET

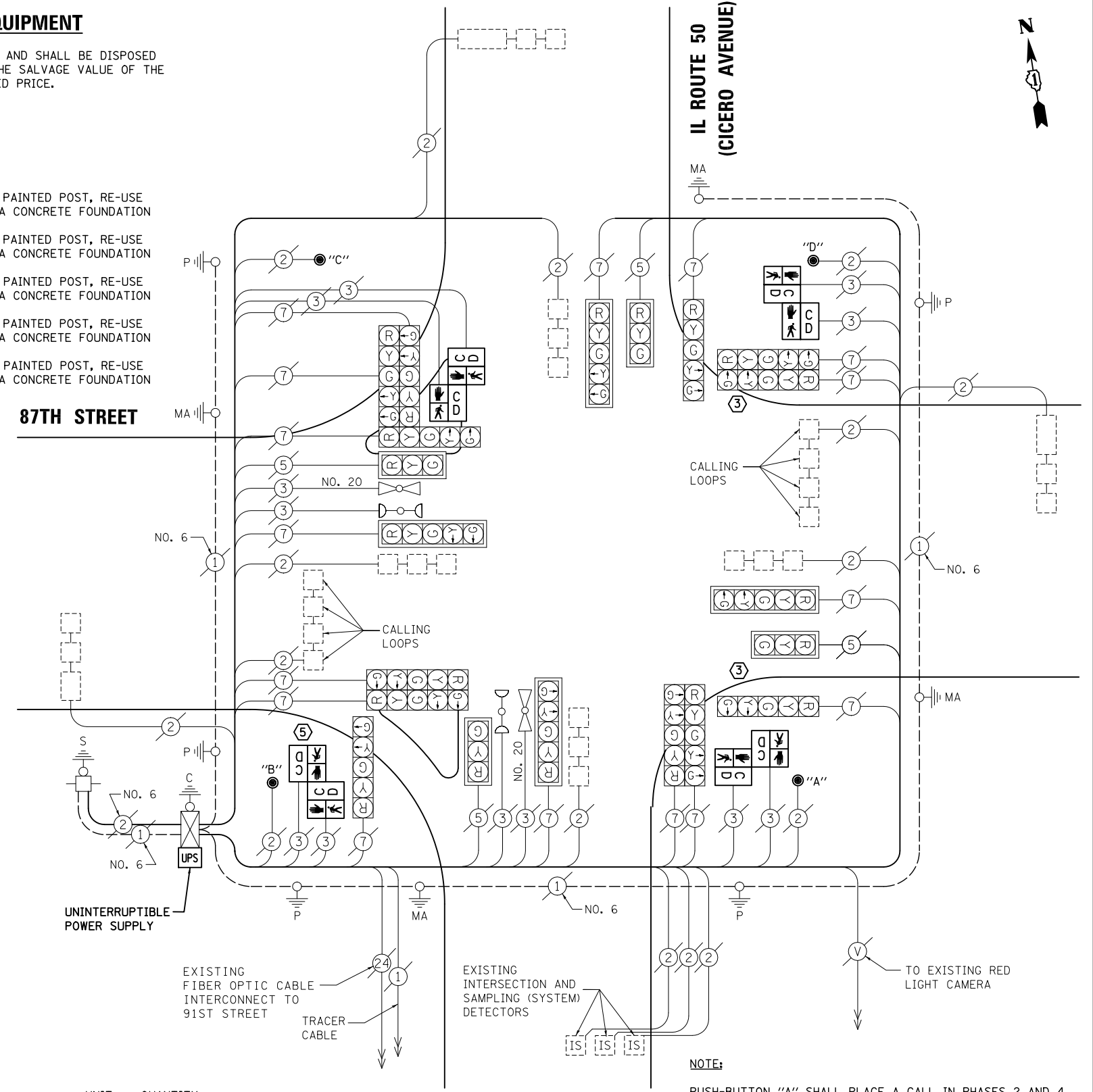

CABLE PLAN

NOTE:
THE TRAFFIC SIGNAL CONTROL EQUIPMENT FOR THIS PROJECT SHALL BE "ECONOLITE" TO MATCH THE EXISTING ADJACENT SYSTEM.

NOTE:
PUSH-BUTTON "A" SHALL PLACE A CALL IN PHASES 2 AND 4.
PUSH-BUTTON "B" SHALL PLACE A CALL IN PHASES 4 AND 6.
PUSH-BUTTON "C" SHALL PLACE A CALL IN PHASES 6 AND 8.
PUSH-BUTTON "D" SHALL PLACE A CALL IN PHASES 2 AND 8.

SCHEDULE OF QUANTITIES

ITEM

MAINTENANCE OF EXISTING TRAFFIC SIGNAL INSTALLATION

TRAFFIC SIGNAL POST, GALVANIZED STEEL 10 FT.

TRAFFIC SIGNAL POST, GALVANIZED STEEL 16 FT.

PEDESTRIAN SIGNAL HEAD, LED, 2-FACE, BRACKET MOUNTED WITH COUNTDOWN TIMER

RELOCATE EXISTING SIGNAL HEAD

MODIFY EXISTING CONTROLLER CABINET

REMOVE EXISTING TRAFFIC SIGNAL EQUIPMENT

UNINTERRUPTIBLE POWER SUPPLY, SPECIAL

PEDESTRIAN PUSH-BUTTON, NON-LATCHING

UNIT	QUANTITY
EACH	1
EACH	1
EACH	2
EACH	4
EACH	4
EACH	1
EACH	1
EACH	1
EACH	4

STATE OF ILLINOIS DEPARTMENT OF TRANSPORTATION

SCHEDULE OF QUANTITIES, CABLE PLAN, PHASE DESIGNATION DIAGRAM AND EMERGENCY VEHICLE PREEMPTION IL ROUTE 50 (CICERO AVENUE) AT 87TH STREET

PREPARED BY:
CEMCON, Ltd.
Consulting Engineers, Land Surveyors & Planners
2280 White Oak Circle, Suite 100
Aurora, Illinois 60504-9675
Ph: 630.862.2100 Fax: 630.862.2199
E-Mail: cadd@cemcon.com Website: www.cemcon.com

F.A.P. RTE.	SECTION	COUNTY	TOTAL SHEETS	SHEET NO.
VAR.	2013-035TS	COOK	93	58

CONTRACT NO. 60W81

FILE NAME = \MICROST\352107\50-2480.DGN

USER NAME = JGC

DESIGNED - BPT

DRAWN - JGC/RDS

PLOT SCALE = NOT TO SCALE

PLOT DATE = X

CHECKED - BPT

DATE - XX-XX-13

REVISED -

REVISED -

REVISED -

REVISED -

TS# 2480
OAK LAWN