

DETECTOR LOOP REQUIREMENTS AND CALCULATIONS
FOR IL 159 & LUDWIG/SALEM DR.

LOOP#	PHASE #	LOOP SIZE (FT. X FT.)	REQUIRED # OF TURNS	CALCULATED INDUCTANCE MICROHENRIES	CALCULATED RESISTANCE OHMS
1. EB CCO A	4	6 X 6	6	334.1	2.2
2. EB CCO B	4	6 X 6	6	338.0	2.3
3. EB CCO C	4	6 X 6	6	340.9	2.3
4. EB LT CD	4	6 X 50-Q	3-6-3	807.3	2.1
5. EB THRU CD	4	6 X 50-Q	3-6-3	800.3	1.9
6. EB RT CD	4	6 X 50-Q	3-6-3	794.4	1.8
7. NB CCO A	6	6 X 6	6	369.9	3.0
8. NB CCO B	6	6 X 6	6	366.4	3.0
9. NB LT CD	1	6 X 50-Q	3-6-3	808.2	2.1
10. WB CCO A	3	6 X 6	3-6-3	900.0	4.2
11. WB CCO B	3	6 X 6	3-6-3	898.0	4.1
12. WB LT CD	3	6 X 50-Q	3-6-3	853.8	3.1
13. WB THRU CD	3	6 X 50-Q	3-6-3	847.2	3.0
14. WB RT CD	3	6 X 50-Q	3-6-3	842.3	2.9
15. SB CCO A	2	6 X 6	7	496.1	3.4
16. SB CCO B	2	6 X 6	7	493.4	3.3
17. SB LT CD	5	6 X 50-Q	3-6-3	817.9	2.3

THE ABOVE VALUES ARE CALCULATED OF COMBINED LOOP AND LEAD-IN INDUCTANCE AND RESISTANCE. ACTUAL MEASURED VALUES SHOULD BE WITHIN +/- 20% OF THESE VALUES.

Q=QUADRAPOLE

⊙ =SEE DETAIL A

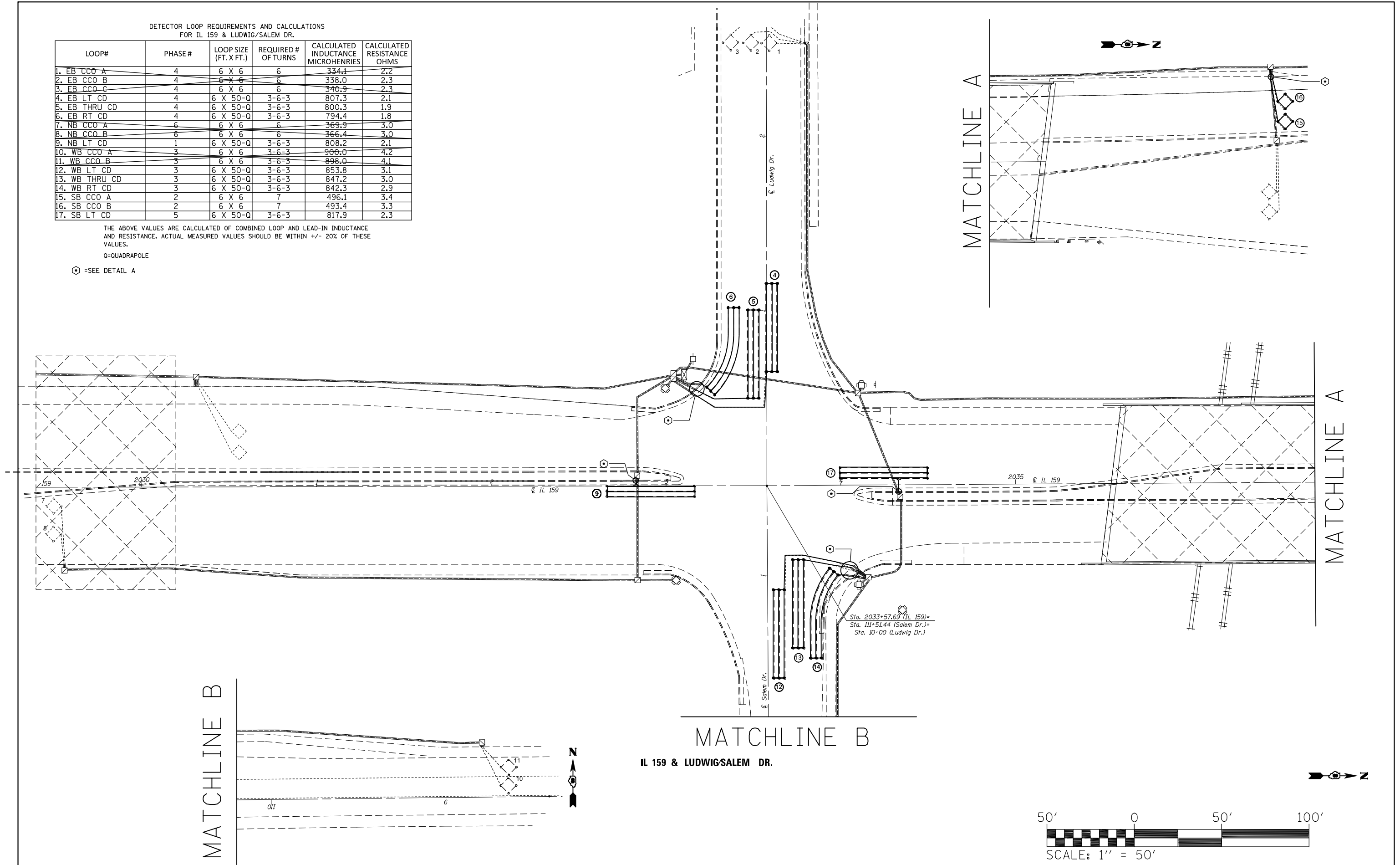

FILE NAME =	USER NAME = prestonme	DESIGNED -	REVISED -
et:\pw\work\pilot\prestonme\d0344817\d876g955-sh1-TS.dgn		DRAWN -	REVISED -
	PLOT SCALE = 50.0000' / in.	CHECKED -	REVISED -
	PLOT DATE = 7/8/2014	DATE -	REVISED -

STATE OF ILLINOIS
DEPARTMENT OF TRANSPORTATION

DETECTOR LOOP REPLACEMENT PLAN
IL 159 & LUDWIG/SALEM DR.

SCALE: SHEET NO. 3 OF 10 SHEETS STA. TO STA.

F.A.P. RTE.	SECTION	COUNTY	TOTAL SHEETS	SHEET NO.
600	(130-1, 130-2)RS-2	ST. CLAIR	36	29**
CONTRACT NO. 76G55				
ILLINOIS FED. AID PROJECT				