

Existing Structure: S.N. 079-0019, originally constructed in 1961 as F.A. Route 182 Sec. 12-D-E-F & P at Station 631+60, using steel beams with 7" concrete deck, nine spans, 1,291'-9" back to back of abutments, 33'-8" out to out width, vaulted abutments on piles and hammerhead piers with footings on piles. Various repairs and maintenance between 1998 and 2011 including elastomeric bearing replacement, deck drains extended and plugged, beam straightening and deck patching.

Structure improvements include deck patching, placing waterproofing and asphalt overlay, replacing expansion joints, installing finger joint retrofit plates and bridge rails.

Road to be closed and traffic detoured during construction.

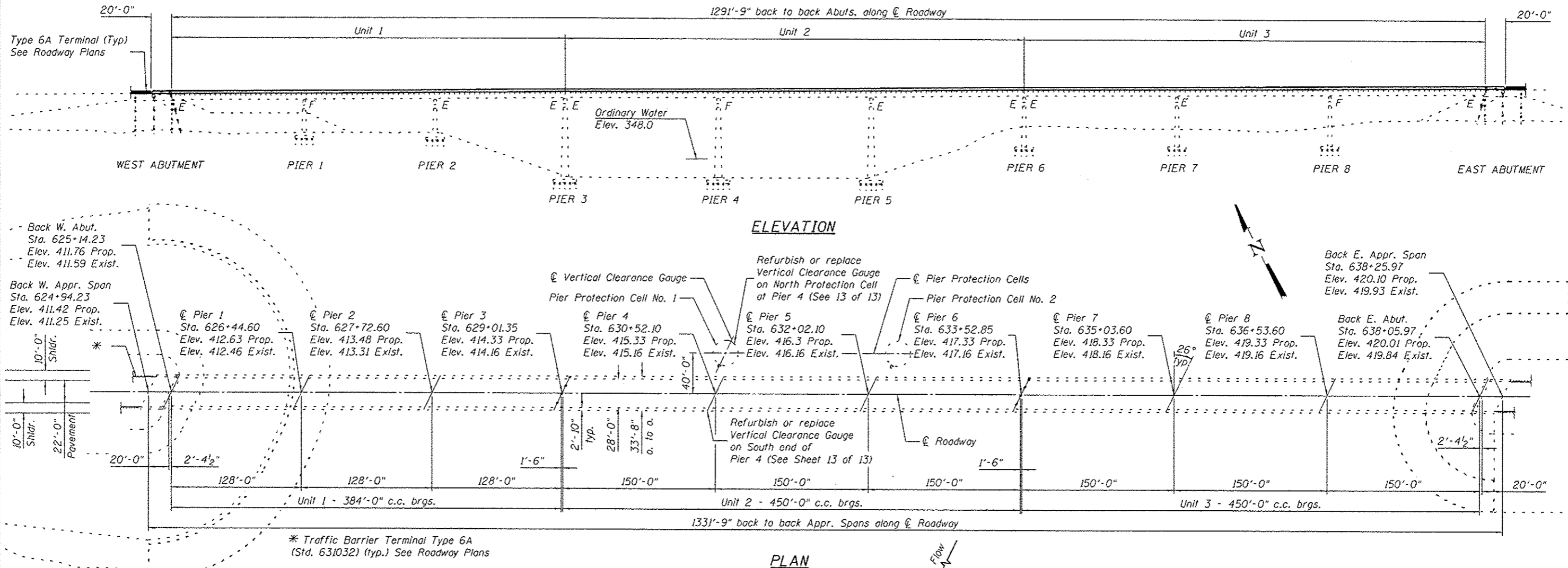

**GENERAL NOTES:**

All structural steel shall conform to AASHTO Classification M-270 Gr. 36, unless otherwise noted.

Prior to pouring the new concrete deck, all heavy or loose rust, loose mill scale, and other loose or potentially detrimental foreign material shall be removed from the surfaces in contact with concrete. Tightly adhered paint may remain unless otherwise noted. Removal shall be accomplished by methods that will not damage the steel and the cost will be included in the pay item covering removal of the existing concrete.

Existing reinforcement bars extending into the removal area shall be cleaned, straightened and incorporated into the new construction. Any reinforcement bars that are damaged during concrete removal shall be replaced with an approved bar splicer or anchorage system. Cost included with Concrete Removal.

The deck surface shall have its final finish lined according to Article 420.09(e)(1) of the Standard Specifications. Cost included with Concrete Superstructures.

The existing structural steel coating contains lead. The Contractor shall take appropriate precautions to deal with the presence of lead on this project.

Reinforcement bars designated (E) shall be epoxy coated.

Plan dimensions and details relative to existing plans are subject to nominal construction variations. The Contractor shall field verify existing dimensions and details affecting new construction and make necessary approved adjustments prior to construction or ordering of materials. Such variations shall not be cause for additional compensation for a change in scope of the work, however, the Contractor will be paid for the quantity actually furnished at the unit price bid for the work.

Joint openings shall be adjusted according to Article 520.04 of the Standard Specifications when joint is poured at a temperature other than 50°F.

**INDEX OF SHEETS**

1. General Plan & Elevation
2. Cross Section
3. Joint Details at Abutments
4. Preformed Joint Strip Seal
5. Finger Plate Details at Pier No. 3 & Pier No. 6
6. Deck Patching Survey Unit 1
7. Deck Patching Survey Unit 1
8. Deck Patching Survey Unit 2
9. Deck Patching Survey Unit 2
10. Deck Patching Survey Unit 3
11. Deck Patching Survey Unit 3
12. Steel Railing Type 2399
13. Vertical Clearance Gauge Details

**PROFILE GRADE**  
(along & roadway)

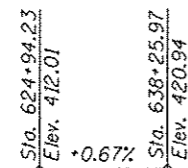

**TOTAL BILL OF MATERIAL**

ITEM	UNIT	TOTAL
Hot-Mix Asphalt Surface Course, Mix "C", N70	Ton	461
Concrete Removal	Cu. Yd.	6.5
Concrete Superstructure	Cu. Yd.	6.9
Reinforcement Bars, Epoxy Coated	Pound	1080
Steel Railing Type 2399	Foot	2,664
Preformed Joint Strip Seal	Foot	78
Finger Plate Expansion Joint, 5"	Foot	62.5
Waterproofing Membrane System	Sq. Yd.	4,116
Vertical Clearance Gage	Each	2
Deck Slab Repair (Full Depth, Type II)	Sq. Yd.	60
Deck Slab Repair (Partial)	Sq. Yd.	896

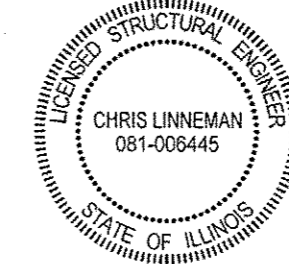

Signed: *[Signature]*  
Date: 5/9/2014  
License Expires: 11/30/2014

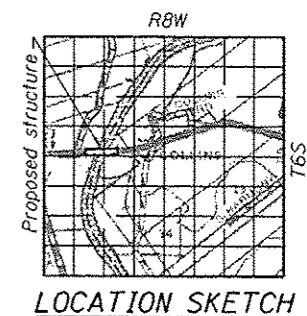

**GENERAL PLAN & ELEVATION**  
**ROOTS ROAD OVER KASKASKIA RIVER**  
**F.A.S. ROUTE 858-SEC. 12VB-II**  
**RANDOLPH COUNTY**  
**STATION 631+60**  
**STRUCTURE NO. 079-0019**

PRINT DATE: 6/26/2014 2:33:45 PM C:\Users\adulimmon\OneDrive\107792019-001-001.dwg

**EFK Moen, LLC**  
Civil Engineering Design  
303 Fontaines Parkway, Suite 240  
Fairview Heights, IL 62708  
Phone 618-206-4250

USER NAME = edi	DESIGNED - CTW	REVISED -
PLLOT SCALE = @2" = 1' / in.	CHECKED - CDL	REVISED -
PLLOT DATE = 6/26/2014	DRAWN - DP	REVISED -
	DATE - 6/26/2014	REVISED -

**STATE OF ILLINOIS**  
**DEPARTMENT OF TRANSPORTATION**

SHEET NO. 1 OF 13 SHEETS

F.A.S. RTE.	SECTION	COUNTY	TOTAL SHEETS	SHEET NO.
858	12VB-II	RANDOLPH	72	34
CONTRACT NO. 76409			ILLINOIS FED. AID PROJECT	