

SEC 22, T20N, R3W, 3RD PM

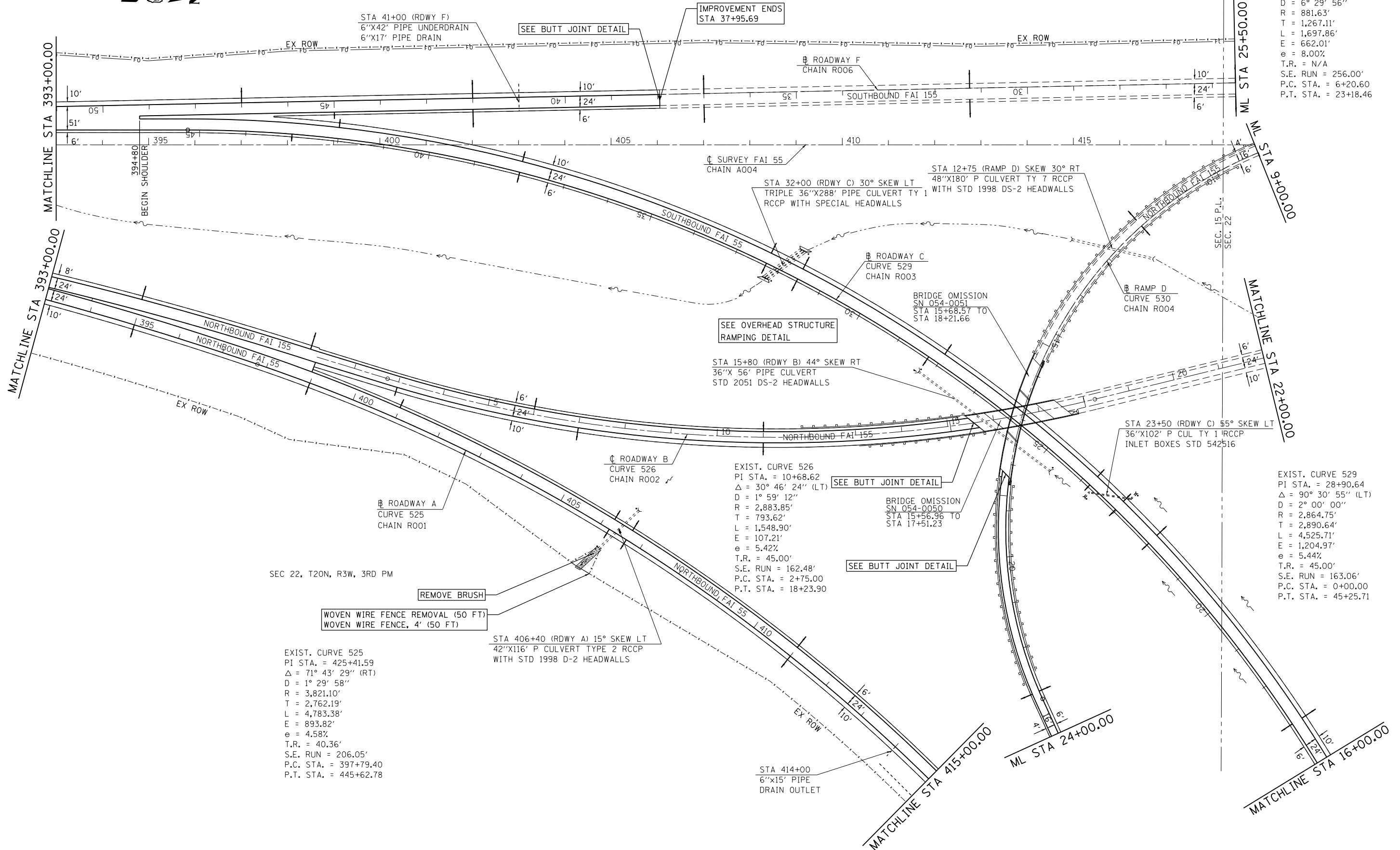

EXIST. CURVE 530
 PI STA. = 18+87.71
 $\Delta = 110^\circ 20' 28''$ (LT)
 $D = 6^\circ 29' 56''$
 $R = 881.63'$
 $T = 1,267.11'$
 $L = 1,697.86'$
 $E = 662.01'$
 $e = 8.00\%$
 $T.R. = N/A$
 $S.E. RUN = 256.00'$
 $P.C. STA. = 6+20.60$
 $P.T. STA. = 23+18.46$

EXIST. CURVE 529
 PI STA. = 28+90.64
 $\Delta = 90^\circ 30' 55''$ (LT)
 $D = 2^\circ 00' 00''$
 $R = 2,864.75'$
 $T = 2,890.64'$
 $L = 4,525.71'$
 $E = 1,204.97'$
 $e = 5.44\%$
 $T.R. = 45.00'$
 $S.E. RUN = 163.06'$
 $P.C. STA. = 0+00.00$
 $P.T. STA. = 45+25.71$

EXIST. CURVE 525
 PI STA. = 425+41.59
 $\Delta = 71^\circ 43' 29''$ (RT)
 $D = 1^\circ 29' 58''$
 $R = 3,821.10'$
 $T = 2,762.19'$
 $L = 4,783.38'$
 $E = 893.82'$
 $e = 4.58\%$
 $T.R. = 40.36'$
 $S.E. RUN = 206.05'$
 $P.C. STA. = 397+79.40$
 $P.T. STA. = 445+62.78$

EXIST. CURVE 526
 PI STA. = 10+68.62
 $\Delta = 30^\circ 46' 24''$ (LT)
 $D = 1^\circ 59' 12''$
 $R = 2,883.85'$
 $T = 793.62'$
 $L = 1,548.90'$
 $E = 107.21'$
 $e = 5.42\%$
 $T.R. = 45.00'$
 $S.E. RUN = 162.48'$
 $P.C. STA. = 2+75.00$
 $P.T. STA. = 18+23.90$

FILE NAME =	USER NAME = sparksgw	DESIGNED -	REVISED -
Default	2041-sht-plan-1.dgn	DRAWN -	REVISED -
	PLOT SCALE = 200.0000' / in.	CHECKED -	REVISED -
	PLOT DATE = Jul-14-2014 03:37:13PM	DATE -	REVISED -

**STATE OF ILLINOIS
 DEPARTMENT OF TRANSPORTATION**

**F.A.I. ROUTE 55
 PLAN SHEET**

SCALE: 1" = 100' SHEET 2 OF SHEETS STA. TO STA.

F.A.I. RTE.	SECTION	COUNTY	TOTAL SHEETS	SHEET NO.
	..	LOGAN	108	53
CONTRACT NO. 72D41			ILLINOIS FED. AID PROJECT	