

**SCHEDULE OF SIGNS**

SIGN NUMBER	SIGN TYPE
1	DETOUR AHEAD W20-2 (0) 48
2	EXIT CLOSED E5-2a-4836
3	ROAD CLOSED R11-4 6030
4	DETOUR M4-10 (0) 4818
5	DETOUR M4-10 (0) 4818
6	END DETOUR M4-8a (0) 2418
7	↑ M6-3 2115
8	↗ M5-1R 2115
9	→ M6-1R 2115
9A	↖ M6-2R 2115
10	↙ M5-1L 2115
11	← M6-1L 2115
12	⊘ R3-2 30"x30"
13	⊘ R3-2 30"x30"
14	NORTH M3-2 (0) 2412
15	SOUTH M3-4 (0) 2412
16	DETOUR M1-7 2412
17	TO R2-1-1212
18	ILLINOIS 171 M1-5-4536
19	SHIELD 55 M1-1-3636
20	ONLY M4-5-3618
21	ROAD CONSTRUCTION AHEAD W20-1103-48

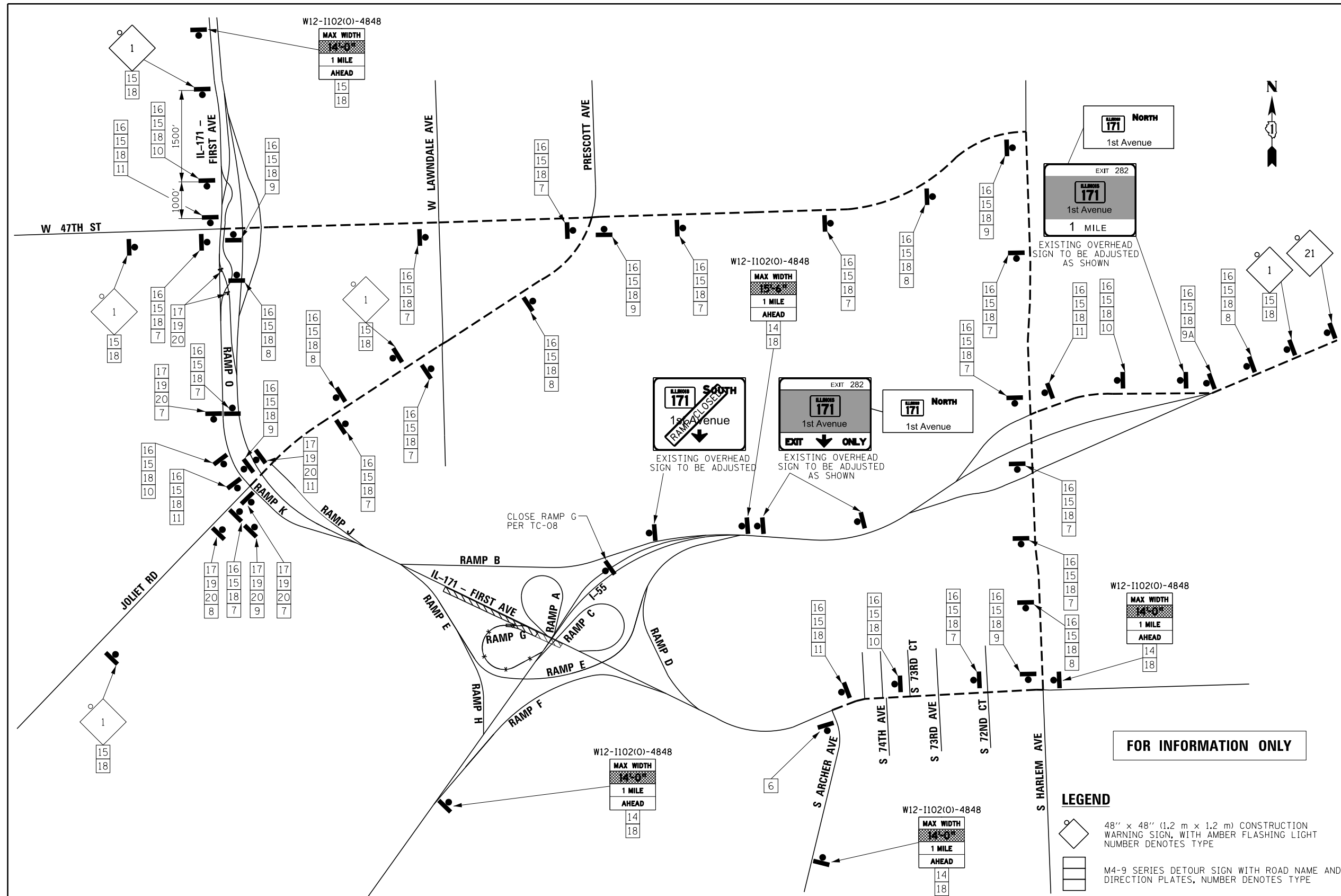

- NOTES:**
1. ALL SIGNAGE ON I-55 TO BE CO-ORDINATED WITH CONTRACT 60W77
  2. FOLLOW TC-21 FOR DETOUR SIGNING
  3. FOLLOW TC-08 FOR RAMP G CLOSURE SIGNING
  4. COVER EXISTING IL 171 SIGNS IF IN CONFLICT WITH DETOUR SIGN
  5. EXACT SIGN LOCATIONS TO BE DETERMINED BY THE ENGINEER

**LEGEND**

- ◇ 48" x 48" (1.2 m x 1.2 m) CONSTRUCTION WARNING SIGN, WITH AMBER FLASHING LIGHT NUMBER DENOTES TYPE
- M4-9 SERIES DETOUR SIGN WITH ROAD NAME AND DIRECTION PLATES, NUMBER DENOTES TYPE
- OTHER DETOUR SIGNS, NUMBER DENOTES TYPE
- ⊥ TYPE III BARRICADE WITH AMBER FLASHING LIGHTS
- - - DETOUR ROUTE
- x - RAMP CLOSED
- ▨ WORK ZONE
- EXISTING OVERHEAD SIGN TO BE COVERED

FOR INFORMATION ONLY

FILE NAME =	DESIGNED - AAA	REVISED -
... \MOT\DI60W77-Detour-1b.dgn	DRAWN - TMB	REVISED -
USER NAME = toddblank	CHECKED - JMM	REVISED -
PLOT DATE = 8/7/2014	DATE - 6/23/2014	REVISED -



STATE OF ILLINOIS  
DEPARTMENT OF TRANSPORTATION

**RAMP G DETOUR**

SCALE: N.T.S. SHEET 7 OF 8 SHEETS STA. TO STA.

F.A.P. RTE.	SECTION	COUNTY	TOTAL SHEETS	SHEET NO.
373	(0707-608 & 611)HB-B	COOK	177	33
CONTRACT NO. 60W77				
ILLINOIS FED. AID PROJECT				