

DETAIL A

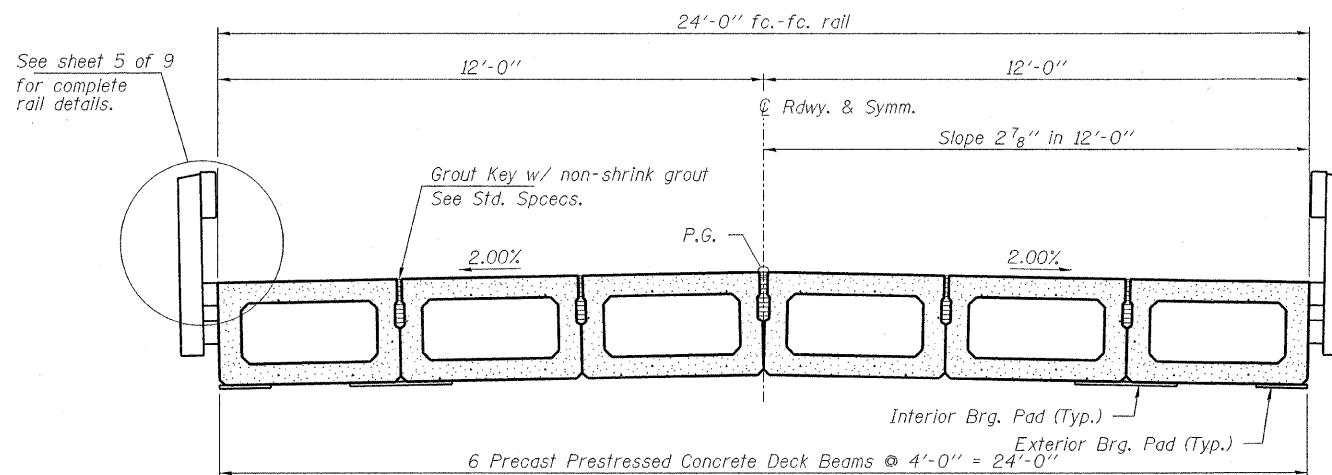

CROSS SECTION
See sheets 2 & 3 of 9 for Superstructure.

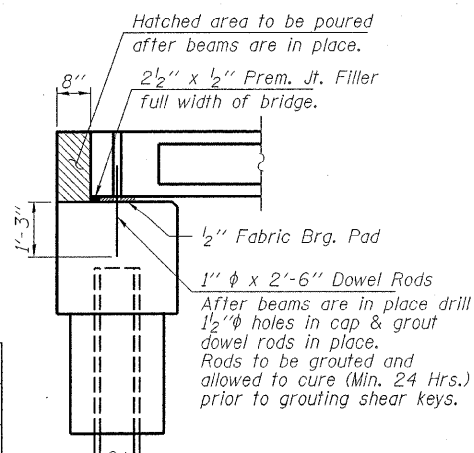

SECTION AT ABUTMENTS

© Rl. L's

DESIGNED - S.M.S.
CHECKED - S.W.M.
DRAWN - D.T.M.
CHECKED - D.A.B.

SUPERSTRUCTURE DETAILS
STRUCTURE NO. 093-3133

HAMPTON, LENZINI & RENWICK, INC. CIVIL & STRUCTURAL ENGINEERS LAND SURVEYORS HLR 3085 STEVENSON DRIVE, SUITE 201 SPRINGFIELD, ILLINOIS 62703 (217) 546-3400 PROJECT NUMBER: 08.0207.130 DATE: 03/31/09	SHEET NO. 4	T.R.	SECTION	COUNTY	TOTAL SHEETS	SHEET NO.
		37	06-06109-00-BR	WABASH	14	8
			CONTRACT NO. 95584			
		FED. ROAD DIST. NO.	ILLINOIS FED. AID PROJECT			