

ROUTE NO.	SECTION	COUNTY	TOTAL SHEETS	SHEET NO.
N. LINCOLN AVE.	07-25932-00-BR	CHAMPAIGN	50	8
STA.	TO STA.			
F.H.W.A. REG.	ILLINOIS PROJECT			

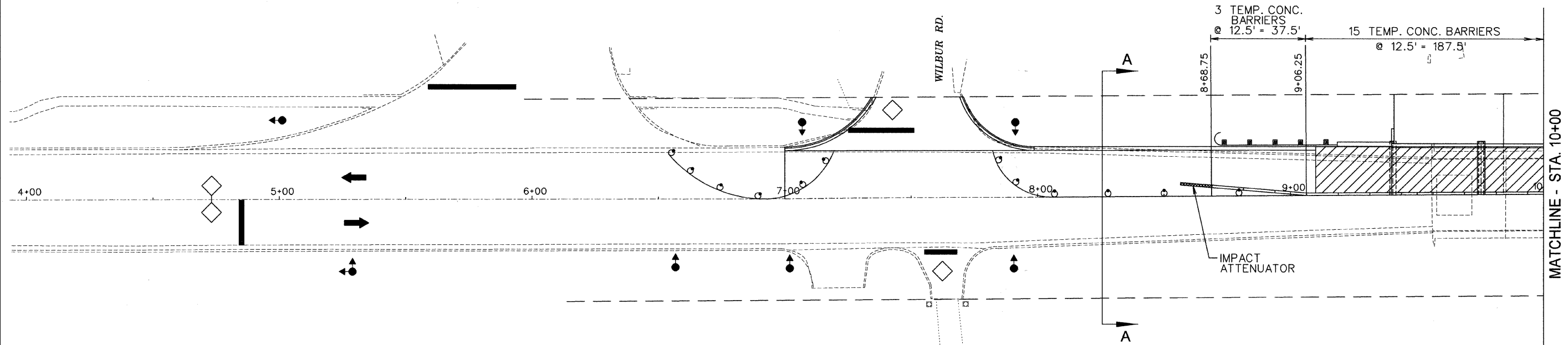
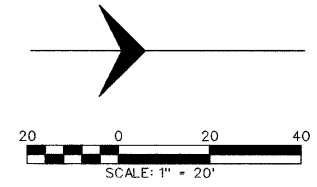

LEGEND

- BRIDGE WORK AREA
- IMPACT ATTENUATOR
- TEMP. CONCRETE BARRIER
- TYPE III BARRICADE
- DRUM WITH STEADY BURNING LIGHT
- INDUCTION LOOP DETECTOR
- TRAFFIC SIGNAL

STAGE I TRAFFIC

TRAFFIC CONTROL SCHEDULE

LOCATION STATION TO STATION	TEMP. CONC. BARRIER (FOOT)	RELOCATE TEMP. CONC. BARRIER (FOOT)	IMPACT ATTENUATORS TEMPORARY (NR) TL3 (EACH)	IMPACT ATTENUATORS RELOCATE (NR) TL3 (EACH)
STAGE I				
STA. 8+68.75 TO 11+31.25	262.5		2	
STAGE II				
STA. 7+93.75 TO 8+68.75	75			2
STA. 8+68.75 TO 11+31.25	0	262.5		
STA. 11+31.25 TO 12+06.25	75			
TOTAL	412.5	262.5	2	2

WORK ZONE PAVEMENT MARKING REMOVAL SCHEDULE

LOCATION STATION TO STATION	70301000 WORK ZONE PVMT. MARKING REMOVAL (SQ. FT.)
STAGE I	
STA. 9+00 TO 12+80	127
STA. 6+50 TO 14+40	264
STAGE II	
STA. 4+75	26
STA. 14+50	26
STA. 6+50 TO 14+40	264
STA. 9+00 TO 12+80	127
SHORT TERM Q	
STA. 4+75 TO 14+50	82
TOTAL	916

SUGGESTED STAGE CONSTRUCTION SEQUENCE

STAGE I

- ERECT TRAFFIC CONTROL FOR STAGE I.
- REMOVE EXISTING BRIDGE AND PAVEMENT LT.
- CONSTRUCT PROPOSED BRIDGE, BASE COURSE STA. 7+00 LT TO STA. 9+10.09 LT AND STA. 10+86.35 LT TO STA. 12+62 LT. CONSTRUCT FIELD ENTRANCE AND TEMPORARY RAMPS.
- CONSTRUCT PROPOSED GUARDRAIL & TERMINALS RT.

GENERAL NOTES

- THIS TRAFFIC CONTROL DETAIL SHALL BE USED IN CONJUNCTION WITH STANDARD 701321.
- EXISTING PAVEMENT MARKING THAT CONFLICT WITH THE REVISED STAGE TRAFFIC PATTERNS DURING ALL PHASES OF STAGE CONSTRUCTION SHALL BE REMOVED AS SPECIFIED IN SECTION 783 OF THE STANDARD SPECIFICATIONS AND PAID FOR AS "PAVEMENT MARKING REMOVAL".
- THE CONTRACTOR SHALL MAINTAIN ACCESS TO ALL PRIVATE AND COMMERCIAL PROPERTIES DURING ALL PHASES OF CONSTRUCTION.
- EACH DETECTOR LOOP SHALL BE CONNECTED TO A SEPARATE DETECTOR AMPLIFIER.

STAGE I TRAFFIC CONTROL PLAN
SECTION: 07-25932-00-BR
CHAMPAIGN COUNTY
Q STATION 10+00