

**LEGEND**

	TEMPORARY EROSION CONTROL SEEDING
	TEMPORARY DITCH CHECK
	INLET & PIPE PROTECTION
	PERIMETER EROSION BARRIER
	EROSION CONTROL BLANKET
	RIPRAP

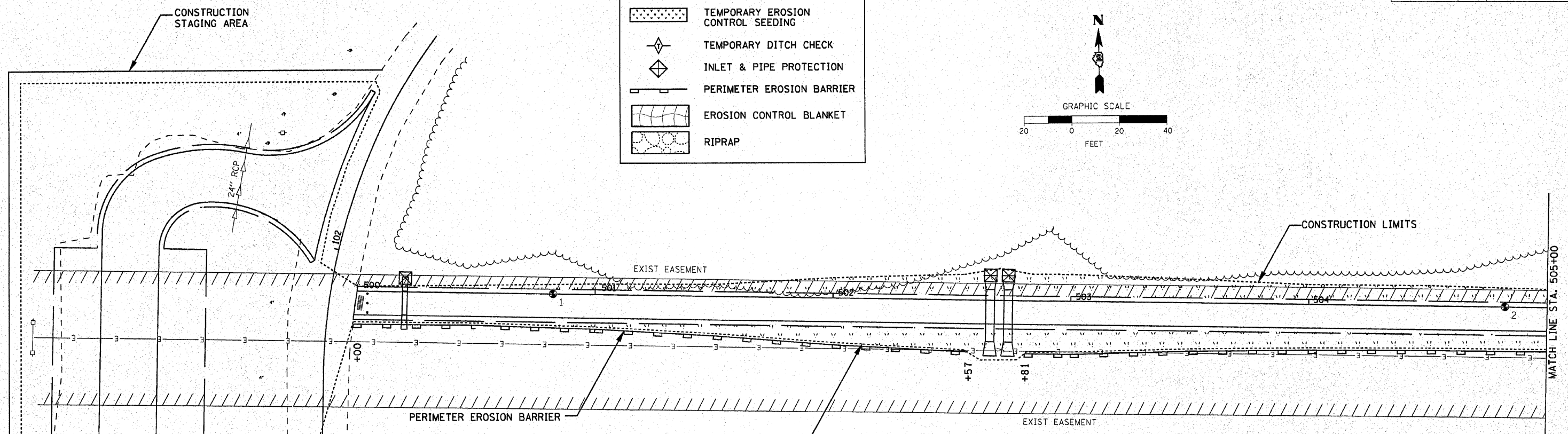
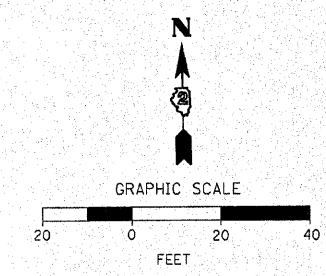

**NOTES:**

- ALL AREAS DISTURBED DUE TO CONSTRUCTION ACTIVITIES SHALL BE RESTORED TO ORIGINAL CONDITION.
- A SIGNIFICANT PORTION OF THE PROJECT ALIGNMENT TRAVERSES JURISDICTIONAL WATERS OF THE U.S. (WETLANDS) REQUIRING SECTION 404 AUTHORIZATION FROM THE U.S. ARMY CORPS OF ENGINEERS AND 401 WATER QUALITY CERTIFICATION FROM THE ILLINOIS ENVIRONMENTAL PROTECTION AGENCY. THE AUTHORIZED LIMITS OF DISTURBANCE PRESCRIBED IN THE PERMITS INCLUDE BOTH THE PERMANENT AND TEMPORARY EASEMENTS AS SHOWN ON THE PROJECT PLAN SHEETS. NO DISTURBANCES ARE AUTHORIZED OUTSIDE OF THE LIMITS OF THE EASEMENTS. THE AUTHORIZED LIMITS OF DISTURBANCE WILL BE DEMARCATED BY EASEMENT STAKES ALONG THE ENTIRE PROJECT LIMIT. ANY STAKING DISTURBED BY THE CONTRACTOR'S OPERATIONS SHALL BE RE-ESTABLISHED AT THE CONTRACTOR'S EXPENSE. A PERIMETER EROSION BARRIER (SILT FENCE) ALONG THE SOUTH SIDE OF THE PATH SHALL BE ERRECTED AS SHOWN IN THE EROSION CONTROL PLANS TO PROTECT THE WETLAND AREAS FROM EROSION AND SEDIMENT FROM CONSTRUCTION OPERATIONS. CARE SHOULD BE EXERCISED TO WORK ONLY WITHIN THE LIMITS OF THE SPECIFIED TEMPORARY AND PERMANENT EASEMENTS.
- ALL AREAS DISTURBED OUTSIDE OF THE TEMPORARY AND PERMANENT EASEMENTS SHALL BE RESTORED BY THE CONTRACTOR TO THE ORIGINAL CONDITION USING THE SPECIFIED SEEDING MIXTURES AT NO ADDITIONAL COST. NO DISTURBANCE TO WOODED OR FORESTED AREAS ARE PERMITTED UNLESS NOTED OTHERWISE ON THE PLANS. SPECIAL CARE SHALL BE TAKEN IN THESE AREAS.
- PLACE TEMPORARY EROSION CONTROL SEEDING IN AREAS DISTURBED DURING CONSTRUCTION, UNLESS PERMANENT SEEDING WILL BE PLACED WITHIN 14 DAYS AFTER WORK IN A DISTURBED AREA IS COMPLETE.
- TRACKING SEDIMENT ONTO THE STREETS MUST BE MINIMIZED. AT A MINIMUM THE STREETS SHALL BE CLEANED DAILY, AND AT THE DIRECTION OF THE ENGINEER.

**SEQUENCE OF MAJOR ACTIVITIES**

ACTIVITY	START DATE	TEMPORARY WORK SUSPENSION DATE	PERMANENT END DATE
1. CLEARING / TREE REMOVAL			
2. PERIMETER EROSION CONTROLS			
3. BOX CULVERT CONSTRUCTION			
4. GRADING / EMBANKMENT			
5. PAVING			
6. FINAL GRADING AND STABILIZATION			*

\* FINAL STABILIZATION ENDS WHEN ALL SOIL DISTURBING ACTIVITIES ARE COMPLETED AND A UNIFORM PERENNIAL VEGETATIVE COVER WITH A DENSITY OF 70% OF THE COVER FOR UNPAVED AREAS HAS BEEN ESTABLISHED OR AN EQUIVALENT PERMANENT STABILIZATION HAS BEEN CONSTRUCTED.

**MAINTENANCE**

THE CONTRACTOR IS REQUIRED TO MAINTAIN ALL EROSION AND SEDIMENT CONTROL MEASURES IN PROPER WORKING ORDER, INCLUDING CLEANING, REPAIRING, OR REPLACING THEM THROUGHOUT THE CONTRACT PERIOD. CLEANING OF SILT CONTROL DEVICES SHALL BEGIN WHEN THE FEATURES HAVE LOST 50% OF THEIR CAPACITY. CONTRACTOR IS REQUIRED TO MODIFY SWPPP WHEN THE EPA OR CITY NOTIFIES THEM THAT THE PLAN DOES NOT COMPLY WITH THE MINIMUM PERMIT REQUIREMENTS, TO ADDRESS A CHANGE IN DESIGN, CONSTRUCTION OPERATIONS OR MAINTENANCE WHICH HAS AN EFFECT ON THE POTENTIAL FOR DISCHARGE OF POLLUTANTS, AND TO PREVENT THE REOCCURRENCE OF REPORTABLE QUANTITY RELEASES OF A HAZARDOUS MATERIAL OR OIL.

**OTHER CONTROLS**

CONTRACTOR SHALL REPORT RELEASES OF REPORTABLE QUANTITIES OF OIL OR OTHER HAZARDOUS MATERIAL.  
 (A) NOTIFY NATIONAL RESPONSE CENTER 1-800-424-8802 IMMEDIATELY.  
 (B) NOTIFY PERMITTING AUTHORITY, CITY OF MOLINE AND CITY OF ROCK ISLAND IN WRITING WITHIN 14 DAYS.  
 (C) MODIFY SWPPP TO INCLUDE THE DATE OF RELEASE, CIRCUMSTANCES LEADING TO THE CAUSE OF THE RELEASE, AND STEPS TAKEN TO PREVENT REOCCURRENCE OF THE RELEASE.

REVISIONS	
NAME	DATE

ILLINOIS DEPARTMENT OF TRANSPORTATION  
**EROSION CONTROL PLAN**  
 SCALE: 1"=20'  
 DATE 3/31/09  
 DRAWN BY PAR  
 CHECKED BY PAR

DATE  
 FILE NAME  
 PLOT SCALE  
 USER NAME