

Benchmark DAS4: Chiseled "square" Southeast corner of traffic signal foundation Northwest quadrant Baugh Ave. & 15th St. 30.1 ft. Left, Sta. 500+30 (Baugh Ave.) Elev. 415.74

Existing Structure: None

DESIGN SPECIFICATIONS

2002 AASHTO Standard Specifications for Highway Bridges
1997 AASHTO Guide Specification for the Design of Pedestrian Bridges

DESIGN STRESSES

FIELD UNITS

f'c = 3,500 psi
fy = 60,000 psi (Reinf.)
fy = 50,000 psi (AASHTO M270 Grade 50) - Structural Steel
fy = 36,000 psi (AASHTO M270 Grade 36) - Railing

PREFABRICATED BRIDGE UNITS

fy = 50,000 psi (AASHTO M270 Grade 50)
See Special Provision for "Pedestrian Truss Superstructure"

LOADING H10 & PEDESTRIAN @ 85 P.S.F.

SEISMIC DATA

Seismic Performance Category (SPC) = B
Bedrock Acceleration Coefficient (A) = 0.12g
Site Coefficient (S) = 1.0

INDEX OF SHEETS

No.	Description
PB-1	GENERAL PLAN AND ELEVATION I
PB-2	GENERAL PLAN AND ELEVATION II
PB-3	GENERAL NOTES, TOTAL BILL OF MATERIAL, & TEMP. SOIL RETENTION SYSTEM
PB-4	BRIDGE TYP. SECTIONS & SUBSTRUCTURE LAYOUT
PB-5	SUPERSTRUCTURE DETAILS
PB-6	PREFORMED JOINT STRIP SEAL
PB-7	METAL SHELL PILE DETAILS
PB-8	WEST ABUTMENT
PB-9	EAST ABUTMENT
PB-10	BAR SPLICER ASSEMBLY DETAILS
PB-11	PIER 1
PB-12	PIER 2
PB-13	PIER 3
PB-14	PIER 4
PB-15	PIER 5
PB-16	PIER 6
PB-17	PIER 7
PB-18	URBAN DESIGN GUIDELINES SOLID PIER ENHANCEMENTS
PB-19	DRAINAGE SYSTEM DETAILS
PB-20	BORING LOGS 1 OF 6
PB-21	BORING LOGS 2 OF 6
PB-22	BORING LOGS 3 OF 6
PB-23	BORING LOGS 4 OF 6
PB-24	BORING LOGS 5 OF 6
PB-25	BORING LOGS 6 OF 6

APPROVED
FOR STRUCTURAL ADEQUACY ONLY

Ralph E. Anderson (TSD)
ENGINEER OF BRIDGES AND STRUCTURES

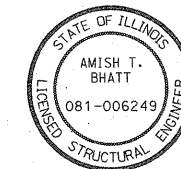

Amish T. Bhatt 05/05/09
AMISH T. BHATT DATE
LICENSE EXPIRES 11/30/2010

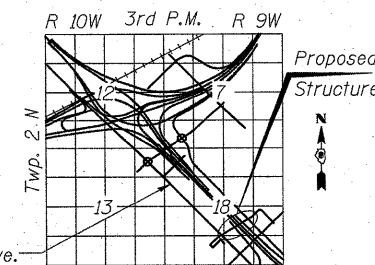

LOCATION SKETCH

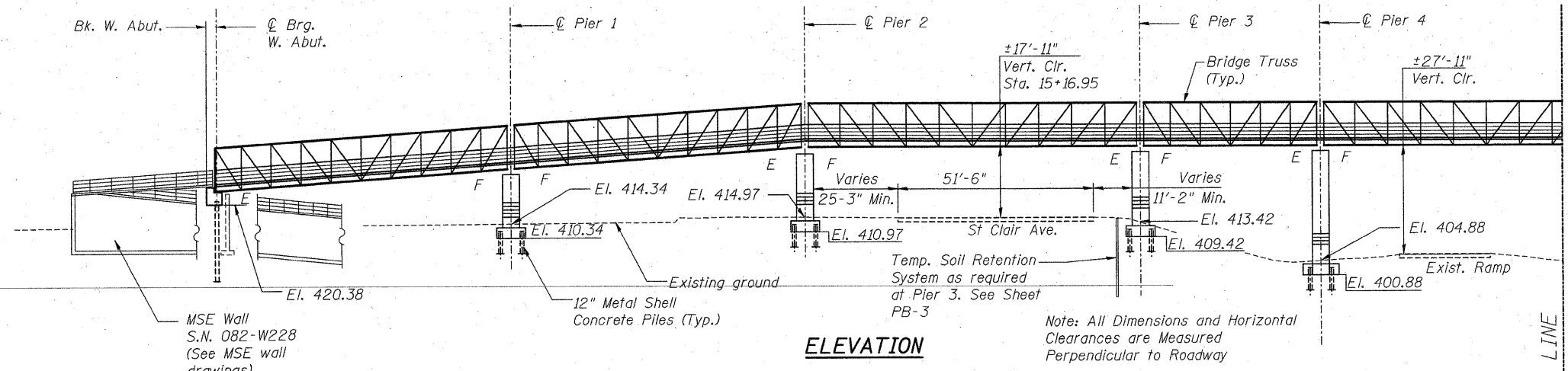

ELEVATION

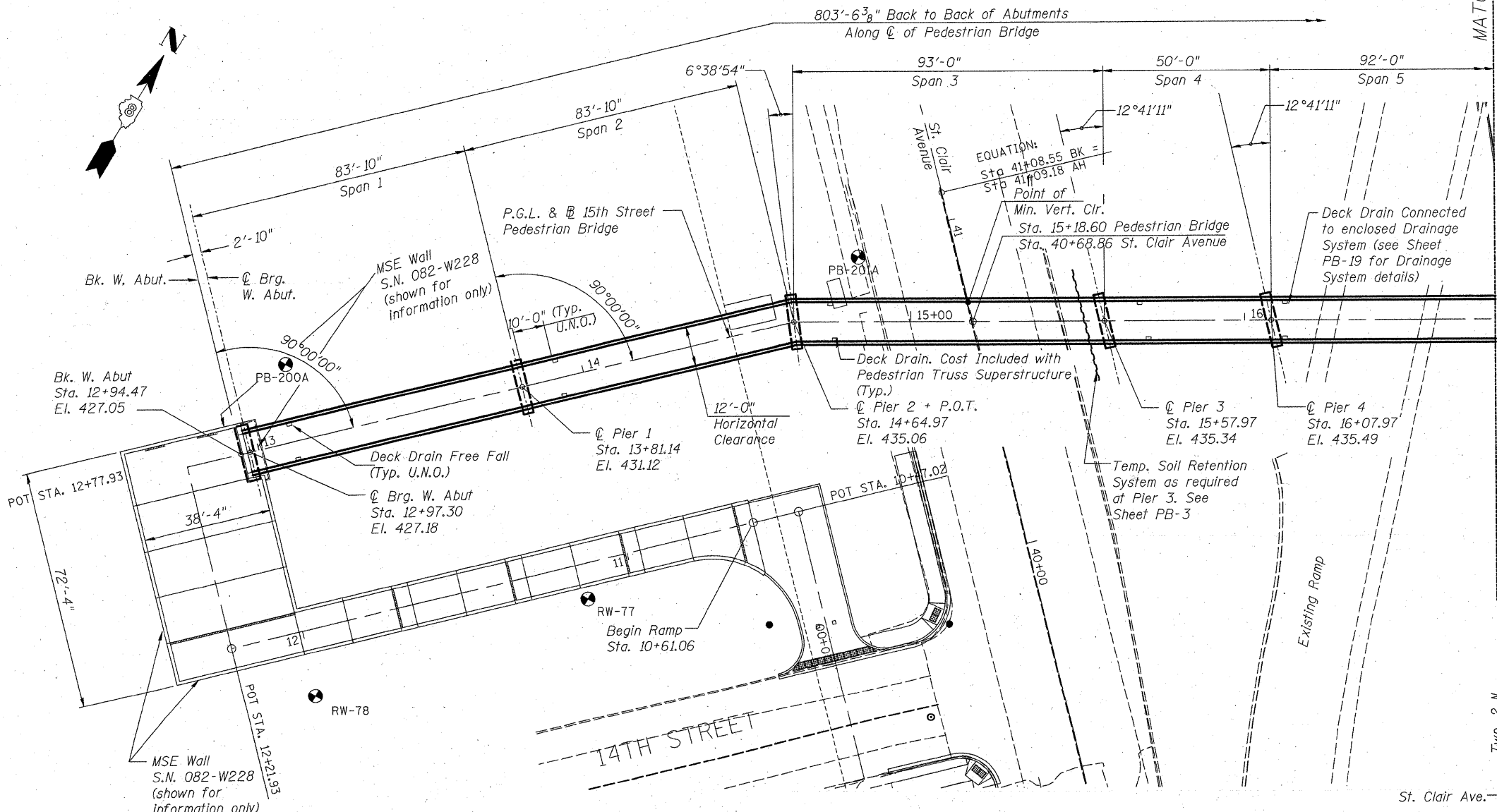

PLAN

FILE NAME = 082-0394.76C47.S01.OP-01.dgn
USER NAME = bhatta

DESIGNED - DEV
DRAWN - MK
CHECKED - ATB
DATE - 05/01/09

REVISED -
REVISED -
REVISED -
REVISED -

STATE OF ILLINOIS
DEPARTMENT OF TRANSPORTATION

GENERAL PLAN AND ELEVATION I
STRUCTURE NO. 082-0394

SCALE: SHEET NO. 1 OF 2 SHEETS STA. TO STA.

F.A. RTE.	SECTION	COUNTY	TOTAL SHEETS	SHEET NO.
64	82-1-1HBR	ST. CLAIR	93	42

FED. ROAD DIST. NO. ILLINOIS FED. AID PROJECT