

STATE OF ILLINOIS  
DEPARTMENT OF TRANSPORTATION  
DIVISION OF HIGHWAYS

**PROPOSED  
HIGHWAY PLANS**

FAI ROUTE 55 (I-55)  
SECTION (54-5,6)RS-1  
PROJECT  
RESURFACING  
LOGAN COUNTY

C-96-120-10

F.A.I. RTE.	SECTION	COUNTY	TOTAL SHEETS	SHEET NO.
55	(54-5,6)RS-1	LOGAN	8	1
		ILLINOIS	CONTRACT NO. 72D16	

D-96-120-10



ADT = 21,300 (2007)

STATE OF ILLINOIS  
DEPARTMENT OF TRANSPORTATION  
DIVISION OF HIGHWAYS

SUBMITTED July 28 2009  
Rep Z Dmsh  
DEPUTY DIRECTOR OF HIGHWAYS, REGION ENGINEER

August 14, 2009  
Charles J. Ingersoll  
ENGINEER OF DESIGN AND ENVIRONMENT

August 14, 2009  
Christine M. Reed  
DIRECTOR OF HIGHWAYS, CHIEF ENGINEER

**INDEX OF SHEETS**

1. COVER SHEET
2. GENERAL NOTES
3. SUMMARY OF QUANTITIES
4. TYPICAL SECTION
- 5.-7. PLAN SHEETS
8. BUTT JOINT DETAIL

**HIGHWAY STANDARDS**

- 000001-05
- 701101-02
- 701400-03
- 701401-05
- 701426-03
- 701901-01
- 7800001-02
- 781001-03

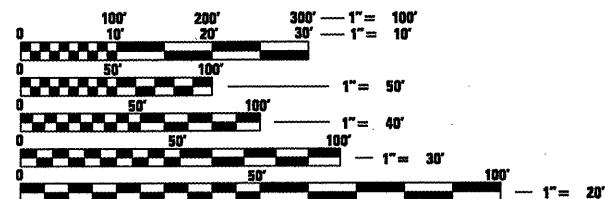

FULL SIZE PLANS HAVE BEEN PREPARED USING STANDARD ENGINEERING SCALES. REDUCED SIZED PLANS WILL NOT CONFORM TO STANDARD SCALES. IN MAKING MEASUREMENTS ON REDUCED PLANS, THE ABOVE SCALES MAY BE USED.

J.U.L.I.E.  
JOINT UTILITY LOCATION INFORMATION FOR EXCAVATION  
1-800-892-0123  
OR 811

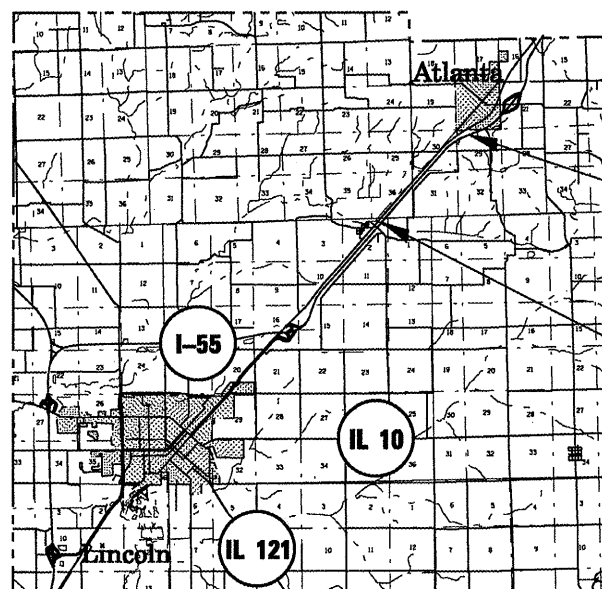

END PROJECT  
STA 437+13.00  
(METRIC STA 223+400.037)

BEGIN PROJECT  
STA 283+97.02  
(METRIC STA 218+731.723)

GROSS LENGTH = 15,315.98 FT. = 2.90 MILE  
NET LENGTH = 15,315.98 FT. = 2.90 MILE

SENIOR SQUAD LEADER: JEFF MYERS PH 217-524-7940  
PROJECT ENGINEER: SAL MADONIA PH 217-782-4761

CONTRACT NO. 72D16

PRINTED BY THE AUTHORITY  
OF THE STATE OF ILLINOIS

**GENERAL NOTES**

1. THE CONTRACTOR SHALL BE RESPONSIBLE FOR PROTECTING UTILITY PROPERTY FROM CONSTRUCTION OPERATIONS AS OUTLINED IN ARTICLE 107.31 OF THE STANDARD SPECIFICATIONS. THE JULIE NUMBER IS 800-892-0123. A MINIMUM OF FORTY-EIGHT HOURS ADVANCE NOTICE IS REQUIRED. ANY DAMAGE TO THE UNDERGROUND FACILITIES, CAUSED BY THE CONTRACTOR SHALL BE REPAIRED TO THE SATISFACTION OF THE DEPARTMENT AT THE CONTRACTOR'S EXPENSE, INCLUDING TEMPORARY REPAIRS WHICH MAY BE REQUIRED TO KEEP THE FACILITY OPERATIONAL WHILE MATERIAL IS BEING OBTAINED TO MAKE PERMANENT REPAIRS.
2. THE LOCATIONS OF THOSE BURIED AND ABOVEGROUND UTILITIES SHOWN ARE APPROXIMATE, ARE SHOWN FOR CONTRACTOR INFORMATIONAL USE ONLY, AND ARE NOT TO BE REFERENCED FOR CONSTRUCTIONS PURPOSES. THE IMPLIED PRESENCE OR ABSENCE OF UTILITIES IS NOT TO BE CONSTRUED BY THE OWNER, ENGINEER, CONTRACTOR, OR SUBCONTRACTORS TO BE AN ACCURATE AND COMPLETE REPRESENTATION OF UTILITIES THAT MAY OR MAY NOT EXIST ON THE CONSTRUCTION SITE. BURIED AND ABOVEGROUND UTILITY LOCATION, IDENTIFICATION, AND MARKING ARE THE SOLE RESPONSIBILITY OF THE CONTRACTOR. REROUTING, DISCONNECTION, PROTECTION, ETC. OF ANY UTILITIES MUST BE COORDINATED BETWEEN THE CONTRACTOR, UTILITY COMPANY, AND OWNER. SITE SAFETY, INCLUDING THE AVOIDANCE OF HAZARDS ASSOCIATED WITH BURIED AND ABOVEGROUND UTILITIES, REMAINS THE SOLE RESPONSIBILITY OF THE CONTRACTOR.
3. THE THICKNESS OF HOT-MIX ASPHALT SHOWN ON THE PLANS IS THE NOMINAL THICKNESS. DEVIATIONS FROM THE NOMINAL THICKNESS WILL BE PERMITTED WHEN SUCH DEVIATIONS OCCUR DUE TO IRREGULARITIES IN THE EXISTING SURFACE OR BASE ON WHICH THE BITUMINOUS MIXTURE IS PLACED.
4. WHERE SECTION OR SUBSECTION MONUMENTS ARE ENCOUNTERED, THE ENGINEER SHALL BE NOTIFIED BEFORE SUCH MONUMENTS ARE REMOVED. THE CONTRACTOR SHALL PROTECT AND CAREFULLY PRESERVE ALL MONUMENTS UNTIL AN AUTHORIZED SURVEYOR OR AGENT HAS WITNESSED OR OTHERWISE REFERENCED THEIR LOCATION. THE CONTRACTOR SHALL BE RESPONSIBLE FOR HAVING AN AUTHORIZED SURVEYOR RE-ESTABLISH ANY SECTION OR SUBSECTION MONUMENTS DESTROYED BY HIS OPERATIONS.
5. THE FOLLOWING RATES OF APPLICATION HAVE BEEN USED IN CALCULATING PLAN QUANTITIES:  

HOT-MIX ASPALT MATERIAL (PRIME COAT)	0.00038	TON/SQ YD
HOT-MIX ASPHALT BINDER, SURFACE CSE	112	LBS/SQ YD/IN
6. ANY REFERENCE TO A STANDARD IN THESE PLANS SHALL BE INTERPRETED TO MEAN THE EDITION AS INDICATED BY THE SUBNUMBER LISTED ON THE INDEX OF SHEETS OR THE COPY OF THE STANDARD INCLUDED IN THESE PLANS.
7. UNLESS NOTED OTHERWISE, STATIONS AND OFFSETS REFER TO CENTERLINE OF PROJECT.
8. IN ADDITION TO FIELD SURVEYS AND AERIAL SURVEYS, PLAN DIMENSIONS AND DETAILS RELATIVE TO THE EXISTING FACILITIES HAVE BEEN TAKEN FROM EXISTING PLANS AND ARE SUBJECT TO CONSTRUCTION VARIATIONS. IT SHALL BE THE CONTRACTOR'S RESPONSIBILITY TO VERIFY SUCH DIMENSIONS AND DETAILS IN THE FIELD. SUCH VARIATIONS SHALL NOT BE A CAUSE FOR ADDITIONAL COMPENSATION DUE TO A CHANGE IN THE SCOPE OF THE WORK. HOWEVER, THE CONTRACTOR WILL BE PAID FOR THE QUANTITY ACTUALLY FURNISHED AT THE UNIT PRICE BID FOR THE WORK.

**MIXTURE REQUIREMENTS**

MIXTURE NUMBER:		
LOCATION	I-55	I-55
MIXTURE USE (S):	HMA LEVELING BINDER	HMA SURFACE
AC/PG:	SBS PG 70-22	SBS PG 76-22
DESIGN AIR VOIDS:	4.0% @ N DESIGN = 105	4.0% @ N DESIGN = 105
MIXTURE COMPOSITION (GRADATION MIXTURE)	IL 9.5 OR 12.5	IL 9.5 OR 12.5
FRICTION AGGREGATE	N/A	MIX "E"

<b>DISTRICT SIX</b>	
EXAMINED <u>July 21</u> 20 <u>09</u>	<i>Ron J. Haas</i>
OPERATIONS ENGINEER	
EXAMINED <u>July 23</u> 20 <u>09</u>	<i>Ron J. Haas</i>
PROGRAM IMPLEMENTATION ENGINEER	
EXAMINED <u>July 27</u> 20 <u>09</u>	<i>DRM</i>
PROGRAM DEVELOPMENT ENGINEER	

**COMMITMENTS**

NONE

SUMMARY OF QUANTITIES			100% STATE
CODE NO.	PAY ITEM	UNIT	CONSTRUCTION TYPE CODE 1000-2A
40600200	BITUMINOUS MATERIALS (PRIME COAT)	TON	7.8
40600895	CONSTRUCTING TEST STRIP	EACH	2
40600855	POLYMERIZED LEVELING BINDER (MACHINE METHOD), N105	TON	2,001
40603575	POLYMERIZED HOT-MIX ASPHALT SURFACE COURSE, MIX "E", N105	TON	1,715
44000162	HOT-MIX ASPHALT SURFACE REMOVAL, 3 1/4"	SQ YD	20,421
44200577	CLASS A PATCHES, TYPE II, 12 INCH	SQ YD	80
44200581	CLASS A PATCHES, TYPE III, 12 INCH	SQ YD	60
44200583	CLASS A PATCHES, TYPE IV, 12 INCH	SQ YD	60
44213000	PATCHING REINFORCEMENT	SQ YD	200
44213200	SAW CUTS	FOOT	1,000
67100100	MOBILIZATION	L SUM	1
70100800	TRAFFIC CONTROL AND PROTECTION, STANDARD 701401	L SUM	1
70106800	CHANGEABLE MESSAGE SIGN	CAL MO	2
70300100	SHORT-TERM PAVEMENT MARKING	FOOT	2,144
70301000	WORK ZONE PAVEMENT MARKING REMOVAL	SQ FT	715
* 78100100	RAISED REFLECTIVE PAVEMENT MARKER	EACH	192
78300200	RAISED REFLECTIVE PAVEMENT MARKER REMOVAL	EACH	192
* X7800620	URETHANE PAVEMENT MARKING - LINE 5"	FOOT	19,146
Z0075300	TIE BARS	EACH	25

*\*Specialty Items*

FILE NAME = c:\pwwork\PM100T\LAUGHLIN\LD151730\	USER NAME = laughlinr1 72D16-800.dgn	DESIGNED - DRAWN -	REVISED - REVISED -	<b>STATE OF ILLINOIS DEPARTMENT OF TRANSPORTATION</b>	<b>SUMMARY OF QUANTITIES</b>			F.A.I. RTE. 55	SECTION (54-5,6/RS-1)	COUNTY LOGAN	TOTAL SHEETS 8	SHEET NO. 3
PLOT SCALE = 1/8" = 100'-0" / IN.		CHECKED -	REVISED -		SCALE:	SHEET NO.	OF	SHEETS	STA.	TO STA.	CONTRACT NO. 72D16	
PLOT DATE = Jul-31-2009 03:18:54PM		DATE -	REVISED -		ILLINOIS FED. AID PROJECT							

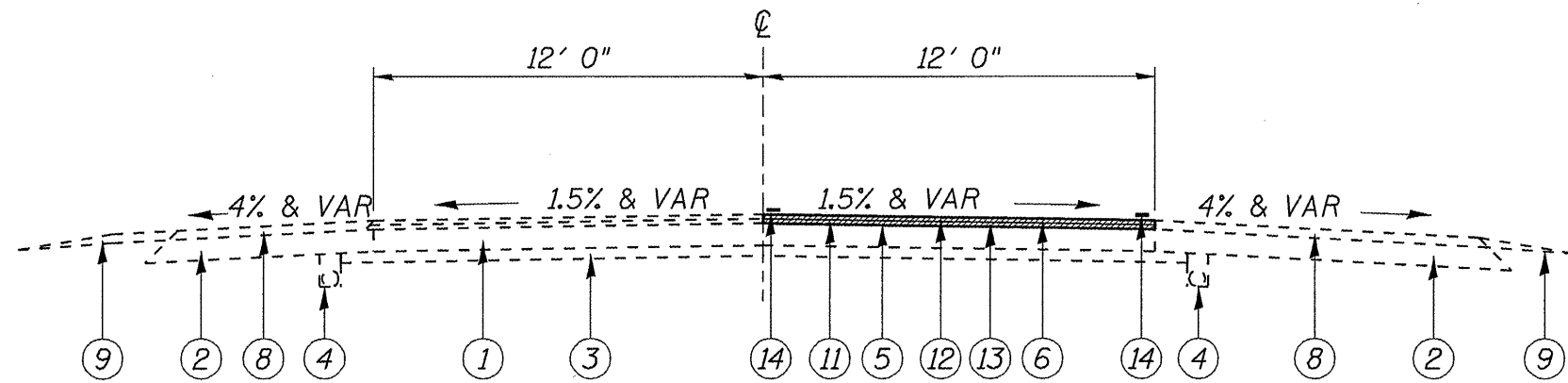

**I-55 SB LANES (LOOKING SOUTH)**  
 STA 402+51.57 TO STA 437+13.00  
 (METRIC STA 222+345.000 TO 223+400.037)

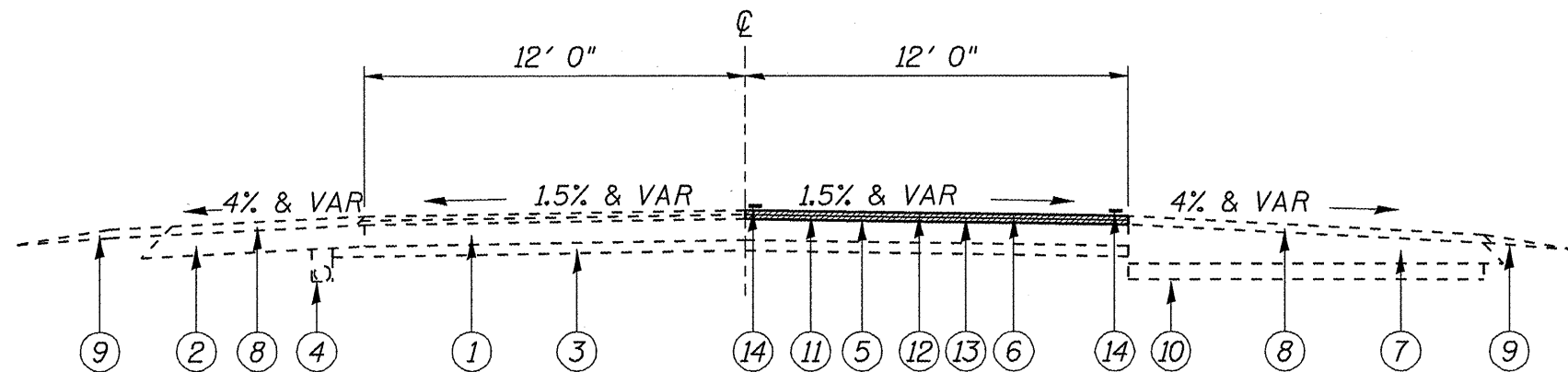

**I-55 SB LANES (LOOKING SOUTH)**  
 STA 283+72.53 TO STA 402+51.57  
 (METRIC STA 218+731.723 TO STA 222+345.000)

LEGEND

- ① EX CRC PAVEMENT, 9"
- ② EX STABILIZED SHOULDER, 8"
- ③ EX STABILIZED SUB-BASE, 4"
- ④ EX PIPE UNDERDRAIN
- ⑤ EX HMA BINDER, 1-3/4"
- ⑥ EX HMA SURFACE, 1-1/2"
- ⑦ EX HMA SHOULDER, VARIABLE DEPTH
- ⑧ EX HMA SHOULDER OVERLAY
- ⑨ EX AGGREGATE SHOULDER
- ⑩ EX PAVEMENT (BURIED)
- ⑪ PR H.M.A. SURFACE REMOVAL 3 1/4"
- ⑫ PR POLYMERIZED H.M.A. SURFACE COURSE, MIX E, NI05 1 1/2"
- ⑬ PR POLYMERIZED H.M.A. LEVELING BINDER (MACHINE METHOD), NI05 1 3/4"
- ⑭ PR URETHANE PAVEMENT MARKING - LINE 5"

FILE NAME =	USER NAME = laughlinr1	DESIGNED -	REVISED -
c:\pwwork\PMIDOT\LAUGHLINR1\0151730\072016-Typical.dgn		DRAWN -	REVISED -
PLOT SCALE = 5/8" = 1' / IN.		CHECKED -	REVISED -
PLOT DATE = Jul-31-2009 03:18:06PM		DATE -	REVISED -

STATE OF ILLINOIS  
 DEPARTMENT OF TRANSPORTATION

TYPICAL SECTIONS

SCALE: SHEET NO. OF SHEETS STA. TO STA.

F.A.I. RTE.	SECTION	COUNTY	TOTAL SHEETS	SHEET NO.
55	(54-5,6)RS-1	LOGAN	8	4
CONTRACT NO. 72016				
ILLINOIS FED. AID PROJECT				

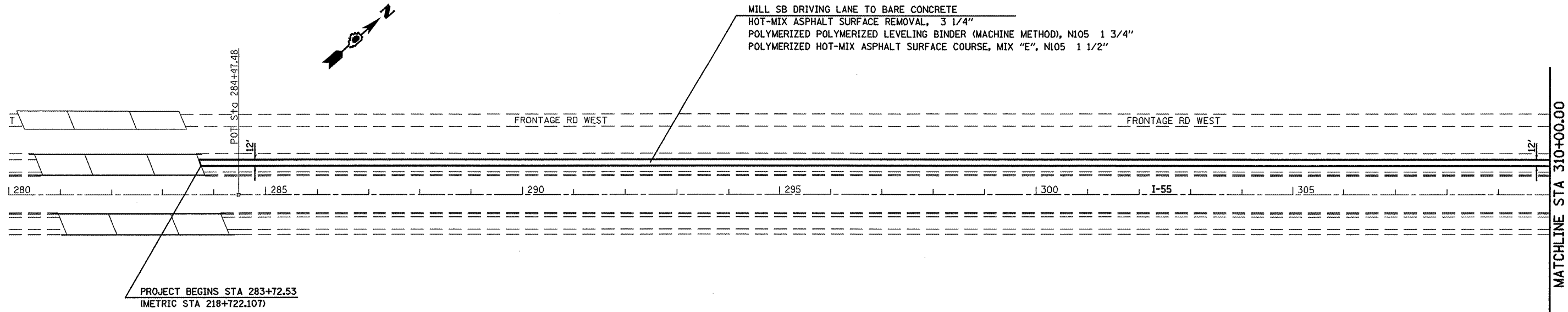

PROJECT BEGINS STA 283+72.53  
(METRIC STA 218+722.107)

POT, Sta 284+47.48

MILL SB DRIVING LANE TO BARE CONCRETE  
HOT-MIX ASPHALT SURFACE REMOVAL, 3 1/4"  
POLYMERIZED POLYMERIZED LEVELING BINDER (MACHINE METHOD), NI05 1 3/4"  
POLYMERIZED HOT-MIX ASPHALT SURFACE COURSE, MIX "E", NI05 1 1/2"

MATCHLINE STA 310+00.00

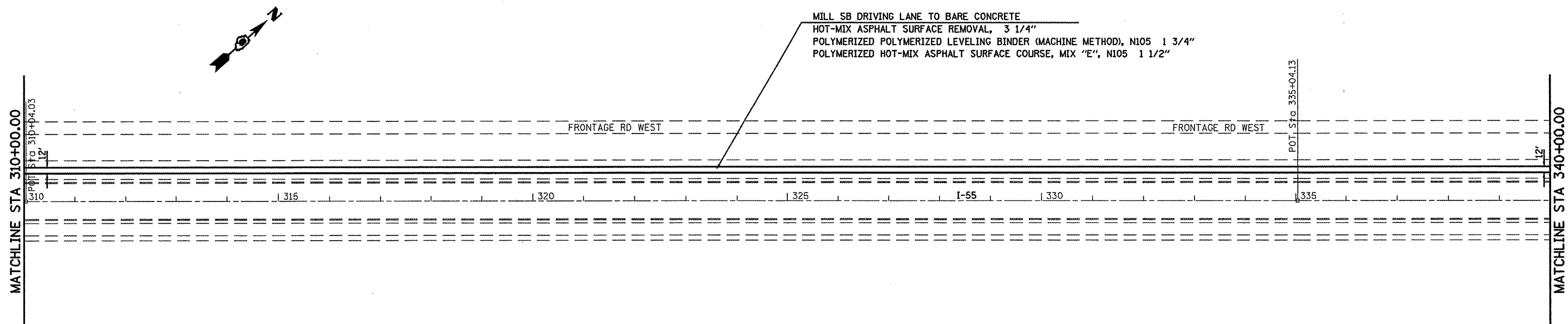

MILL SB DRIVING LANE TO BARE CONCRETE  
HOT-MIX ASPHALT SURFACE REMOVAL, 3 1/4"  
POLYMERIZED POLYMERIZED LEVELING BINDER (MACHINE METHOD), NI05 1 3/4"  
POLYMERIZED HOT-MIX ASPHALT SURFACE COURSE, MIX "E", NI05 1 1/2"

POT, Sta 335+04.13

MATCHLINE STA 310+00.00

MATCHLINE STA 340+00.00

FILE NAME =	USER NAME = laughlinr1	DESIGNED -	REVISED -
of:\pwork\p\WID07\AUGHLINRL\00151730\072016-sh-t-plan3.dgn		DRAWN -	REVISED -
	PLOT SCALE = 200.0000 ' / IN.	CHECKED -	REVISED -
	PLOT DATE = Jul-31-2007 03:10:58PM	DATE -	REVISED -

**STATE OF ILLINOIS  
DEPARTMENT OF TRANSPORTATION**

**I-55 PLAN SHEET**

SCALE: 1" = 100' SHEET NO. OF SHEETS STA. TO STA.

F.A.T. RTE.	SECTION	COUNTY	TOTAL SHEETS	SHEET NO.
55	(54-5,6)RS-1	LOGAN	8	5
CONTRACT NO. T2D16			ILLINOIS FED. AID PROJECT	

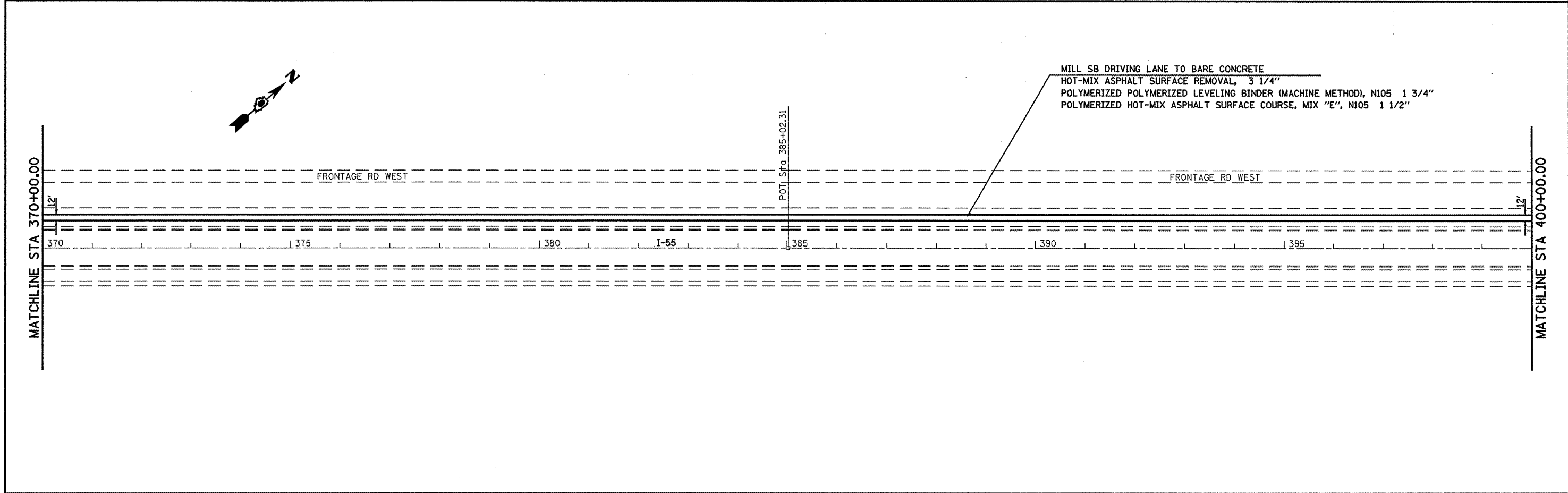
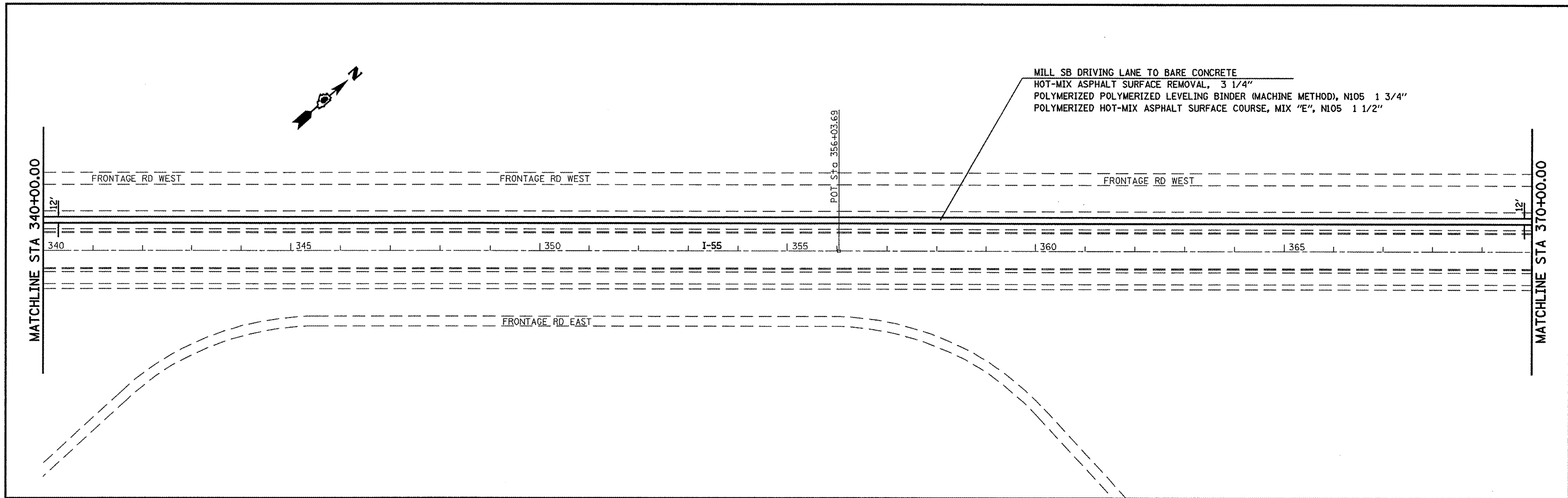

FILE NAME = c:\pwwork\pwwork\101\LAUGHLIN\101\15173\101\72016-shr-plan3.dgn

USER NAME = laughlinr1  
 PLOT SCALE = 200.0000' / IN.  
 PLOT DATE = Jul-31-2009 03:11:00PM

DESIGNED -	REVISED -
DRAWN -	REVISED -
CHECKED -	REVISED -
DATE -	REVISED -

**STATE OF ILLINOIS  
 DEPARTMENT OF TRANSPORTATION**

**I-55 PLAN SHEET**

SCALE: 1" = 100'    SHEET NO.    OF    SHEETS    STA.    TO STA.

F.A.L. RTE.	SECTION	COUNTY	TOTAL SHEETS	SHEET NO.
55	(54-5,6)RS-1	LOGAN	8	6
CONTRACT NO. 72D16			ILLINOIS FED. AID PROJECT	

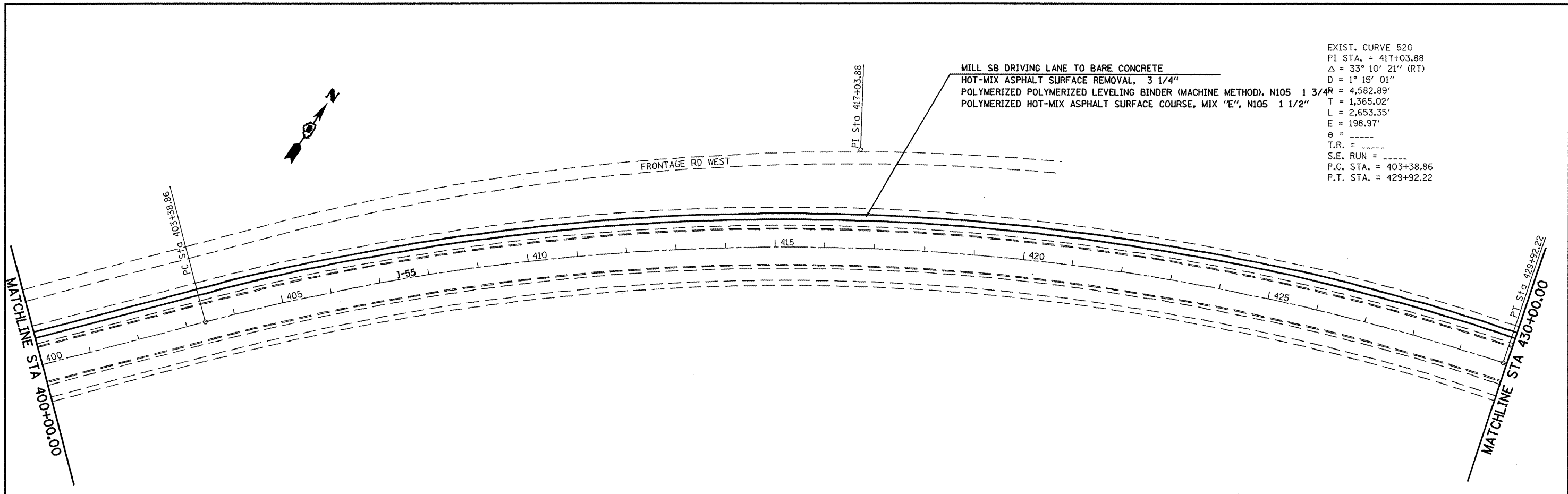

EXIST. CURVE 520  
 PI STA. = 417+03.88  
 $\Delta = 33^\circ 10' 21''$  (RT)  
 $D = 1^\circ 15' 01''$   
 $R = 4,582.89'$   
 $T = 1,365.02'$   
 $L = 2,653.35'$   
 $E = 198.97'$   
 $e = \text{-----}$   
 T.R. =  $\text{-----}$   
 S.E. RUN =  $\text{-----}$   
 P.C. STA. = 403+38.86  
 P.T. STA. = 429+92.22

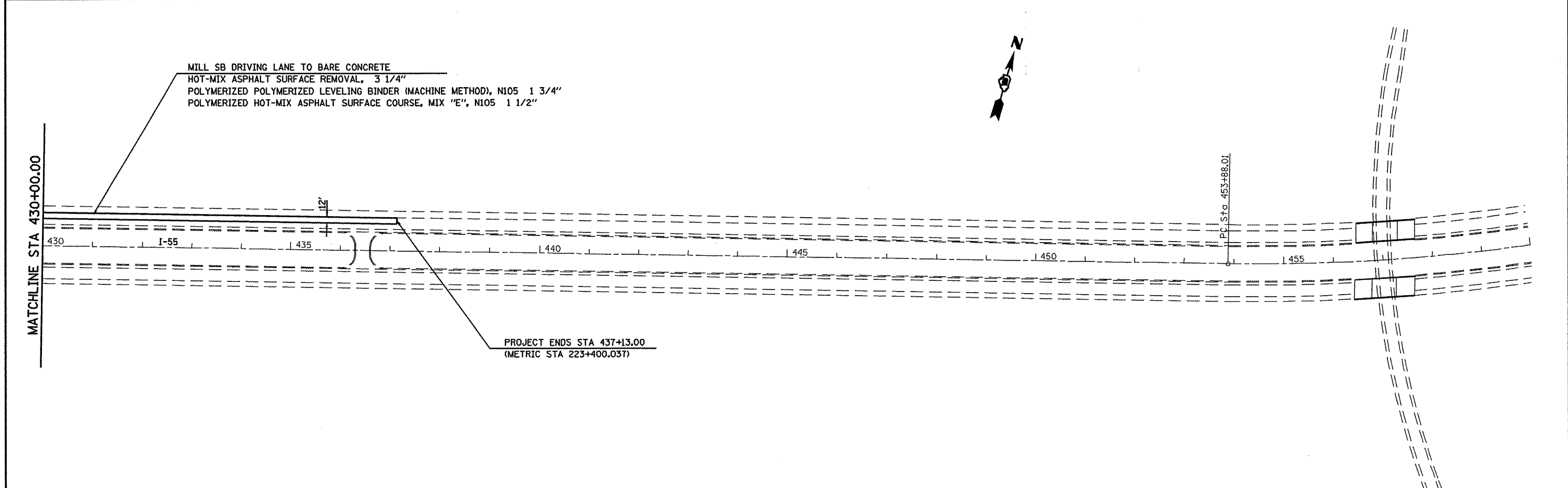

FILE NAME = c:\pwwork\p\widot\LAUGHLIN\140151730\0	USER NAME = laughl1nr1 72D16-sh-t-plan3dgn	DESIGNED - DRAWN -	REVISED - REVISED -	<b>STATE OF ILLINOIS DEPARTMENT OF TRANSPORTATION</b>	<b>I-55 PLAN SHEET</b>			F.A.I. RTE: 55	SECTION (54-5,6)RS-1	COUNTY LOGAN	TOTAL SHEETS 8	SHEET NO. 7
PLOT SCALE = 200.0000' / IN.					CHECKED -	REVISED -	SCALE: 1" = 100'	SHEET NO. OF SHEETS	STA. TO STA.	CONTRACT NO. T2D16		
PLOT DATE = Jul-31-2009 03:11:02PM					DATE -	REVISED -	ILLINOIS FED. AID PROJECT					

SAW CUT MIN. 1 1/2"  
INCLUDED IN H.M.A.  
SURF. REM. 3 1/4"

STA. 283+72.53  
(METRIC STA 218+722.107)

STA 437+13.00  
(METRIC STA. 223+400.037)

SAW CUT MIN. 1 1/2"  
INCLUDED IN H.M.A.  
SURF. REM. 3 1/4"

EXIST. H.M.A.  
SURFACE

BRIDGE  
ABUTMENT

PROP. POLY. H.M.A. SURF. CRSE., MIX E,  
N 105, 1 1/2"

PROP. POLY. H.M.A LEVEL BIND  
(MACHINE METHOD), N105, 1 3/4"

PROP. POLY. H.M.A. SURF. CRSE., MIX E,  
N 105, 1 1/2"

PROP. POLY. H.M.A LEVEL BIND  
(MACHINE METHOD), N105, 1 3/4"

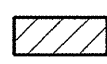
 PROP. POLY. H.M.A SURF. REM. 3 1/4"

FILE NAME = c:\pwwork\pwwid001\LAUGH.D\RL\d0151730\	USER NAME = laughlrr1	DESIGNED -	REVISED -
	72D16-detail.dgn	DRAWN -	REVISED -
	PLOT SCALE = 100.0000' / IN.	CHECKED -	REVISED -
	PLOT DATE = Jul-31-2009 03:11:47PM	DATE -	REVISED -

STATE OF ILLINOIS  
DEPARTMENT OF TRANSPORTATION

BUTT JOINT DETAIL				
SCALE:	SHEET NO.	OF SHEETS	STA.	TO STA.

F.A.I. RTE.	SECTION	COUNTY	TOTAL SHEETS	SHEET NO.
55	(54-5,6)RS-1	LOGAN	8	8
CONTRACT NO. 72D16				
ILLINOIS FED. AID PROJECT				