

RAILROAD CROSSING ON TOUHY AVENUE BETWEEN ST. LOUIS AVE. AND KIMBALL AVE. IS ABANDONED AND ROADWAY WORK IS TO BE DONE UP TO BOTH SIDES OF THE TRACK

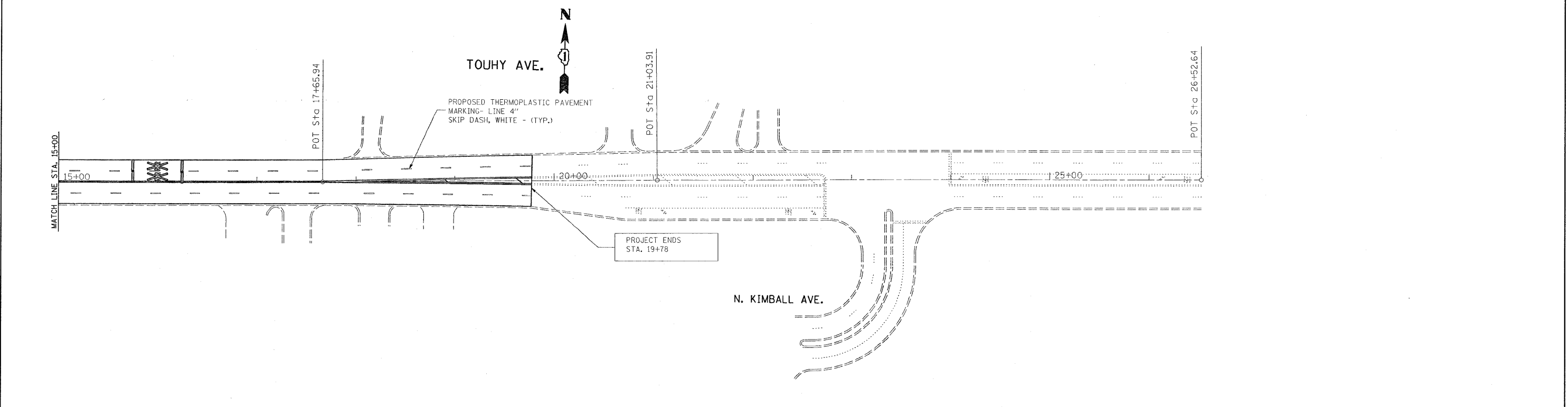

| | | | | | | | | | | | | | |
|---|-----------------------------|------------|-----------|---|--|-----------|----|------------------------|------------------------|----------------|-----------------------|-------------------|--|
| FILE NAME = c:\p\work\p\WIDOT\GUILLAUMEFP\d0143208 | USER NAME = guillaumefp | DESIGNED - | REVISED - | STATE OF ILLINOIS DEPARTMENT OF TRANSPORTATION | ROADWAY & PAVEMENT MARKING PLAN TOUHY AVE. (LAWNDALE TO KIMBALL AVE.) | | | F.A.U. RTE. 1340 | SECTION 2009-063 RS | COUNTY COOK | TOTAL SHEETS 21 | SHEET NO. 6 | |
| | PLOT SCALE = 50.0000' / IN. | CHECKED - | REVISED - | | SCALE: | SHEET NO. | OF | SHEETS | STA. | TO STA. | CONTRACT NO. 60H66 | | |
| | PLOT DATE = 6/27/2009 | DATE - | REVISED - | | ILLINOIS FED. AID PROJECT | | | | | | | | |
| | | | | | | | | | | | | | |