

STATE OF ILLINOIS
DEPARTMENT OF TRANSPORTATION

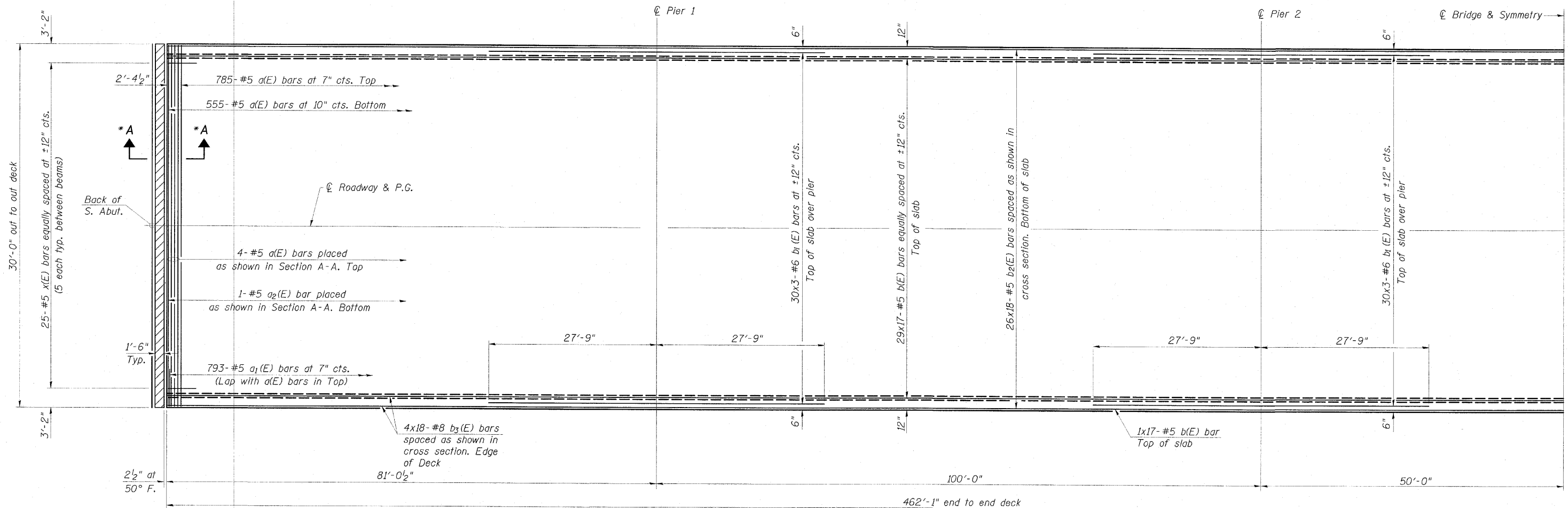

PARTIAL PLAN

* Section A-A on sheet 9 of 25

MINIMUM BAR LAP

- (Slab)
- #5 bar = 3'-3"
 - #6 bar = 3'-10"
 - #8 bar = 6'-9"

Notes:
See sheet 9 of 25 for superstructure details and Bill of Material.
Bars indicated thus 29 x 17-#5 etc. indicates 29 lines of bars with 17 lengths per line.

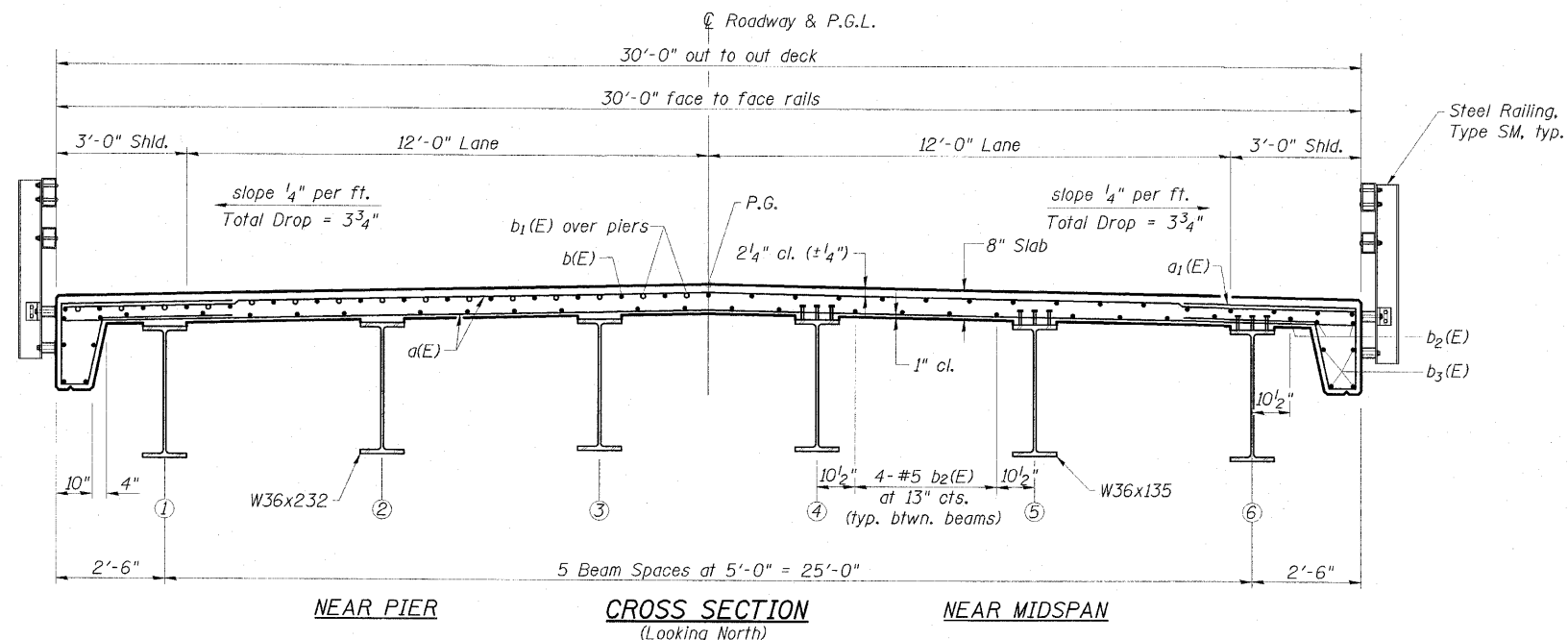

CROSS SECTION
(Looking North)

**SUPERSTRUCTURE
STRUCTURE NO. 074-0085**

ESCA
CONSULTANTS, INC.

DESIGNED BY:	FMA/MTD	11/09
DRAWN BY:	DWH/HAS	11/09
CHECKED BY:	MTD	11/09
APPROVED BY:	RDP	05/10

SHEET NO. 8 25 SHEETS	F.A.S. RTE.	SECTION	COUNTY	TOTAL SHEETS	SHEET NO.
	535	08-00255-00-BR	PIATT	62	32
CONTRACT NO. 91436					
FED. ROAD DIST. NO.		ILLINOIS	FED. AID PROJECT		