

RTE	SECTION	COUNTY	TOTAL SHEETS	SHEET NO.
**	*	PIATT	62	1
STA.	TO STA.			
FED. ROAD DIST. NO.	ILLINOIS	FED. AID PROJECT		
*08-00255-00-BR **FAS 535				

STATE OF ILLINOIS  
DEPARTMENT OF TRANSPORTATION  
DIVISION OF HIGHWAYS

**PLANS FOR PROPOSED  
ROADWAY IMPROVEMENTS**

FAS 535 (SHADY REST ROAD)  
SECTION 08-00255-00-BR  
BRIDGE REPLACEMENT  
PIATT COUNTY  
C-95-326-10  
PROJECT NO. BRS-RS-0535(103)

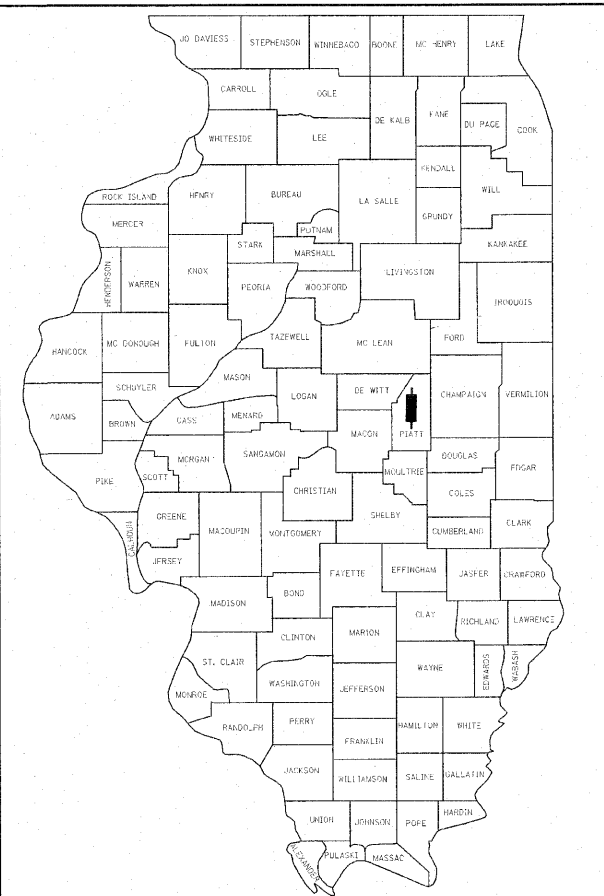

LOCATION OF SECTION INDICATED THUS:

FAS 535  
FUNCTIONAL CLASSIFICATION: MAJOR COLLECTOR  
ADT: 1000

APPROVED *[Signature]* 20 10  
COUNTY ENGINEER

PASSED *[Signature]* 6/7 20 10  
DISTRICT FIVE ENGINEER OF LOCAL ROADS & STREETS

RELEASED FOR BID  
BASED ON LIMITED  
REVIEW *[Signature]* JUNE 8 20 10  
DEPUTY DIRECTOR OF HIGHWAYS, REGION THREE ENGINEER

STATE OF ILLINOIS  
DEPARTMENT OF TRANSPORTATION

**PRINTED BY THE AUTHORITY  
OF THE STATE OF ILLINOIS**

**INDEX OF SHEETS**

SHEET NO.	DESCRIPTION
<b>ROADWAY PLANS</b>	
1.	COVER SHEET
2.	GENERAL NOTES, STANDARDS, AND LEGEND
3.-4.	SUMMARY OF QUANTITIES
5.-10.	TYPICAL SECTIONS
11.-13.	SCHEDULES OF QUANTITIES
14.	TIES & BENCHMARKS
15.-17.	FAS 535 PLAN AND PROFILE
18.-19.	TEMPORARY ACCESS ROAD PLAN AND PROFILE
20.	FAS 535 EROSION CONTROL AND DRAINAGE PLAN
21.-22.	MISCELLANEOUS DETAILS
23.	BOX CULVERT EXTENSION
24.	TRAFFIC CONTROL AND PROTECTION FOR TEMPORARY DETOUR
<b>STRUCTURE PLANS</b>	
25.	GENERAL PLAN
26.	GENERAL DATA
27.-29.	TOP OF SLAB ELEVATIONS
30.	TOP OF SOUTH APPROACH SLAB ELEVATIONS
31.	TOP OF NORTH APPROACH SLAB ELEVATIONS
32.	SUPERSTRUCTURE
33.	SUPERSTRUCTURE DETAILS
34.-35.	BRIDGE APPROACH SLAB DETAILS
36.	STEEL RAILING, TYPE SM
37.	PREFORMED JOINT STRIP SEAL
38.-39.	STEEL FRAMING PLAN AND DETAILS
40.	BEARING DETAILS
41.	ABUTMENTS
42.	PIERS 1 AND 4
43.	PIER 2
44.	PIER 3
45.	HP PILE DETAILS
46.	BAR SPLICER ASSEMBLY AND MECHANICAL SPLICER DETAILS
47.-49.	SOIL BORING LOGS
<b>CROSS SECTIONS</b>	
50.-62.	FAS 535 CROSS SECTIONS

**SCALES**

SHEET TYPES	SCALE
PLAN	1"=40'
PROFILE HORIZONTAL	1"=40'
PROFILE VERTICAL	1"=5'
CROSS SECTION HORIZONTAL	1"=10'
CROSS SECTION VERTICAL	1"=5'

**ENGLISH RATIOS**

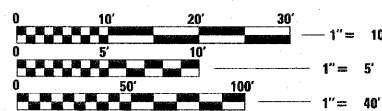

FULL SIZE PLANS HAVE BEEN PREPARED USING STANDARD ENGINEERING SCALES. REDUCED SIZED PLANS WILL NOT CONFORM TO STANDARD SCALES. IN MAKING MEASUREMENTS ON REDUCED PLANS, THE ABOVE SCALES MAY BE USED.

J.U.L.I.E.  
JOINT UTILITY LOCATION INFORMATION FOR EXCAVATION  
1-800-892-0123

PIATT COUNTY HIGHWAY DEPARTMENT  
(217) 762-9481

CONTRACT NO. 91436

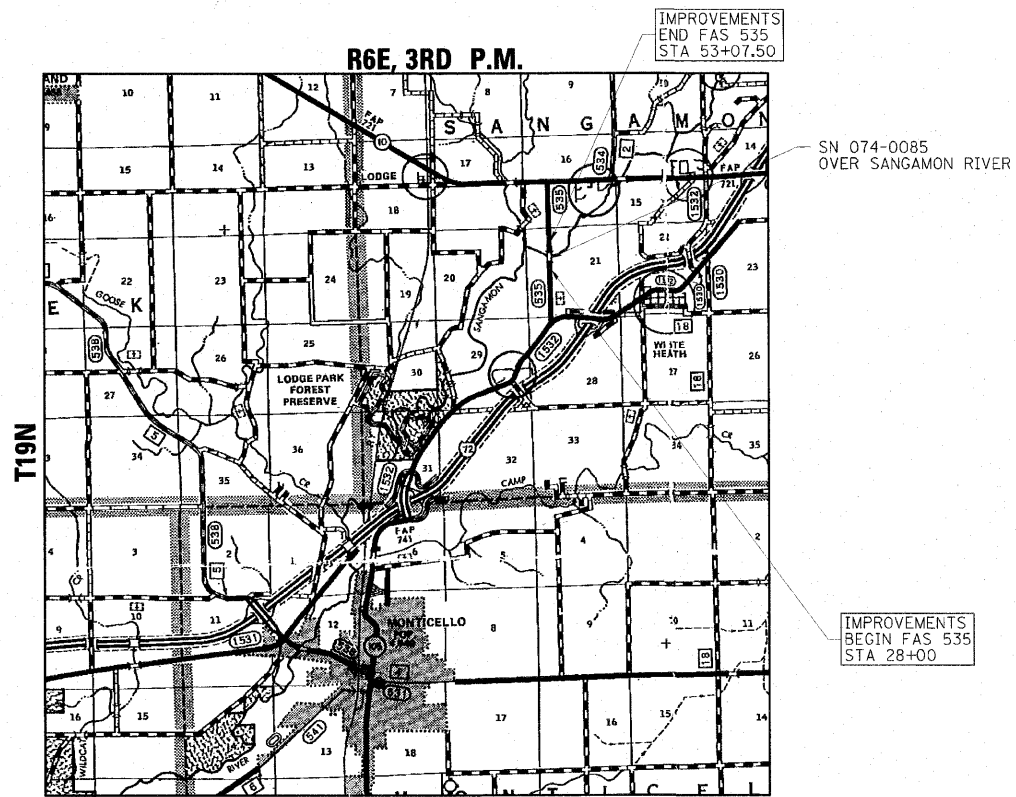
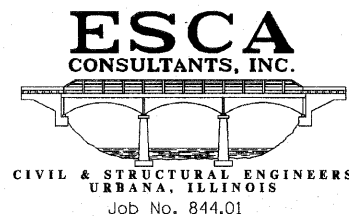

LOCATION MAP

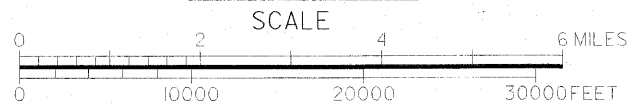

GROSS LENGTH = 2508 FT. = 0.47 MI.  
NET LENGTH = 2508 FT. = 0.47 MI.

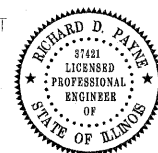

*Richard D. Payne* DATE: 05/21/0  
ILLINOIS PROFESSIONAL LICENSE NO. 37421  
(EXPIRATION DATE: 11-30-11)