

SECTION 23, TOWNSHIP 36, RANGE 14

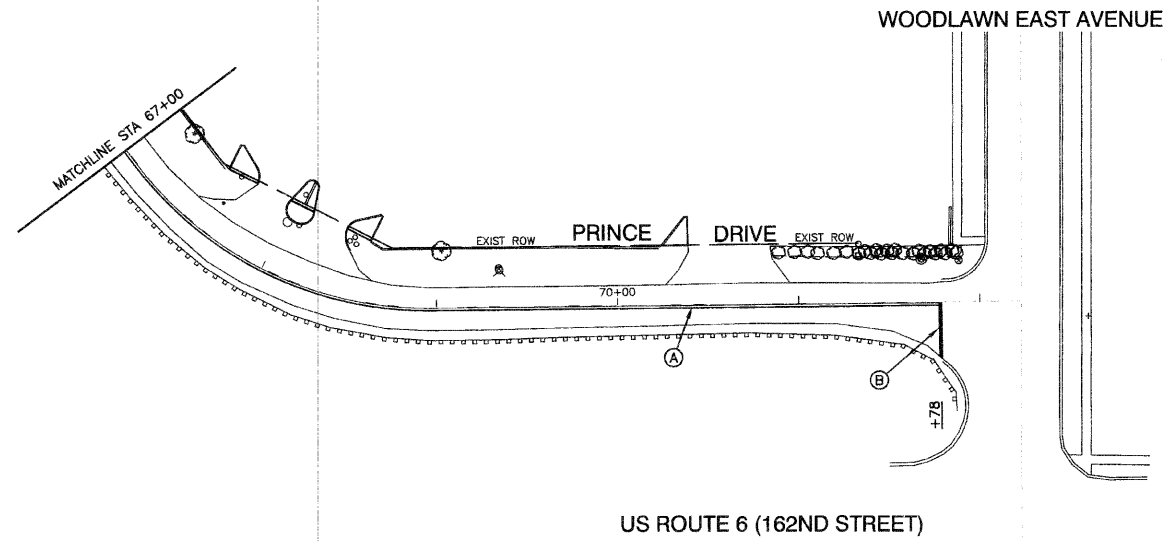

LEGEND

- (A) THERMOPLASTIC PAVEMENT MARKING
YELLOW, DOUBLE LINE, 4"
- (B) THERMOPLASTIC PAVEMENT MARKING
WHITE, 24"
- (C) THERMOPLASTIC PAVEMENT MARKING
WHITE, 4"
- ◆ TWO-WAY AMBER MARKER
40' C/C UNLESS OTHERWISE INDICATED

BENCH MARK:

"X" CUT ON NEX CONC BASE OF ALUM LT
POLE ON NWX 167TH PL AND PRINCE DRIVE
ELEVATION = 600.275

FILE NAME = 06185_01-FVMK-01 - IDOT P&4	USER NAME =	DESIGNED -- JPH	REVISED --
		CHECKED -- PKB	REVISED --
	PLOT SCALE =	DRAWN -- RG	REVISED --
	PLOT DATE = 06-22-10	CHECKED -- AG	REVISED --

STATE OF ILLINOIS
DEPARTMENT OF TRANSPORTATION

PRINCE DRIVE RESURFACING 170TH STREET TO WOODLAWN EAST AVENUE PAVEMENT MARKING		F.A.I. RTE.	SECTION	COUNTY	TOTAL SHEETS	SHEET NO.
SCALE: 1"=50'		94	10-00088-00-RS	COOK	18	11
SHEET NO. 11 OF 18 SHEETS		STA. TO STA.		CONTRACT NO. 63495		
		FED. ROAD DIST. NO. 1		ILLINOIS	FED. AID PROJECT ARA-9003(668)	