

STATE OF ILLINOIS  
DEPARTMENT OF TRANSPORTATION

ROUTE NO.	SECTION	COUNTY	TOTAL SHEETS	SHEET NO.	SHEET NO. 8
FAP 303 IL 173	2010-086-F	LAKE	29	19	23 SHEETS
FED. ROAD DIST. NO. 7	ILLINOIS	FED. AID PROJECT-			

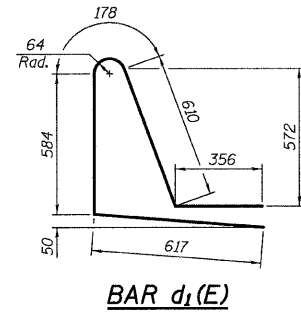
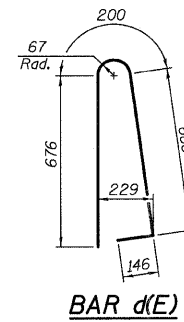
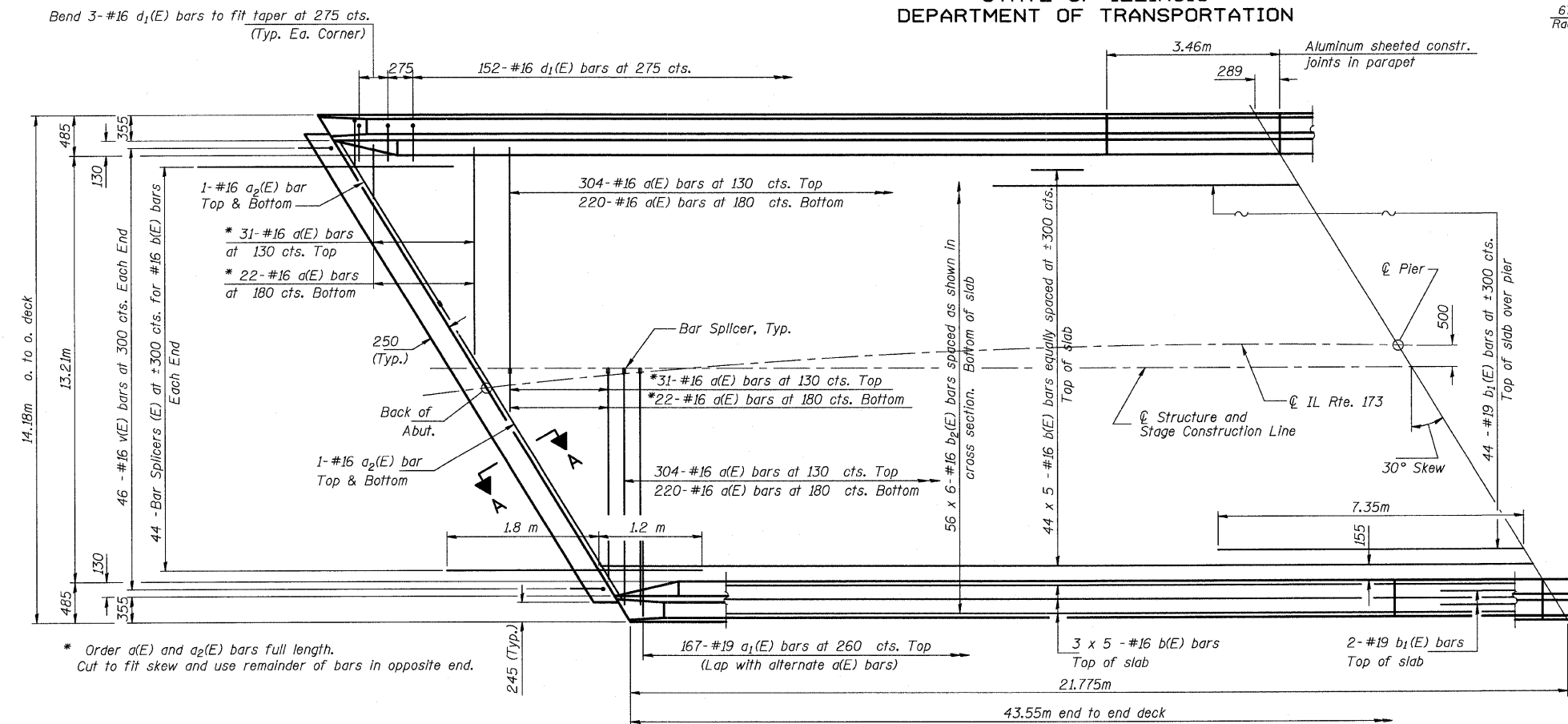

**SUPERSTRUCTURE BILL OF MATERIAL**

Bar	No.	Size	Length(m)	Shape
$a(E)$	1154	#16	6.800	—
$a_1(E)$	334	#19	2.000	—
$a_2(E)$	8	#16	8.000	—
$b(E)$	250	#16	9.180	—
$b_1(E)$	48	#19	14.700	—
$b_2(E)$	336	#16	7.750	—
$d(E)$	316	#16	1.702	U
$d_1(E)$	316	#16	2.345	U
$e(E)$	64	#16	9.370	—
$e_1(E)$	8	#25	9.700	—
$e_2(E)$	32	#16	3.460	—
$e_3(E)$	4	#25	3.460	—
$m(E)$	8	#19	8.107	—
$m_1(E)$	12	#19	8.107	—
$m_2(E)$	24	#19	3.709	—
$m_3(E)$	10	#19	2.739	—
$m_4(E)$	4	#19	0.939	—
$s(E)$	92	#16	1.413	—
$s_1(E)$	92	#16	2.872	—
$v(E)$	92	#16	1.044	—
Reinforcement Bars Epoxy Coated		kg	27,800	
Concrete Superstructure		m <sup>3</sup>	175	

**MINIMUM BAR LAP**  
#16 bar = 610  
#25 bar = 1.270m

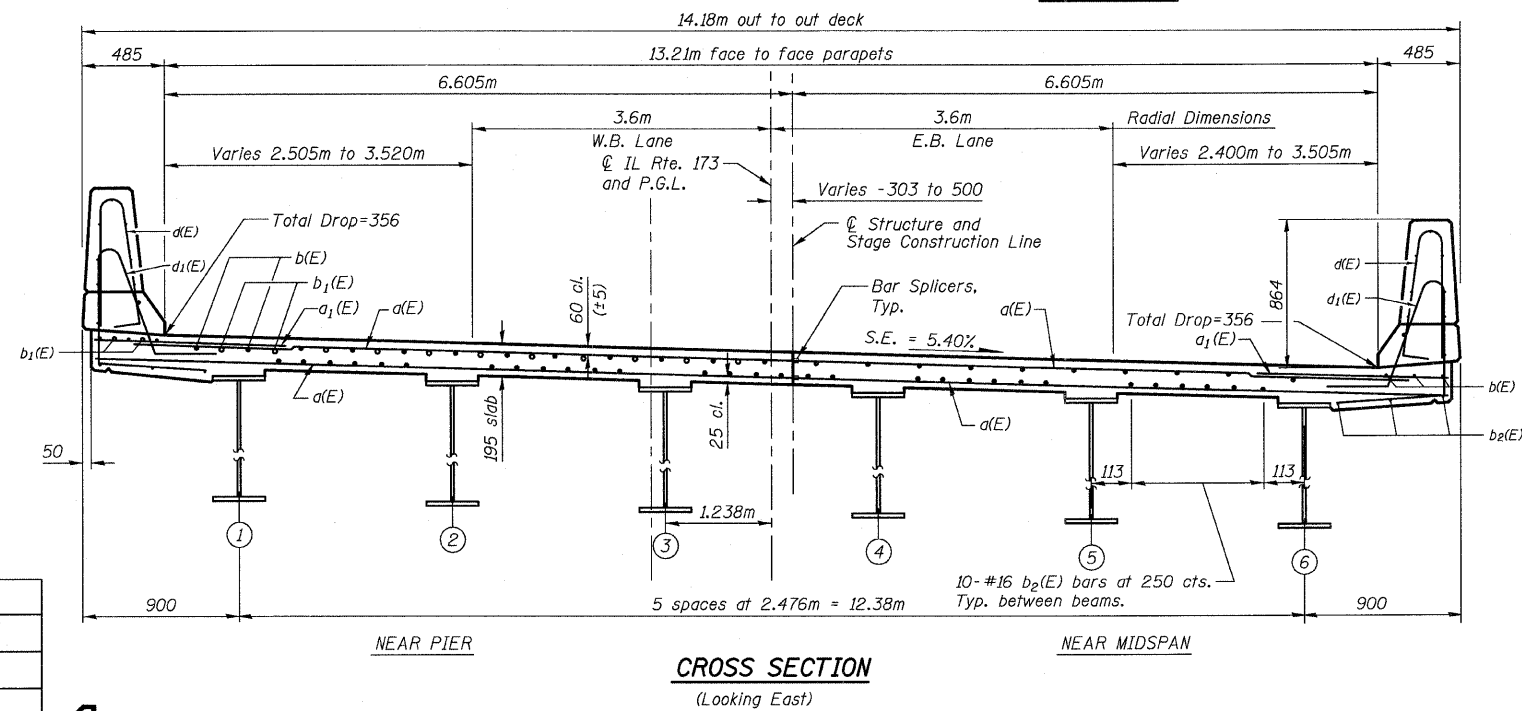
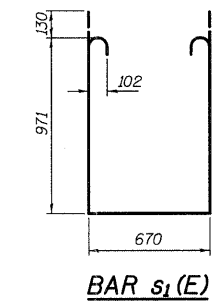
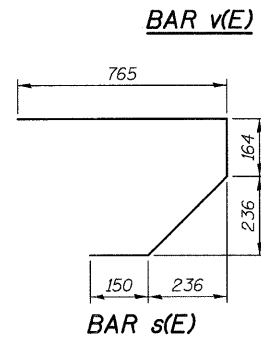

DESIGNED	JRF
CHECKED	RCJ
DRAWN	RDS
CHECKED	JRF



**NOTES**

See Sheets #9 and 10 for additional Superstructure details.

Bars indicated thus 20x3-#15 etc. indicates 20 lines of bar with 3 lengths per line.

See Sheet #10 for parapet reinforcement.

See Sheet #9 for Section A-A.

Reinforcing Bars designated (E) shall be Epoxy Coated.

All dimensions are in millimeters (mm) except as noted.

(X) Girder designation

**DECK PLAN AND CROSS SECTION**  
FAP 303 IL. ROUTE 173  
OVER EAST BOAT CHANNEL  
SECTION 2010-086-F  
LAKE COUNTY  
STATION 26+271.906  
STRUCTURE NO. 049-0198

**FOR INFORMATION ONLY**