

DIST. 1 - DESIGN / CONSULTANT SERVICES PROJECT MANAGER: BRIAN KUTTAB (847) 705-4431  
BEAM FAB:3116&17COV

F.A.P. RTE.	SECTION	COUNTY	TOTAL SHEETS	SHEET NO.
303	2010-086-F	LAKE	29	1

D-91-025-11  
CONTRACT NO. 60L81

STATE OF ILLINOIS  
DEPARTMENT OF TRANSPORTATION

DIVISION OF HIGHWAYS  
**PLANS FOR PROPOSED  
HIGHWAY**

**FAP 303 - IL ROUTE 173 OVER BOAT CHANNELS  
(1.8 MI WEST OF IL 59 & 2.5 MI WEST OF IL 59)  
SECTION: 2010-086-F  
BEAMS AND BEARINGS FABRICATION**

C-91-025-11

**Project located  
in THE TOWNSHIP OF ANTIOCH**

FOR INDEX OF SHEETS, SEE SHEET NO. 2

TRAFFIC DATA  
2007 ADT: 12,400 VEHICLES  
2007 ADTT: 1,875  
2027 ADT: 16,700 VEHICLES

POSTED SPEED LIMIT  
65 km/h (40 mph)

**DESIGN DESIGNATION**  
17,400(30) PRINCIPAL ARTERIAL  
5.07 (FD-20)

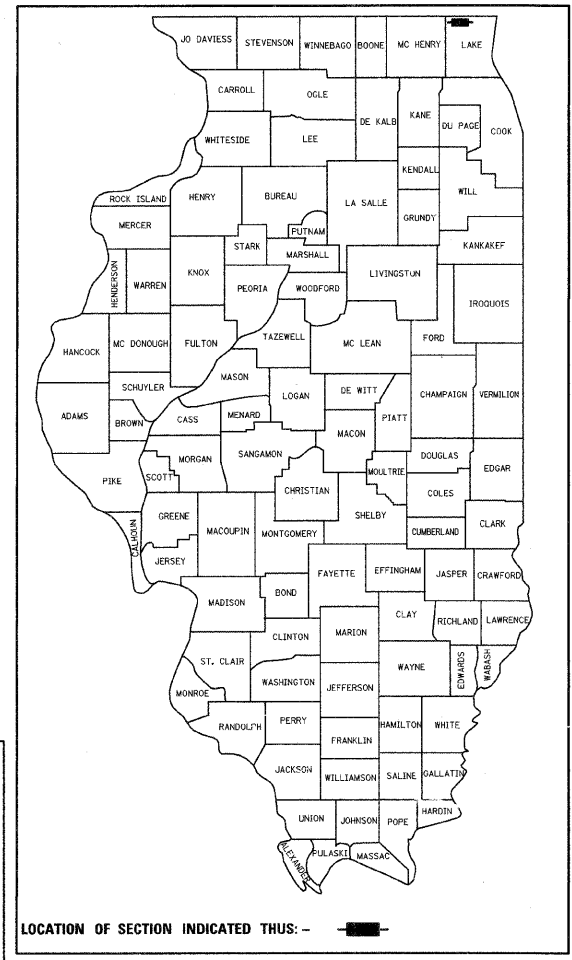

**Project Description**  
IL ROUTE 173 OVER EAST BOAT CHANNEL,  
1.8 MI WEST OF IL ROUTE 59,  
PROPOSED BEAM AND BEARING FABRICATION  
EXISTING S. N. 049-0056  
PROPOSED S. N. 049-0198  
EXISTING BRIDGE LENGTH 29.58 M  
PROPOSED BRIDGE LENGTH 43.55 M  
STA. 26+250.541 TO STA. 26+294.164

**Project Description**  
IL ROUTE 173 OVER WEST BOAT CHANNEL,  
2.5 MI WEST OF IL ROUTE 59,  
PROPOSED BEAM AND BEARING FABRICATION  
EXISTING S. N. 049-0055  
EXISTING BRIDGE LENGTH 9.72 M  
STA. 25+093.533 TO STA. 25+103.253

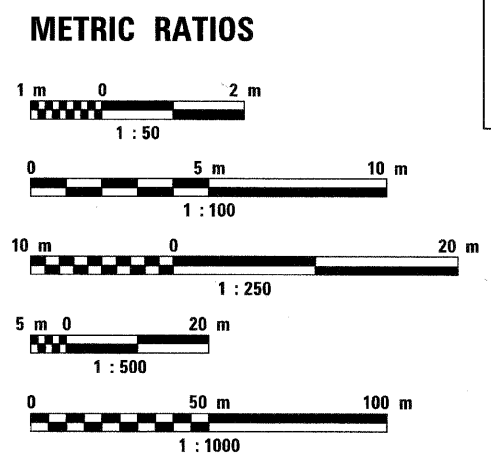
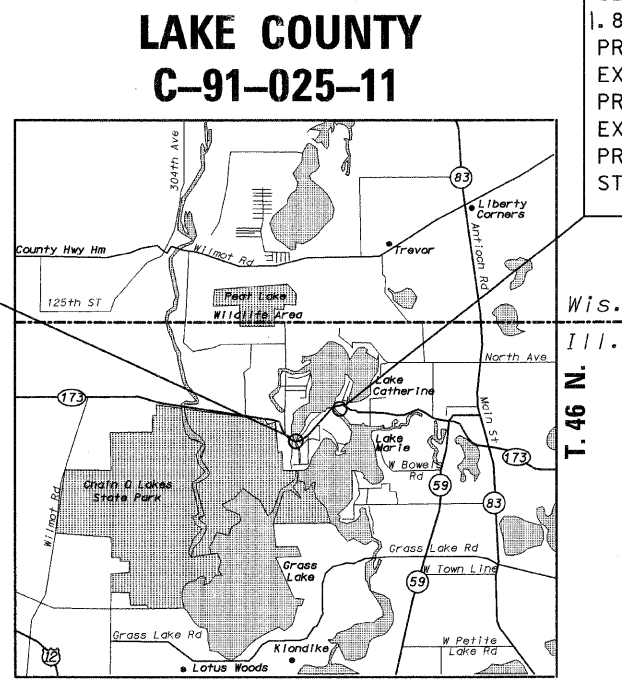

FULL SIZE PLANS HAVE BEEN PREPARED USING STANDARD ENGINEERING SCALES. REDUCED SIZED PLANS WILL NOT CONFORM TO STANDARD SCALES. IN MAKING MEASUREMENTS ON REDUCED PLANS, THE ABOVE SCALES MAY BE USED.

J.U.L.I.E.  
JOINT UTILITY LOCATION INFORMATION FOR EXCAVATION  
1-800-892-0123

CONTRACT NO. 60L81

GROSS LENGTH OF WEST BOAT CHANNEL SN 049-0055 = 9.72m = 0.0097km  
GROSS LENGTH OF EAST BOAT CHANNEL SN 049-0198 = 43.55m = 0.0436km



7/12/10  
Expires 11/30/10

SEAL

STATE OF ILLINOIS  
DEPARTMENT OF TRANSPORTATION  
DIVISION OF HIGHWAYS

SUBMITTED July 13, 2010  
Diana M. O'Keefe  
DEPUTY DIRECTOR OF HIGHWAY, REGION ONE ENGINEER

August 13, 2010  
Scott E. Stitt, P.E.  
acting ENGINEER OF DESIGN AND ENVIRONMENT

August 13, 2010  
Christine M. Reeder  
DIRECTOR, DIVISION OF HIGHWAYS

PRINTED BY THE AUTHORITY  
OF THE STATE OF ILLINOIS

**Applied Technologies**  
CONSULTING ENGINEERS  
468 PARK AVENUE  
LAKE VILLA, ILLINOIS 60046  
PHONE: 847-265-7325, EXT 101  
FAX: 847-265-7327