

STATE OF ILLINOIS
DEPARTMENT OF TRANSPORTATION

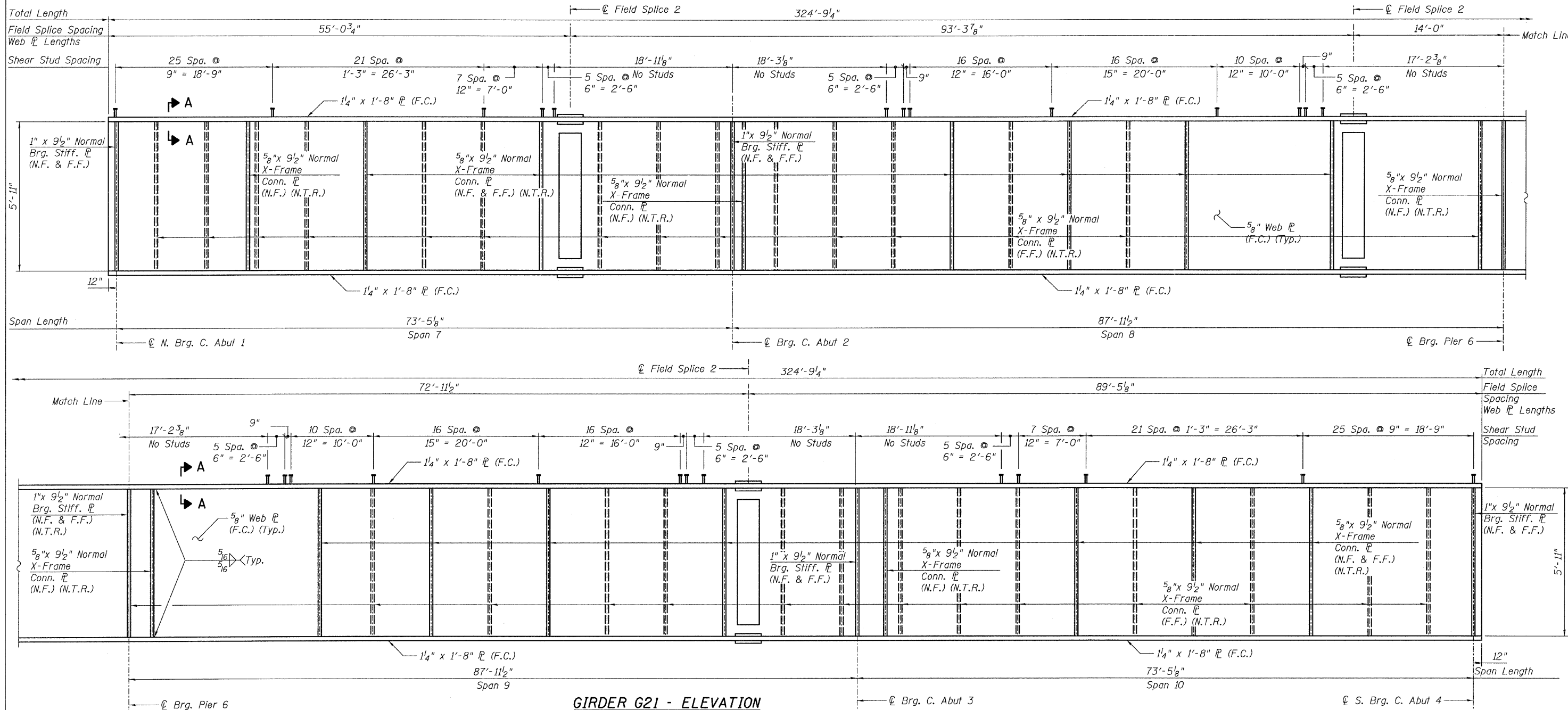

GIRDER G21 - ELEVATION
(Looking West)
(F.C.M.)

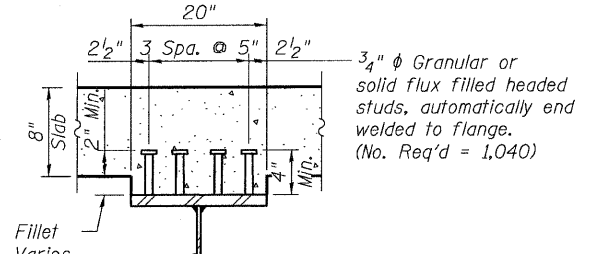

NOTES:

- All Steel shown on this sheet shall be AASHTO M 270 GR 50.
- For Top of Web Elevations, see sheet 40.
- For Bearing stiffener and connection plate details, see sheet 53.
- For Field Splice detail, See sheet 52.
- F.C.M. denotes Fracture Critical Member
- F.C. denotes Fracture Critical Material, AASHTO Zone II
- N.F. denotes Near Face
- F.F. denotes Far Face
- Girder G21 shall not be cambered.
- Load carrying components designated "NTR" shall conform to the supplemental requirements for Notch Toughness, Zone 2.

GIRDER G21 - ELEVATION
CENTRAL/I-55
STRUCTURE NO. 016-0724

TYLIN INTERNATIONAL	DESIGNED - JMA	REVISIONS		SHEET NO. 49 137 SHEETS	F.A.I RTE. 55	SECTION 0711.2R & 1011.1BR	COUNTY COOK	TOTAL SHEETS 200	SHEET NO. 79	
	CHECKED - AMD,	NAME	DATE							CONTRACT NO. 60L39
	DRAWN - JMA									
	CHECKED - AMD,									
	DATE - 08/02/10				FED. ROAD DIST. NO. 1 ILLINOIS FED. AID PROJECT					

8/13/2010 9:56:43 AM